

## Tuinberging Moos

- 1x Deurpaneel -1715x1985mm
- 5x Dichtpaneel - 1715x1985mm
- 2x Dakpaneel betonplex - 1860x1710mm

- 
- 6x Douglas balk 120x120mm - 1988mm
  - 2x Douglas balk 90x90mm - 1890mm langste maat 1x 45\*
  - 2x Douglas balk 90x90mm - 1950mm langste maat 1x 45\*
  - 1x Douglas balk 90x90mm - 1860mm
  - 2x Balk 90x90mm- 700mm 2x 45\*
  - 2x Balk 35x30mm - 30cm
  - 2x Lat douglas 65x16mm - 195cm
  - 2x Lat douglas 65x16mm - 1906mm
  - 1x Epdm dakbedekking 2400x4000mm

- 
- 18x Schroeven 120mm
  - 56x Schroeven 100mm
  - 6x Schroeven 80mm
  - 8x Schroeven 60mm
  - 12x Schroeven 40mm
  - 1x Boortje 5mm



**1.**

1x Dichtpaneel - 1715x1985mm  
2x Balk 120x120mm - 1988mm  
6x Schroef 100mm

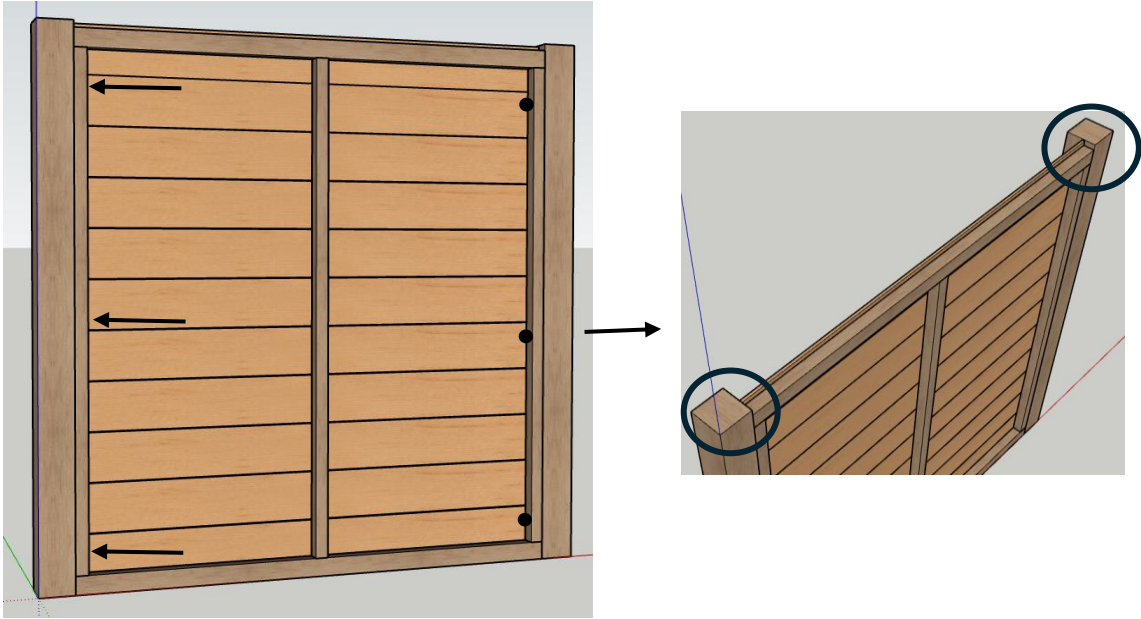

**2.**

1x Dichtpaneel - 1715x1985mm  
1x Balk 120x120mm - 1988mm  
6x Schroef 100mm

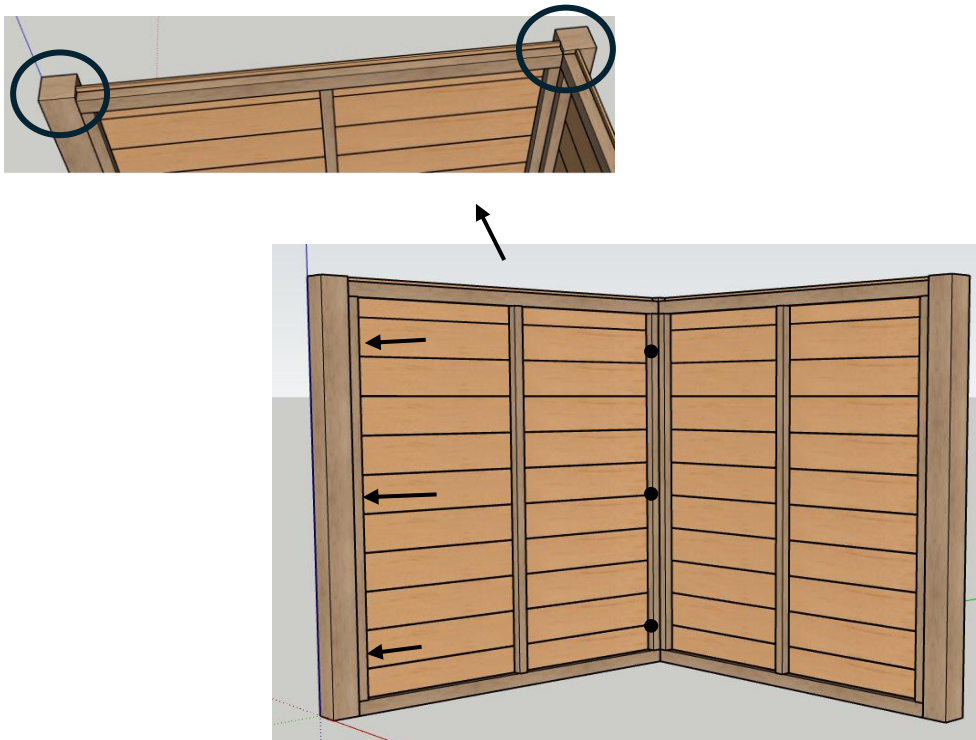

**3.**

**1x Deurpaneel - 1715x1985mm  
1x Balk 120x120mm - 1988mm  
6x Schroef 100mm**

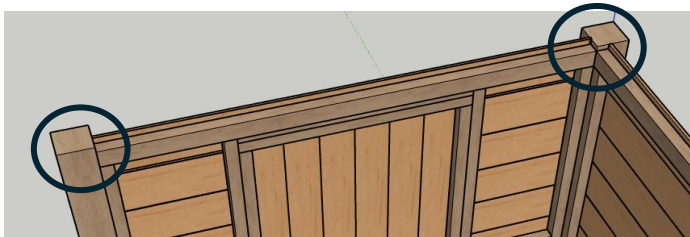

**4.**

**1x Dichtpaneel - 1715x1985mm  
1x Balk 120x120mm - 1988mm  
6x Schroef 100mm**



**5.**

**1x Dichtpaneel - 1715x1985mm  
6x Schroef 100mm**

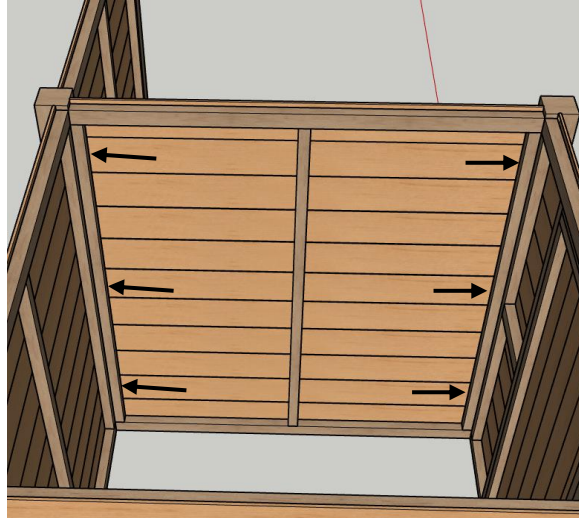
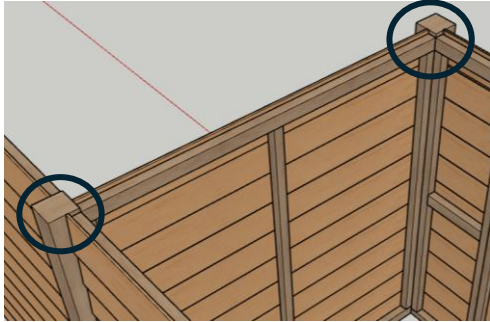

**6.**

**1x Dichtpaneel - 1715x1985mm  
1x Balk 120x120mm - 1988mm  
6x Schroef 100mm**



**7.**

**2x Balk 90x90mm - 1950mm 2x45\*  
8x Schroef 120mm**

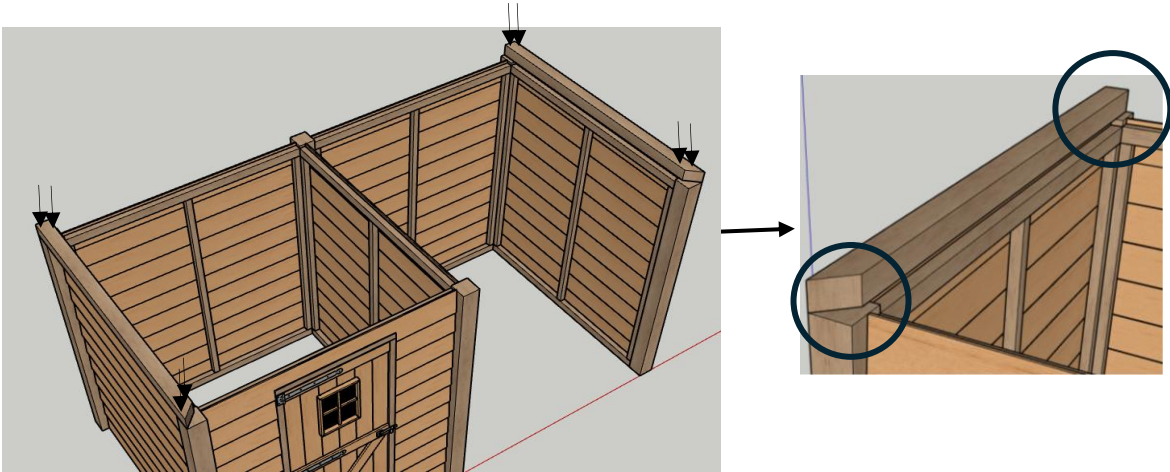

**8.**

**2x Balk 90x90mm - 1890mm 1x45\*  
8x Schroef 120mm  
4x Schroef 80mm**

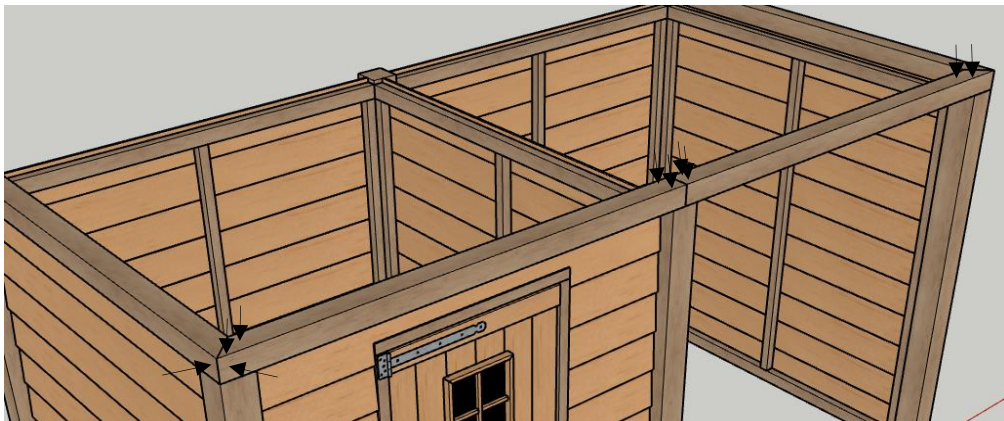
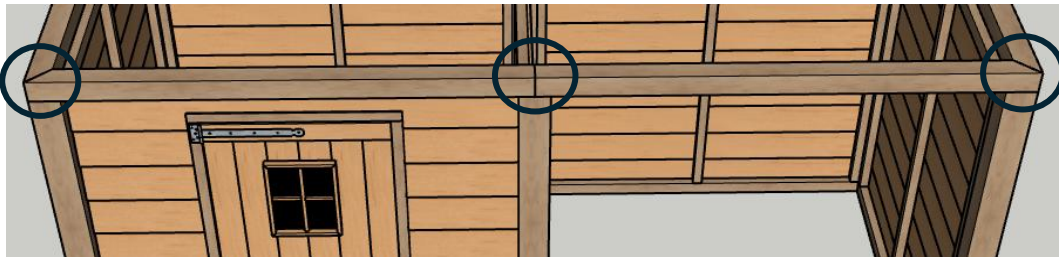

**9.**

2x Balk 35x30mm - 30cm (35mm hoog, 30mm breed)  
8x Schroef 60mm



**10.**

1x Balk 90x90mm - 1860mm  
2x Schroef 120mm  
2x Schroef 80mm

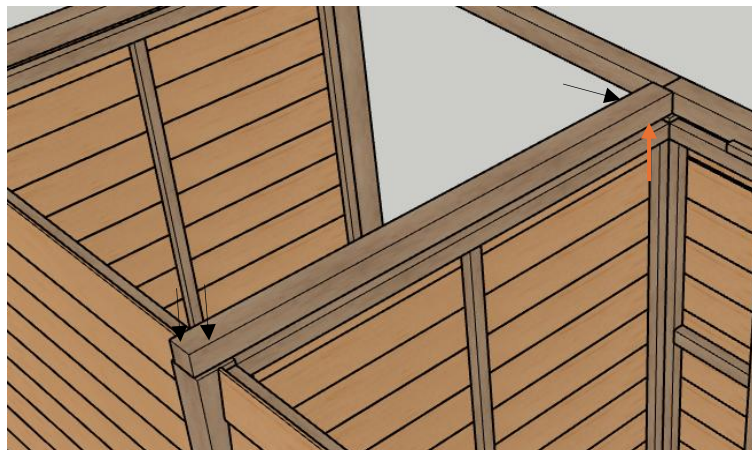

**11.**

2x Balk 90x90mm- 700mm 2x 45°  
4x Schroef 100mm

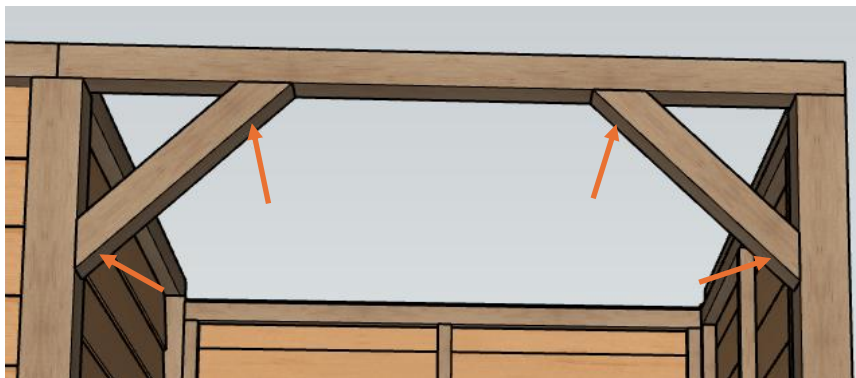

**12.**

2x Dakpaneel betonplex - 1860x1710mm  
16x Schroef 100mm

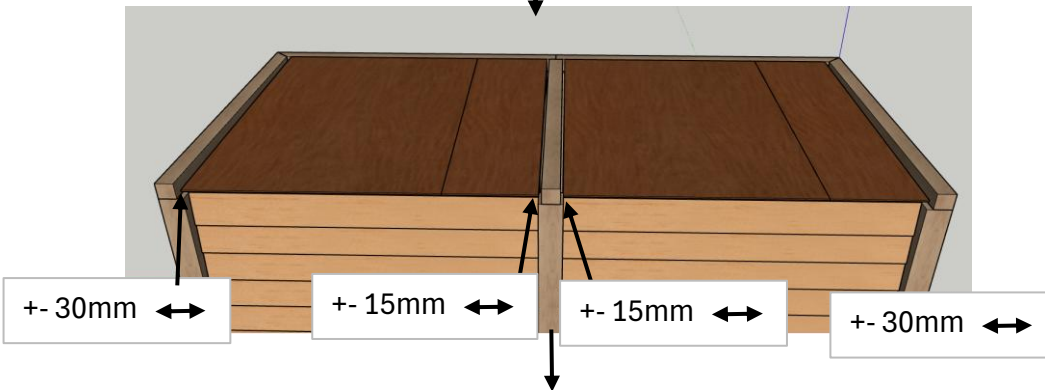
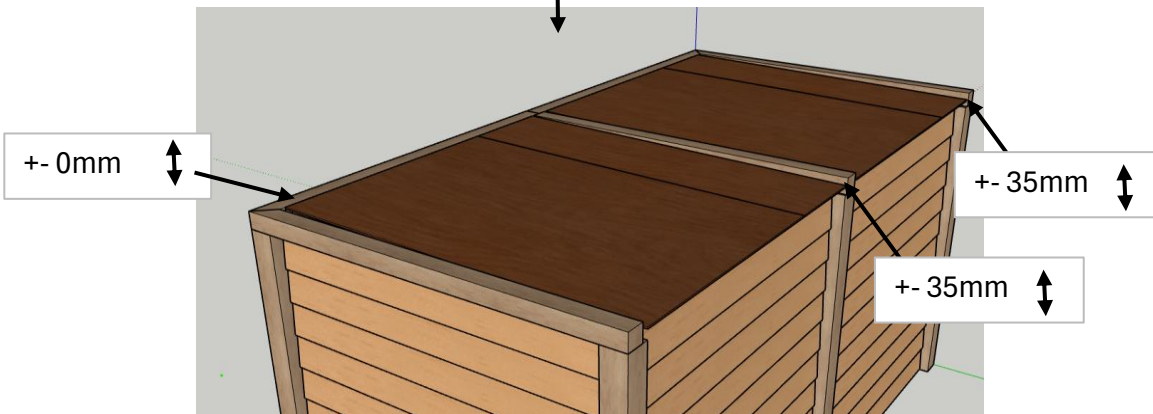
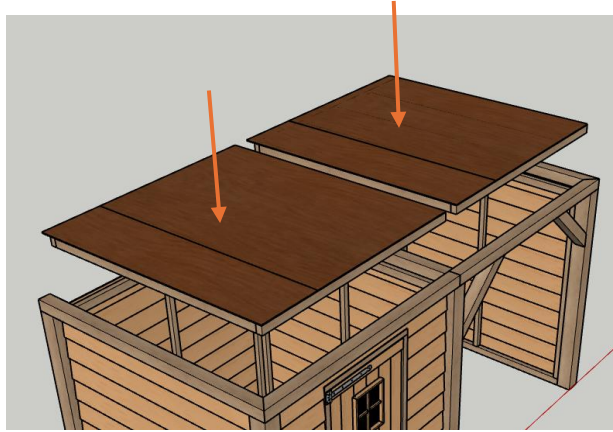



**13.**

1x EPDM 4000x2200mm

Verdeel het EPDM over de dakplaten. Zorg dat het EPDM aan de achterzijde 13cm oversteekt. Verdeel de overige zijdes

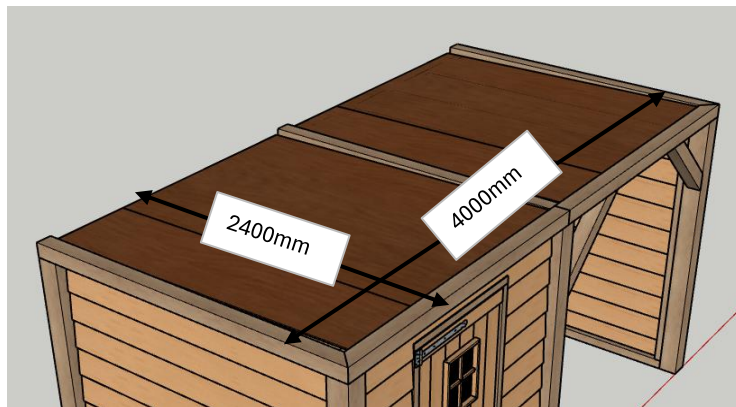

**14.**

2x Lat 65x16mm - 1950mm  
2x Lat 65x16mm - 1906mm  
12x Schroef 40mm

+ Snij het Epdm wat aan de voor + kopzijdes onder de lat uitsteekt af (indien nodig)

