

BE161015624

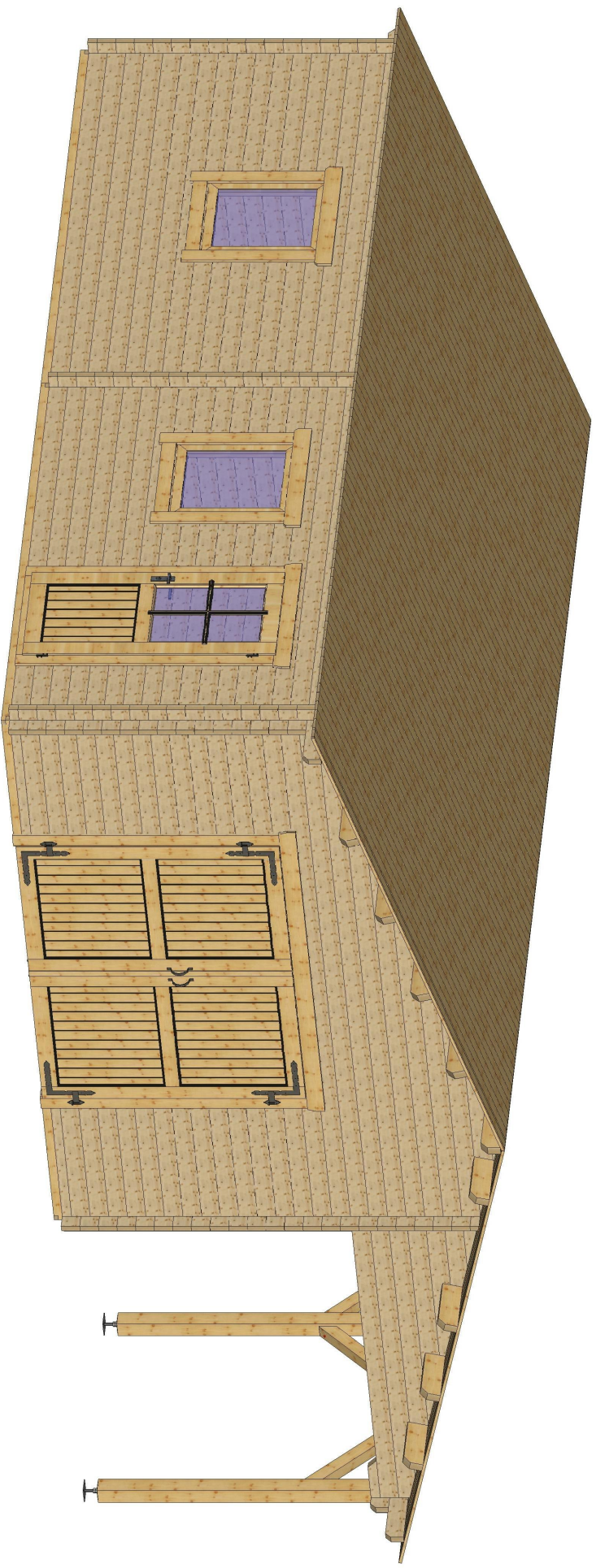

Bemerkung: die Ansicht von Turen, Fenster und anderen Teilen kann abweichen von diesem Bild

Projektas		Breziny's		Masels	
Uzakymo Nr.		Nuotrauka		1 :	
				Data	
NL-160969				2016 11 04	
				Projektavo	
				R.Kregde	

BE161015624

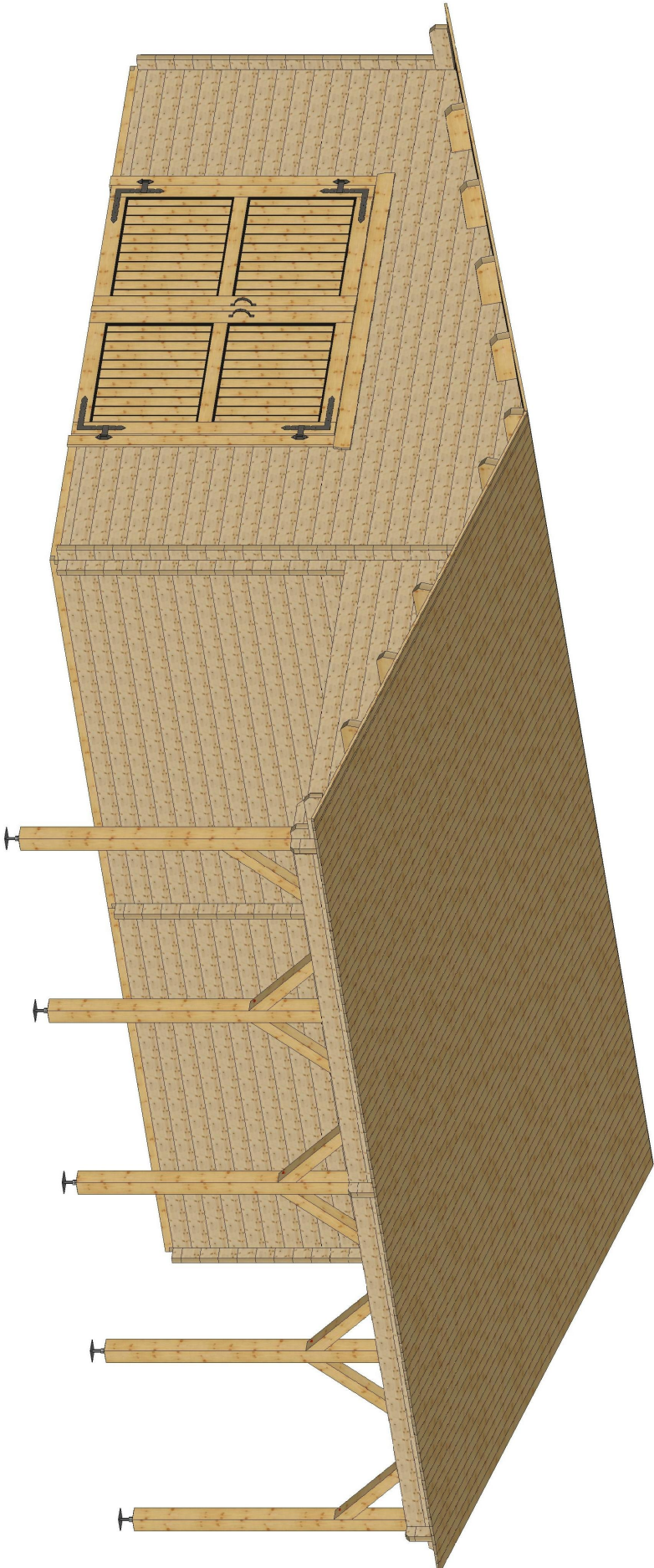

Bemerkung: die Ansicht von Turen, Fenster und anderen Teilen kann abweichen von diesem Bild

Projektas  
Uzakymo Nr.

Brezinys  
Nuotrauka

Mastelis  
1 :

NL-160969

Data  
2016 11 04  
Projektavo  
R.Kregzde

4,5

Grundriss

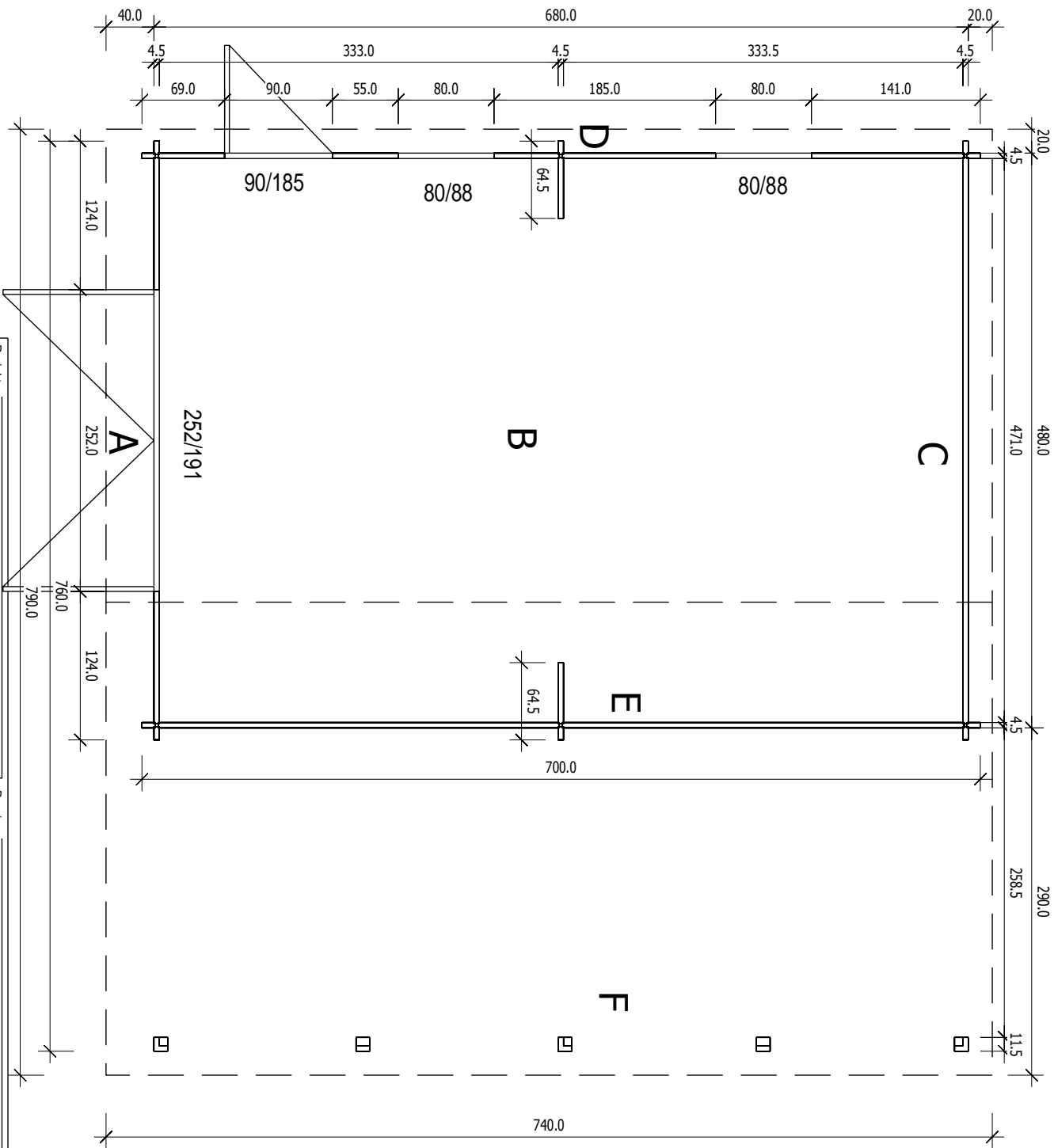

Projektas \_\_\_\_\_  
Uždavymų Nr. \_\_\_\_\_

Brezinis \_\_\_\_\_  
Planas \_\_\_\_\_

Mastelis \_\_\_\_\_  
1 : 50

NL-160969

Data \_\_\_\_\_  
2016 11 04  
Projektavo \_\_\_\_\_  
R. Kregždė

# Schnitt

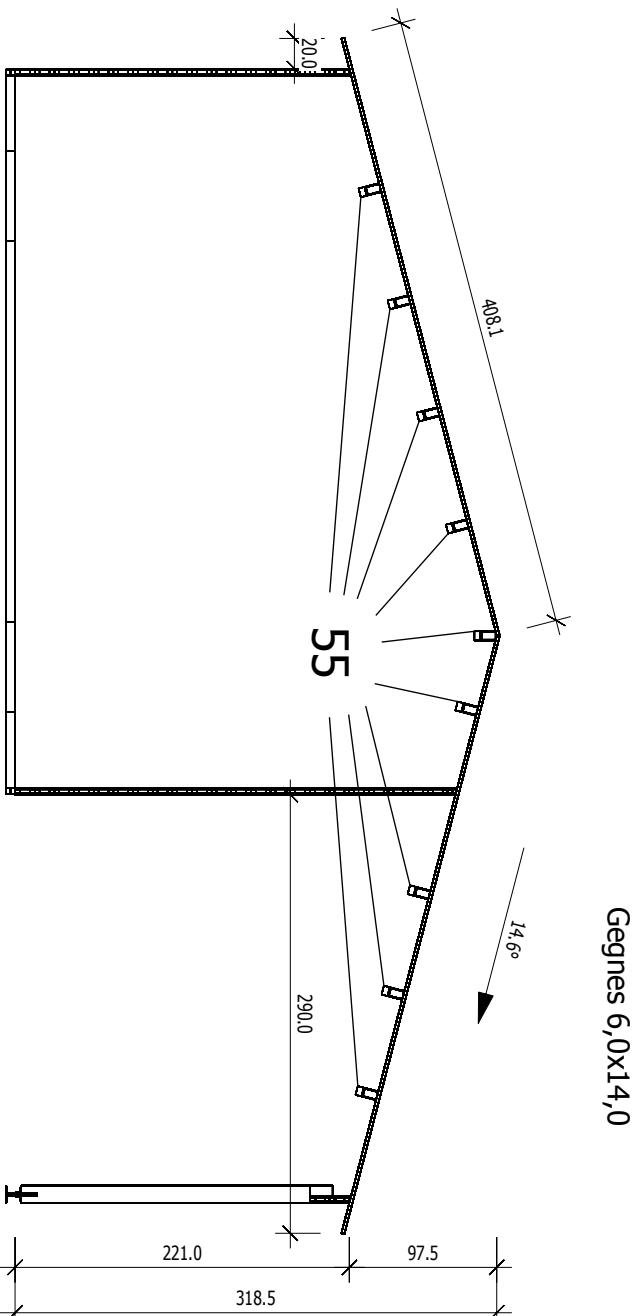

Projektas	Bezinys
Uzskymo Nr.	Piuvis

Brezinsys  
Pjuvis

Masteils	1 : 50
----------	--------

**NL-160969**

Data **2016 11 04**

Projektavo **R. Kregzde**

A

M 1:40

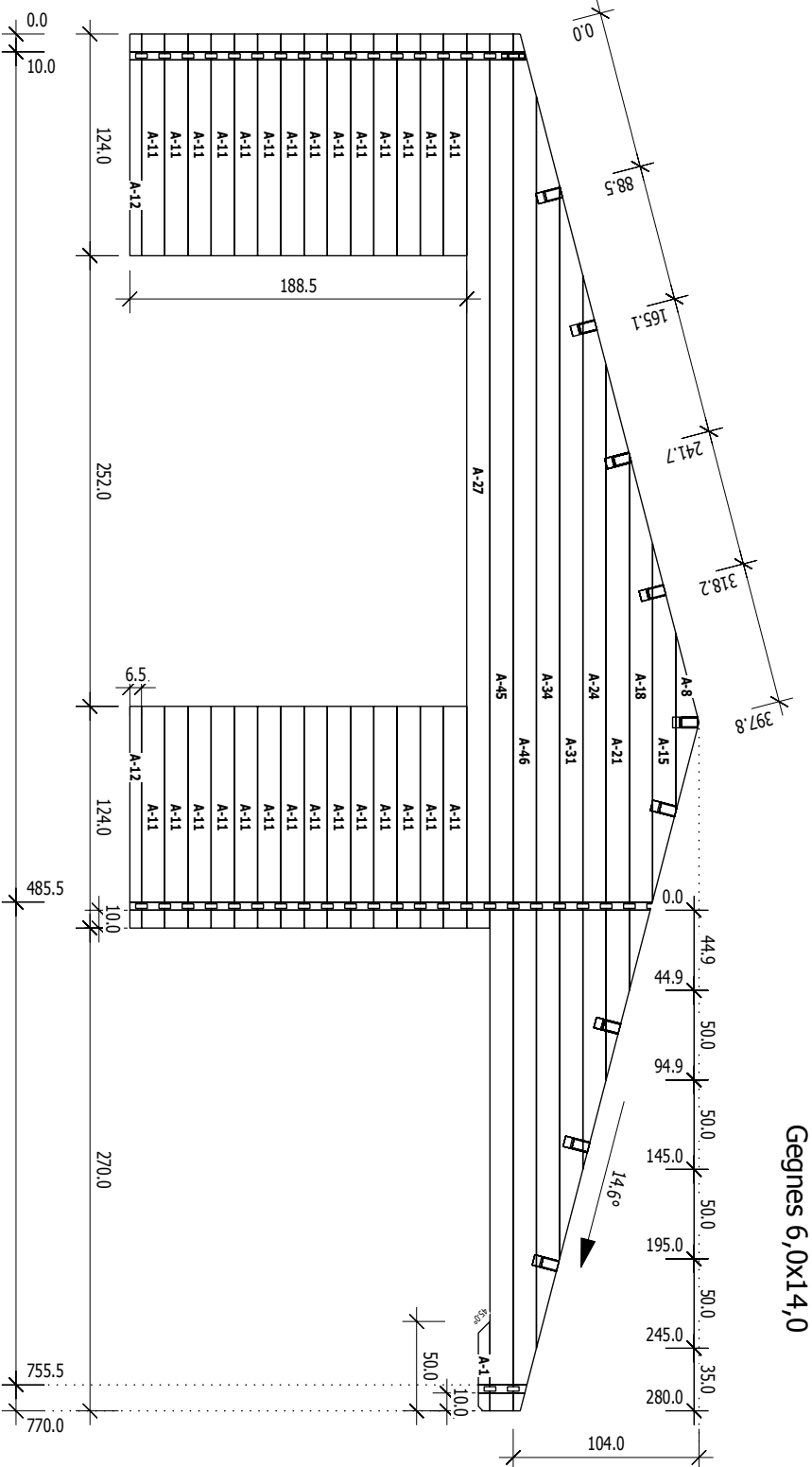

Gegnes 6,0x14,0

Nr	H	L	Psc
1	6.5	50.0	1
8	13.0	99.8	1
11	13.0	124.0	28
12	6.5	124.0	2
15	13.0	199.8	1
18	13.0	299.9	1
21	13.0	399.9	1
24	13.0	499.9	1
27	13.0	500.0	1
31	13.0	600.0	1
34	13.0	700.0	1
45	13.0	770.0	1
46	13.0	770.0	1

B

M 1:40

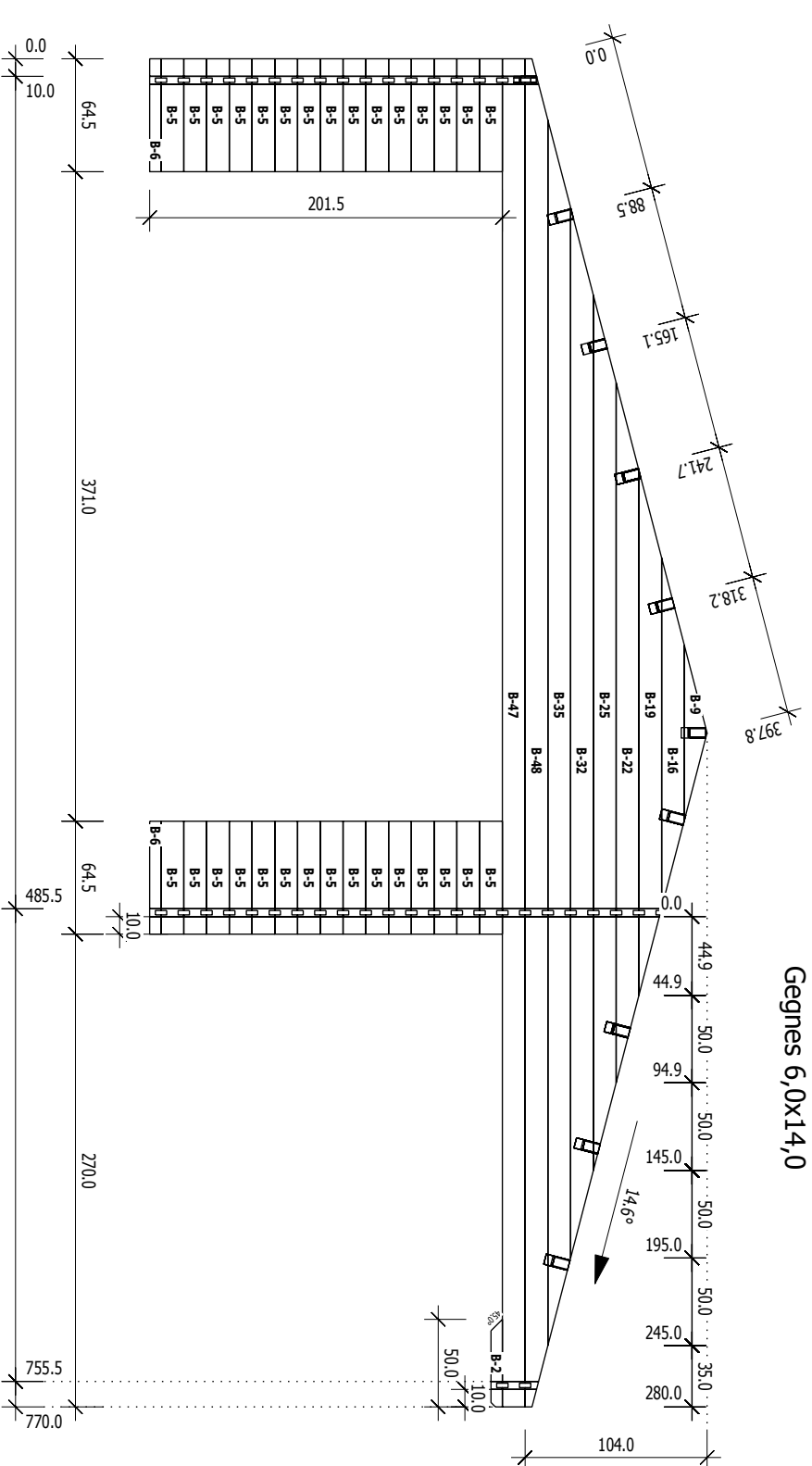

Gegnes 6,0x14,0

Nr	H	L	Psc
2	6.5	50.0	1
5	13.0	64.5	30
6	6.5	64.5	2
9	13.0	99.8	1
16	13.0	199.8	1
19	13.0	299.9	1
22	13.0	399.9	1
25	13.0	499.9	1
32	13.0	600.0	1
35	13.0	700.0	1
47	13.0	770.0	1
48	13.0	770.0	1

Projeklas	Brezinys	Mastelis
Uzsakymo Nr.	Siena A B	1 : 40
NL-160969		Data
		2016 11 04
		Projektavo
		R.Kregzde

4,5

Grundrahmenplan

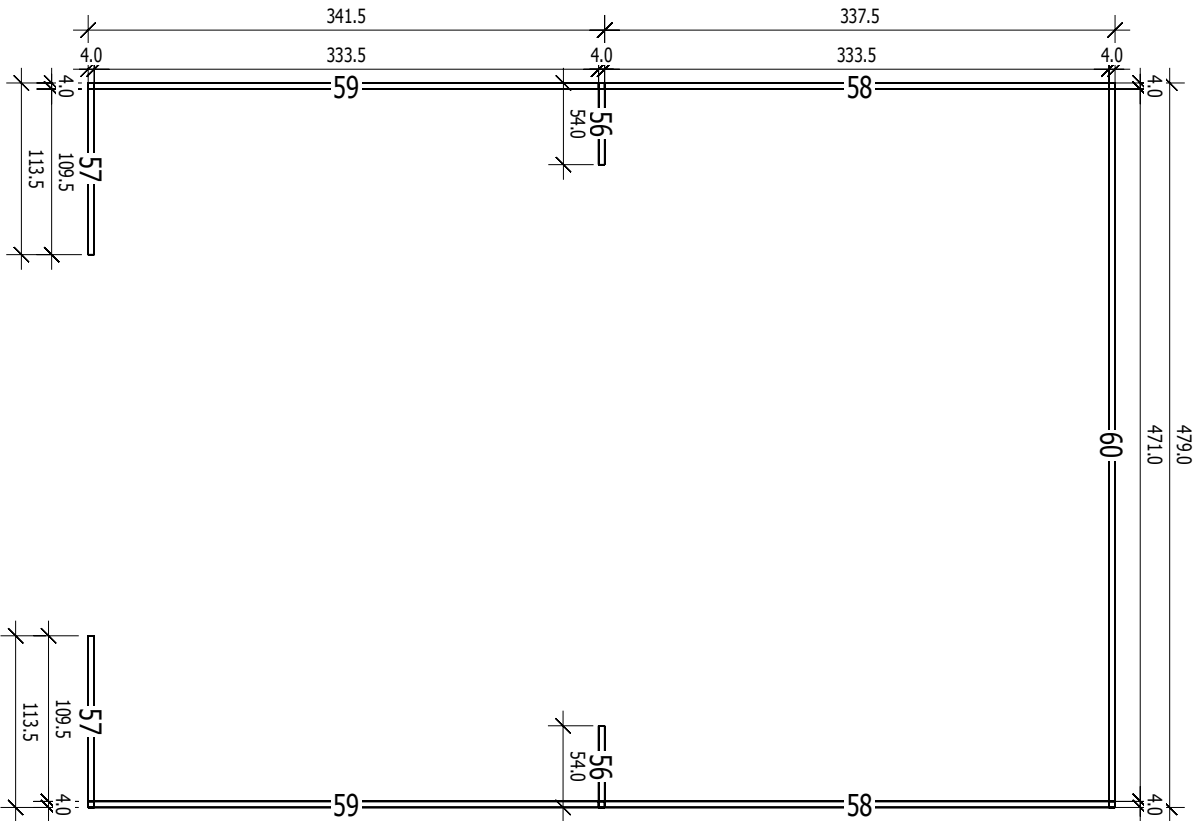

Nr.	B	H	L	Psc
56	4,0	6,0	54,0	2
57	4,0	6,0	113,5	2
58	4,0	6,0	337,5	2
59	4,0	6,0	341,5	2
60	4,0	6,0	479,0	1

Projektas  
Uždavimas Nr.

Brezinis  
Pagrindinio planas

Mastelis  
1 : 50

NL-160969

Data  
2016 11 04

Projektavo  
R. Kregždė

Grundrahmenplan

4,5

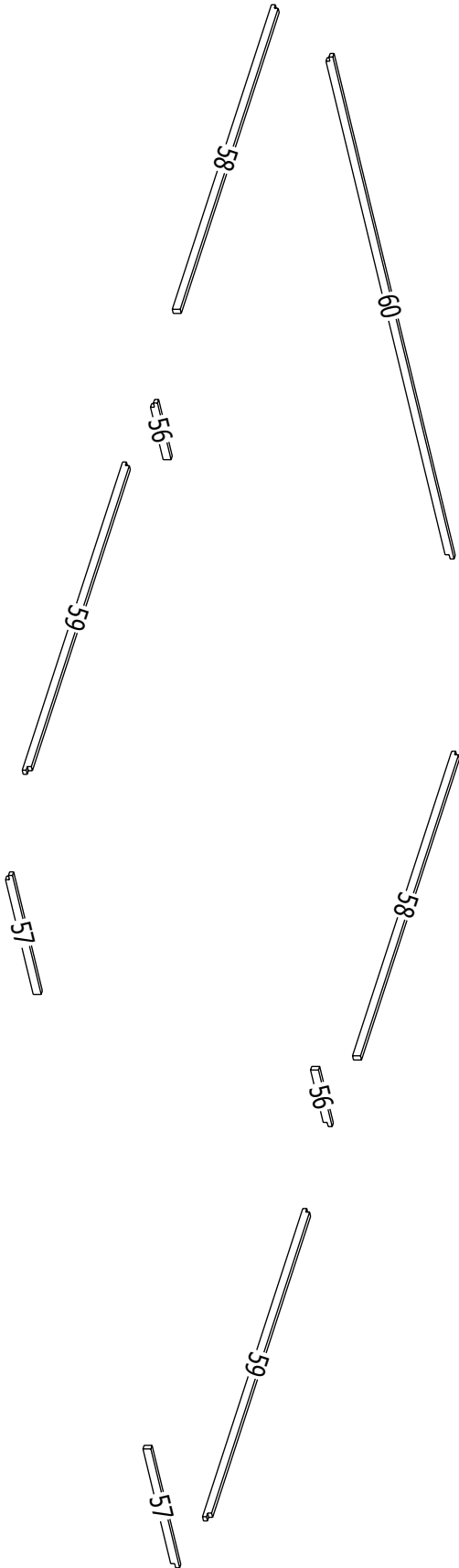

Projektas	Brezinys	Mastelis
Uzskymo Nr.	Pagrindo planas	1 : 50
NL-160969		
Data		Projektavo
2016 11 04		R. Kregzde

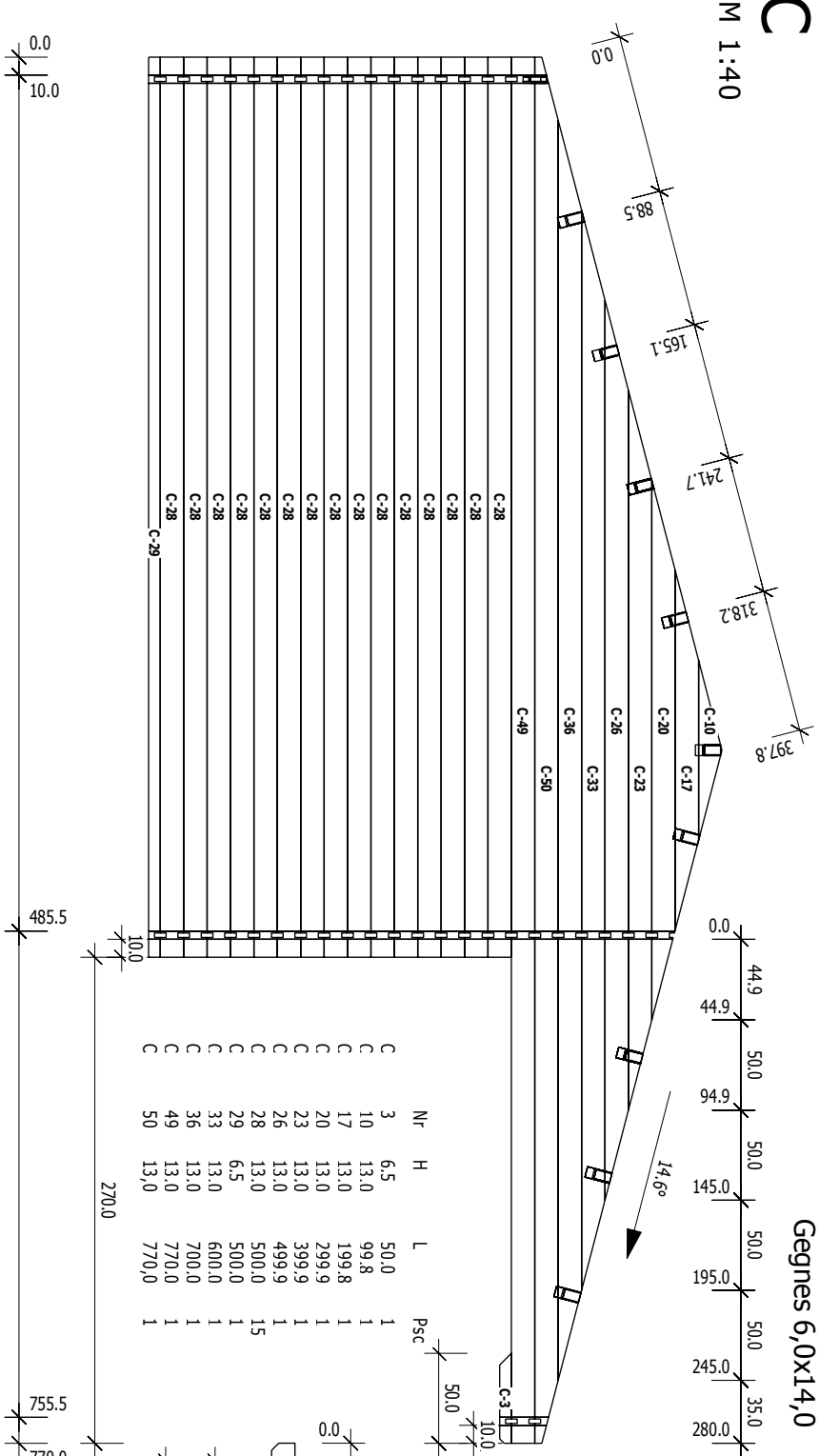

Nr	H	L	Psc
3	6,5	50,0	1
10	13,0	99,8	1
17	13,0	199,8	1
20	13,0	299,9	1
23	13,0	399,9	1
26	13,0	499,9	1
28	13,0	500,0	15
29	6,5	500,0	1
33	13,0	600,0	1
36	13,0	700,0	1
49	13,0	770,0	1
50	13,0	770,0	1

F

M 1:40

Nr	H	L	Psc
41	13,0	700,0	1
44	13,0	740,0	1

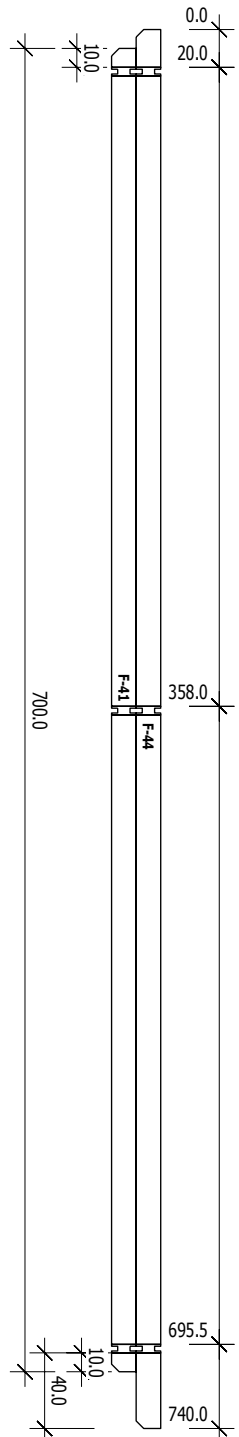

E

M 1:40

D

Nr	H	L	Psc
4	13,0	55,0	7
7	13,0	69,0	14
13	13,0	141,0	7
14	13,0	185,0	7
30	13,0	541,0	7
37	13,0	700,0	1
38	13,0	700,0	1
43	13,0	740,0	1

M 1:40

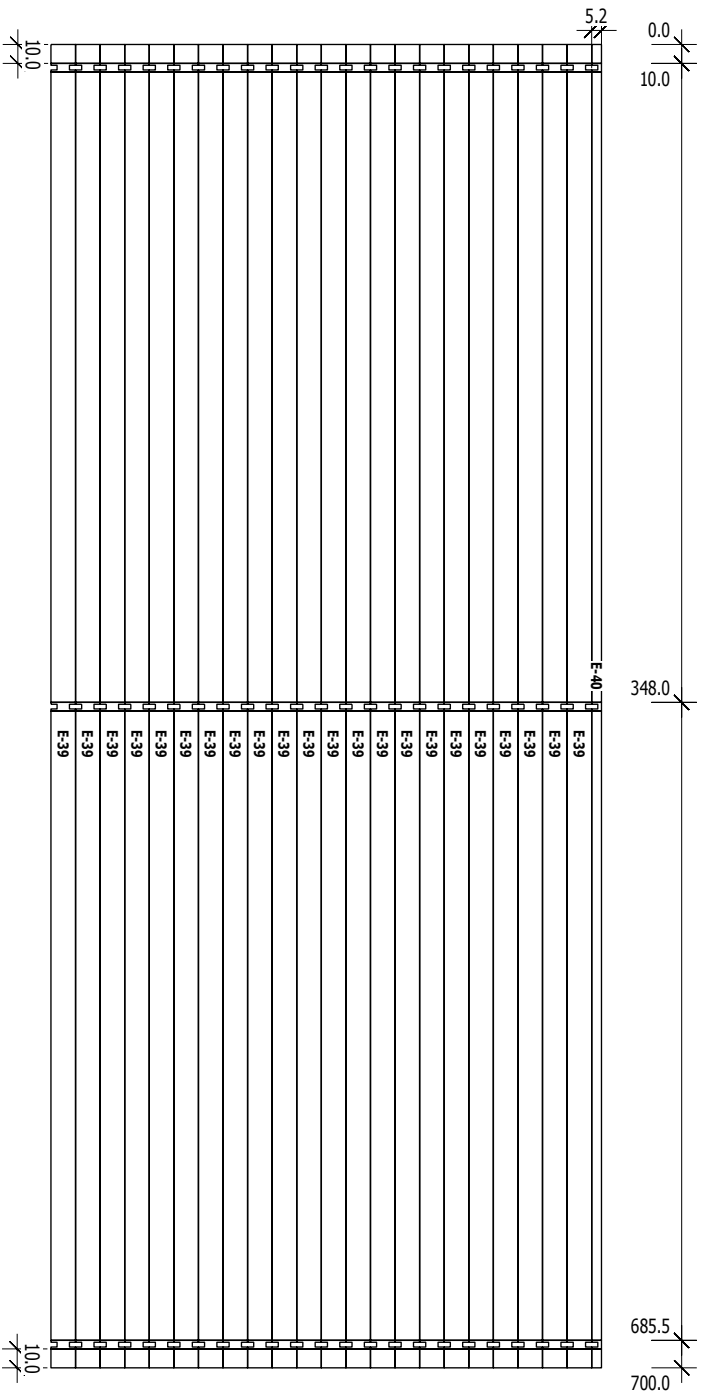
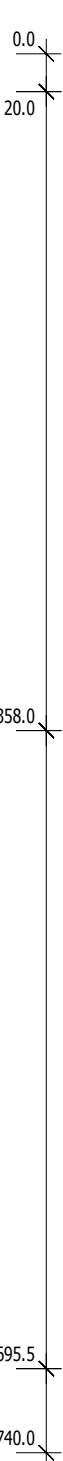

Nr	H	L	Psc
39	13,0	700,0	22
40	5,2	700,0	1

