

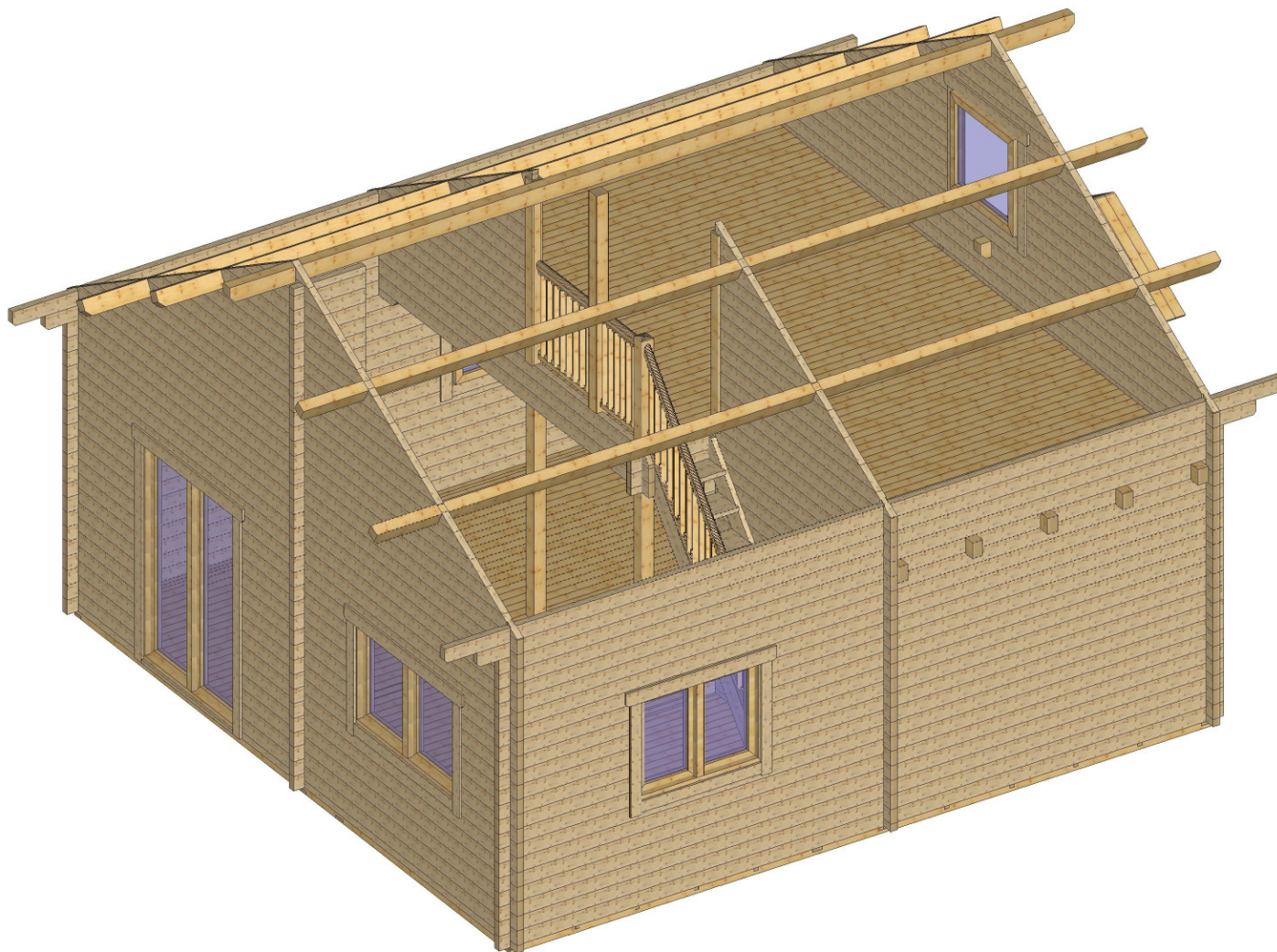

Bemerkung: die Ansicht von Turen, Fenster und anderen Teilen kann abweichen von diesem Bild





Bemerkung: die Ansicht von Türen, Fenster und anderen Teilen kann abweichen von diesem Bild

Grundriss

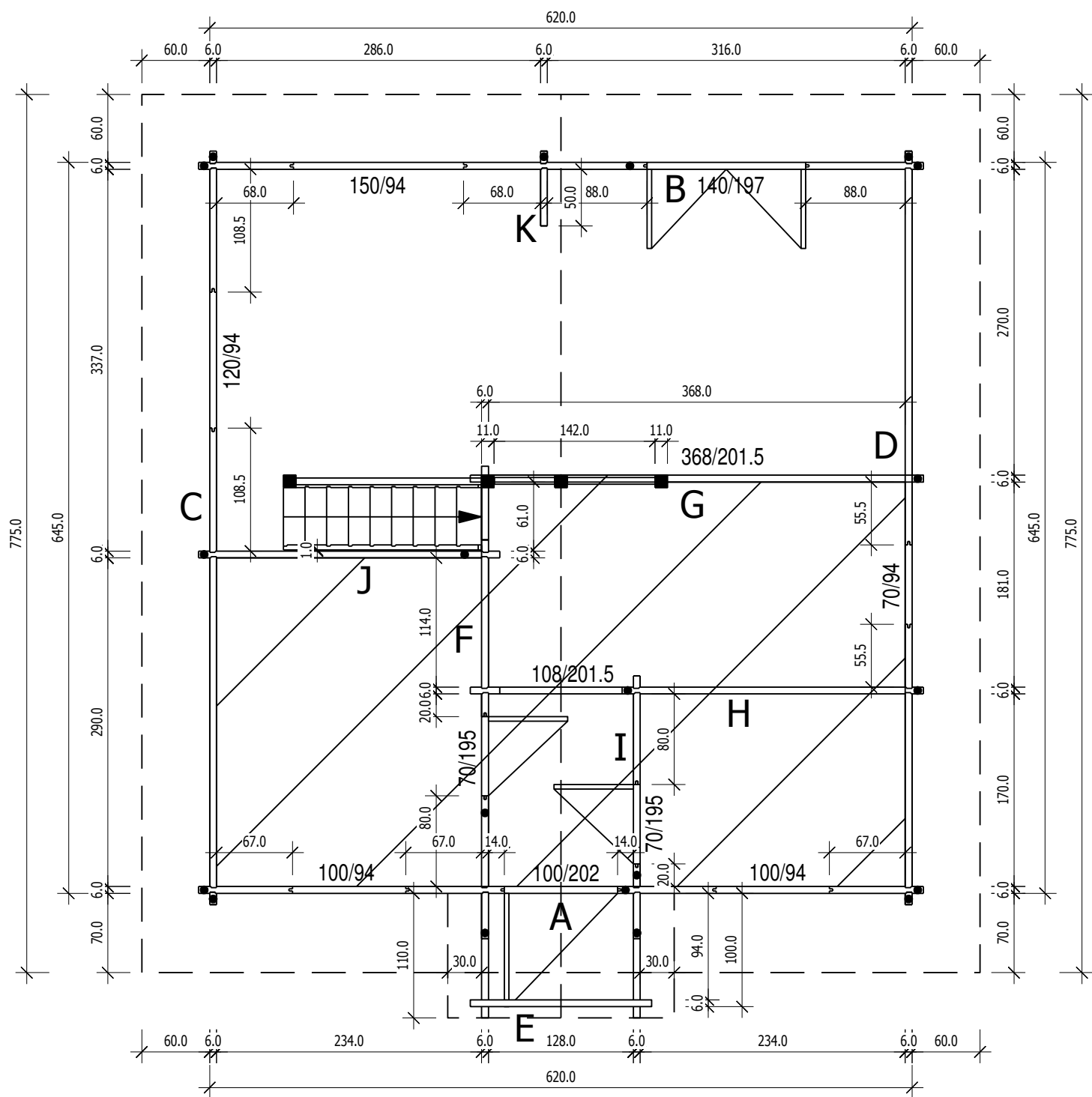

Schnitt

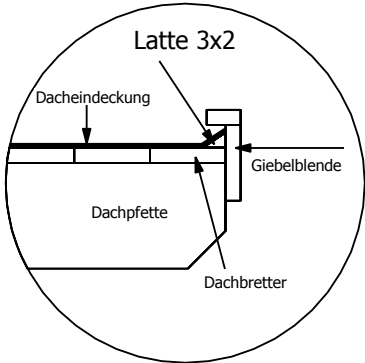
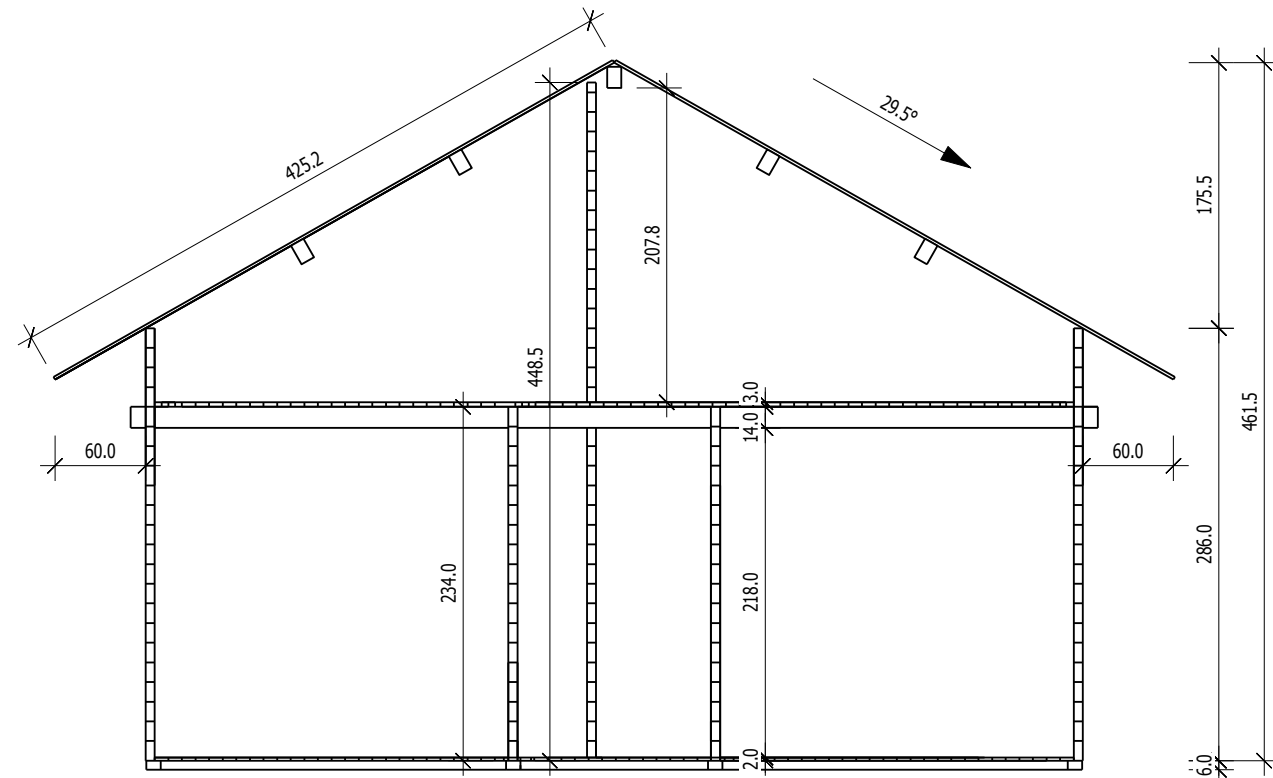

Grundrahmenplan

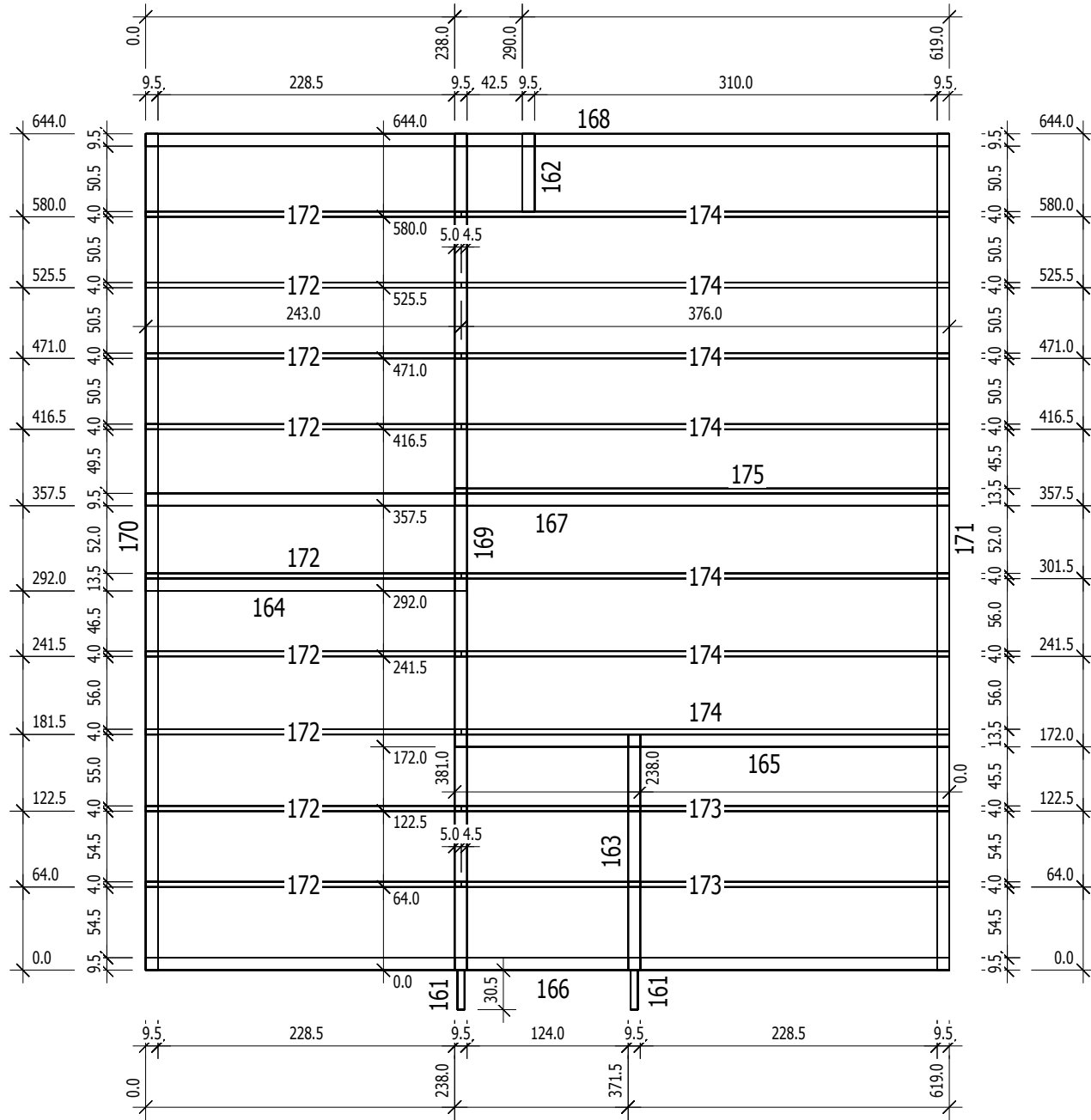

Nr.	B	H	L	Psc
	[cm]	[cm]	[cm]	
=====				
161	5,5	6,0	30,5	2
162	9,5	6,0	60,0	1
163	9,5	6,0	181,5	1
164	9,5	6,0	247,5	1
165	9,5	6,0	381,0	1
166	9,5	6,0	619,0	1
167	9,5	6,0	619,0	1
168	9,5	6,0	619,0	1
169	9,5	6,0	644,0	1
170	9,5	6,0	644,0	1
171	9,5	6,0	644,0	1
172	4,0	6,0	243,0	9
173	4,0	6,0	376,0	2
174	4,0	6,0	376,0	7
175	4,0	6,0	381,0	1

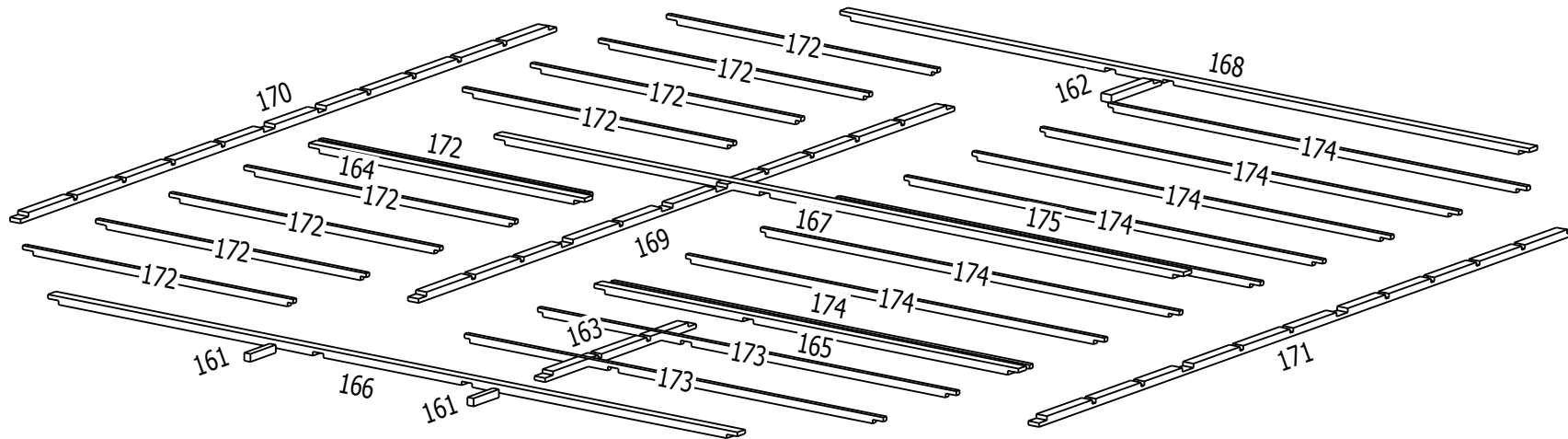

Hobeldielenplan

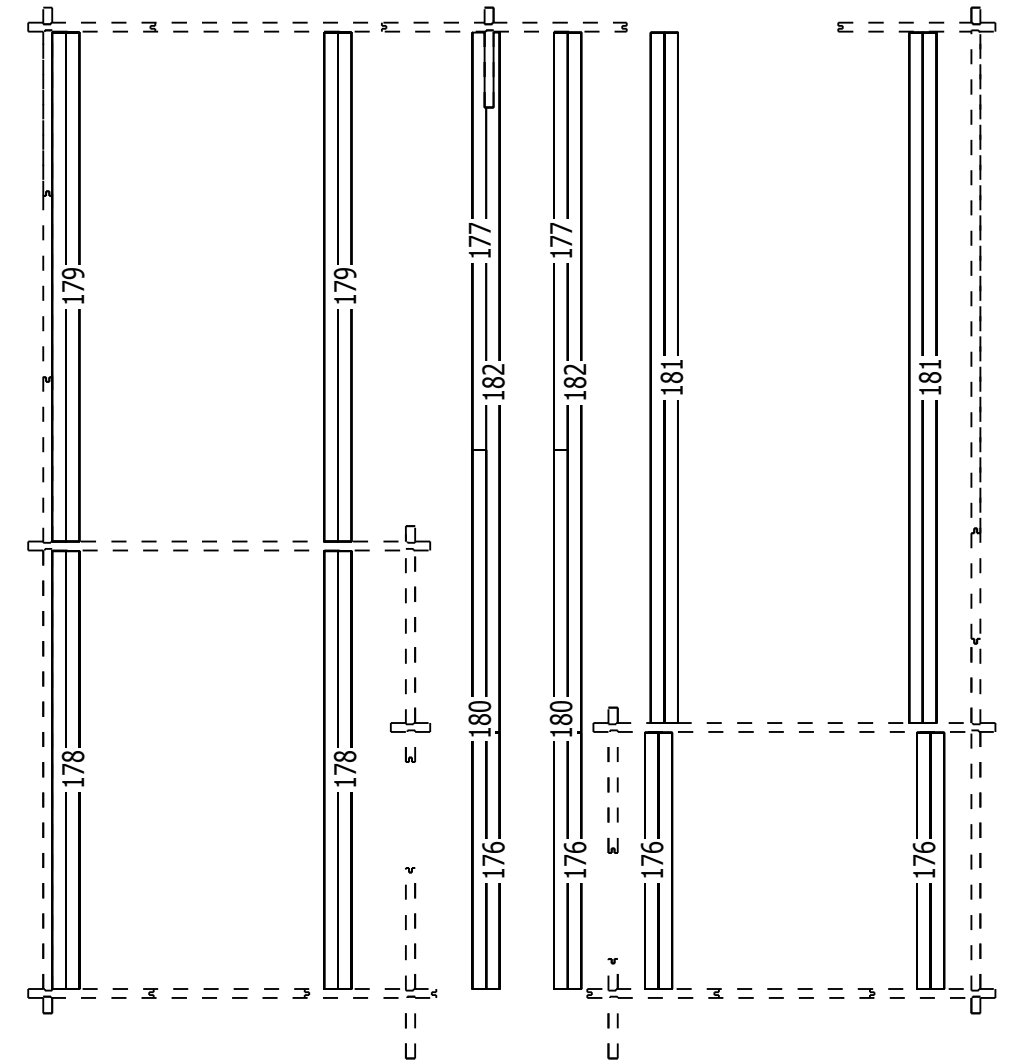

Nr.	B	H	L	Psc
	[cm]	[cm]	[cm]	
176	9,0	2,0	169,5	35
177	9,0	2,0	276,0	7
178	9,0	2,0	289,5	27
179	9,0	2,0	336,5	27
180	9,0	2,0	356,5	7
181	9,0	2,0	456,5	28
182	9,0	2,0	463,0	8

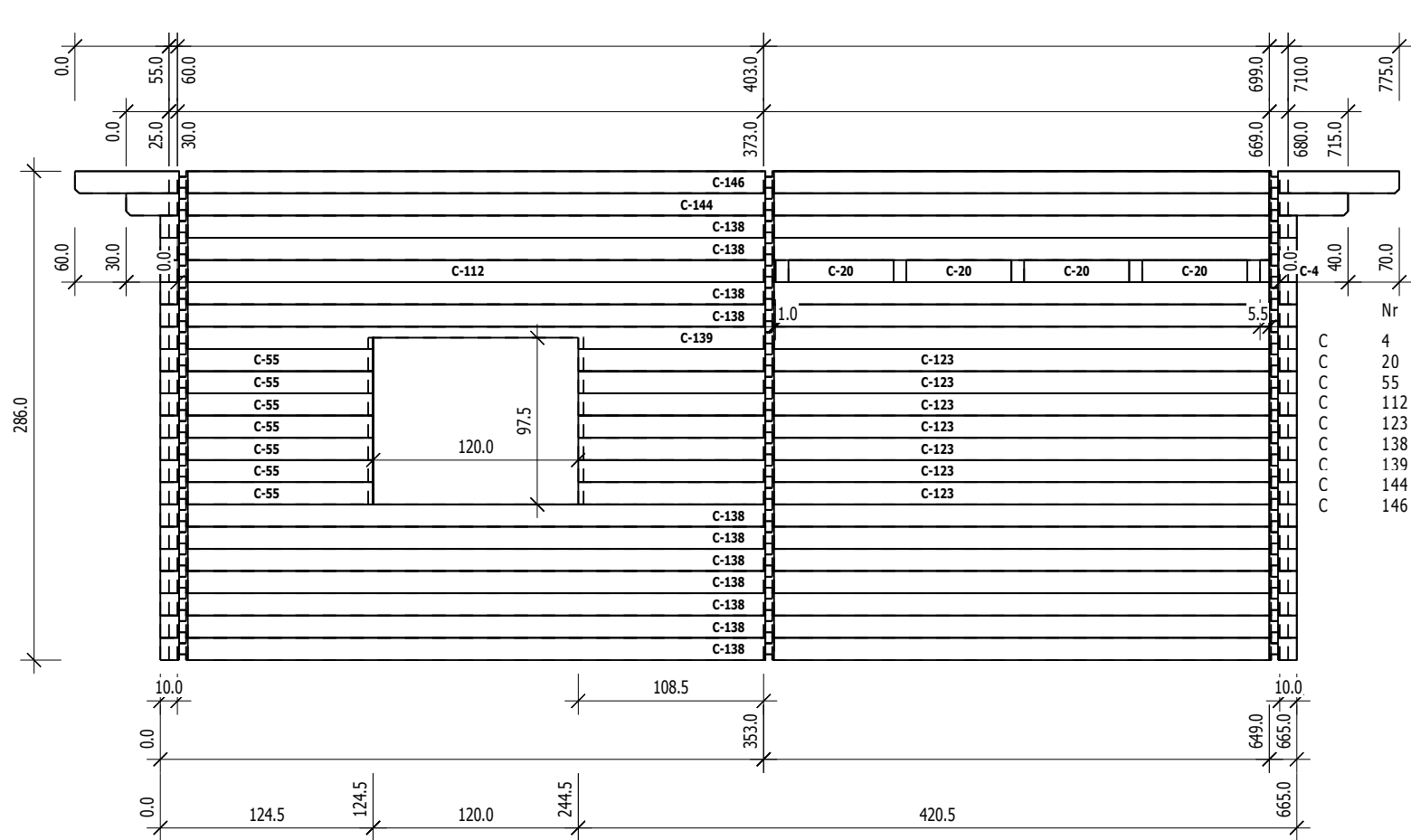

	Nr	H	L	Psc
K	28	13.0	66.0	34
K	29	6,5	66,0	1

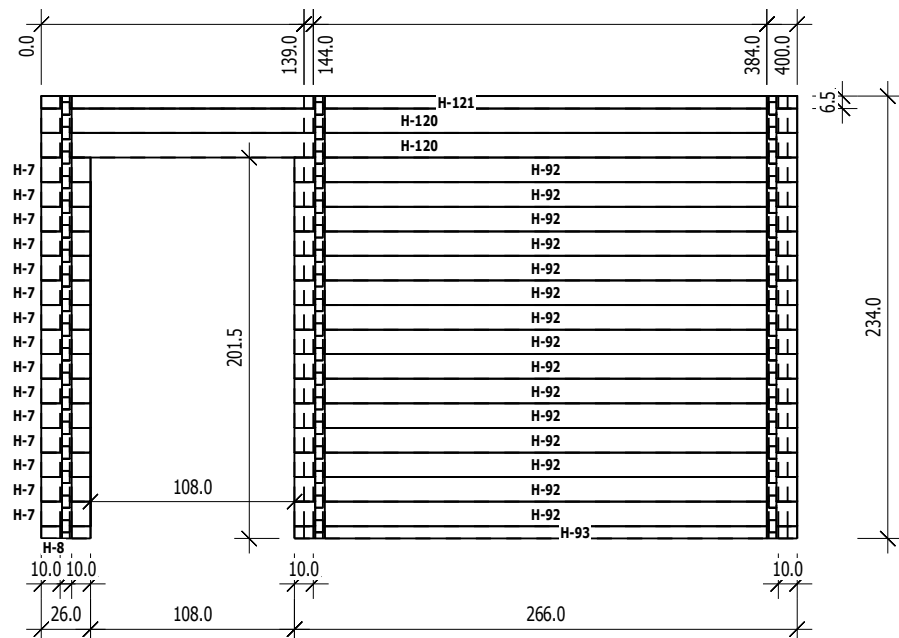
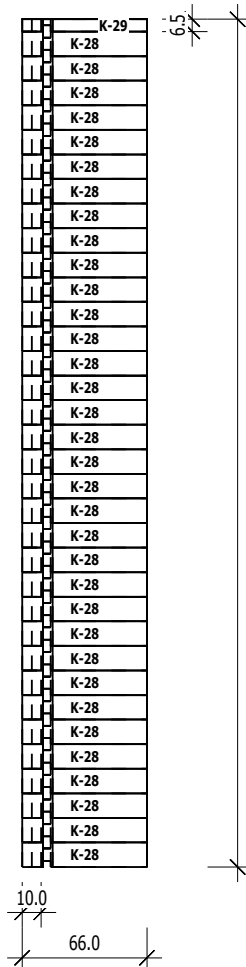

	Nr	H	L	Psc
H	7	13.0	26.0	15
H	8	6.5	26.0	1
H	92	13.0	266.0	15
H	93	6.5	266.0	1
H	120	13.0	400.0	2
H	121	6,5	400,0	1

	Nr	H	L	Psc
D	5	13.0	21.5	1
D	19	13.0	59.5	1
D	21	13.0	61.5	1
D	22	13.0	61.5	3
D	88	13.0	247.5	7
D	107	13.0	293.0	1
D	111	13.0	347.5	7
D	140	13.0	665.0	2
D	141	13.0	665.0	2
D	142	13.0	665.0	7
D	143	13.0	665.0	1
D	145	13.0	715.0	1
D	147	13,0	775,0	1

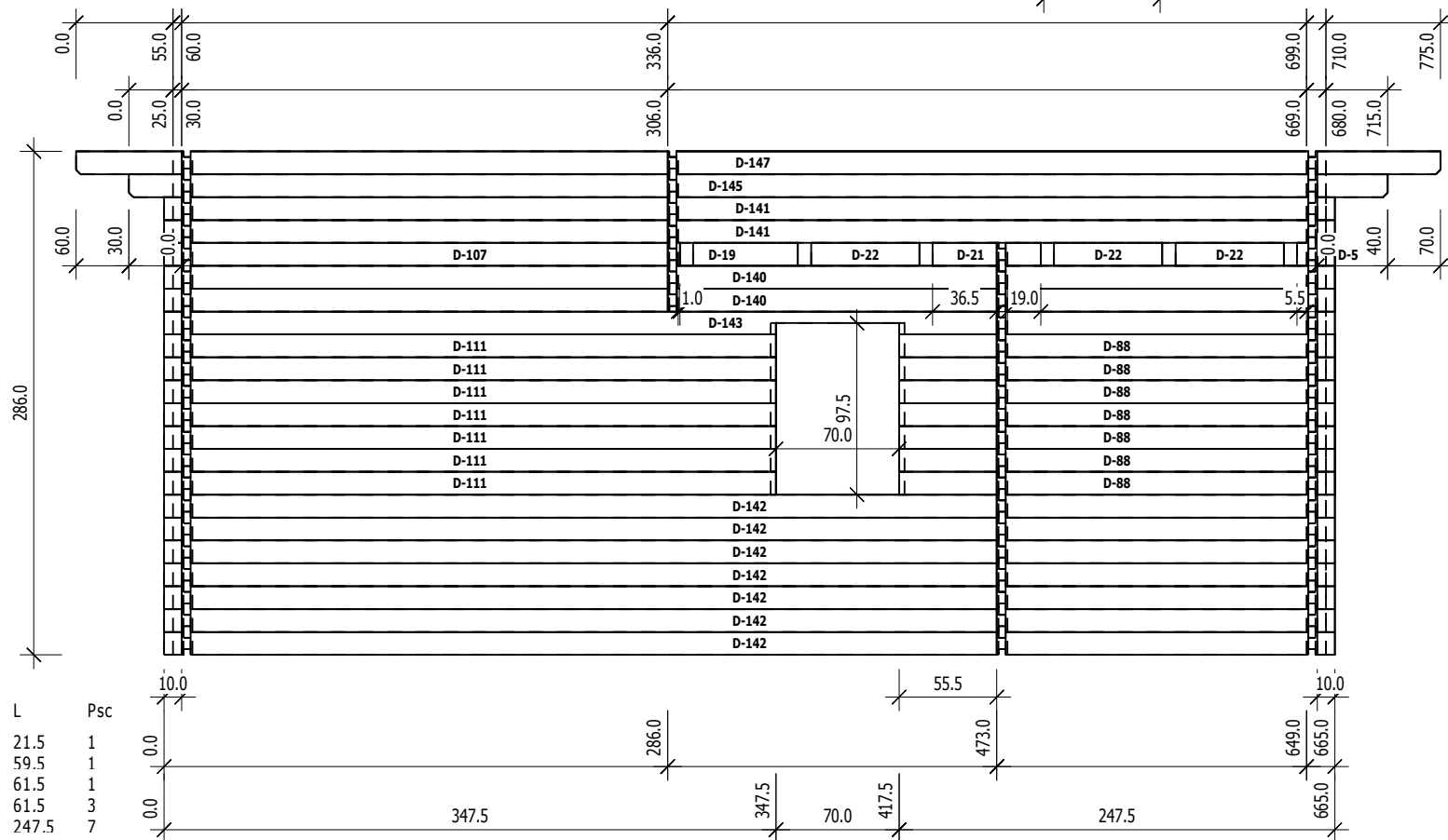

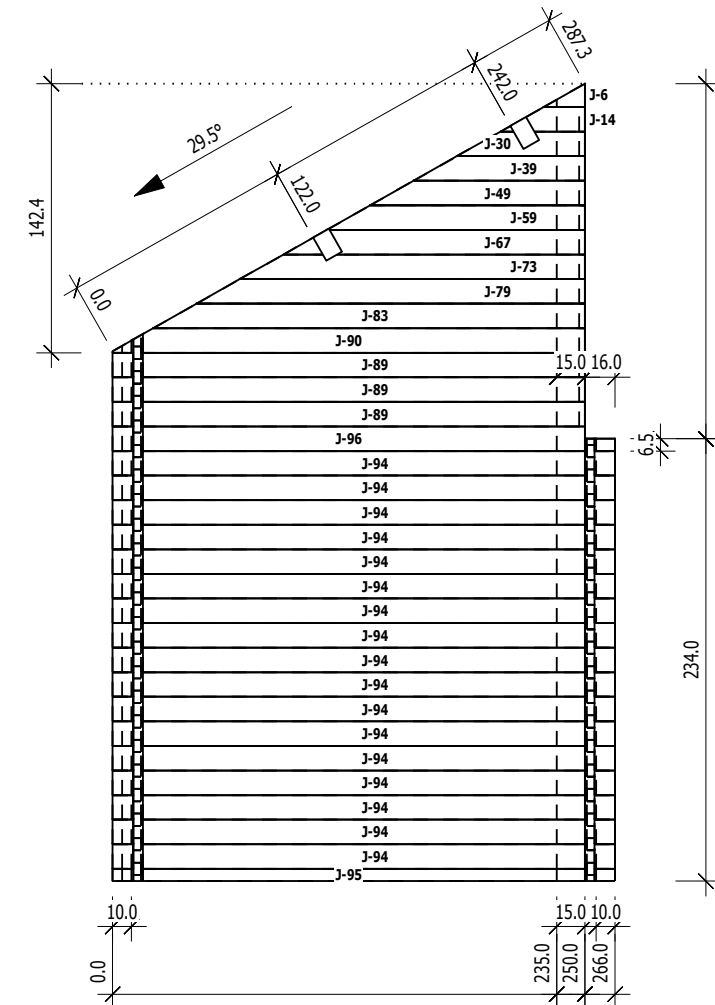
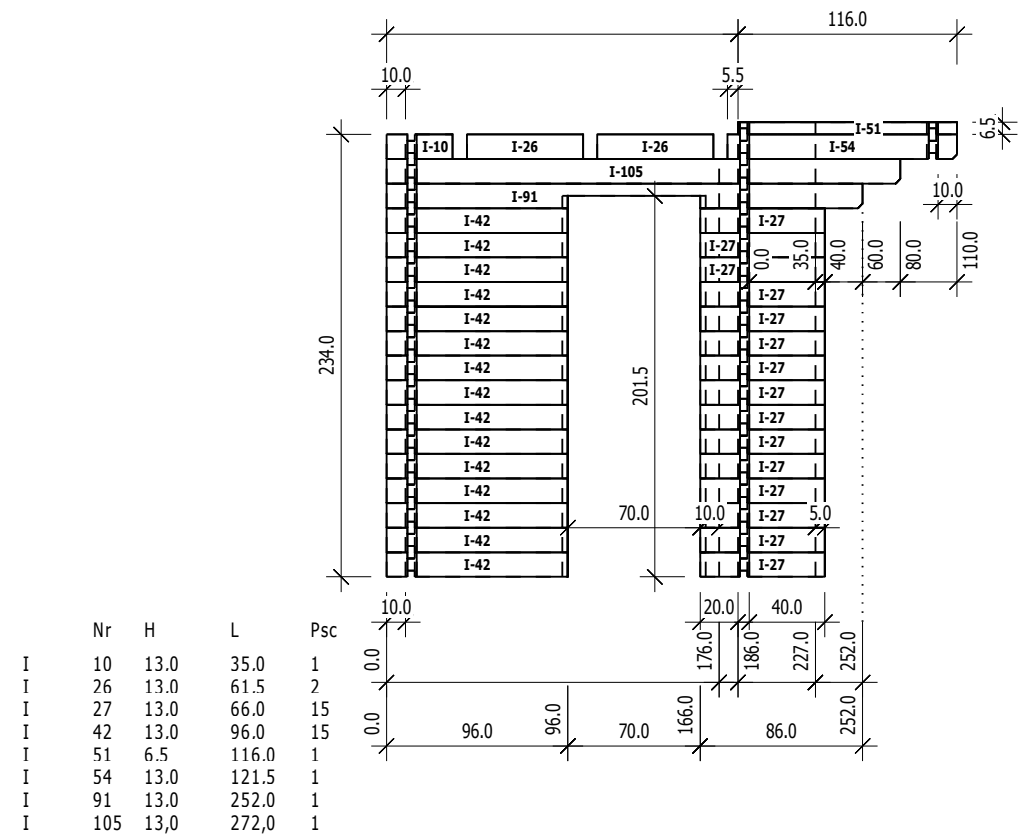
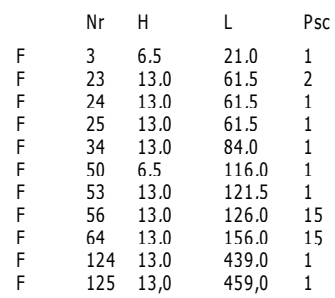

	Nr	H	L	Psc
J	6	12.4	21.9	1
J	14	13.0	44.8	1
J	30	13.0	67.8	1
J	39	13.0	90.7	1
J	49	13.0	113.7	1
J	59	13.0	136.7	1
J	67	13.0	159.6	1
J	73	13.0	182.6	1
J	79	13.0	205.6	1
J	83	13.0	228.5	1
J	89	13.0	250.0	3
J	90	13.0	250.0	1
J	94	13.0	266.0	17
J	95	6.5	266.0	1
J	96	13.0	266.0	1

