

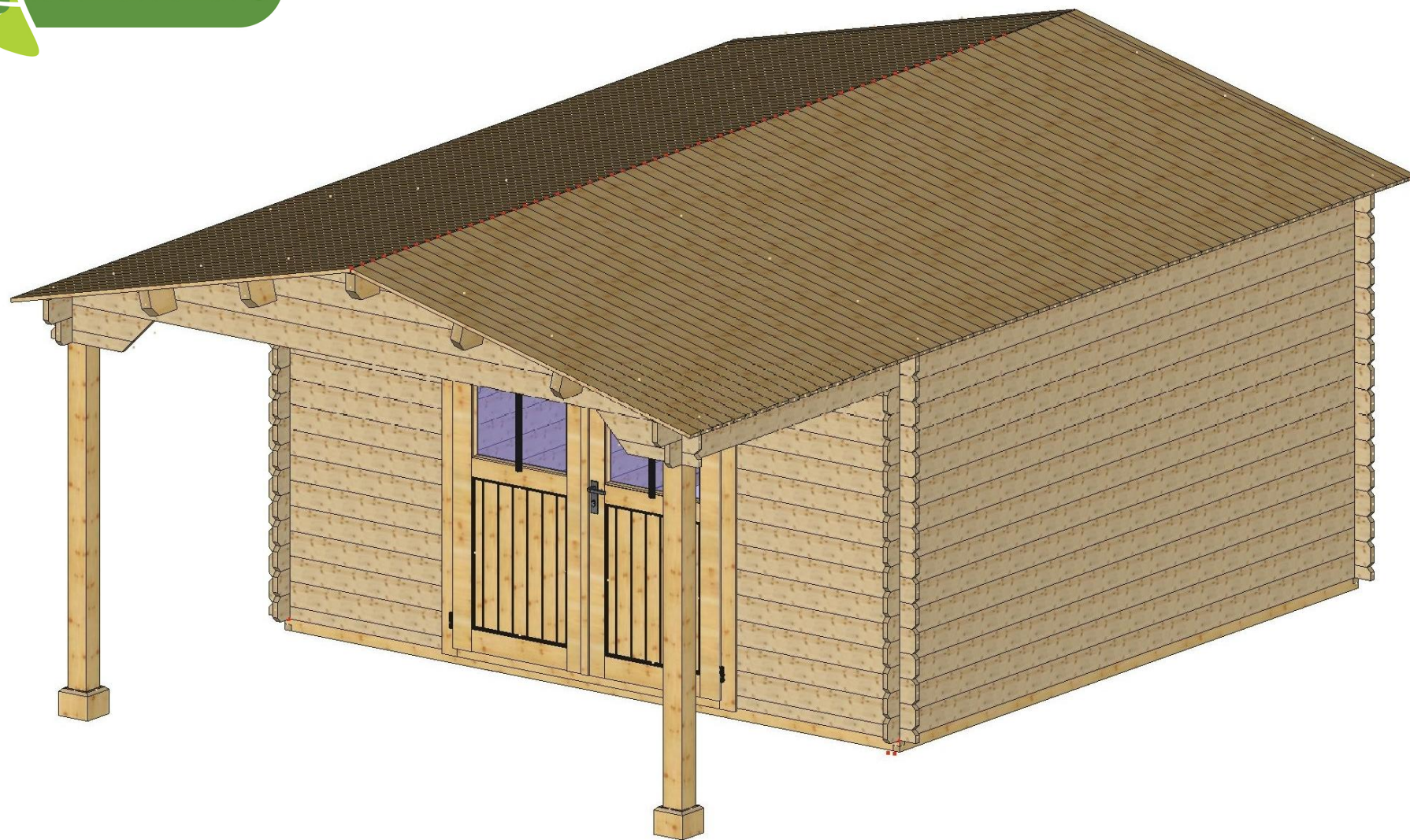

3,0



Bemerkung: die Ansicht von Turen, Fenster und anderen Teilen kann abweichen von diesem Bild

Grundriss

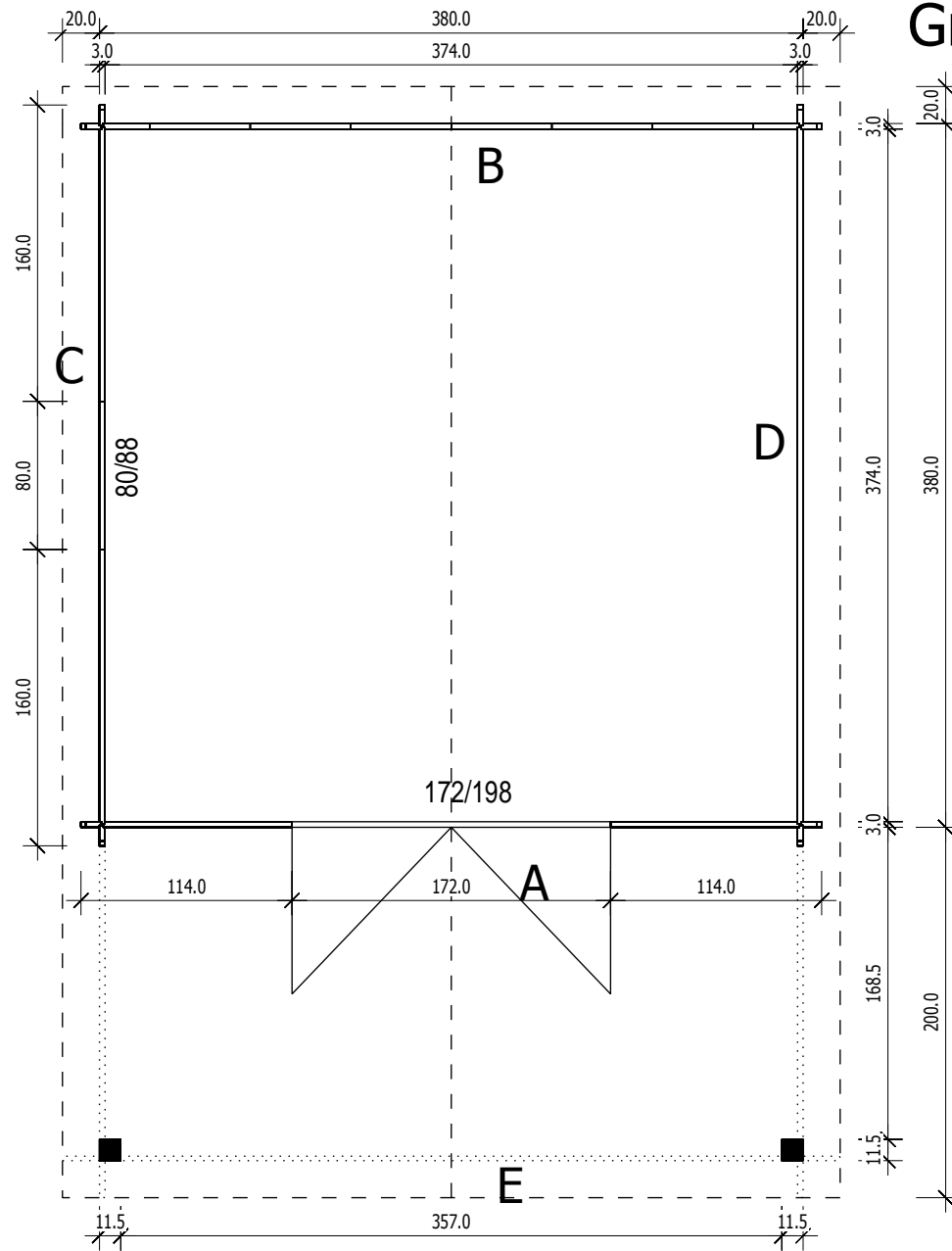

Schnitt

3,0

Gegnes 6,0x14,0

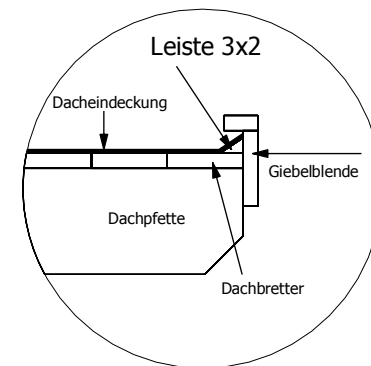
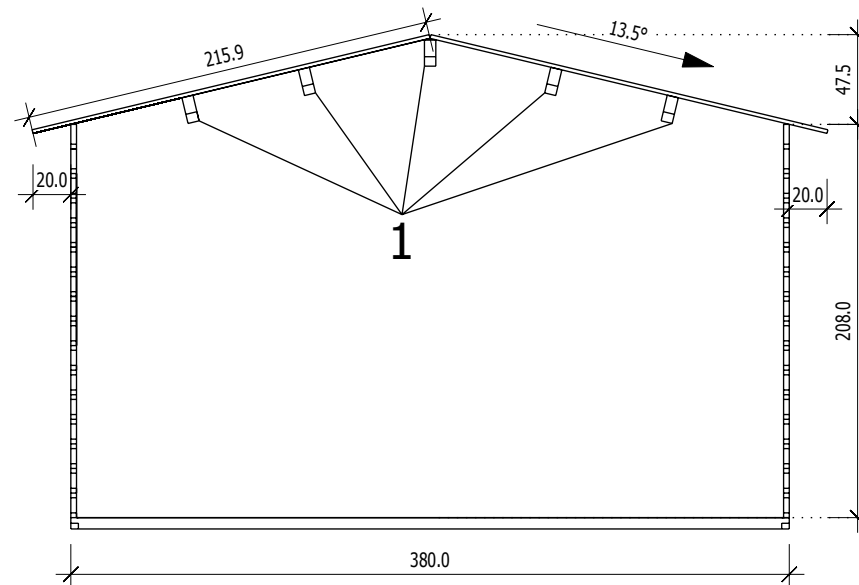

Grundrahmenplan

3,0

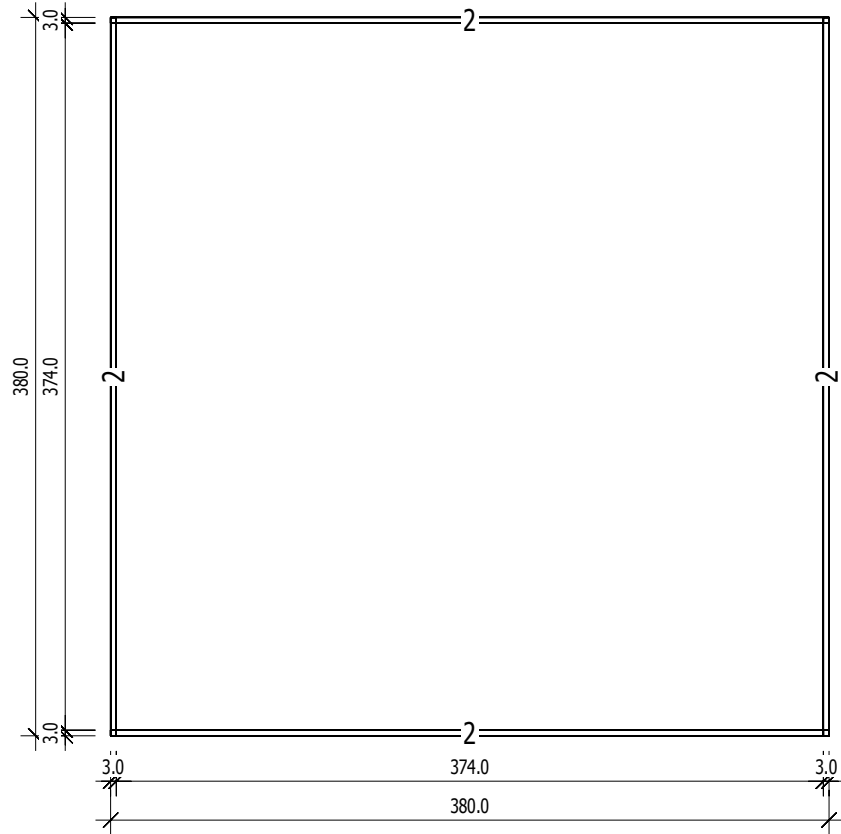

Nr.	B	H	L	Psc
	[cm]	[cm]	[cm]	
2	3,0	6,0	380,0	4

