

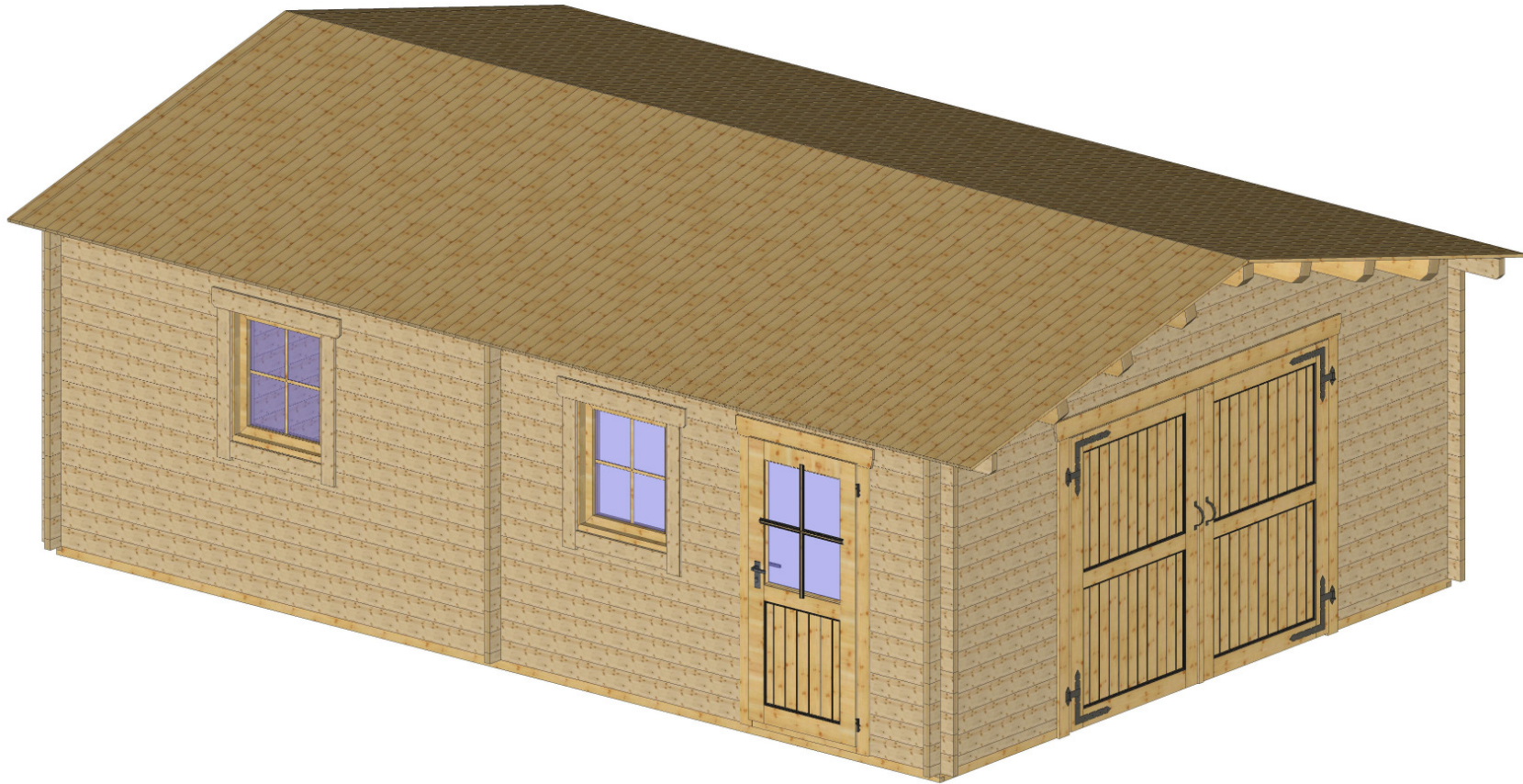

TG-5070



Bemerkung: die Ansicht von Turen, Fenster und anderen Teilen kann abweichen von diesem Bild

TG-5070

Grundriss

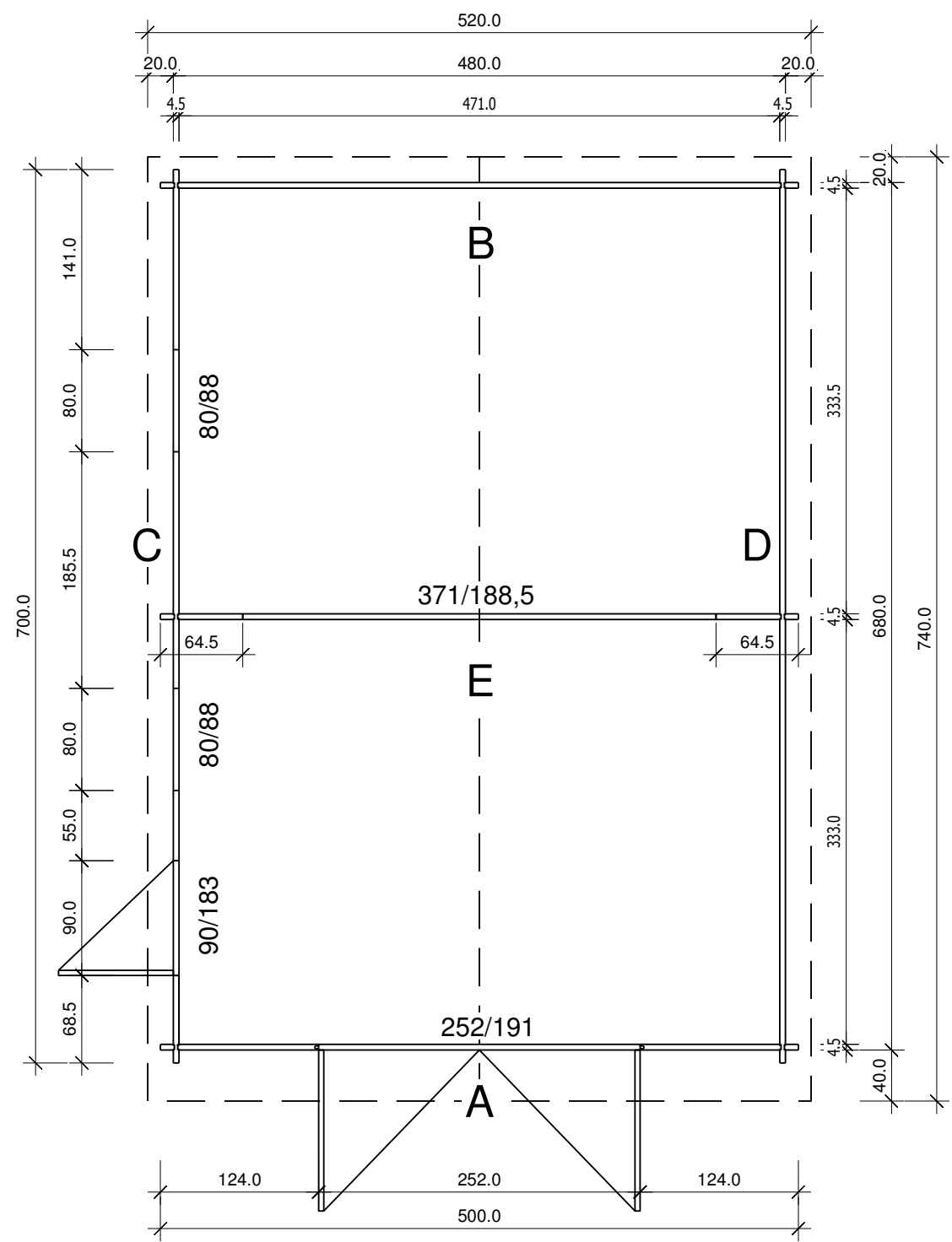

Schnitt

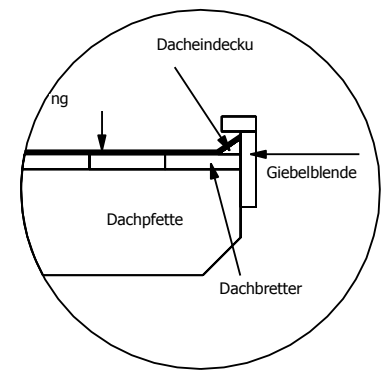
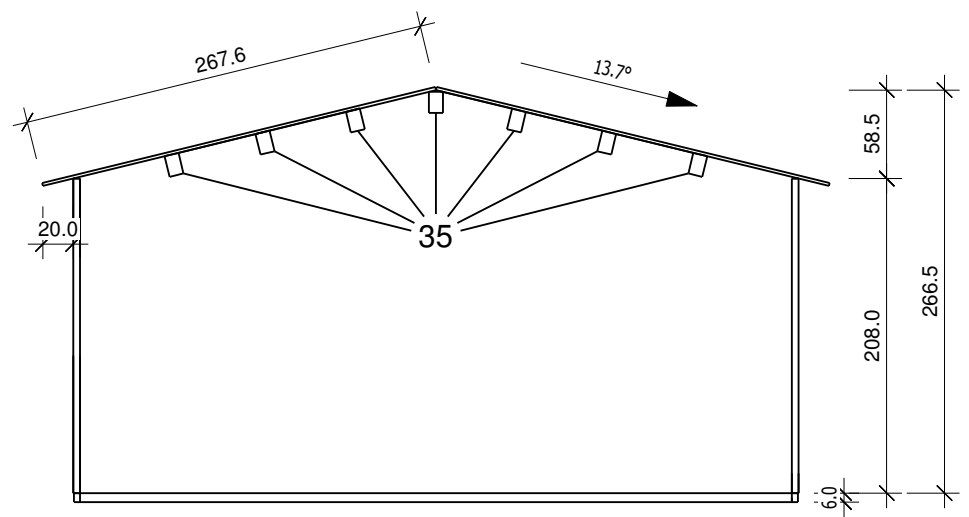

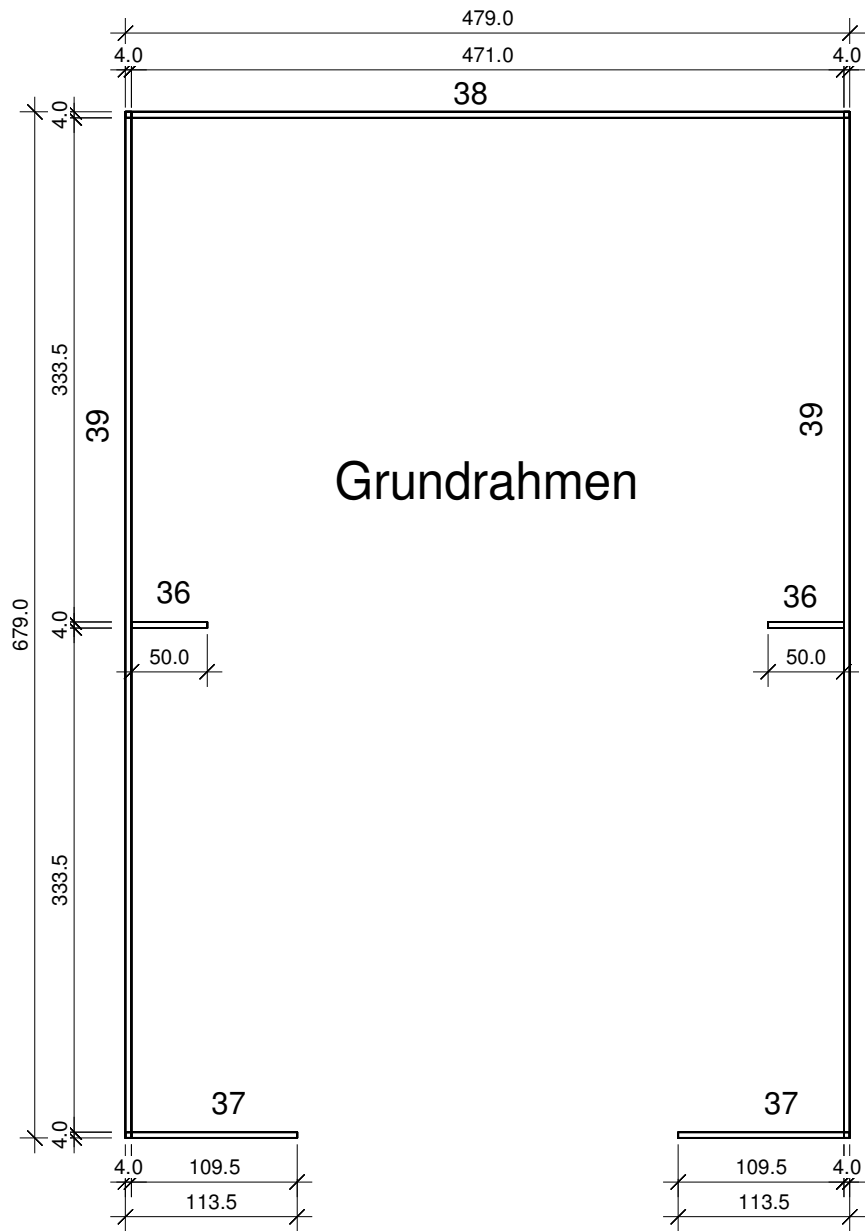

Nr.	B [cm]	H [cm]	L [cm]	Psc
36	4,0	6,0	50,0	2
37	4,0	6,0	113,5	2
38	4,0	6,0	479,0	1
39	4,0	6,0	679,0	2

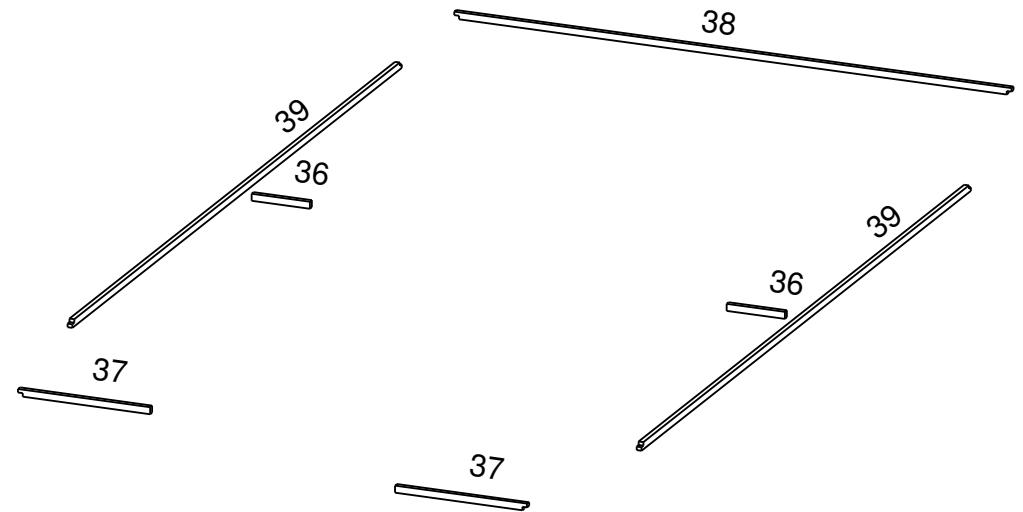

A
M 1:40

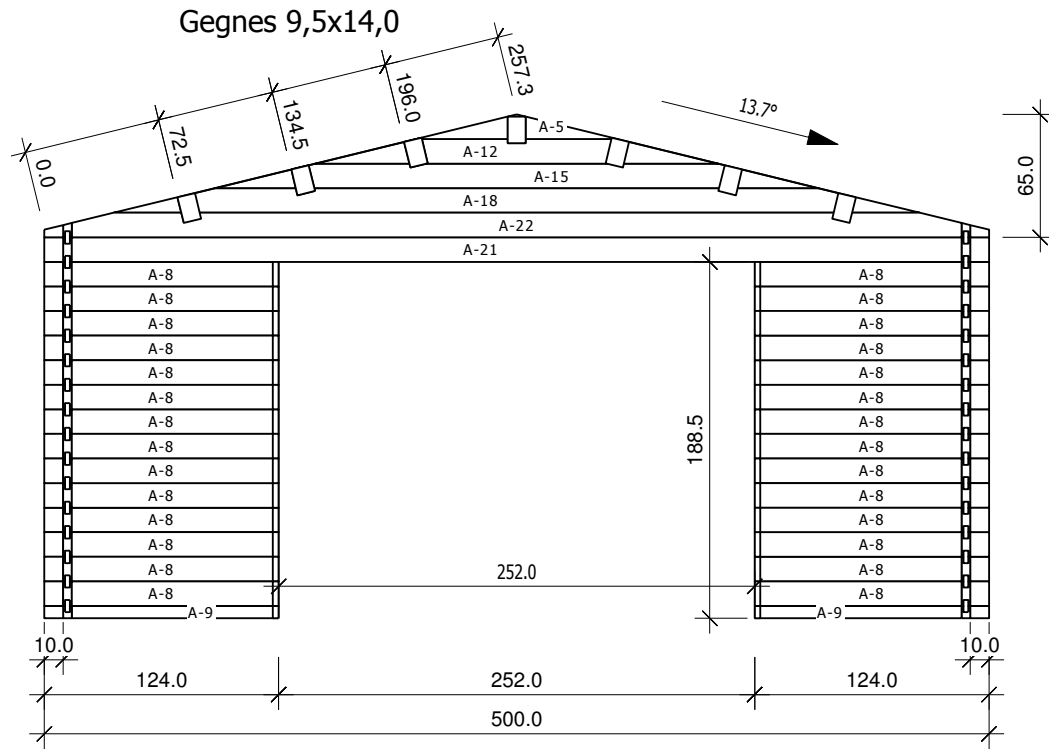

Nr	H	L	Psc
A 5	13,0	106,7	1
A 8	13,0	124,0	28
A 9	6,5	124,0	2
A 12	13,0	213,3	1
A 15	13,0	320,0	1
A 18	13,0	426,7	1
A 21	13,0	500,0	1
A 22	13,0	500,0	1

Nr	H	L	Psc
B 6	13,0	106,7	1
B 13	13,0	213,3	1
B 16	13,0	320,0	1
B 19	13,0	426,7	1
B 23	13,0	500,0	15
B 24	6,5	500,0	1
B 25	13,0	500,0	1

B
M 1:40

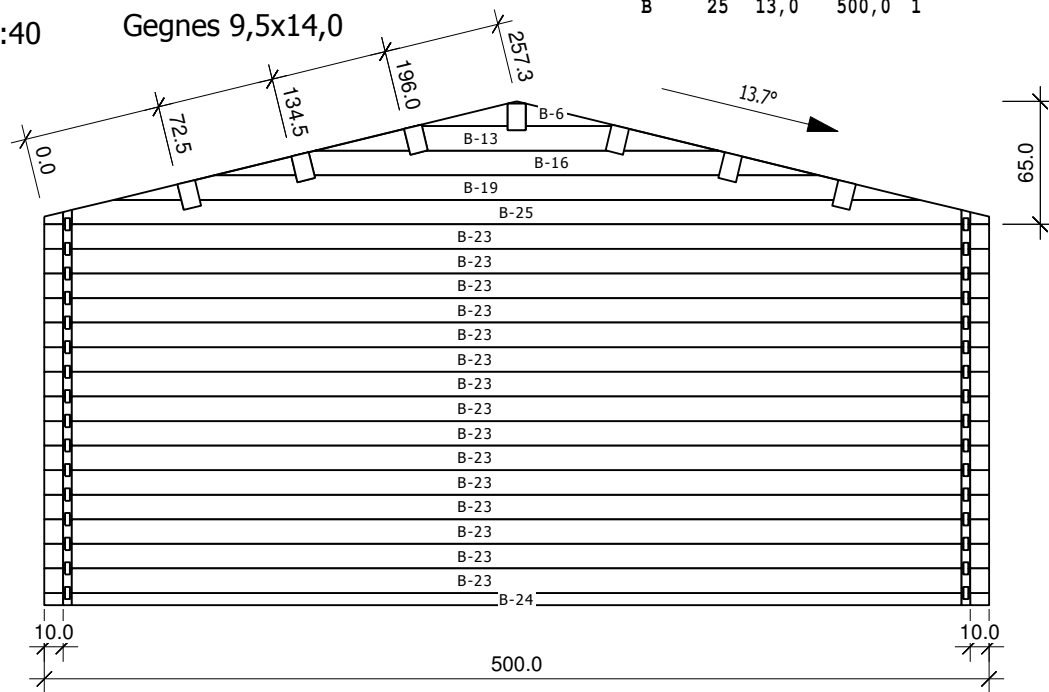

C
M 1:40

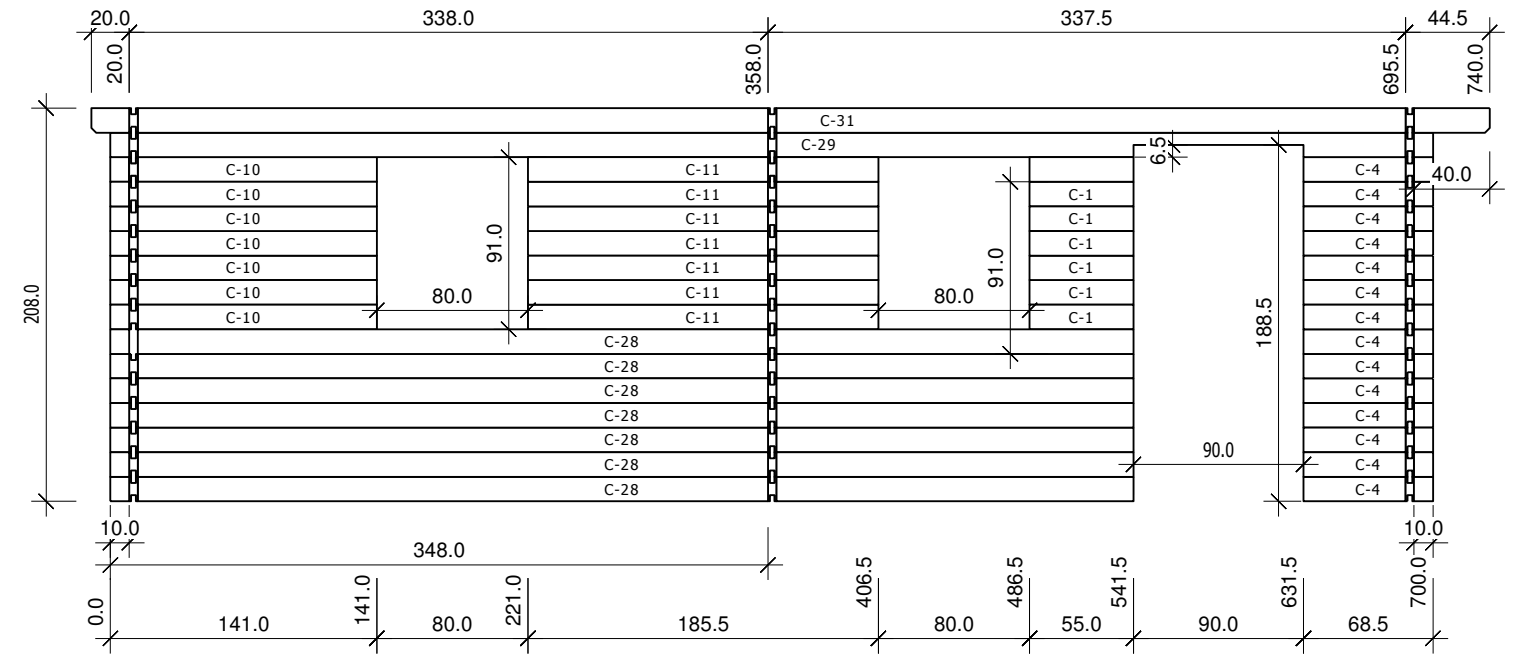

Nr	H	L	Psc
C 1	13,0	55,0	7
C 4	13,0	68,5	14
C 10	13,0	141,0	7
C 11	13,0	185,5	7
C 28	13,0	541,5	7
C 29	13,0	700,0	1
C 31	13,0	740,0	1

Nr	H	L	Psc
D 30	13,0	700,0	15
D 32	13,0	740,0	1

D
M 1:40

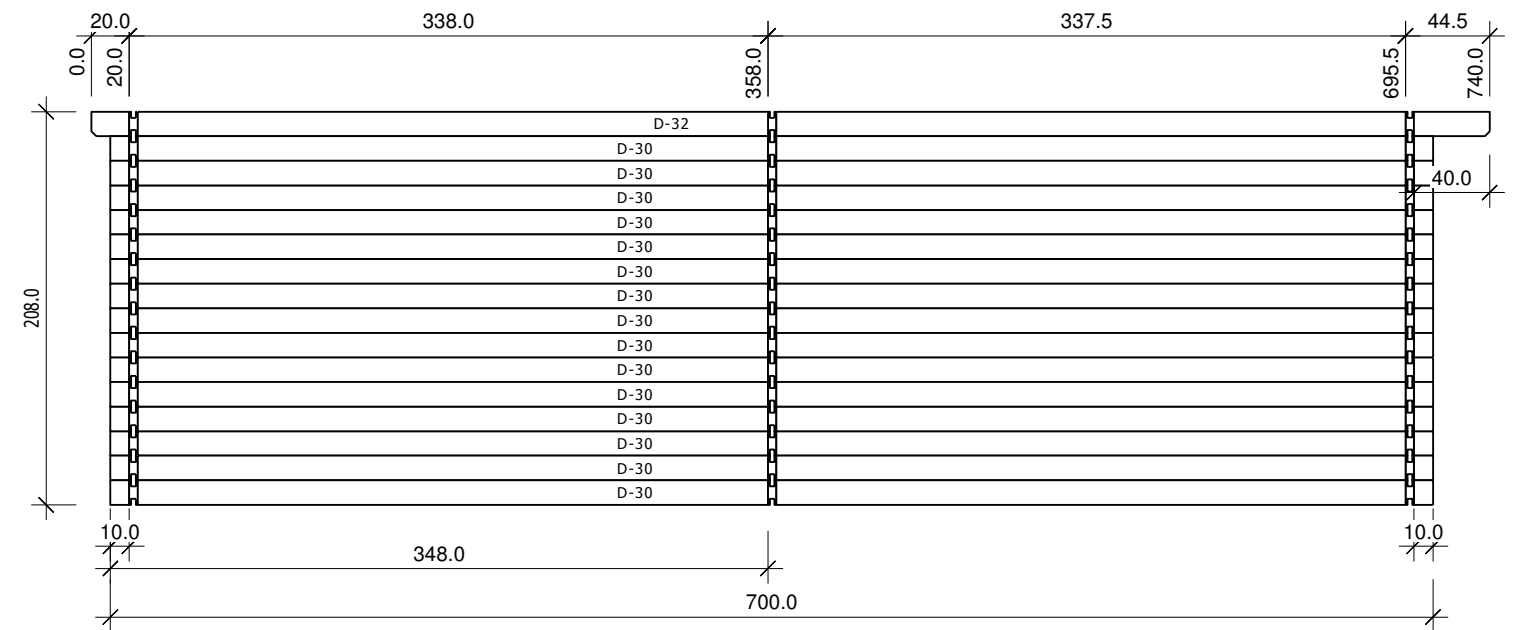

E

M 1:40

4,5

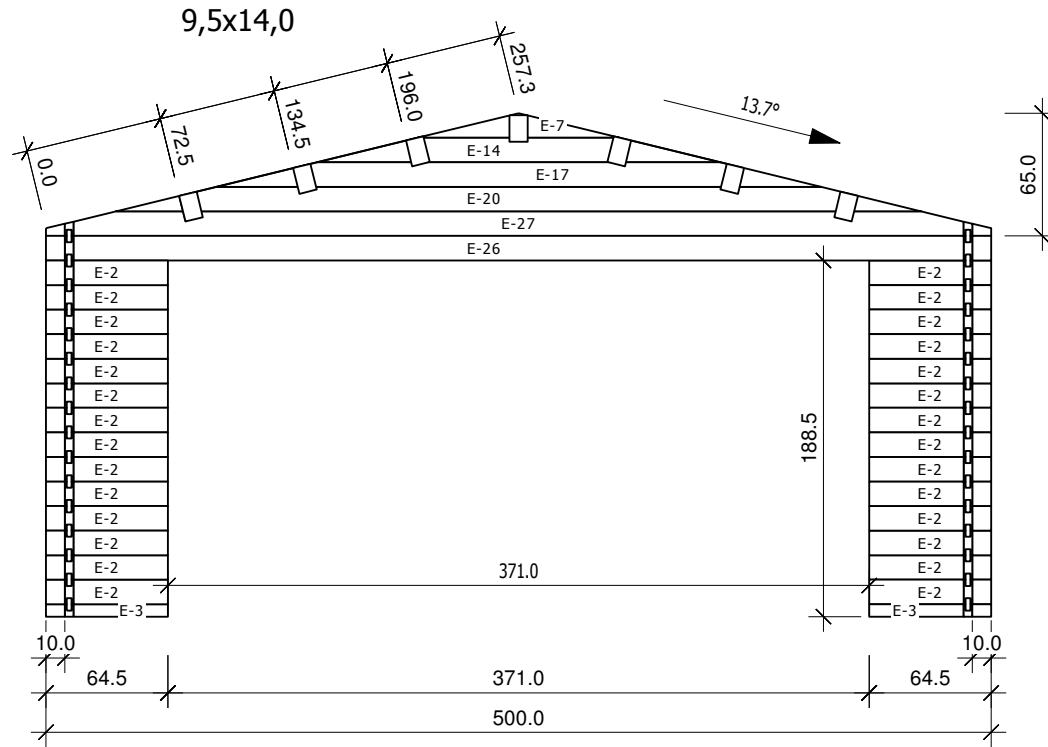

	Nr	H	L	Psc
E	2	13,0	64,5	28
E	3	6,5	64,5	2
E	7	13,0	106,7	1
E	14	13,0	213,3	1
E	17	13,0	320,0	1
E	20	13,0	426,7	1
E	26	13,0	500,0	1
E	27	13,0	500,0	1