

Bemerkung: die Ansicht von Turen, Fenster und anderen Teilen kann abweichen von diesem Bild

# Grundriss

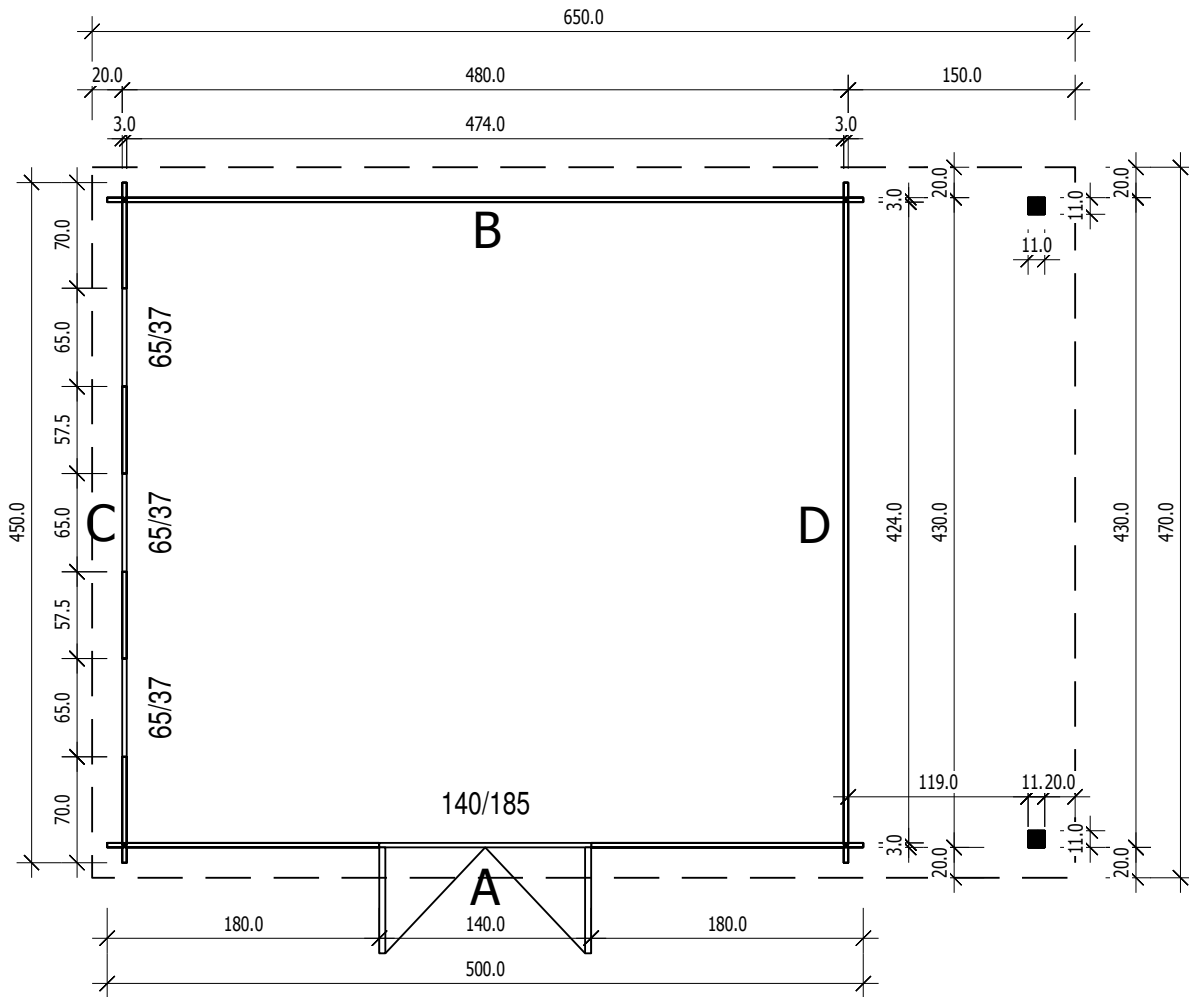

# Schnitt

3,0

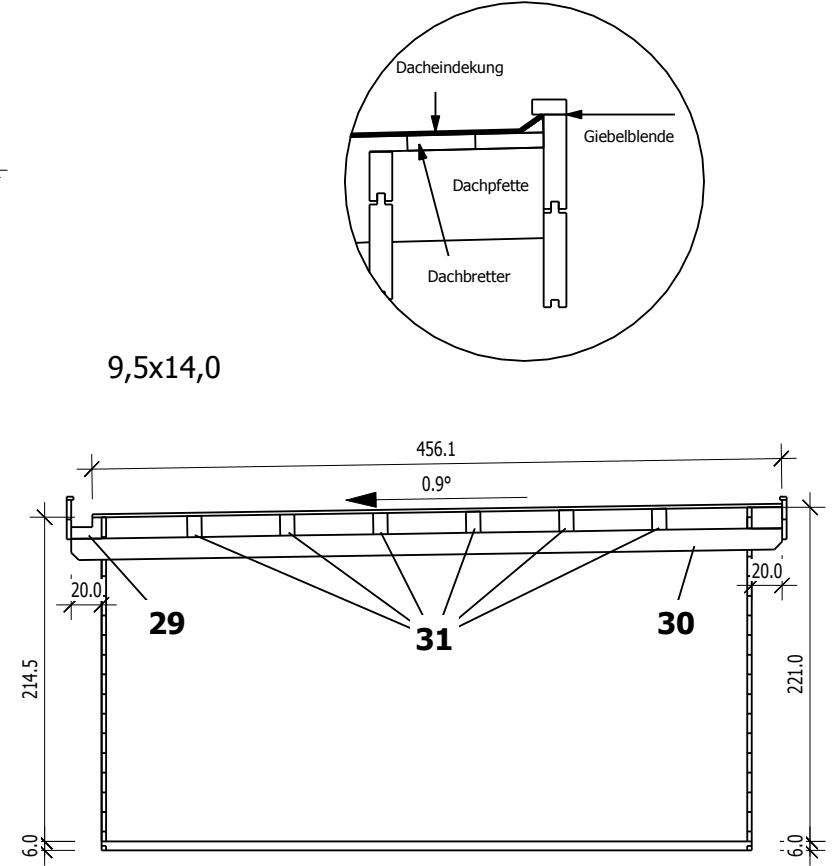

# Grundrahmenplan

3,0

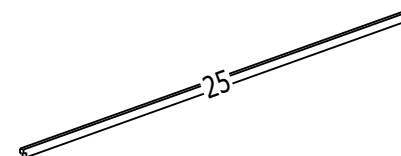
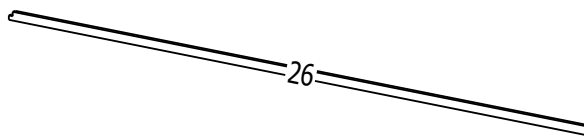
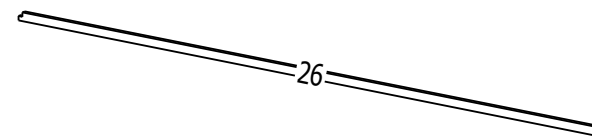
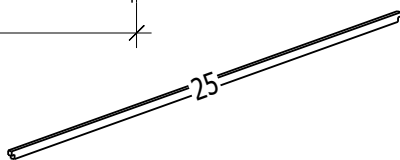
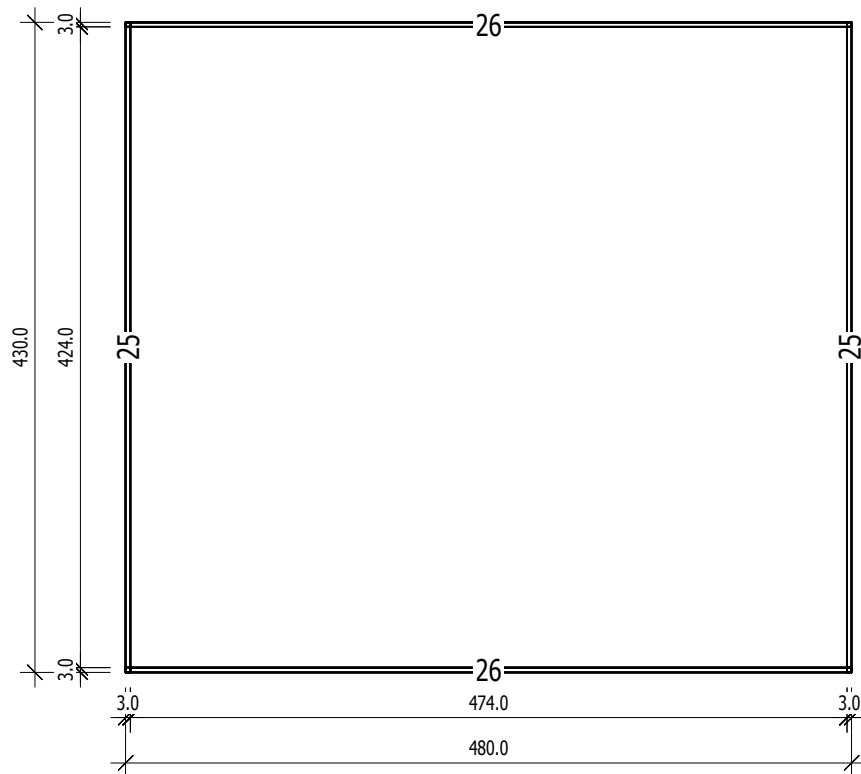

**A**

M 1:40

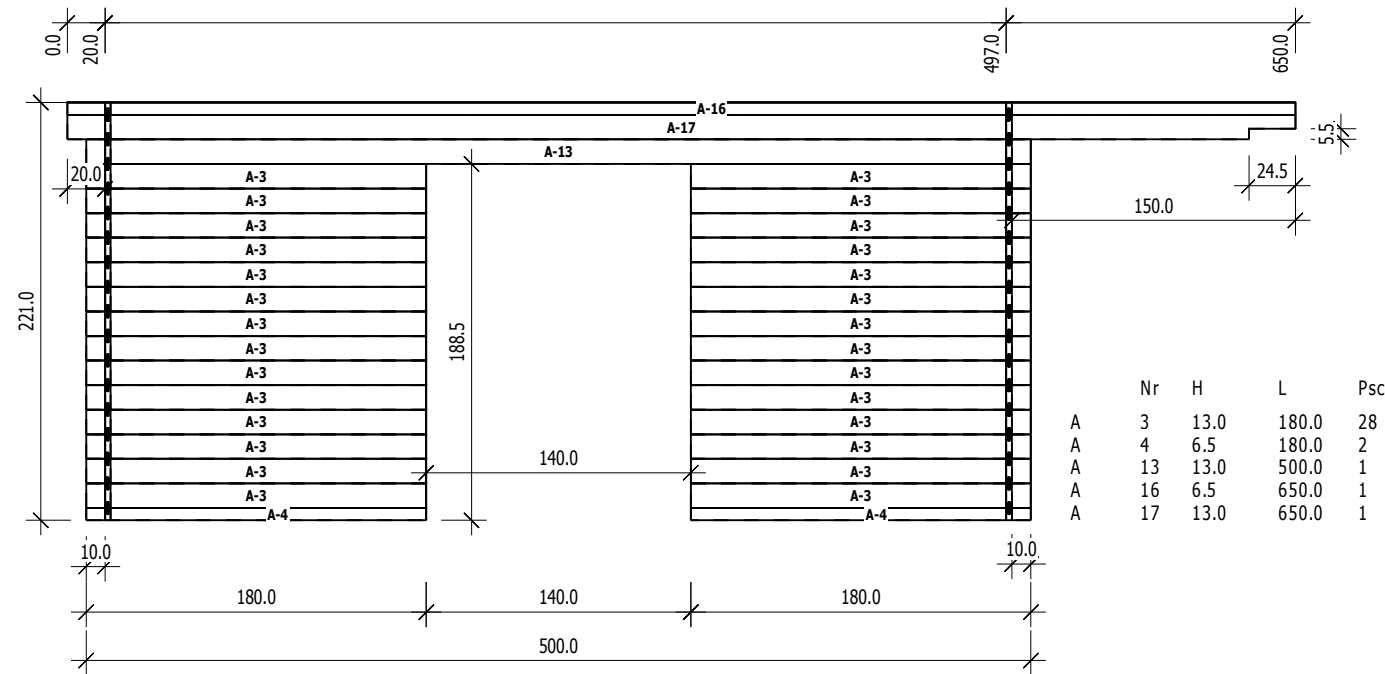
**C**

M 1:40 Gegnes 9,5x14,0

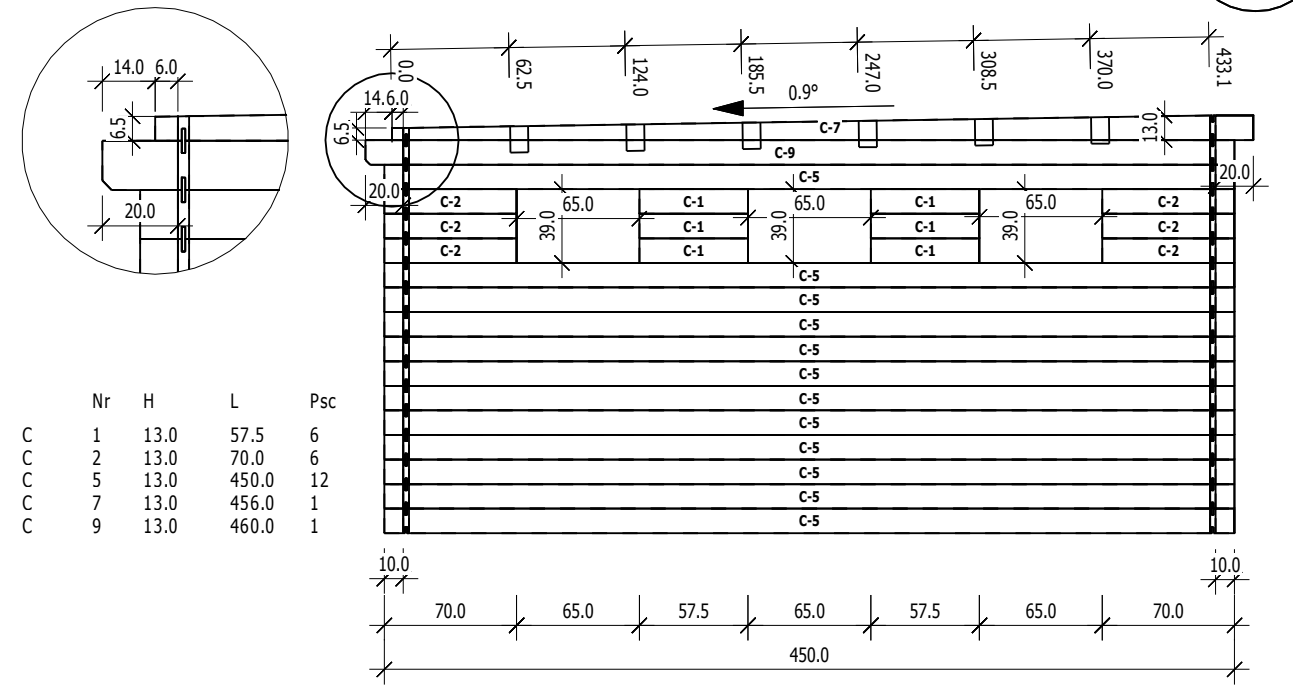

3,0

**B**

M 1:40

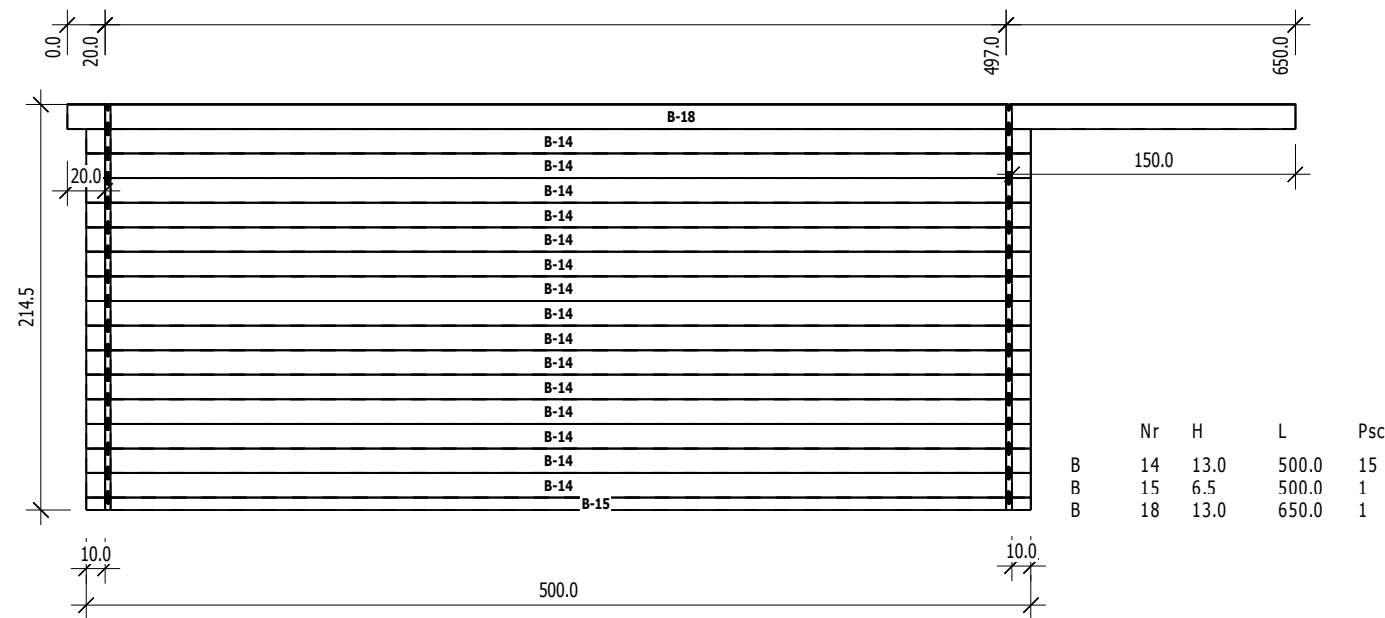
**D**

M 1:40 Gegnes 9,5x14,0

