



Bemerkung: die Ansicht von Turen, Fenster und anderen Teilen kann abweichen von diesem Bild



3,0

Grundriss

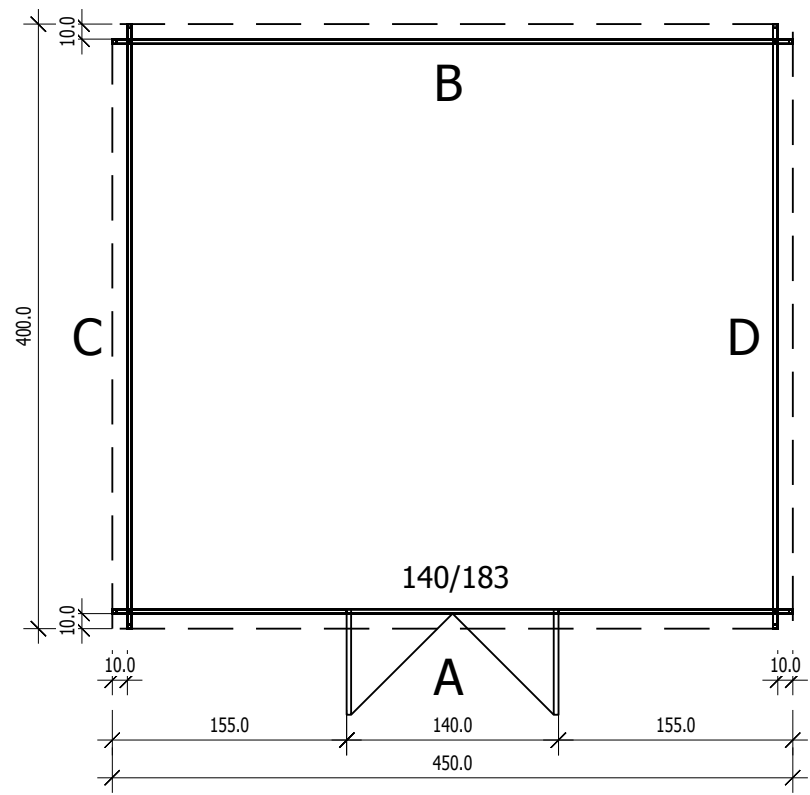

Schnitt

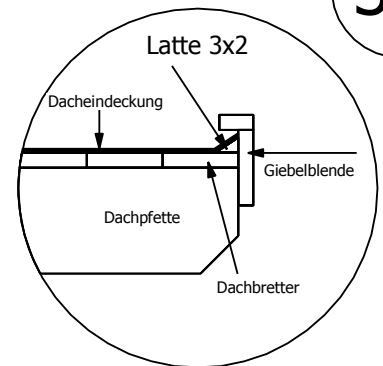
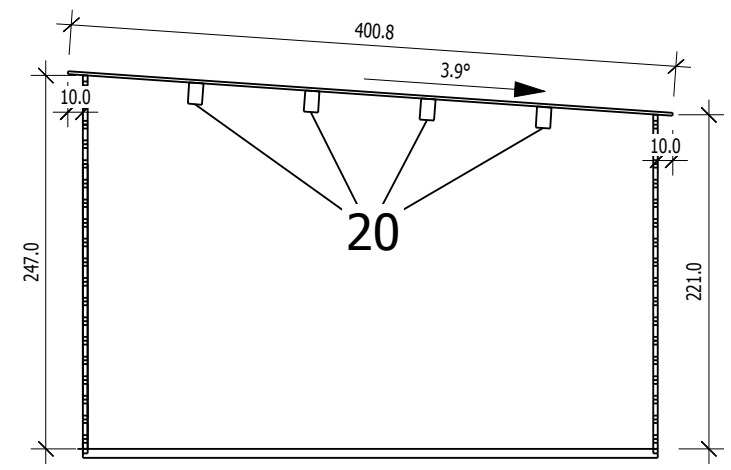

Grundrahmenplan

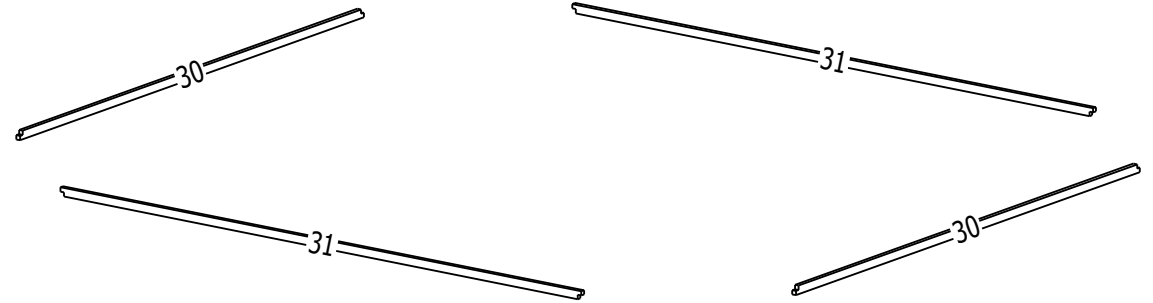
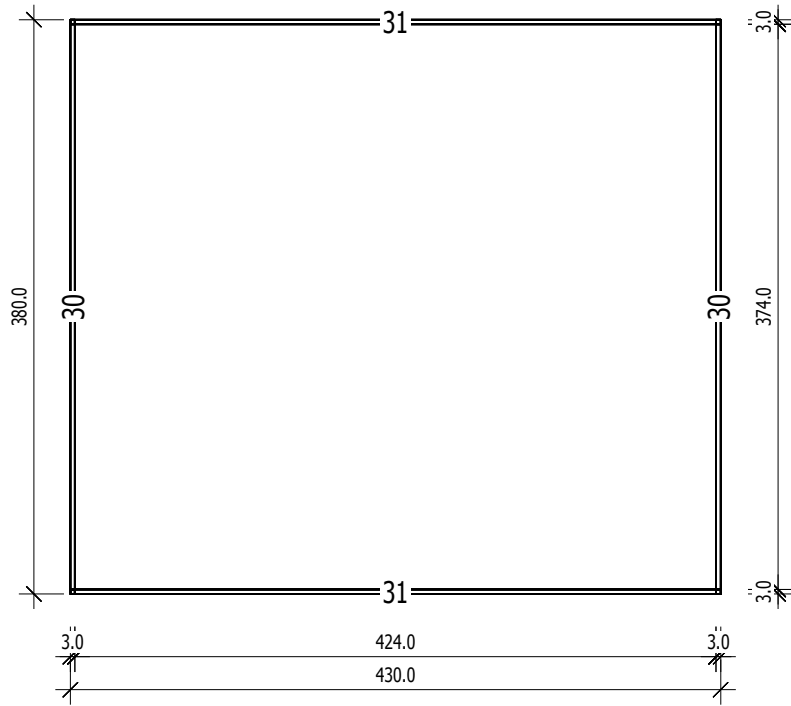

	Nr	H	L	Psc
A	1	13.0	155.0	28
A	2	6.5	155.0	2
A	11	13.0	450.0	3
A	12	13.0	450.0	1
A	13	6,5	450,0	1

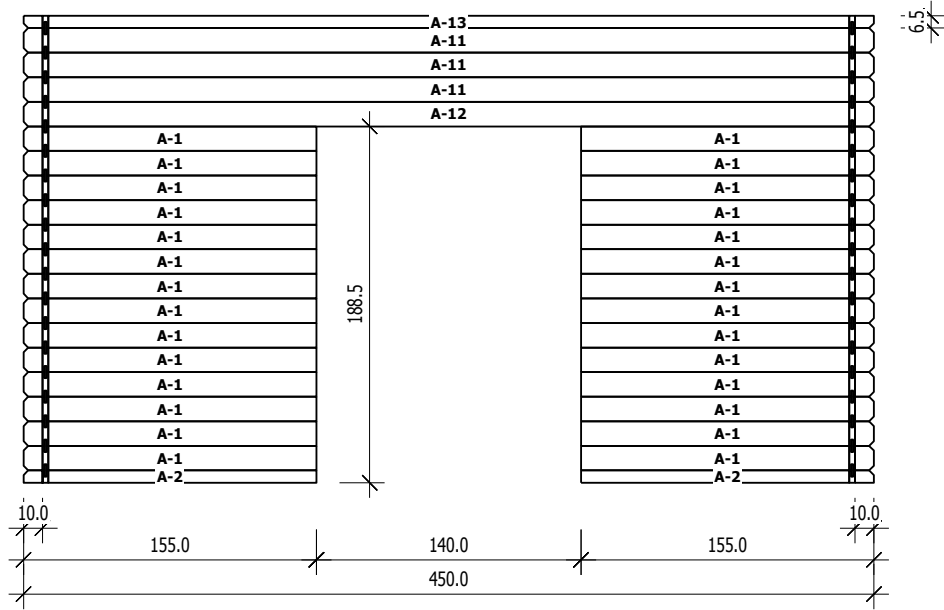

1/59

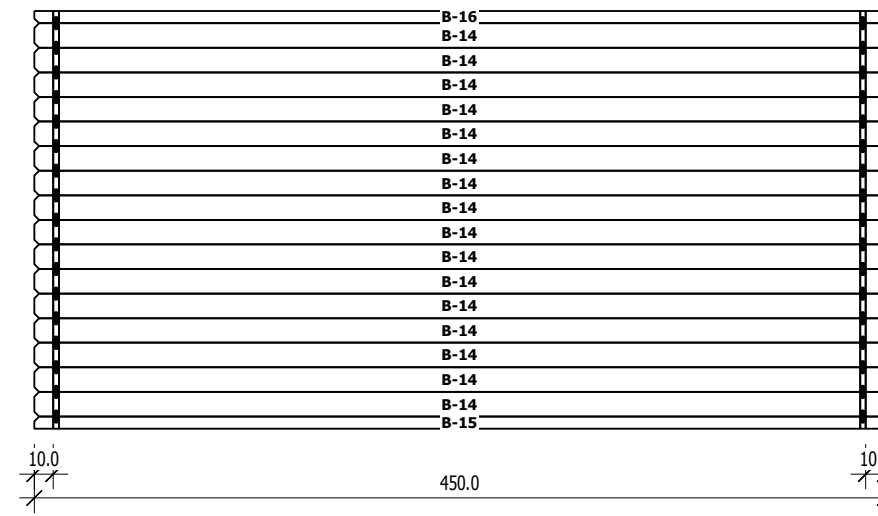

1/59

	Nr	H	L	Psc
B	14	13.0	450.0	16
B	15	6.5	450.0	1
B	16	6,5	450,0	1

	Nr	H	L	Psc
C	3	13.0	201.5	1
C	5	13.0	388.0	1
C	7	13.0	400.0	16
C	8	13,0	400,0	1

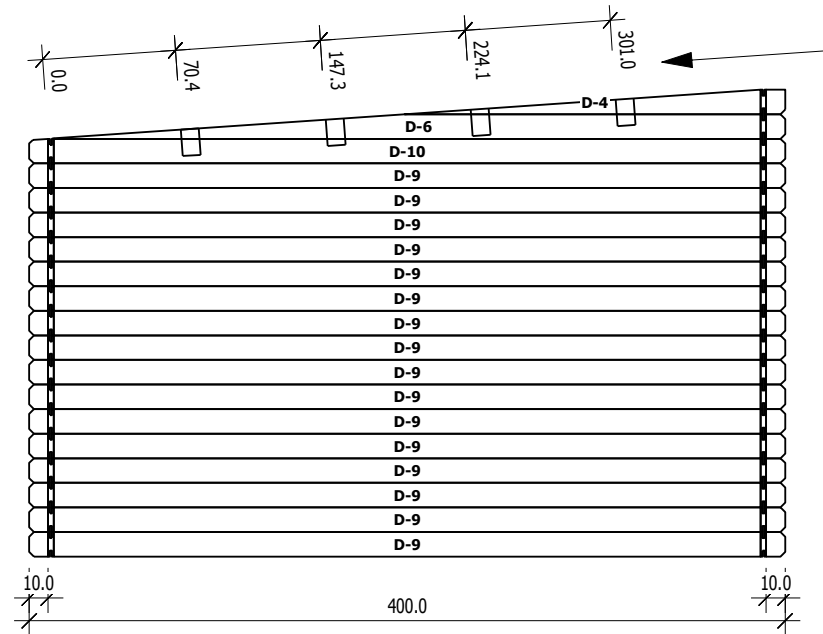
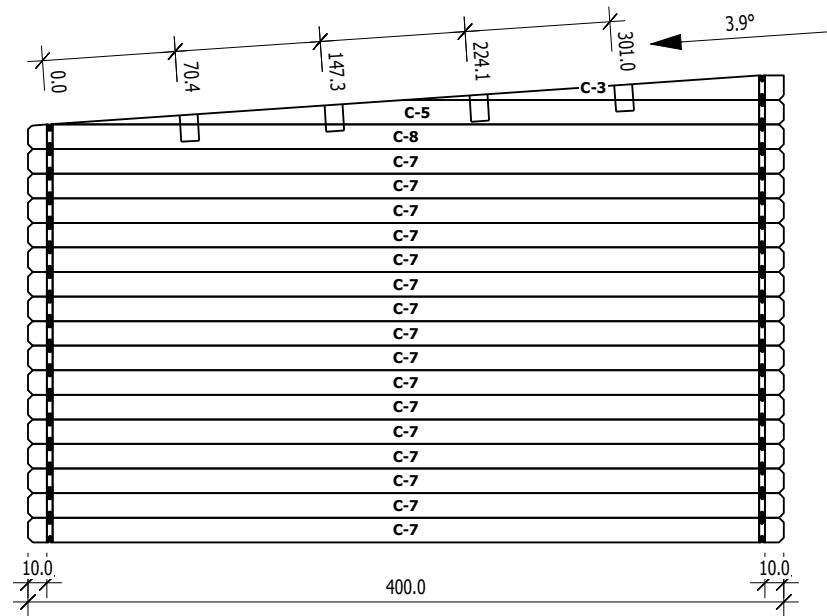

	Nr	H	L	Psc
D	4	13.0	201.5	1
D	6	13.0	388.0	1
D	9	13.0	400.0	16
D	10	13,0	400,0	1