

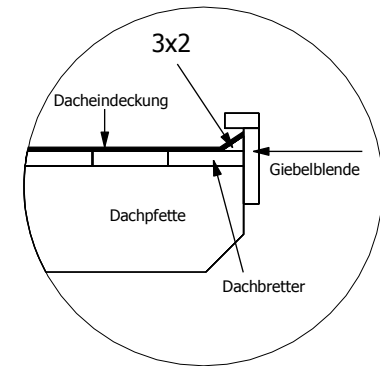

Bemerkung: die Ansicht von Turen, Fenster und anderen Teilen kann abweichen von diesem Bild

Grundriss

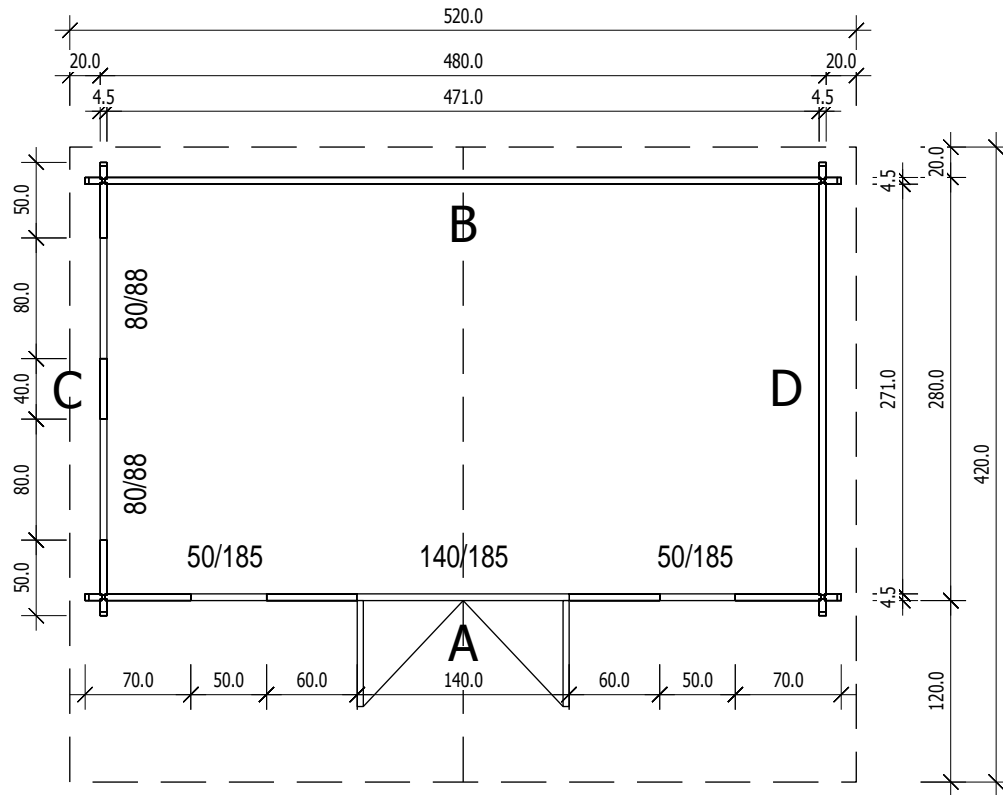

4,5

Schnitt

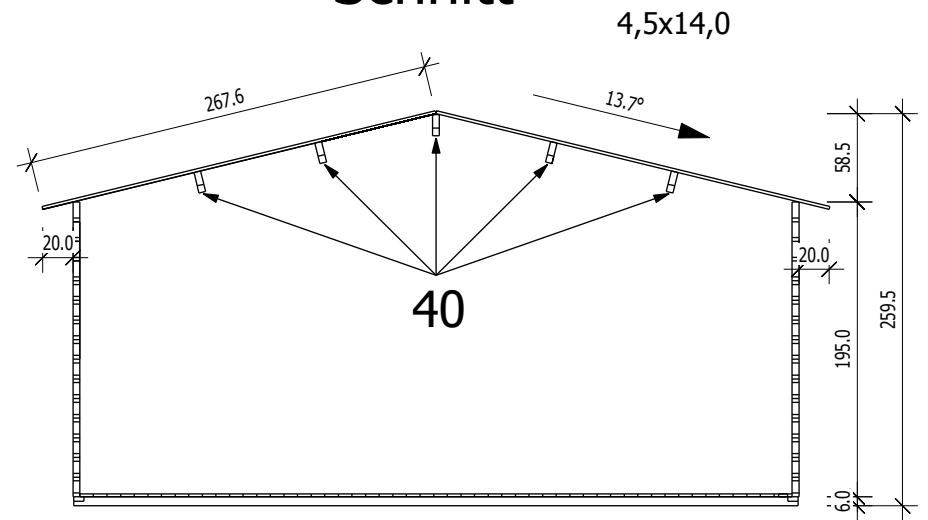

Grundrahmenplan

4,5

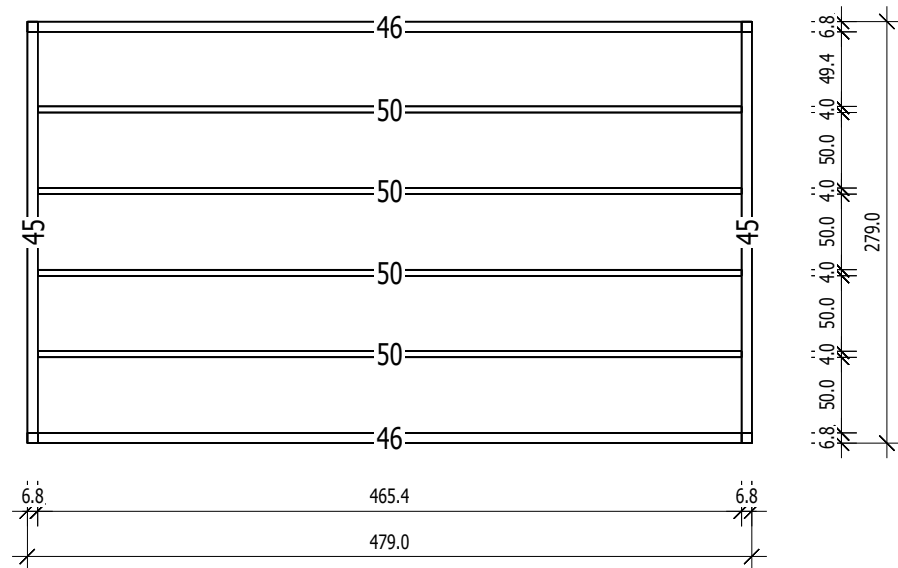

Nr.	B	H	L	Psc
	[cm]	[cm]	[cm]	
45	6,8	6,0	279,0	2
46	6,8	6,0	479,0	2
50	4,0	6,0	465,4	4

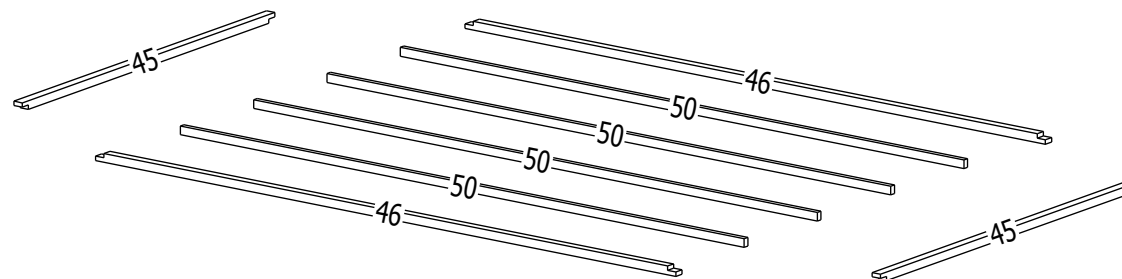

A

M 1:40

Ansicht von Aussen

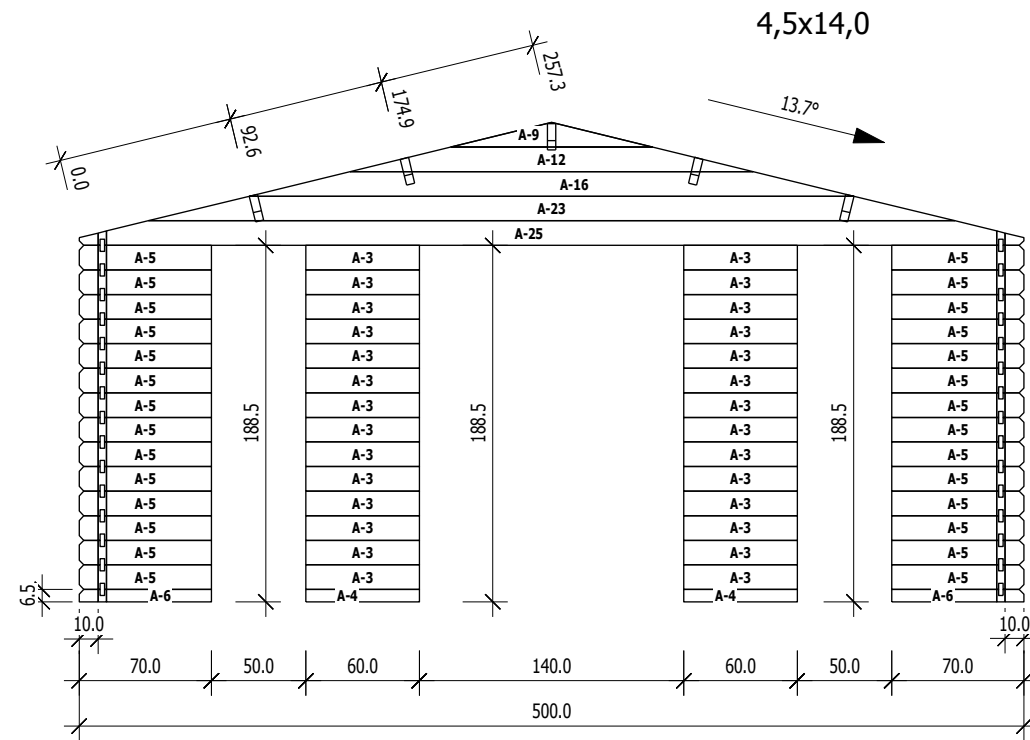

	Nr	H	L	Psc
A	3	13.0	60.0	28
A	4	6.5	60.0	2
A	5	13.0	70.0	28
A	6	6.5	70.0	2
A	9	13.0	106.7	1
A	12	13.0	213.3	1
A	16	13.0	320.0	1
A	23	13.0	426.7	1
A	25	13.0	500.0	1

C

M 1:40

Ansicht von Aussen

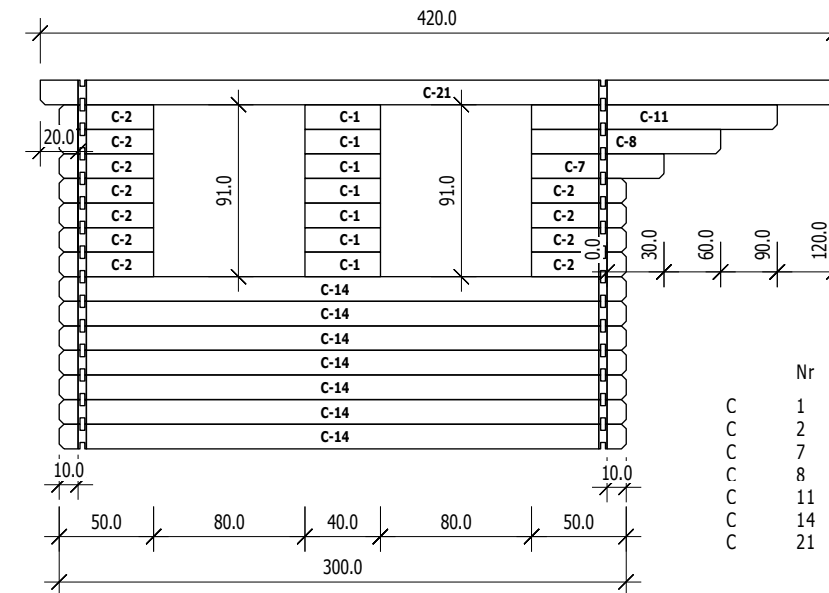

	Nr	H	L	Psc
C	1	13.0	40.0	7
C	2	13.0	50.0	11
C	7	13.0	70.0	1
C	8	13.0	100.0	1
C	11	13.0	130.0	1
C	14	13.0	300.0	7
C	21	13.0	420.0	1

4,5

B

M 1:40

Ansicht von Innen

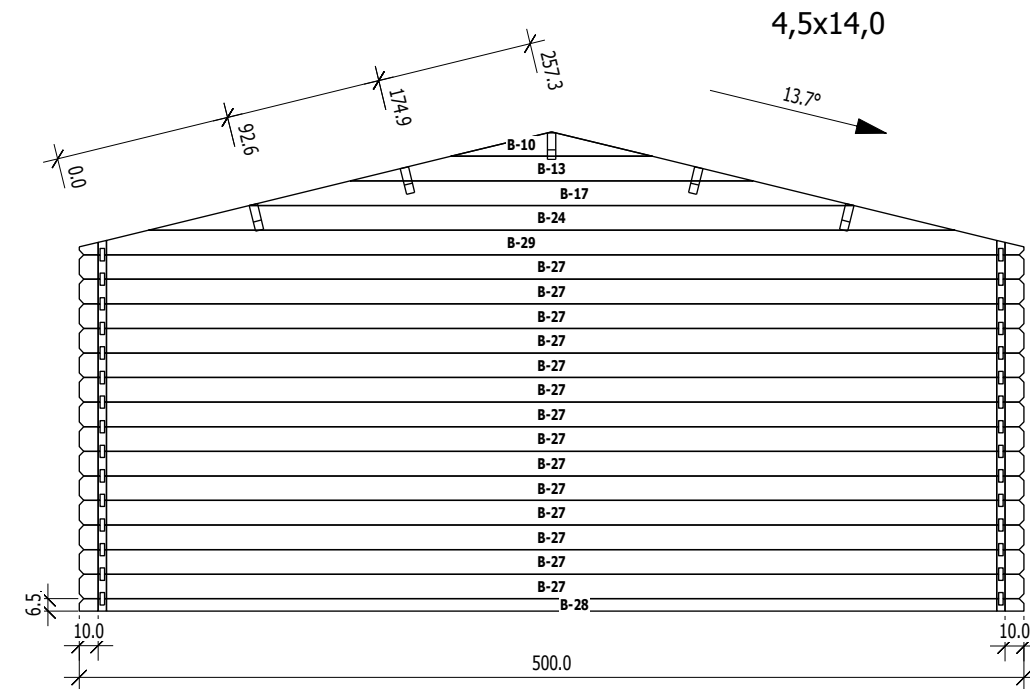

	Nr	H	L	Psc
B	10	13.0	106.7	1
B	13	13.0	213.3	1
B	17	13.0	320.0	1
B	24	13.0	426.7	1
B	27	13.0	500.0	14
B	28	6.5	500.0	1
B	29	13.0	500.0	1

D

M 1:40

Ansicht von Innen

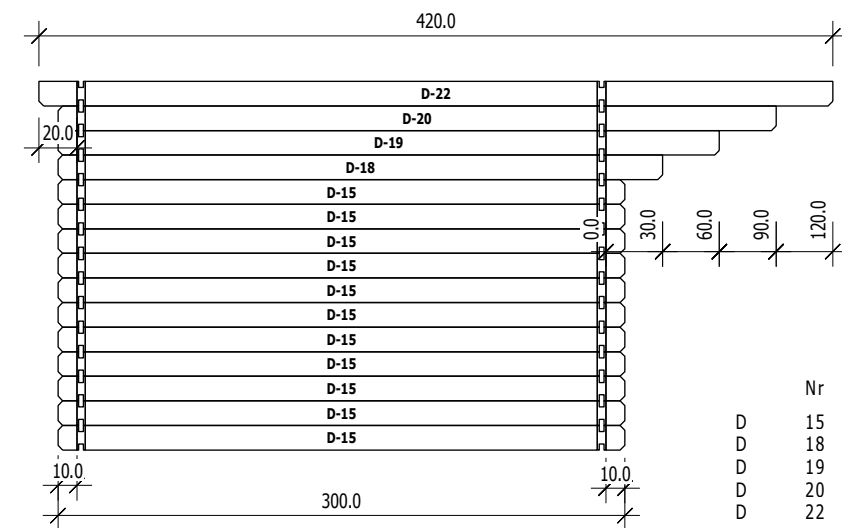

	Nr	H	L	Psc
D	15	13.0	300.0	11
D	18	13.0	320.0	1
D	19	13.0	350.0	1
D	20	13.0	380.0	1
D	22	13.0	420.0	1