

Bemerkung: die Ansicht von Türen, Fenster und anderen Teilen kann abweichen von diesem Bild

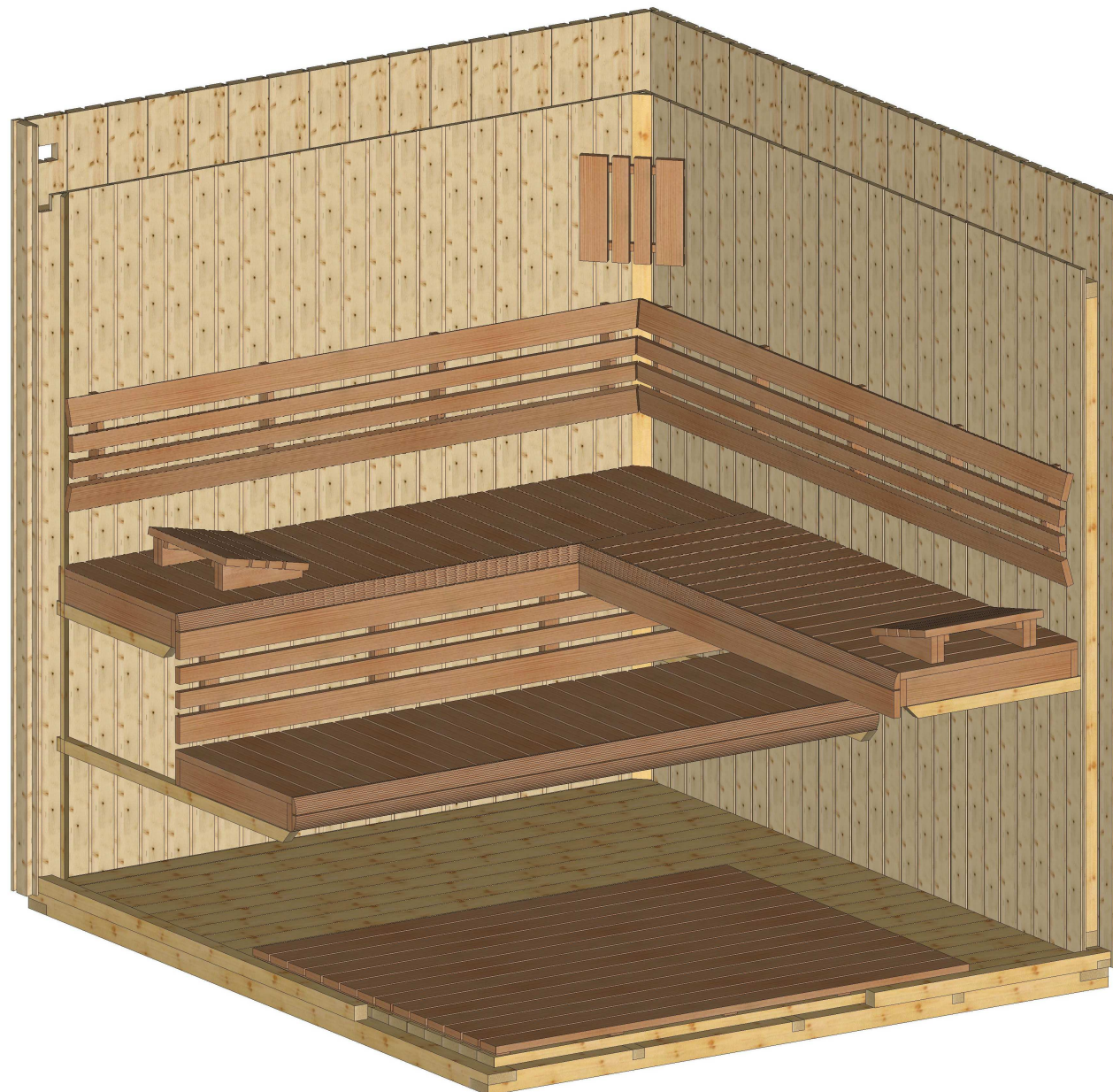

Bemerkung: die Ansicht von Türen, Fenster und anderen Teilen kann abweichen von diesem Bild

Grundriss

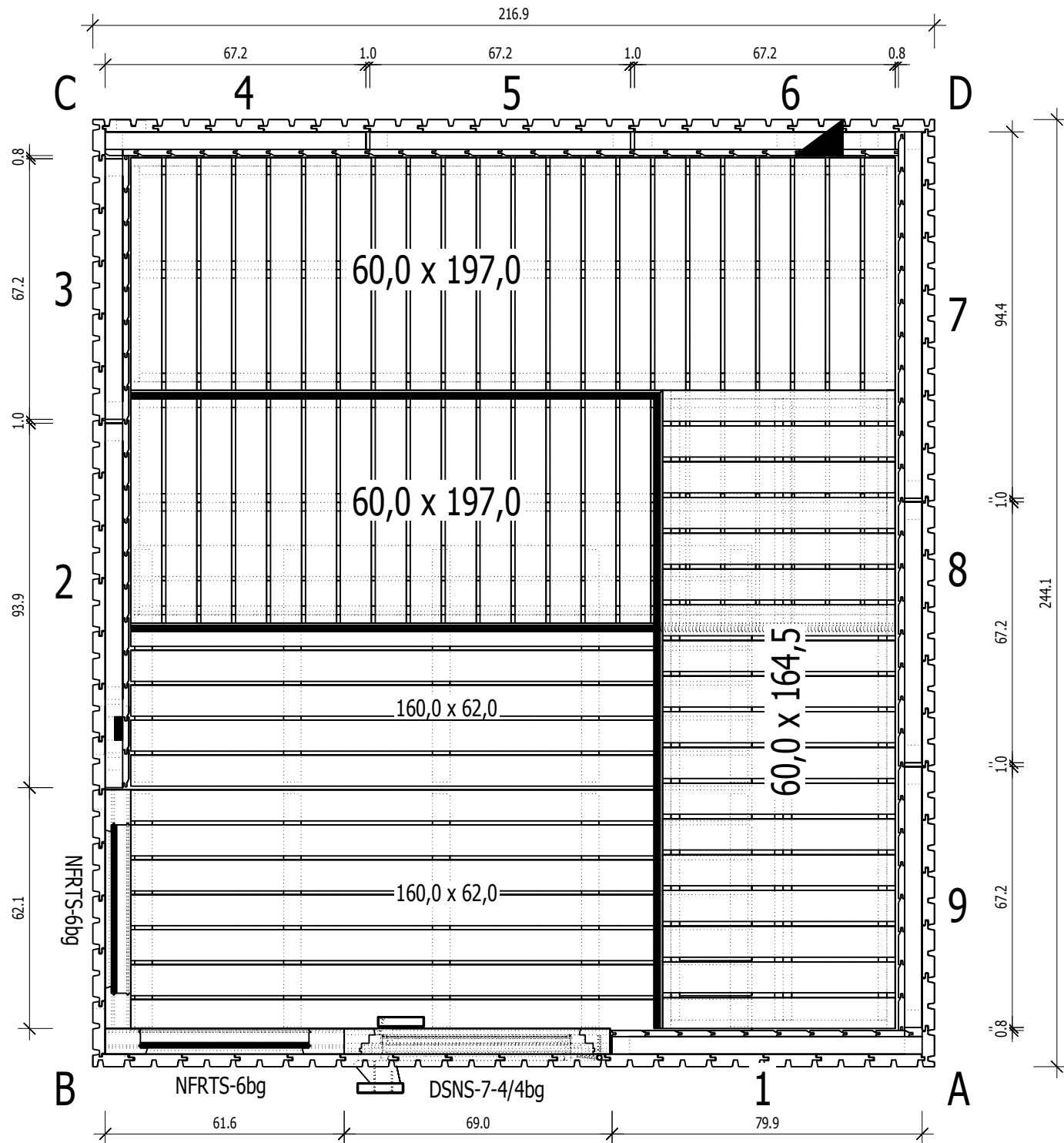

Schnitt

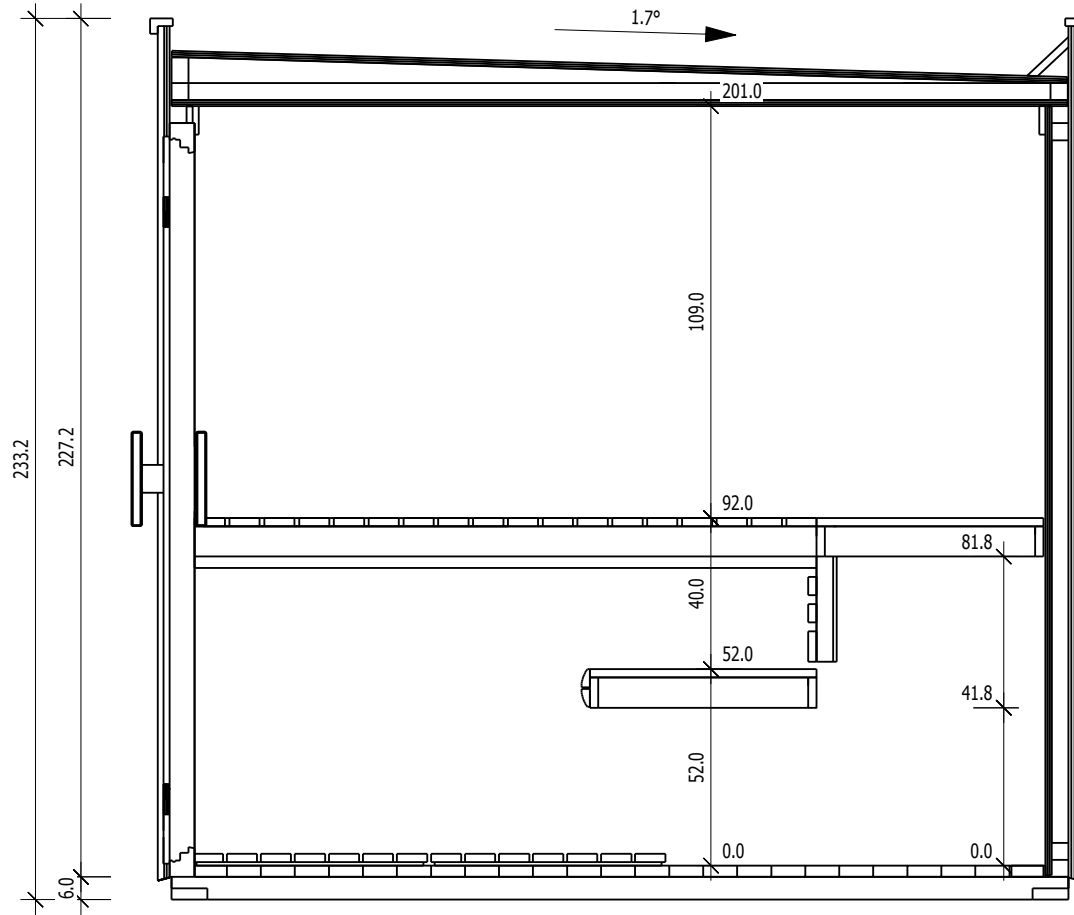

Grundrahmen

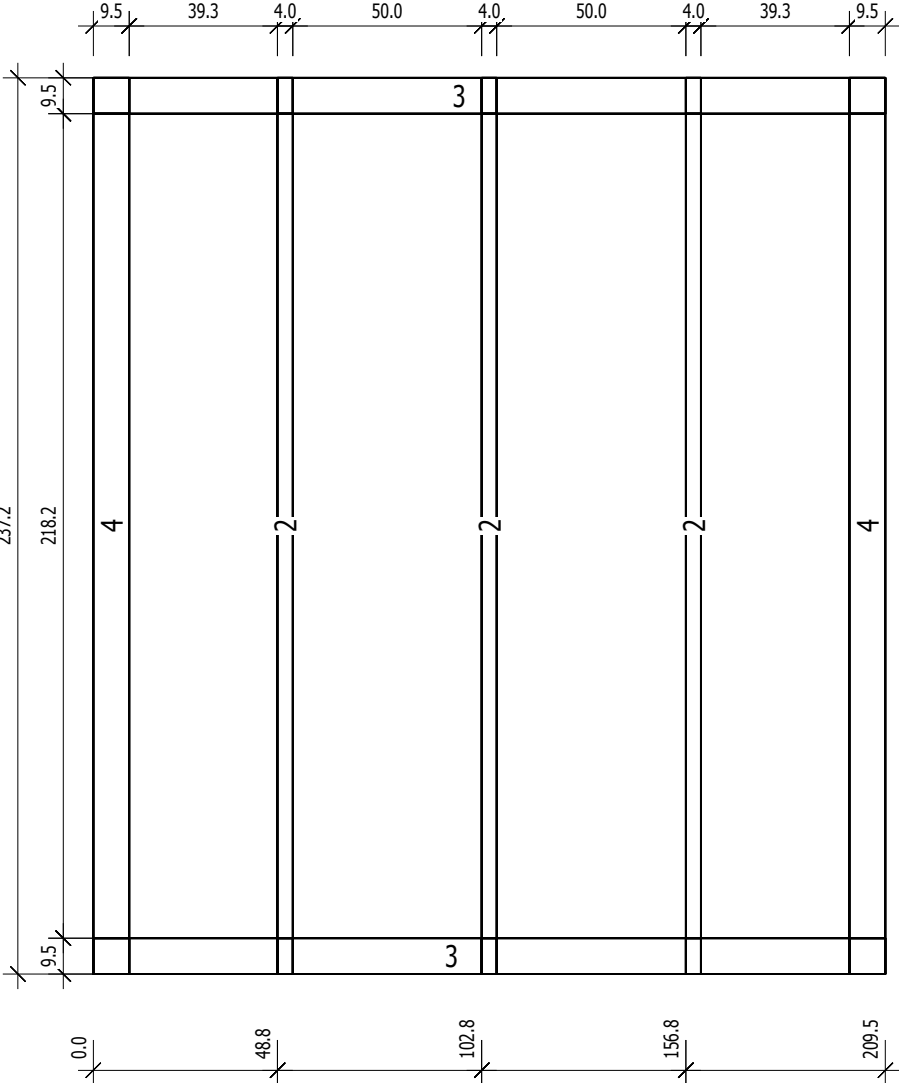

Nr.	B [cm]	H [cm]	L [cm]	Psc
2	4,0	6,0	169,0	3
3	9,5	6,0	209,5	2
4	9,5	6,0	237,2	2

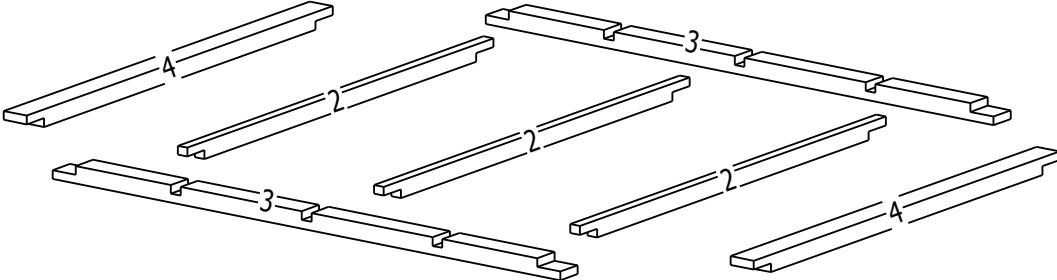

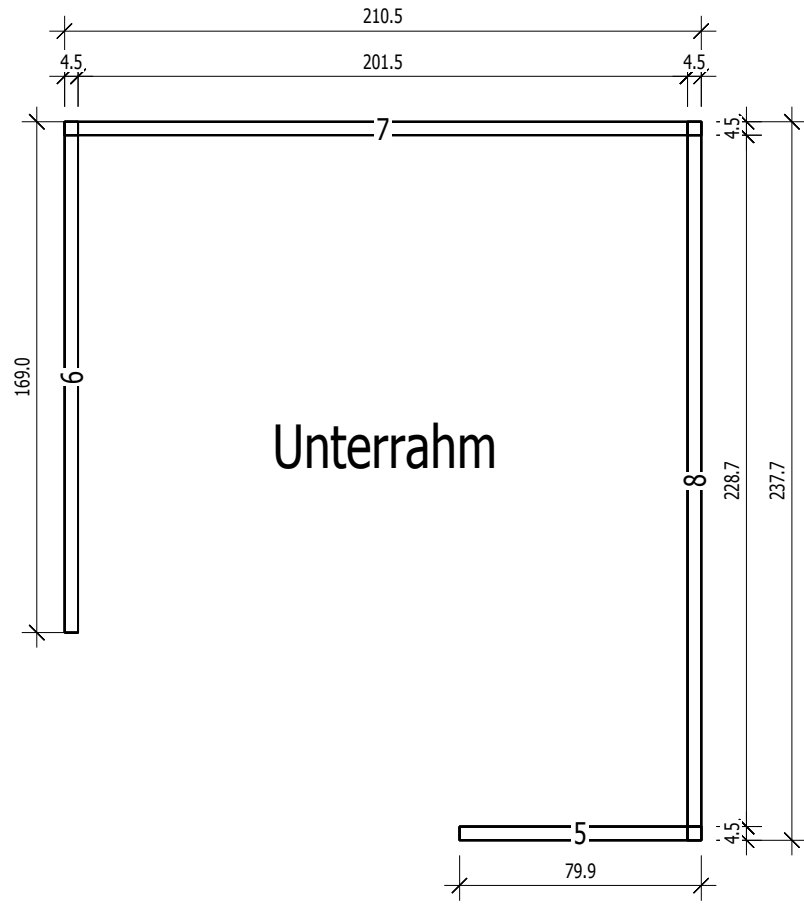

Unterrahm

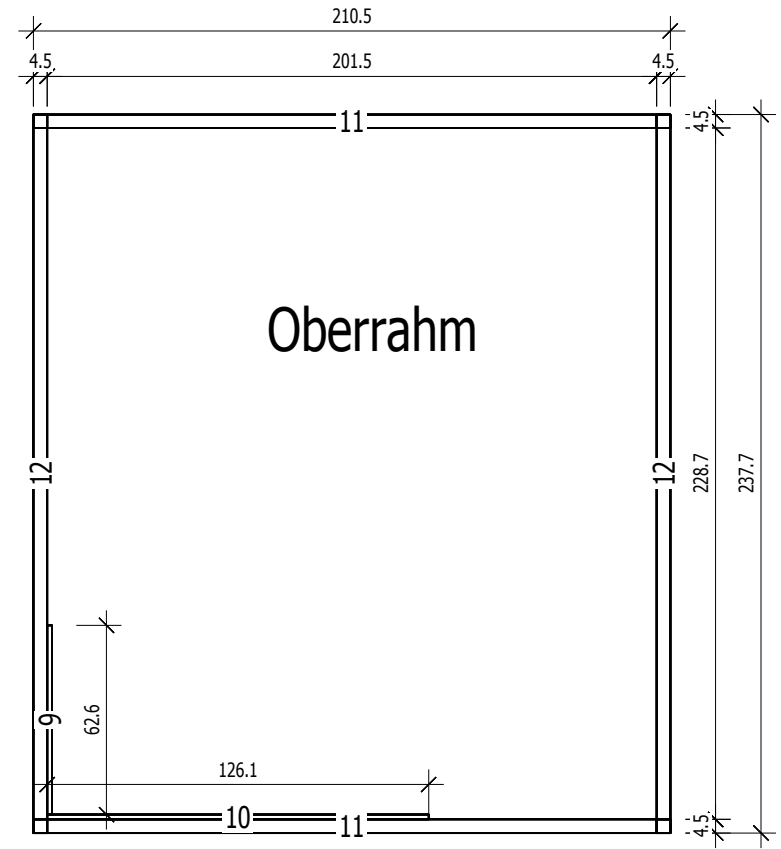

Oberrahm

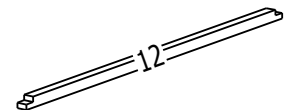
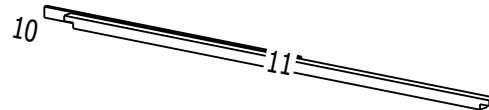
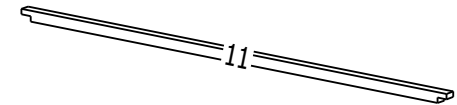
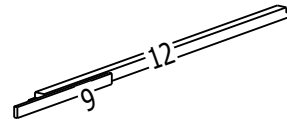
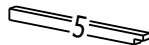
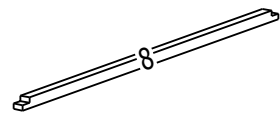
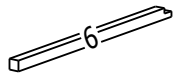

Dachelemente

