

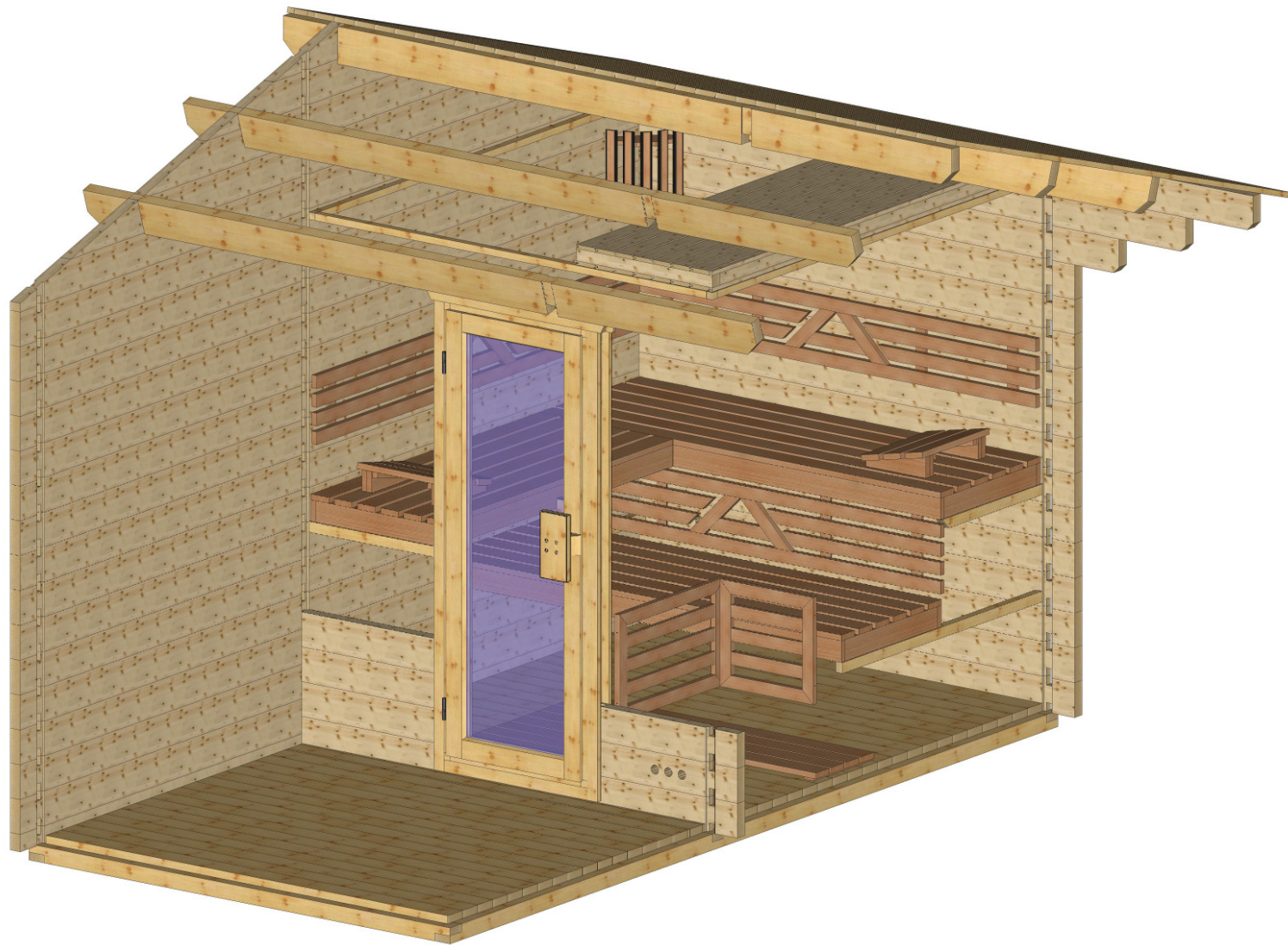

Bemerkung: die Ansicht von Turen, Fenster und anderen Teilen kann abweichen von diesem Bild



Bemerkung: die Ansicht von Turen, Fenster und anderen Teilen kann abweichen von diesem Bild

Grundriss

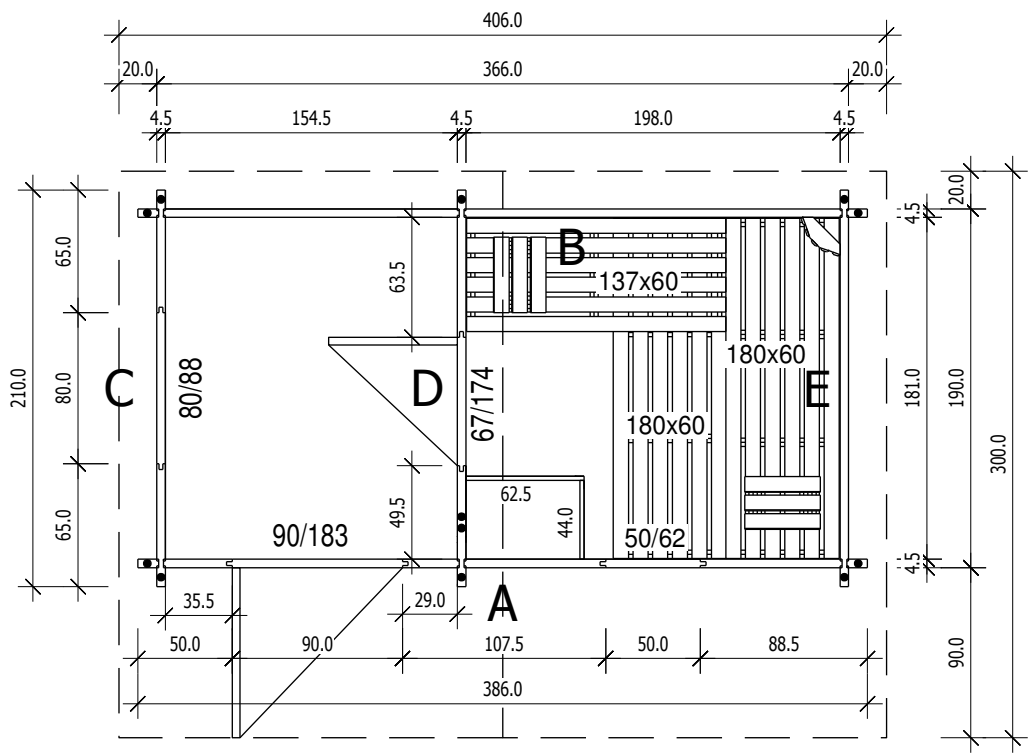

Schnitt

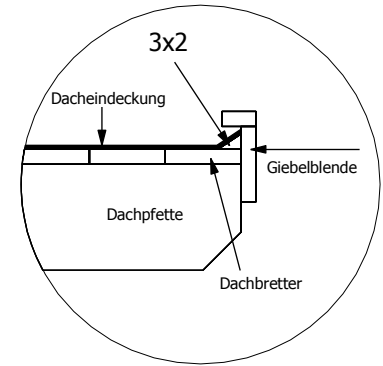
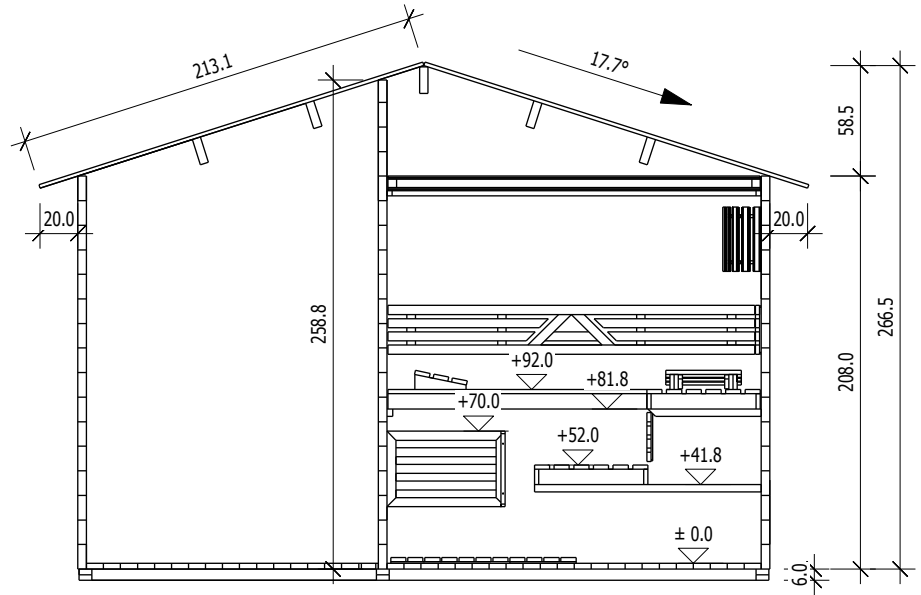

Grundrahmenplan

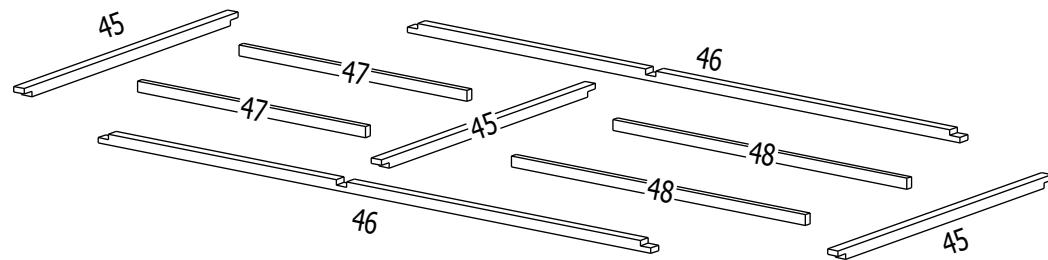
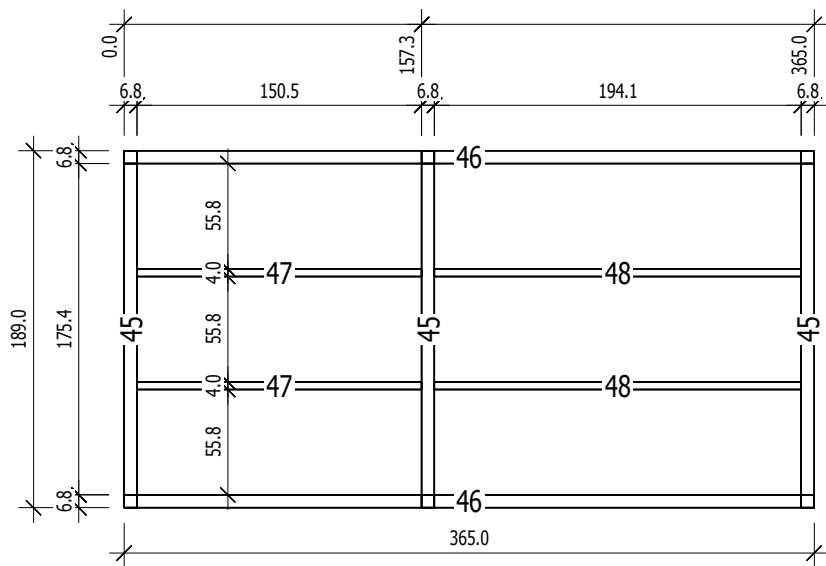

| Nr. | B | H | L | Psc |
|-----|------|------|-------|-----|
| | [cm] | [cm] | [cm] | |
| 45 | 6,8 | 6,0 | 189,0 | 3 |
| 46 | 6,8 | 6,0 | 365,0 | 2 |
| 47 | 4,0 | 6,0 | 150,6 | 2 |
| 48 | 4,0 | 6,0 | 194,1 | 2 |

A
M 1:40

| Nr | H | L | Psc |
|------|------|-------|-----|
| A 1 | 13.0 | 50.0 | 14 |
| A 2 | 6.5 | 50.0 | 1 |
| A 7 | 13.0 | 81.3 | 1 |
| A 10 | 13.0 | 88.5 | 4 |
| A 11 | 13.0 | 107.5 | 4 |
| A 12 | 13.0 | 162.7 | 1 |
| A 22 | 13.0 | 244.0 | 1 |
| A 24 | 13.0 | 246.0 | 8 |
| A 25 | 6.5 | 246.0 | 1 |
| A 26 | 13.0 | 246.0 | 1 |
| A 27 | 13.0 | 246.0 | 1 |
| A 33 | 13.0 | 325.3 | 1 |
| A 35 | 13.0 | 386.0 | 1 |
| A 36 | 13.0 | 386.0 | 1 |

Ansicht von Aussen

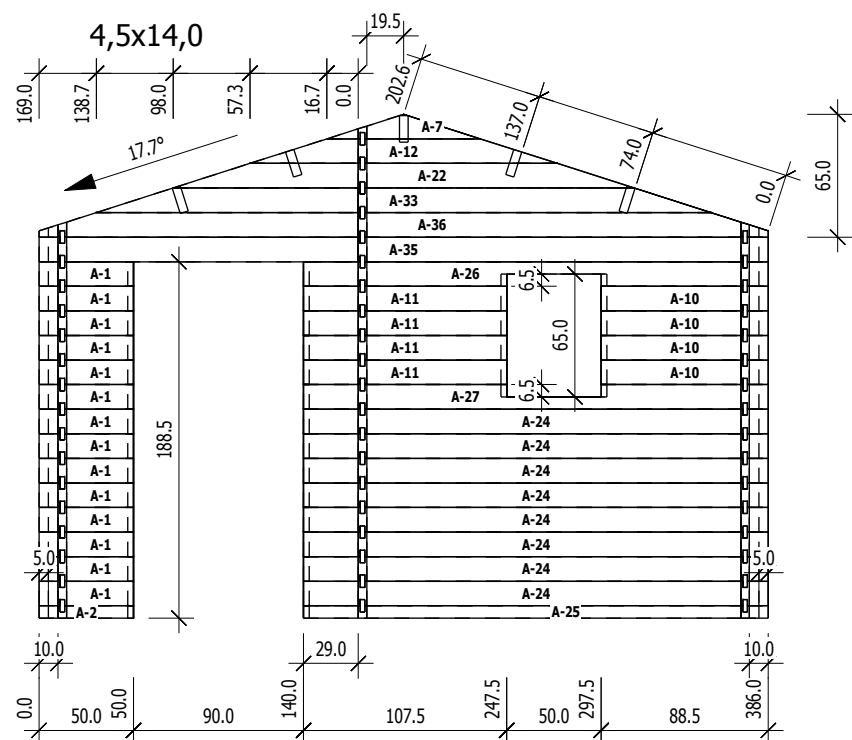

B
M 1:40

| Nr | H | L | Psc |
|------|------|-------|-----|
| B 8 | 13.0 | 81.3 | 1 |
| B 13 | 13.0 | 162.7 | 1 |
| B 23 | 13.0 | 244.0 | 1 |
| B 34 | 13.0 | 325.3 | 1 |
| B 37 | 13.0 | 386.0 | 15 |
| B 38 | 6.5 | 386.0 | 1 |
| B 39 | 13.0 | 386.0 | 1 |

Ansicht von Innen

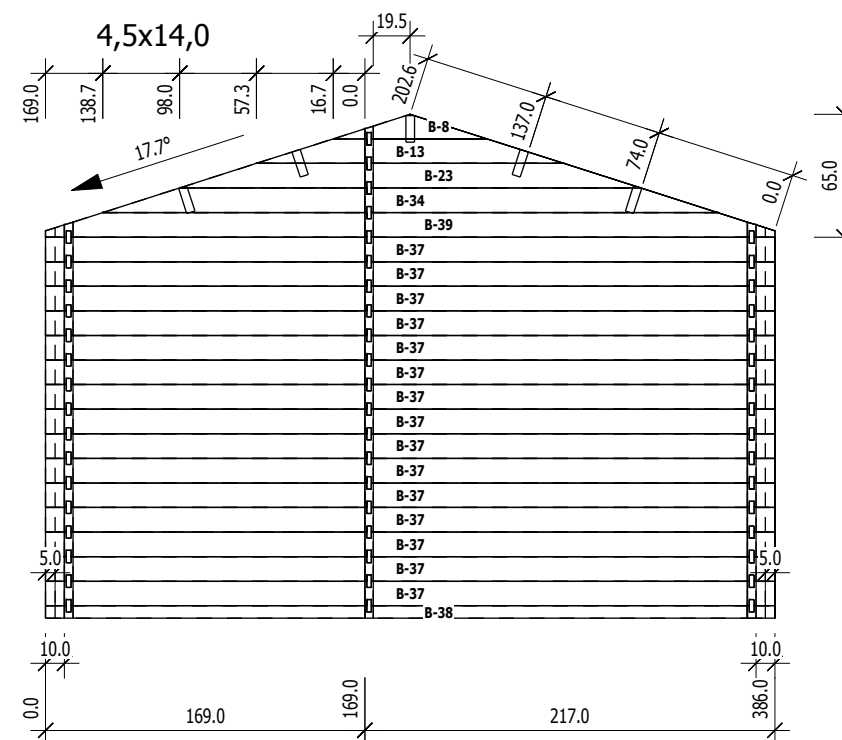

C
M 1:40

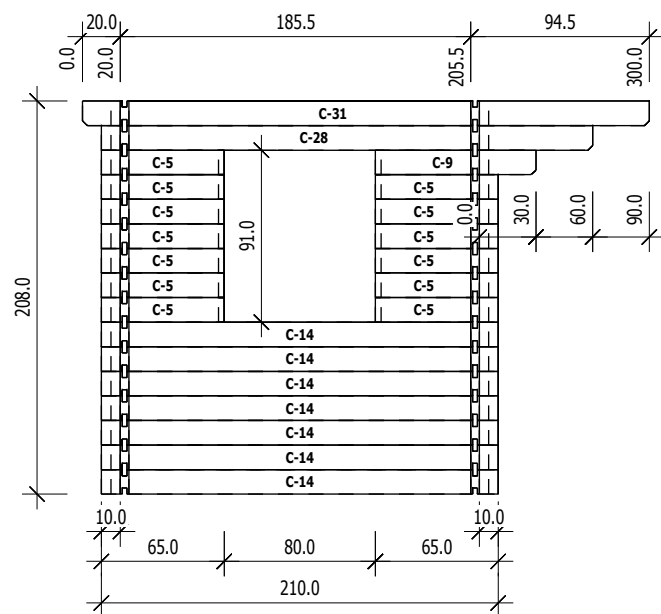

| Nr | H | L | Psc |
|------|------|-------|-----|
| C 5 | 13.0 | 65.0 | 13 |
| C 9 | 13.0 | 85.0 | 1 |
| C 14 | 13.0 | 210.0 | 7 |
| C 28 | 13.0 | 260.0 | 1 |
| C 31 | 13.0 | 300.0 | 1 |

Ansicht von Aussen

D
M 1:40

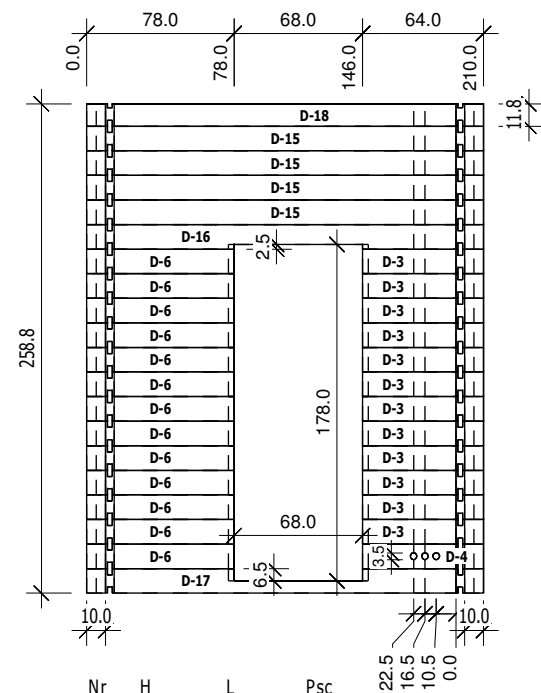

| Nr | H | L | Psc |
|------|------|-------|-----|
| D 3 | 13.0 | 64.0 | 12 |
| D 4 | 13.0 | 64.0 | 1 |
| D 6 | 13.0 | 78.0 | 13 |
| D 15 | 13.0 | 210.0 | 4 |
| D 16 | 13.0 | 210.0 | 1 |
| D 17 | 13.0 | 210.0 | 1 |
| D 18 | 11.8 | 210.0 | 1 |

Ansicht von Innen

E
M 1:40

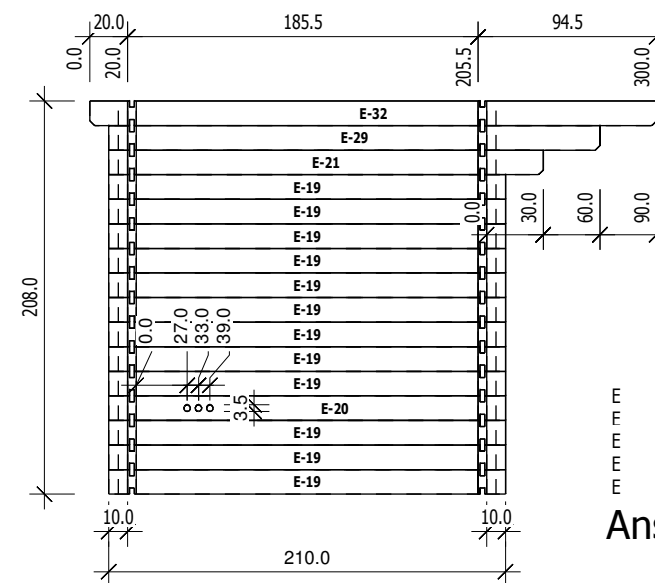

| Nr | H | L | Psc |
|------|------|-------|-----|
| E 19 | 13.0 | 210.0 | 12 |
| E 20 | 13.0 | 210.0 | 1 |
| E 21 | 13.0 | 230.0 | 1 |
| E 29 | 13.0 | 260.0 | 1 |
| E 32 | 13.0 | 300.0 | 1 |

Ansicht von Innen