

Lynn-4030

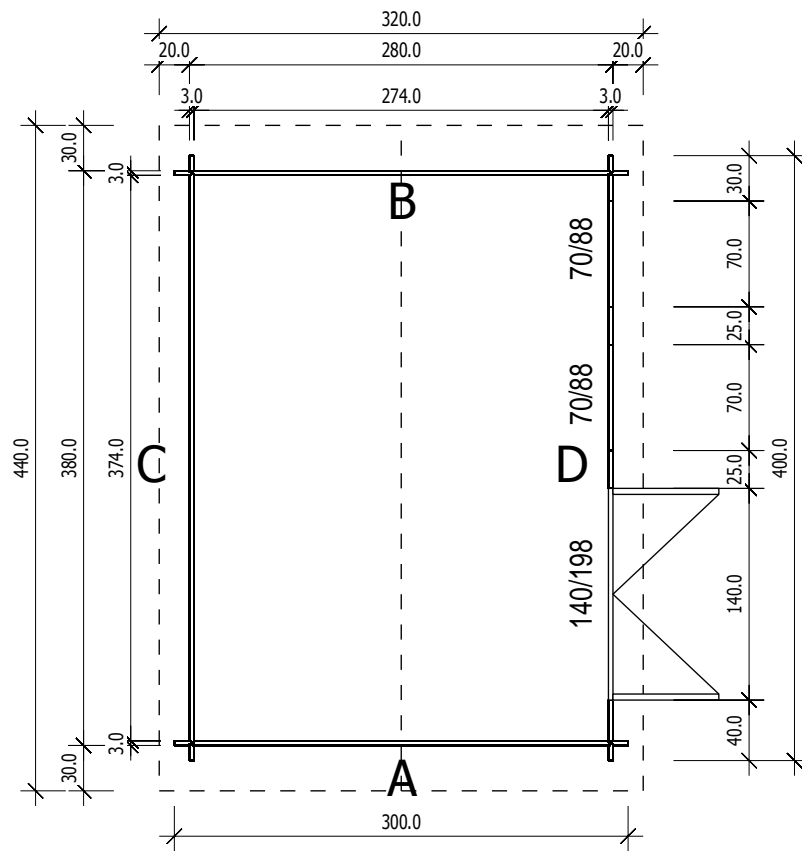

Bemerkung: die Ansicht von Turen, Fenster und anderen Teilen kann abweichen von diesem Bild

# Grundriss



# Schnitt

3,0

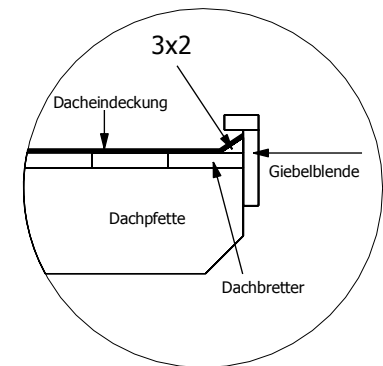
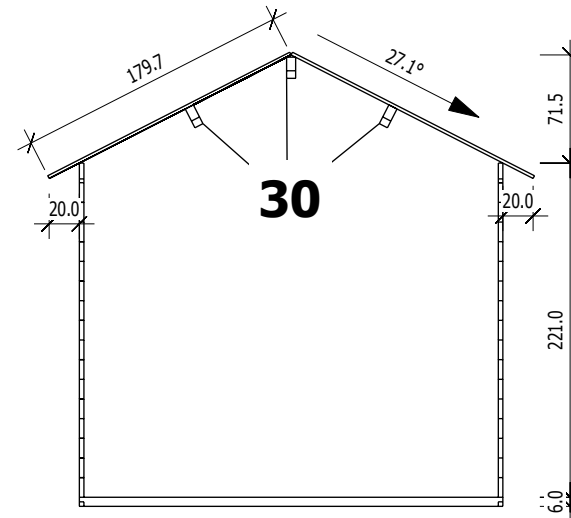

# Grundrahmenplan

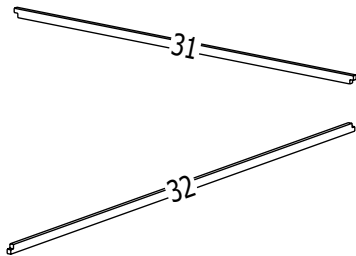
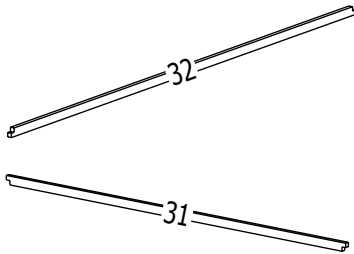
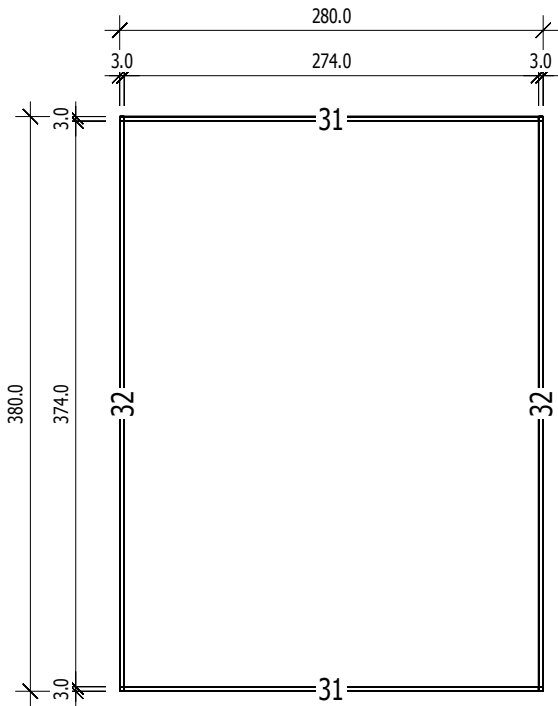

Nr.	B	H	L	Psc
	[cm]	[cm]	[cm]	
=====				
31	3,0	6,0	280,0	2
32	3,0	6,0	380,0	2

**A**

M 1:40

	Nr	H	L	Psc
A	4	13.0	50.9	1
A	6	13.0	101.8	1
A	9	13.0	152.7	1
A	11	13.0	203.6	1
A	14	13.0	254.5	1
A	16	13.0	300.0	16
A	17	6.5	300.0	1
A	18	13.0	300.0	1

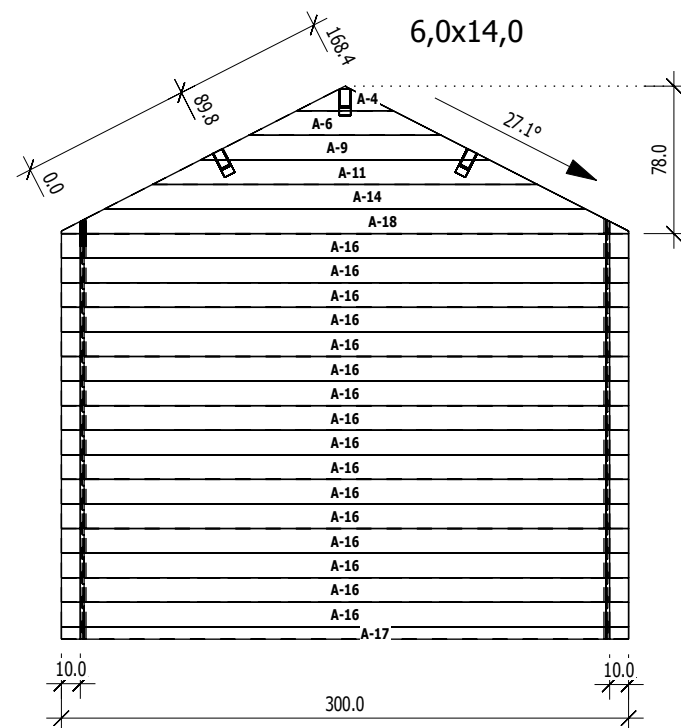
**B**

M 1:40

	Nr	H	L	Psc
B	5	13.0	50.9	1
B	7	13.0	101.8	1
B	10	13.0	152.7	1
B	12	13.0	203.6	1
B	15	13.0	254.5	1
B	19	13.0	300.0	16
B	20	6.5	300.0	1
B	21	13.0	300.0	1

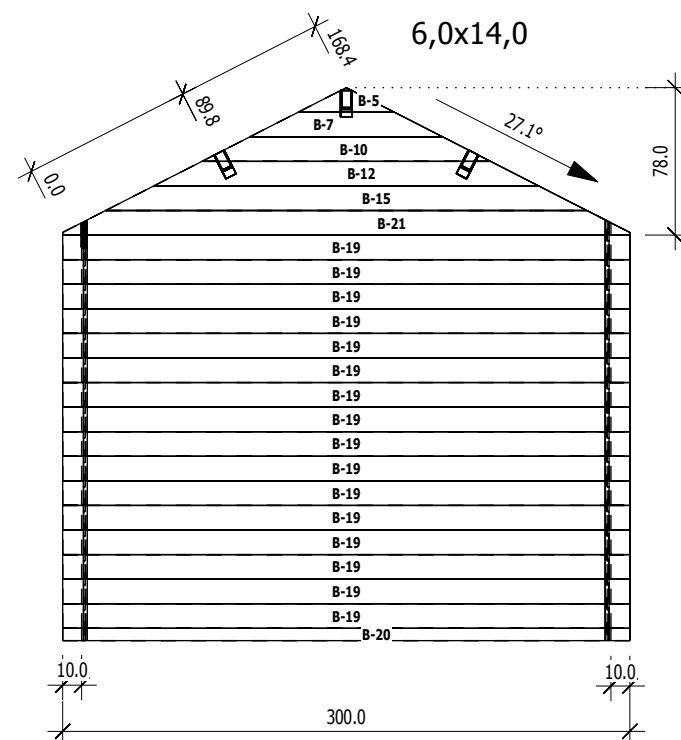
**C**

M 1:40

	Nr	H	L	Psc
C	22	13.0	400.0	16
C	25	13.0	440.0	1

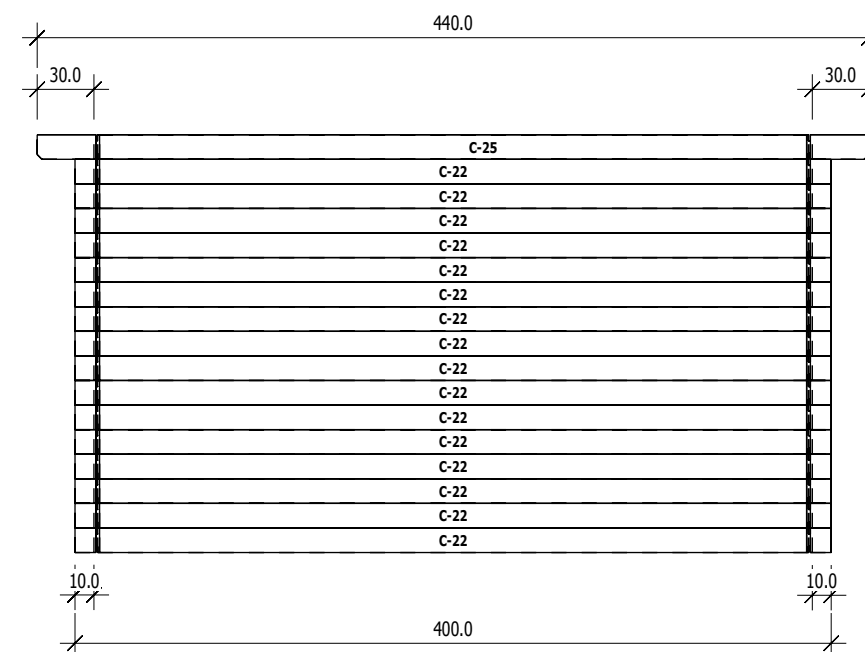
**D**

M 1:40

	Nr	H	L	Psc
D	1	13.0	25.0	14
D	2	13.0	30.0	7
D	3	13.0	40.0	15
D	13	13.0	220.0	8
D	23	13.0	400.0	1
D	26	13.0	440.0	1

