

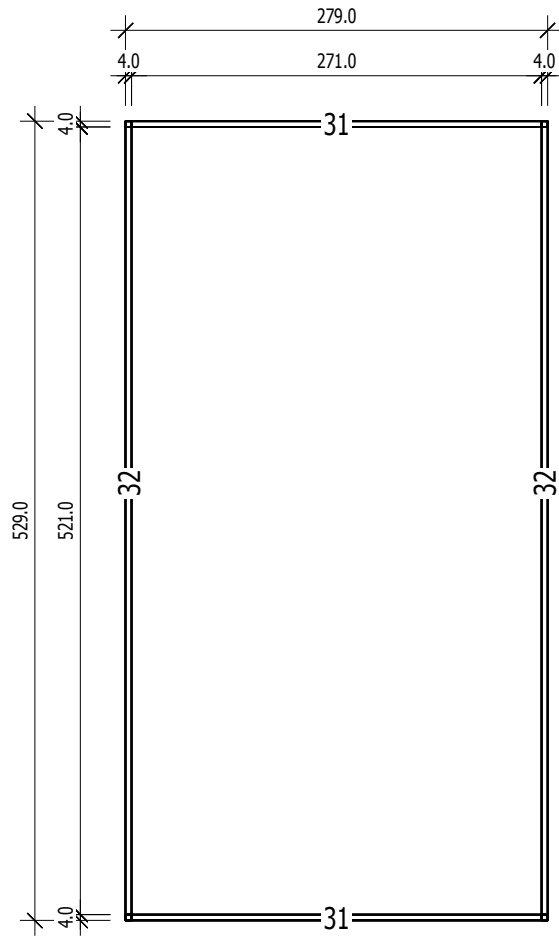

Bemerkung: die Ansicht von Turen, Fenster und anderen Teilen kann abweichen von diesem Bild





Grundrahmenplan

Nr.	B	H	L	Psc
	[cm]	[cm]	[cm]	
31	4.0	6.0	279.0	2
32	4.0	6.0	529.0	2

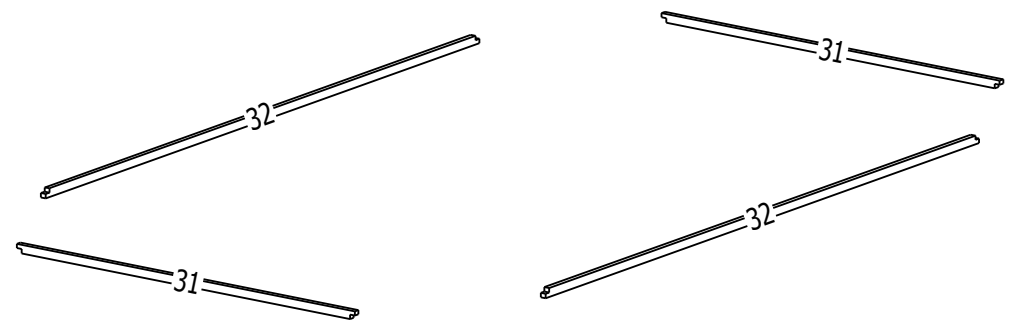

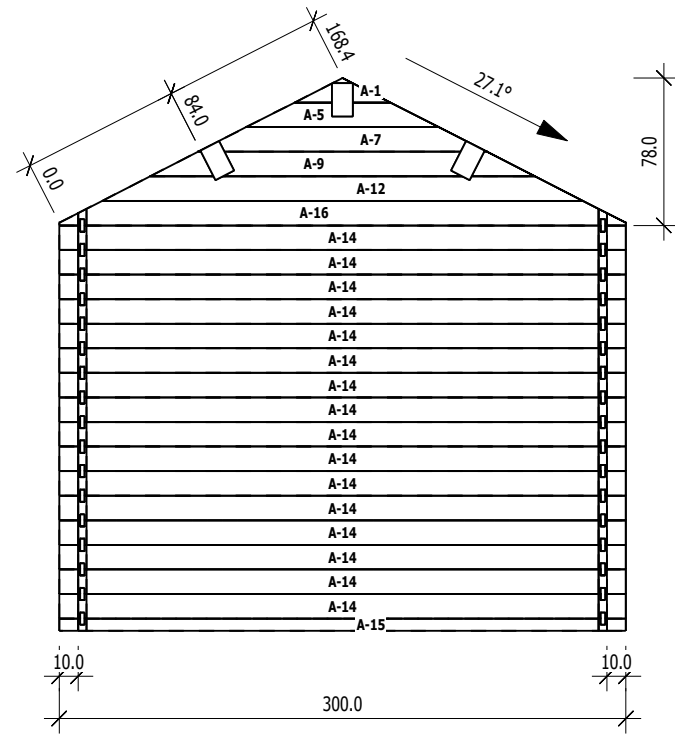

	Nr	H	L	Psc
A	1	13.0	50.9	1
A	5	13.0	101.8	1
A	7	13.0	152.7	1
A	9	13.0	203.6	1
A	12	13.0	254.5	1
A	14	13.0	300.0	16
A	15	6.5	300.0	1
A	16	13.0	300.0	1

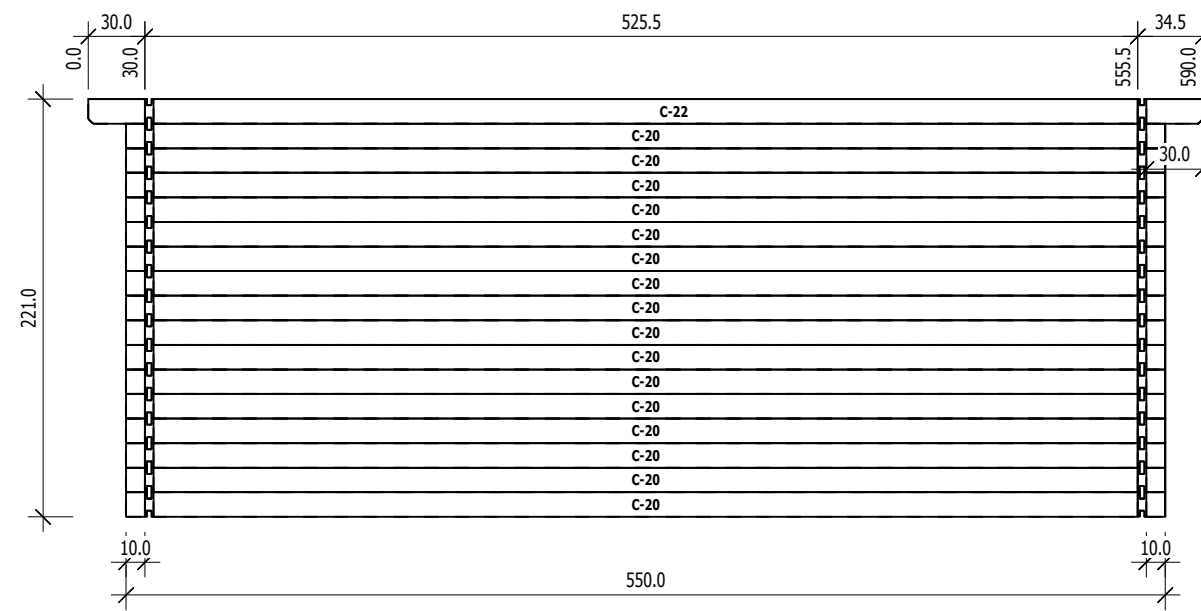

	Nr	H	L	Psc
C	20	13.0	550.0	16
C	22	13.0	590.0	1

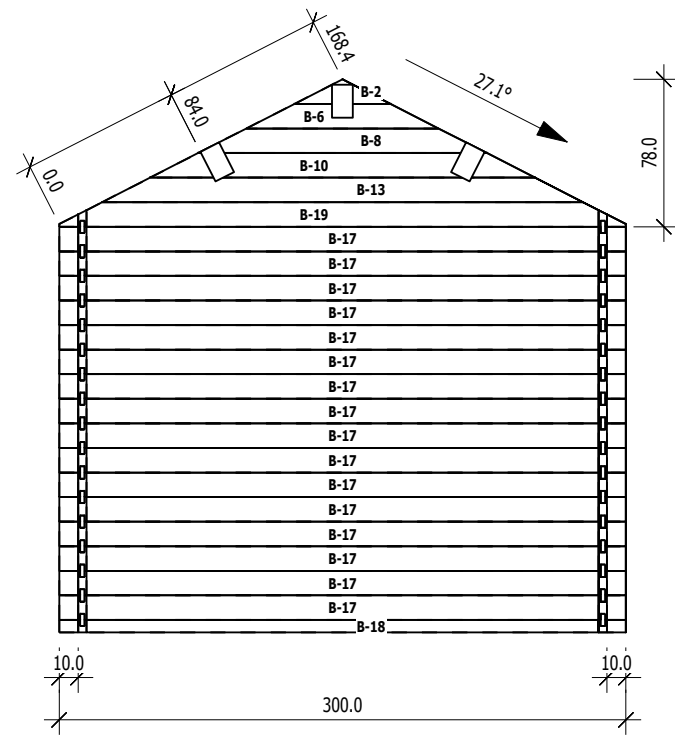

	Nr	H	L	Psc
B	2	13.0	50.9	1
B	6	13.0	101.8	1
B	8	13.0	152.7	1
B	10	13.0	203.6	1
B	13	13.0	254.5	1
B	17	13.0	300.0	16
B	18	6.5	300.0	1
B	19	13.0	300.0	1

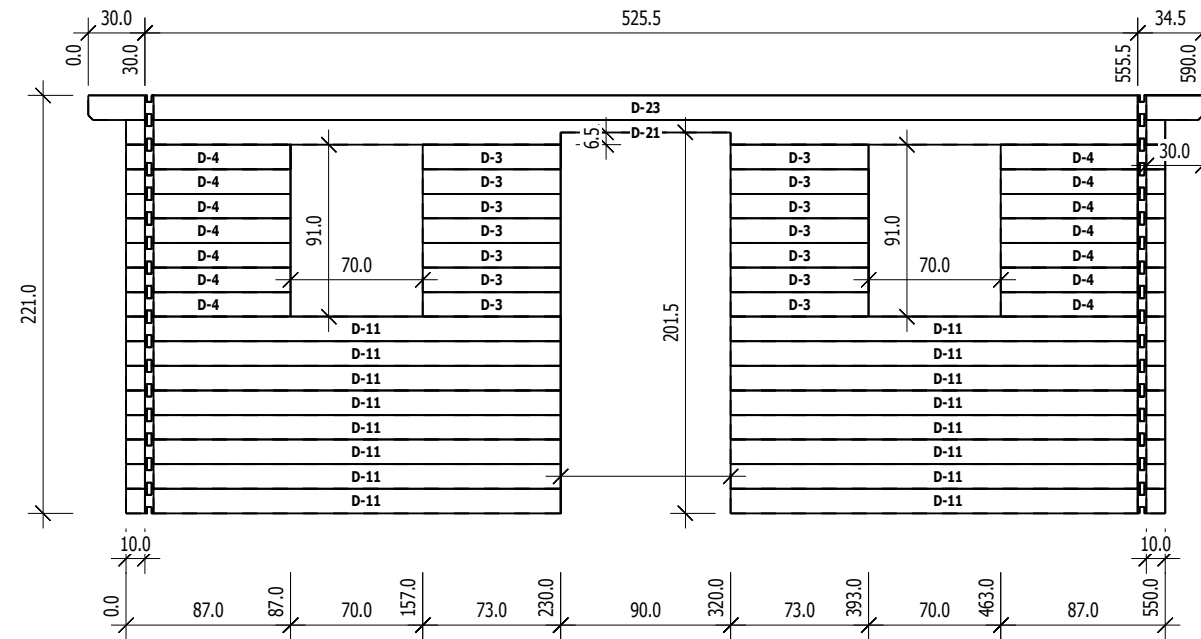

	Nr	H	L	Psc
D	3	13.0	73.0	14
D	4	13.0	87.0	14
D	11	13.0	230.0	16
D	21	13.0	550.0	1
D	23	13.0	590.0	1