

Bemerkung: die Ansicht von Turen, Fenster und anderen Teilen kann abweichen von diesem Bild

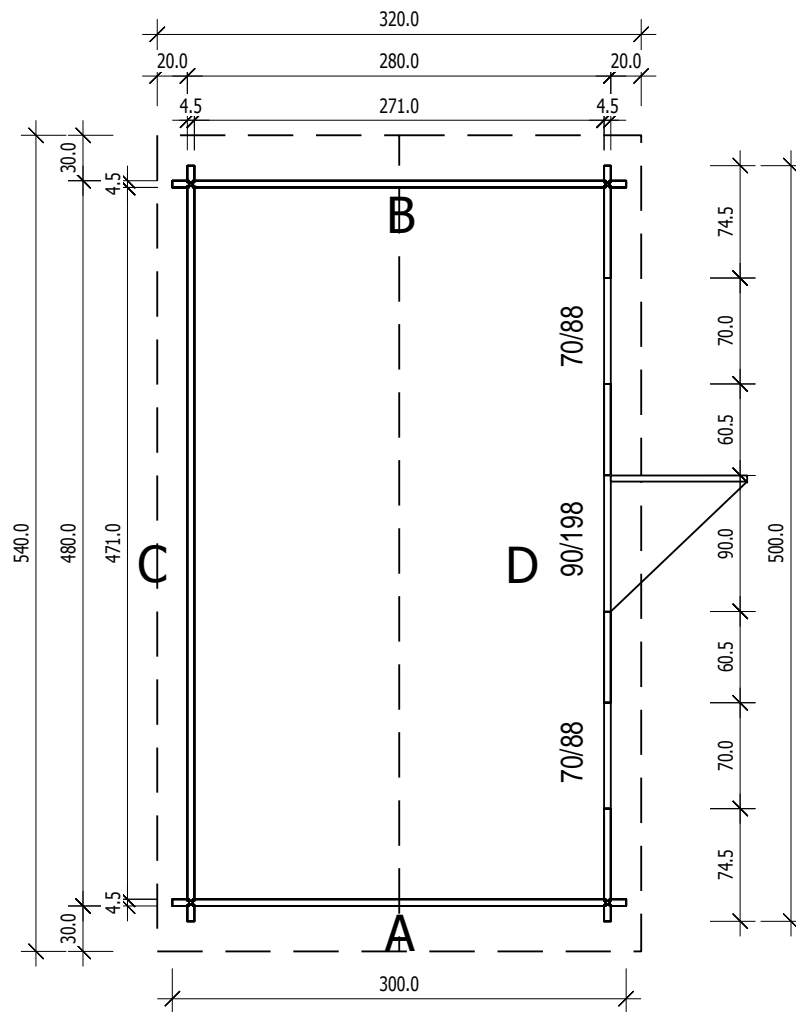

# Grundriss



# Schnitt

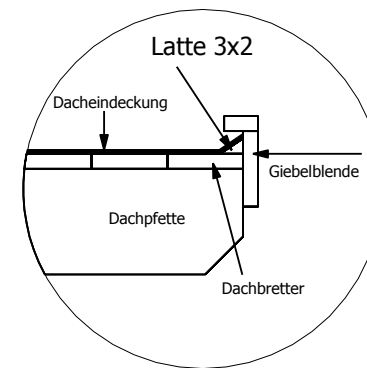
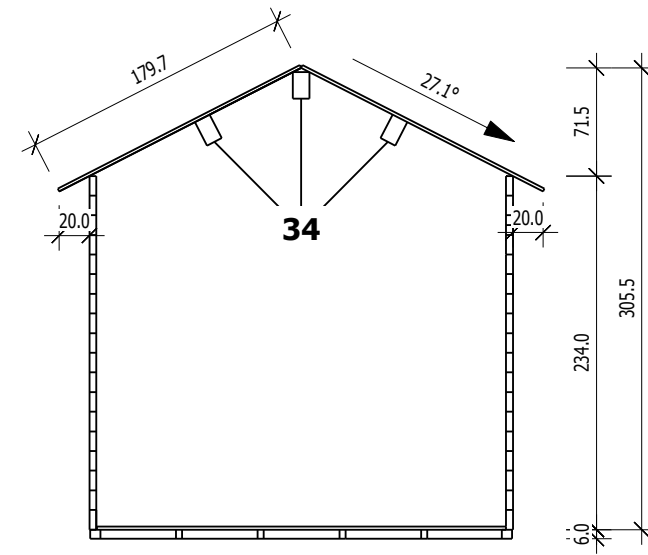

4,5

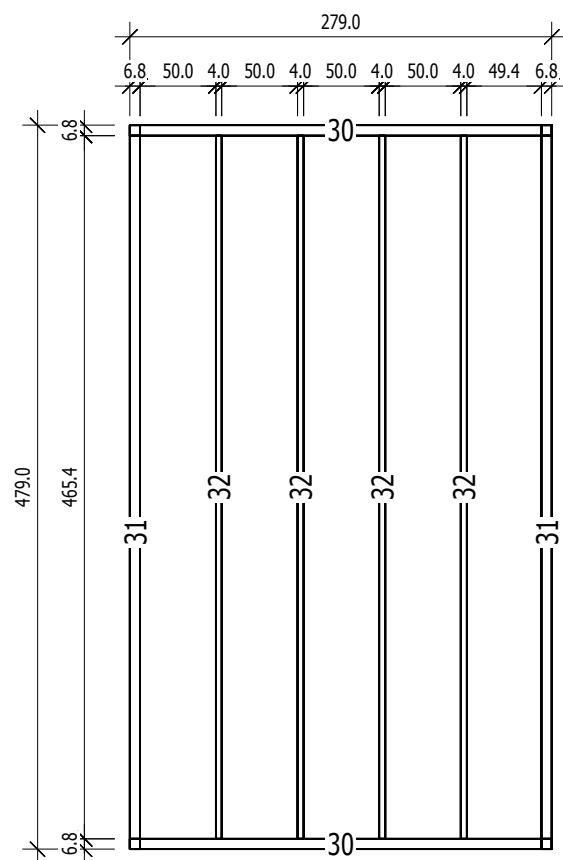

## Grundrahmenplan

Nr.	B	H	L	Psc
	[cm]	[cm]	[cm]	
30	6.8	6.0	279.0	2
31	6.8	6.0	479.0	2
32	4.0	6.0	465.4	4

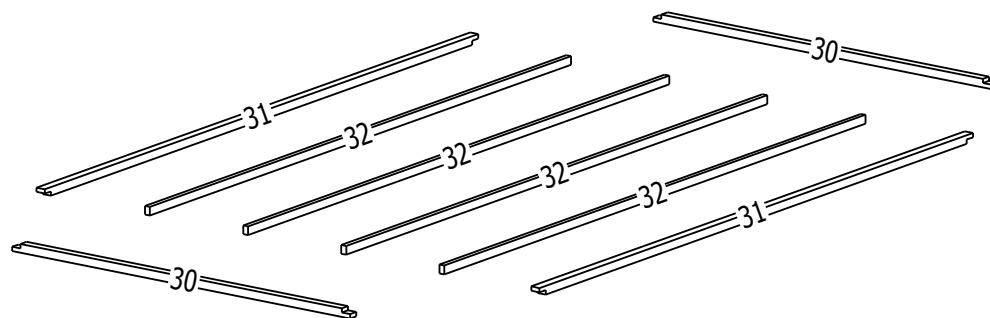

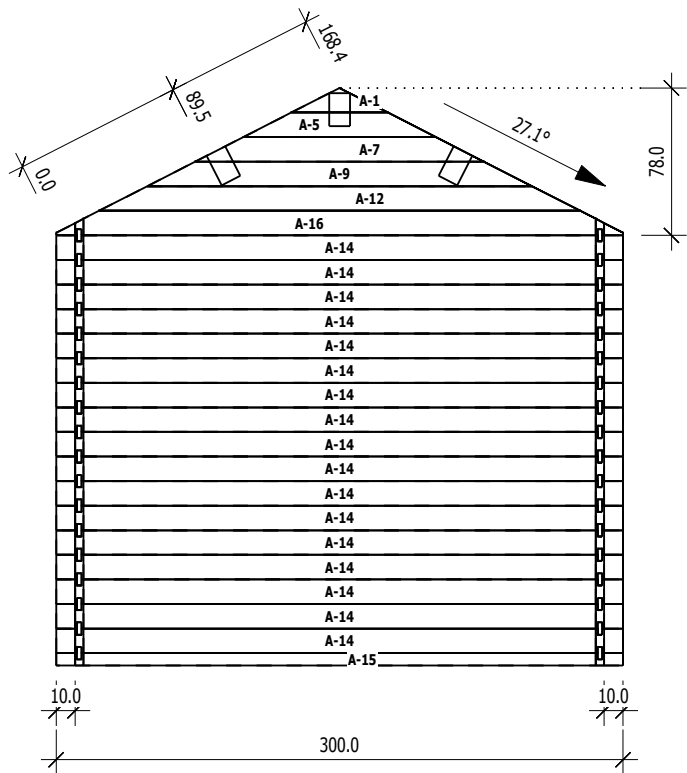

	Nr	H	L	Psc
A	1	13.0	50.9	1
A	5	13.0	101.8	1
A	7	13.0	152.7	1
A	9	13.0	203.6	1
A	12	13.0	254.5	1
A	14	13.0	300.0	17
A	15	6.5	300.0	1
A	16	13.0	300.0	1

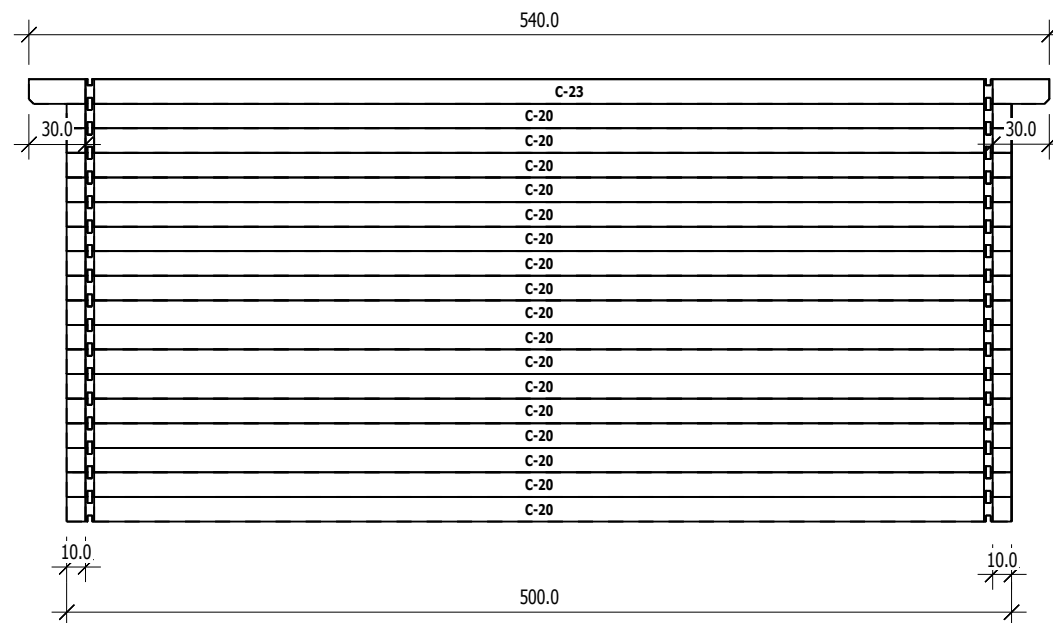

	Nr	H	L	Psc
C	20	13.0	500.0	17
C	23	13.0	540.0	1

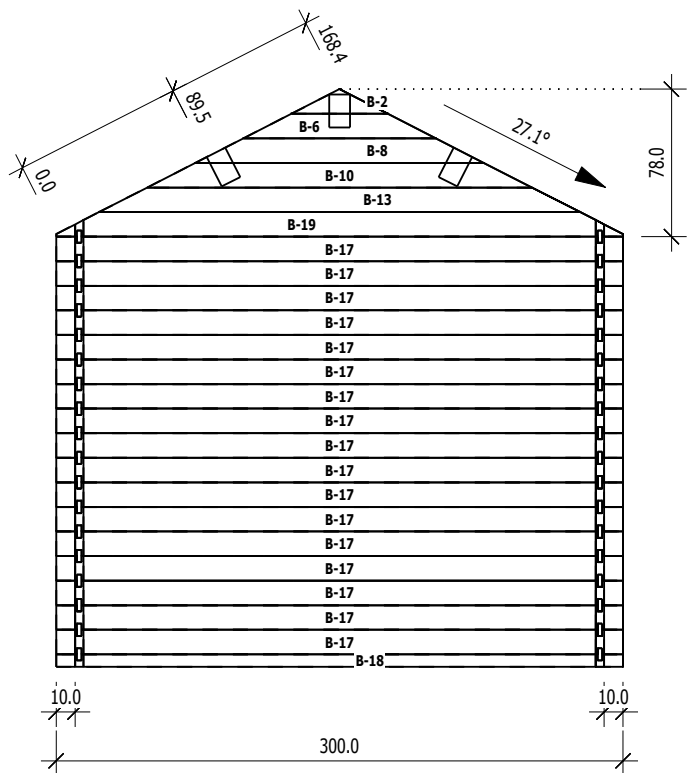

	Nr	H	L	Psc
B	2	13.0	50.9	1
B	6	13.0	101.8	1
B	8	13.0	152.7	1
B	10	13.0	203.6	1
B	13	13.0	254.5	1
B	17	13.0	300.0	17
B	18	6.5	300.0	1
B	19	13.0	300.0	1

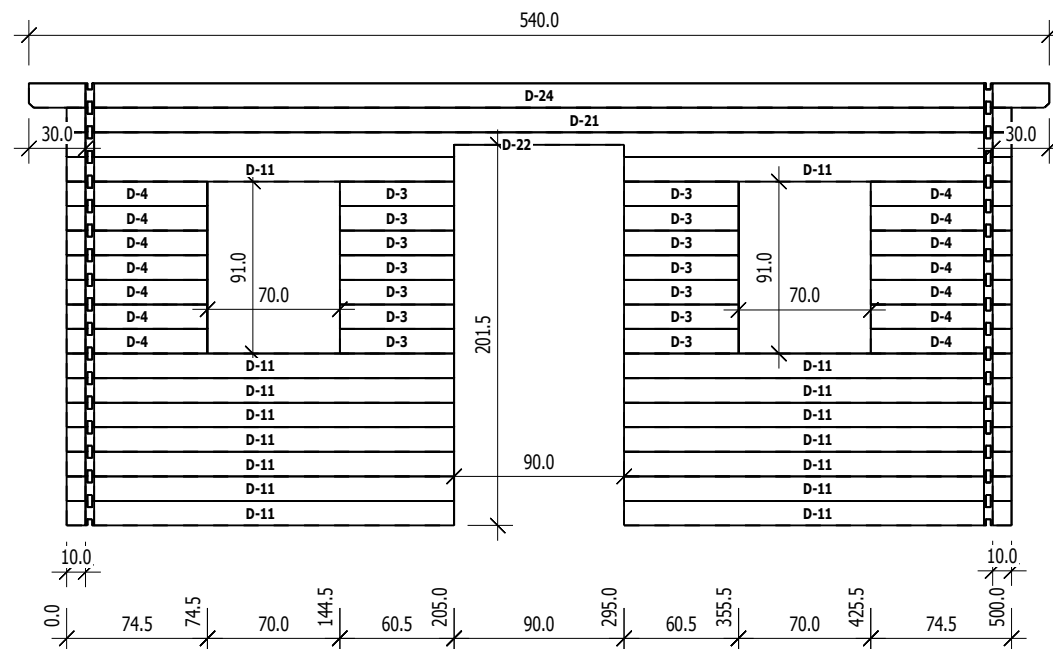

	Nr	H	L	Psc
D	3	13.0	60.5	14
D	4	13.0	74.5	14
D	11	13.0	205.0	16
D	21	13.0	500.0	1
D	22	13.0	500.0	1
D	24	13.0	540.0	1