

Bemerkung: die Ansicht von Turen, Fenster und anderen Teilen kann abweichen von diesem Bild

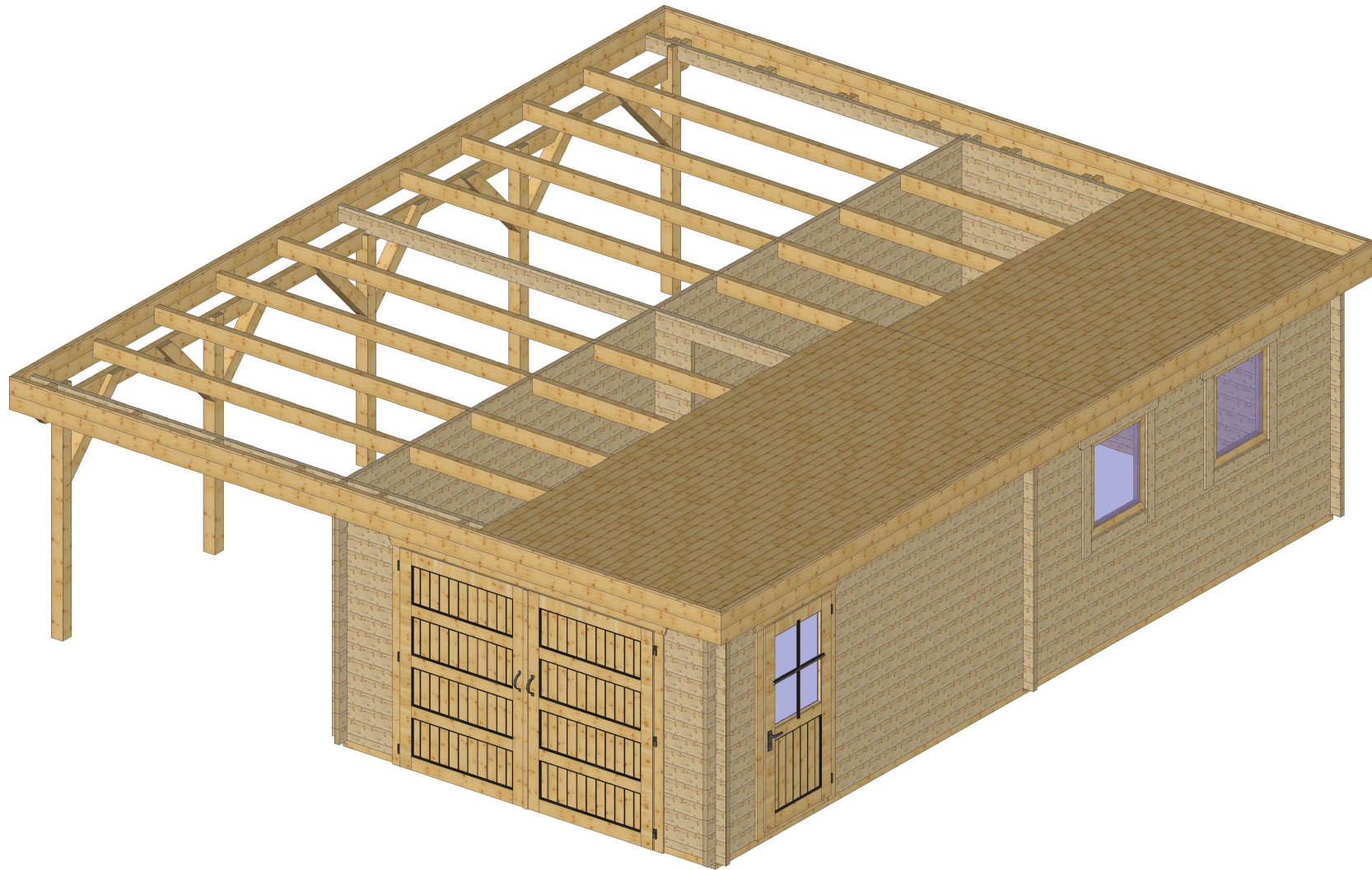



Bemerkung: die Ansicht von Turen, Fenster und anderen Teilen kann abweichen von diesem Bild

Grundriss

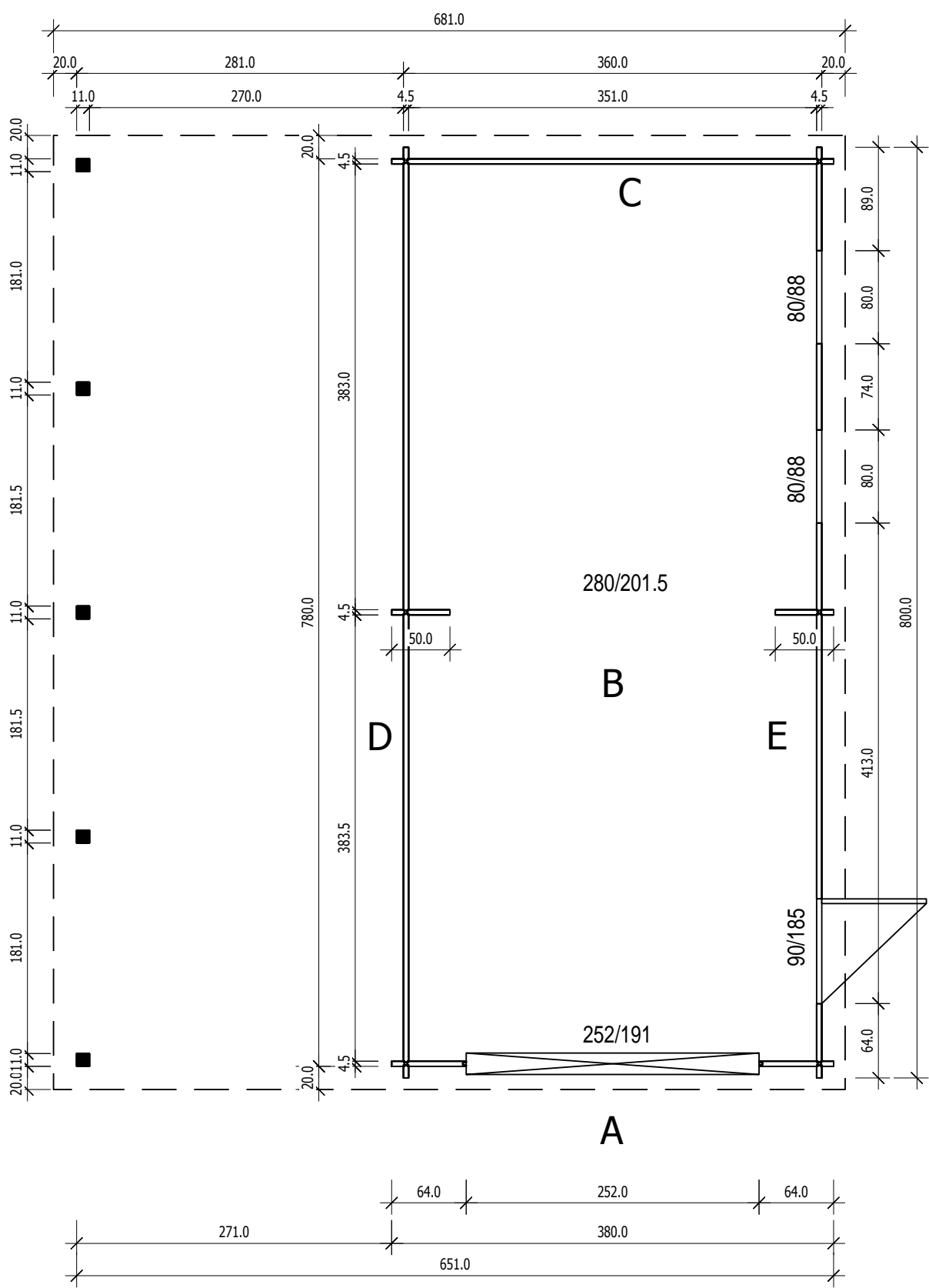

4,5

Schnitt

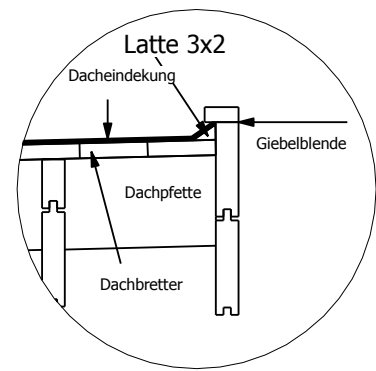
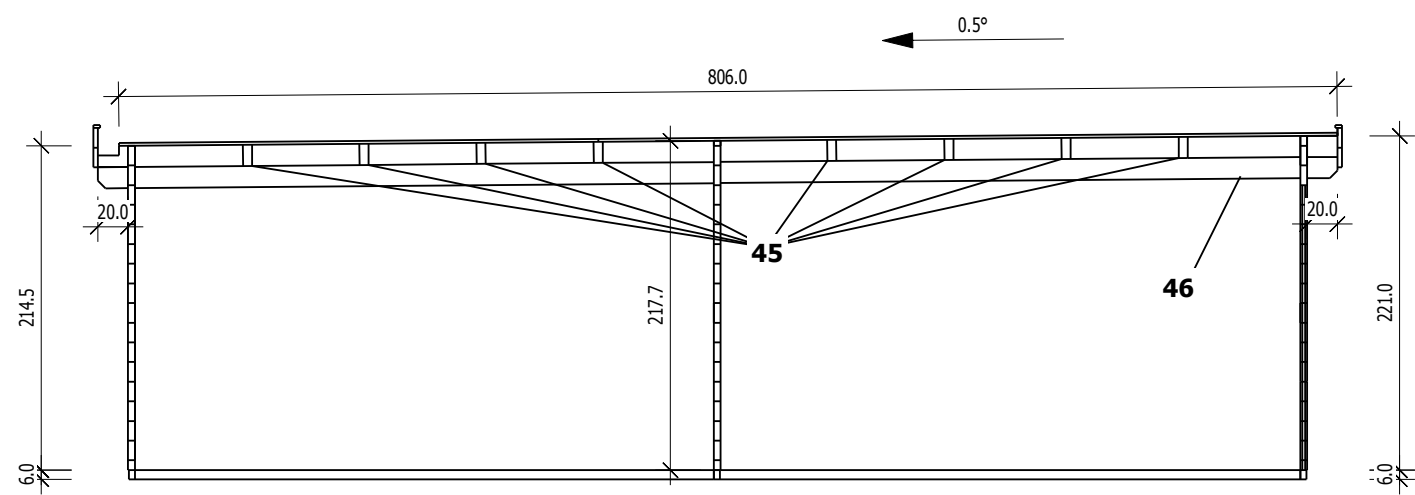

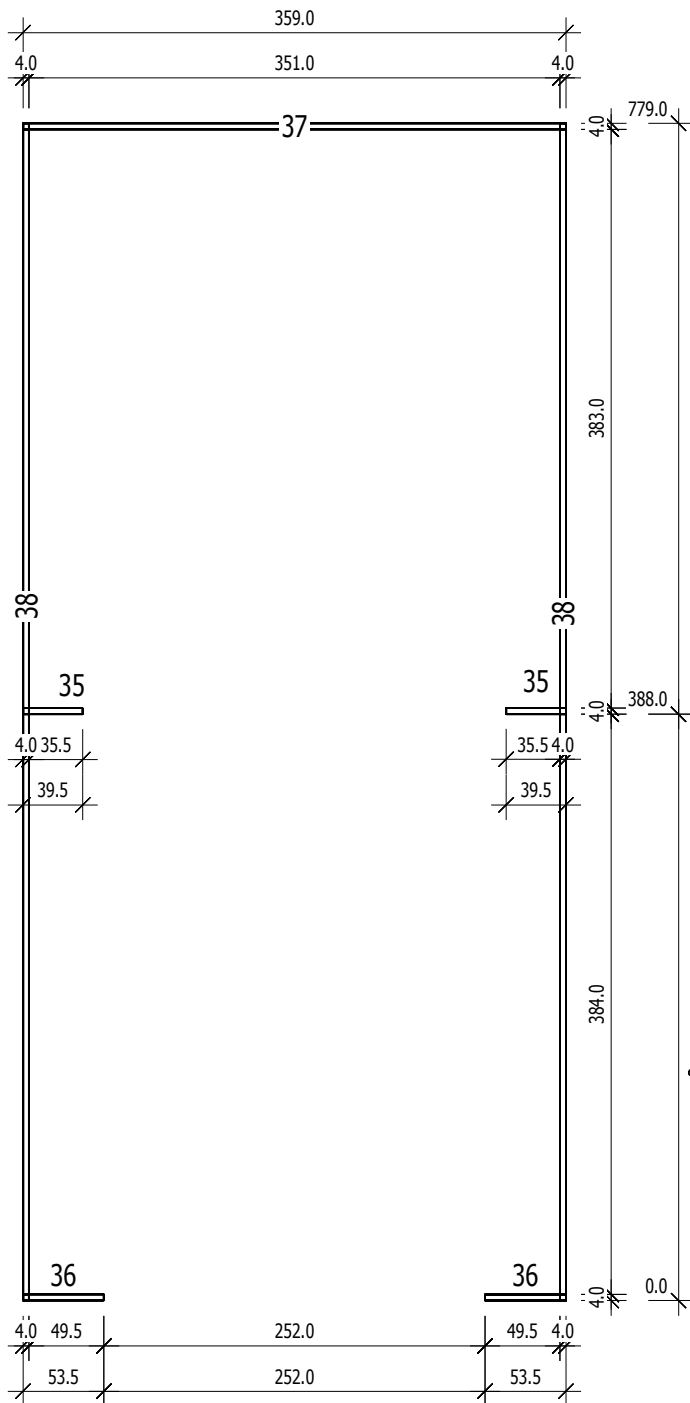

4,5

Grundrahmenplan

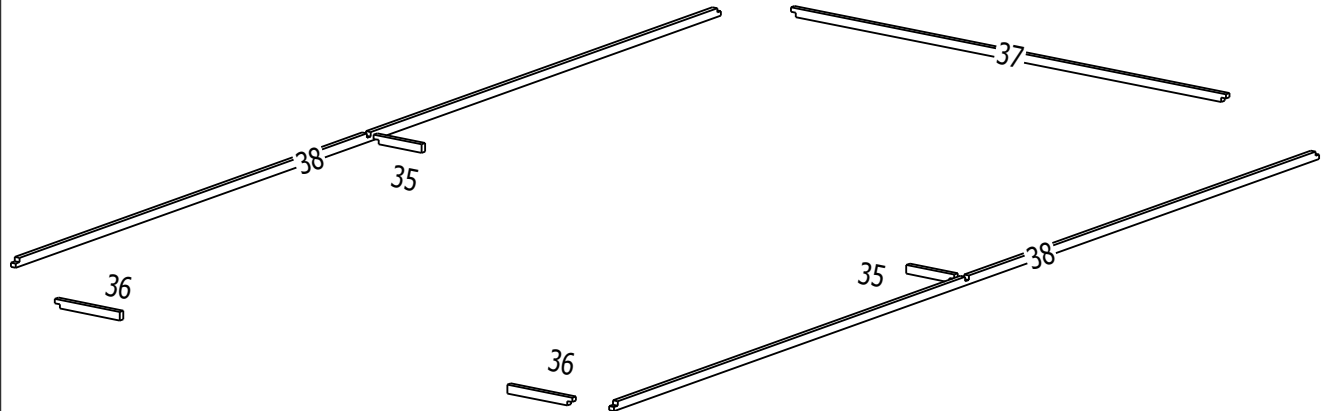

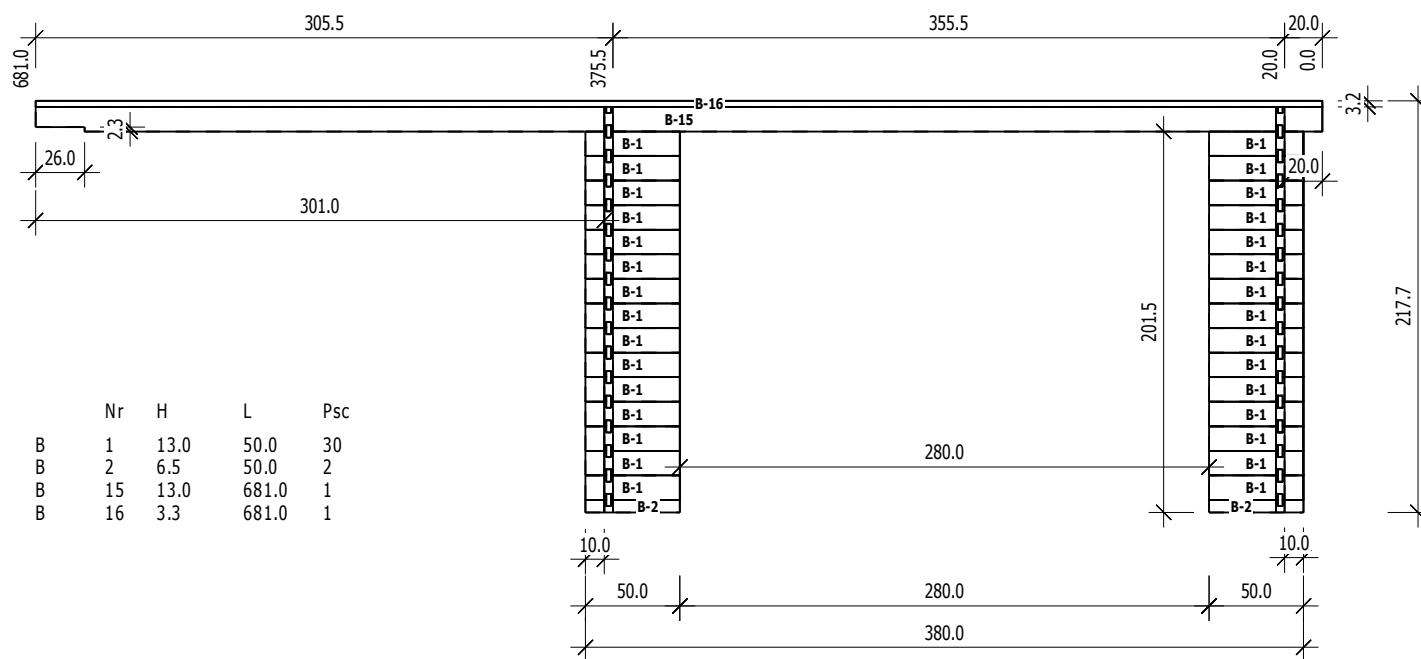
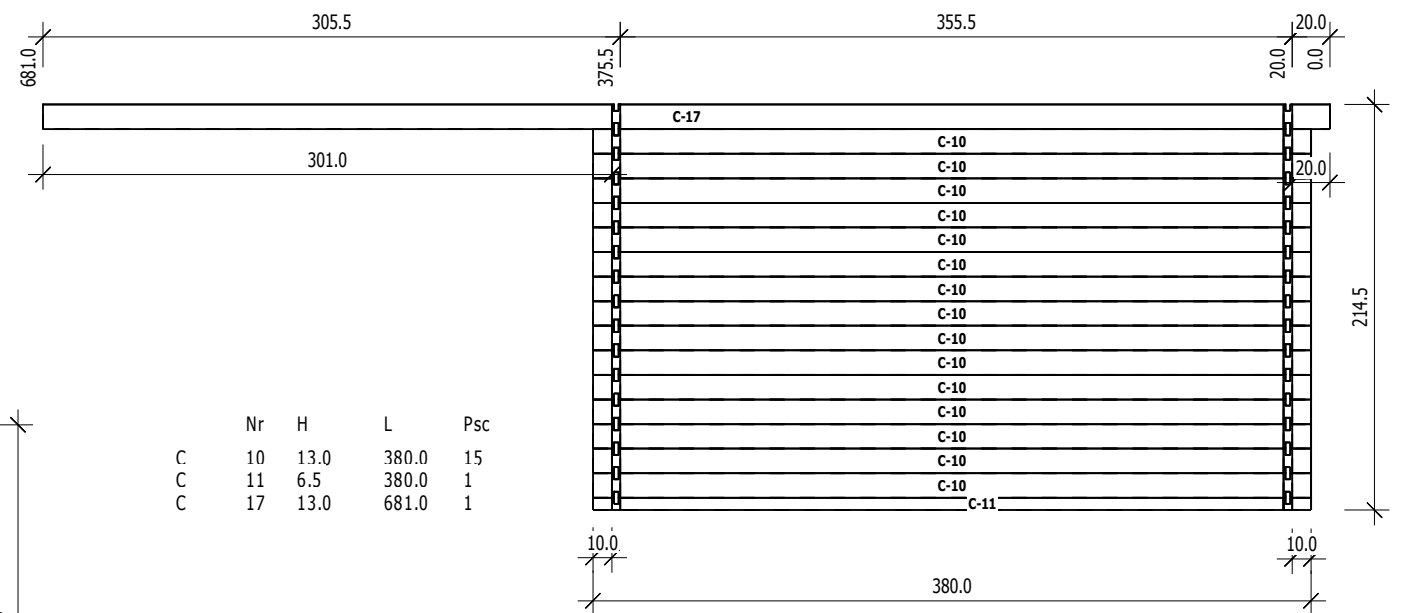
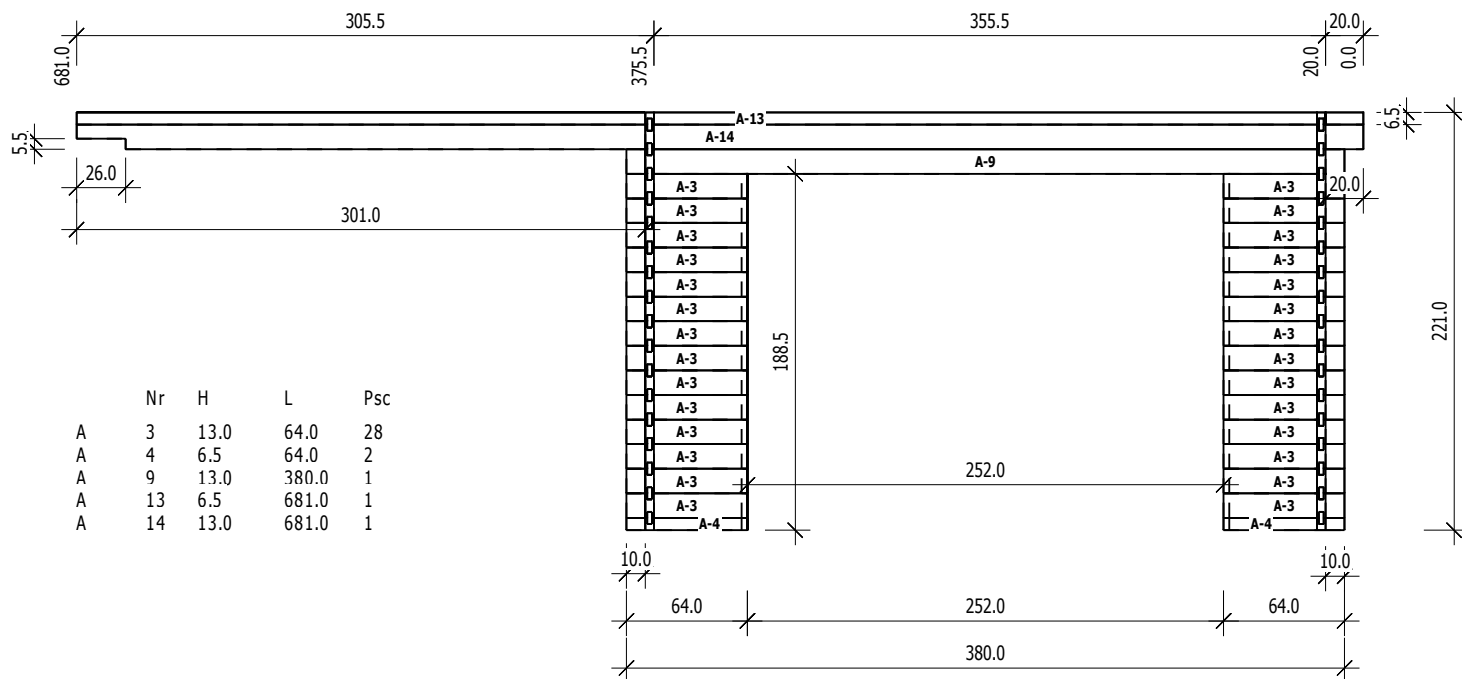

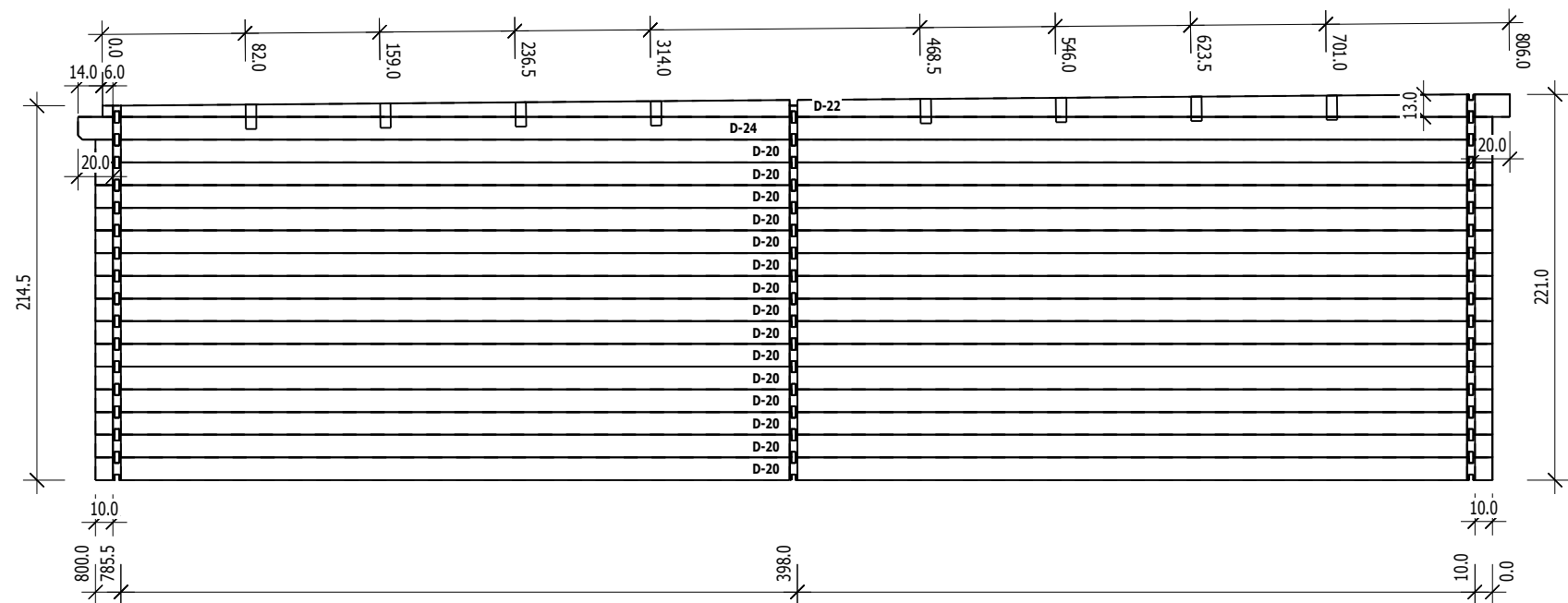

	Nr	H	L	Psc
D	20	13.0	800.0	15
D	22	13.0	806.0	1
D	24	13.0	810.0	1

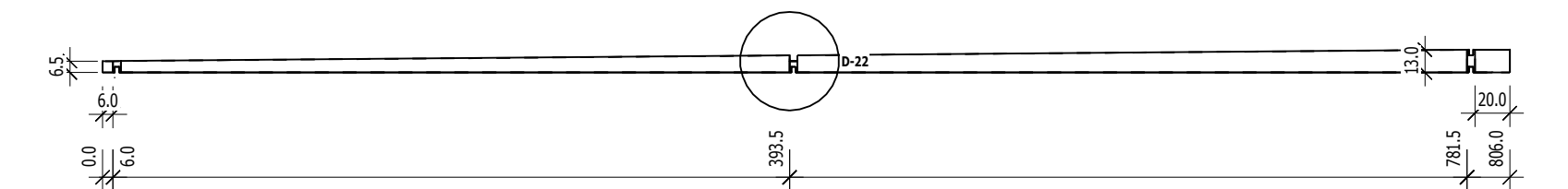
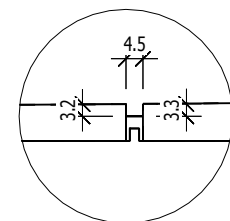

	Nr	H	L	Psc
E	5	13.0	64.0	14
E	6	13.0	74.0	7
E	7	13.0	89.0	7
E	8	13.0	323.0	7
E	12	13.0	646.0	7
E	21	13.0	800.0	1
E	23	13.0	806.0	1
E	25	13.0	810.0	1

