

Bemerkung: die Ansicht von Turen, Fenster und anderen Teilen kann abweichen von diesem Bild

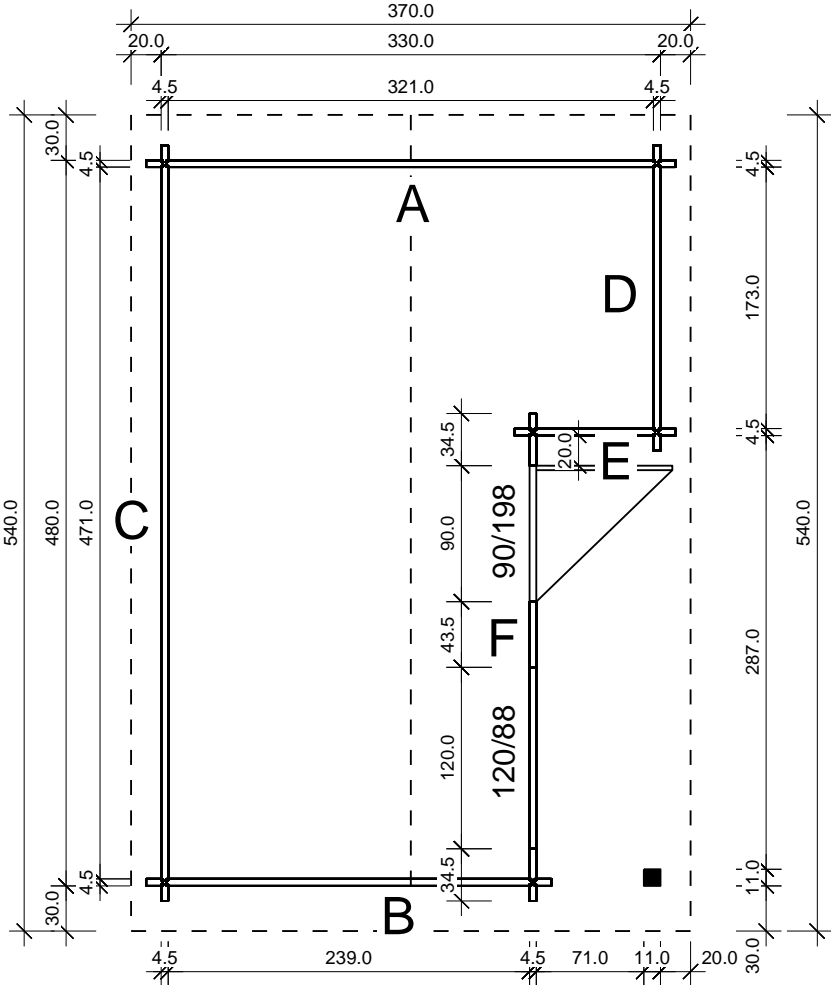

Grundriss



Schnitt

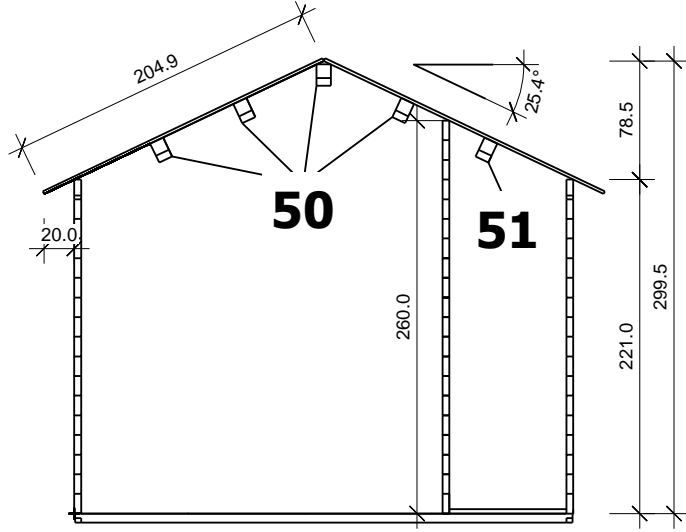

4,5

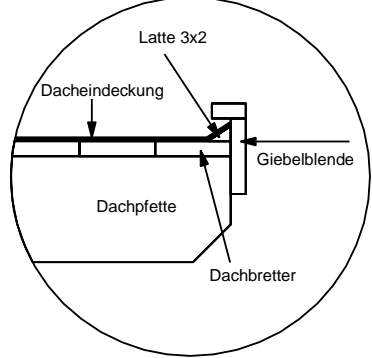

Grundrahmenplan

4,5

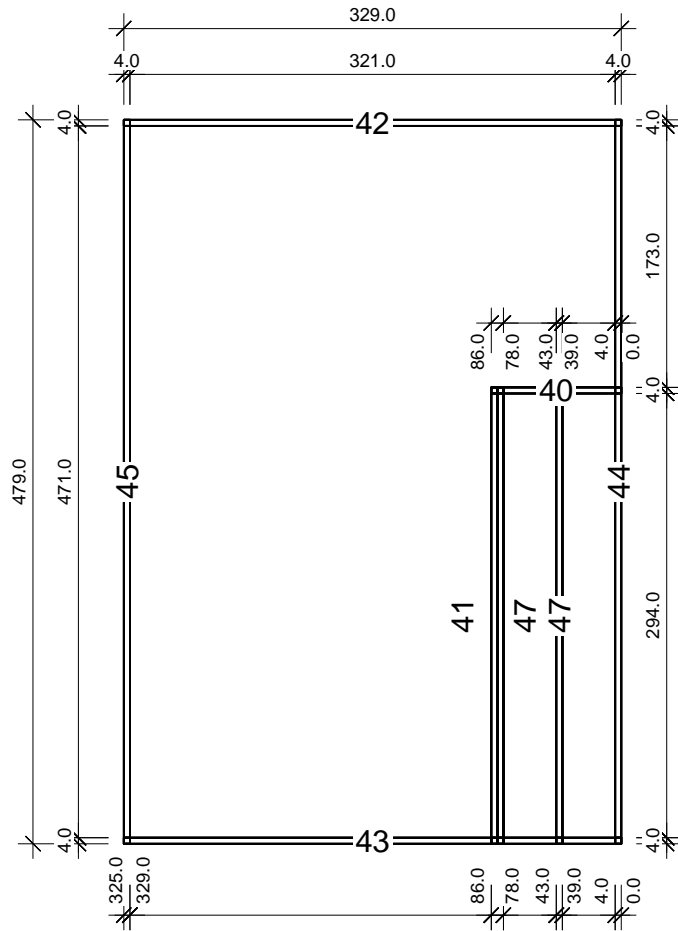

Nr.	B [cm]	H [cm]	L [cm]	Psc
40	4.0	6.0	86.0	1
41	4.0	6.0	302.0	1
42	4.0	6.0	329.0	1
43	4.0	6.0	329.0	1
44	4.0	6.0	479.0	1
45	4.0	6.0	479.0	1
47	4.0	6.0	302.0	2

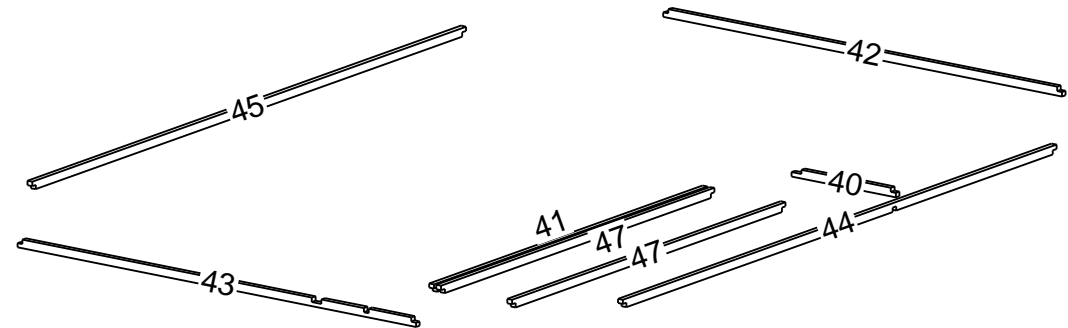

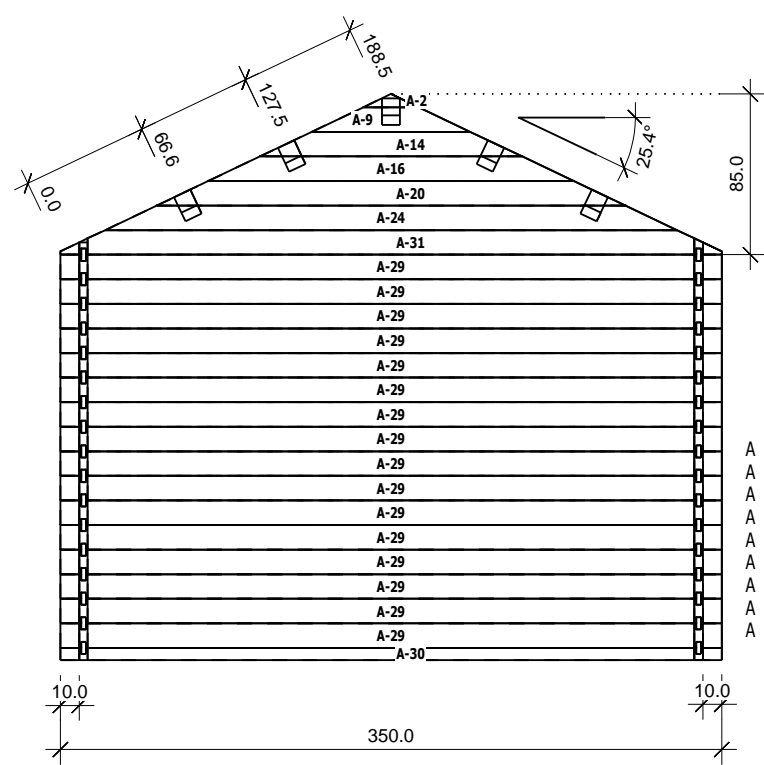

Nr	H	L	Psc
A 2	7.0	29.3	1
A 9	13.0	84.0	1
A 14	13.0	138.7	1
A 16	13.0	193.3	1
A 20	13.0	248.0	1
A 24	13.0	302.7	1
A 29	13.0	350.0	16
A 30	6.5	350.0	1
A 31	13.0	350.0	1

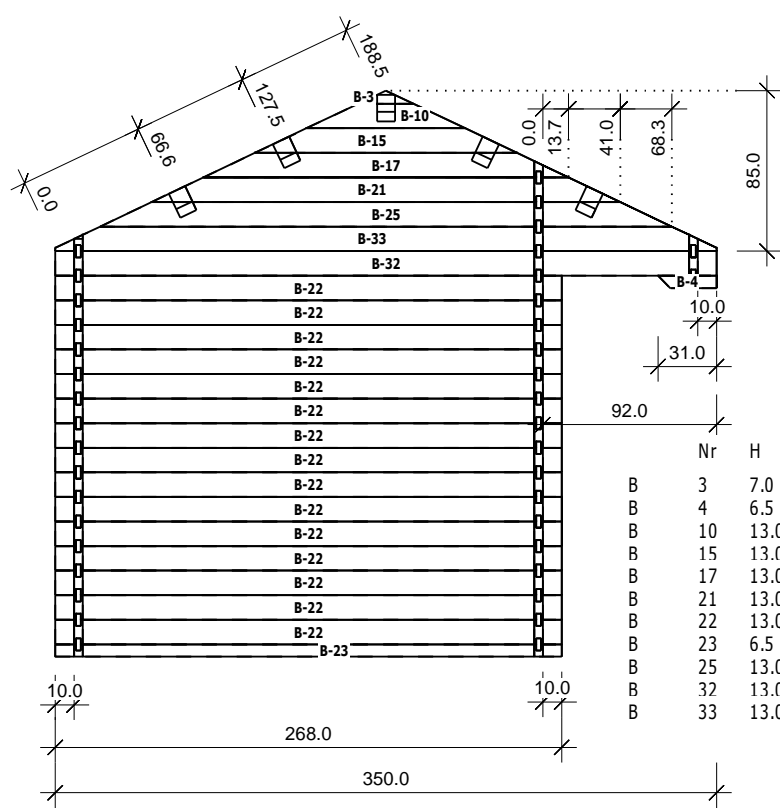

Nr	H	L	Psc
B 3	7.0	29.3	1
B 4	6.5	31.0	1
B 10	13.0	84.0	1
B 15	13.0	138.7	1
B 17	13.0	193.3	1
B 21	13.0	248.0	1
B 25	13.0	268.0	15
B 22	6.5	268.0	1
B 22	13.0	302.7	1
B 22	13.0	350.0	1
B 22	13.0	350.0	1
B 23	13.0	350.0	1

Nr	H	L	Psc
F 5	13.0	34.5	22
F 6	13.0	43.5	7
F 18	13.0	198.0	8
F 26	13.0	322.5	3
F 27	13.0	322.5	1
F 28	13.0	322.5	1

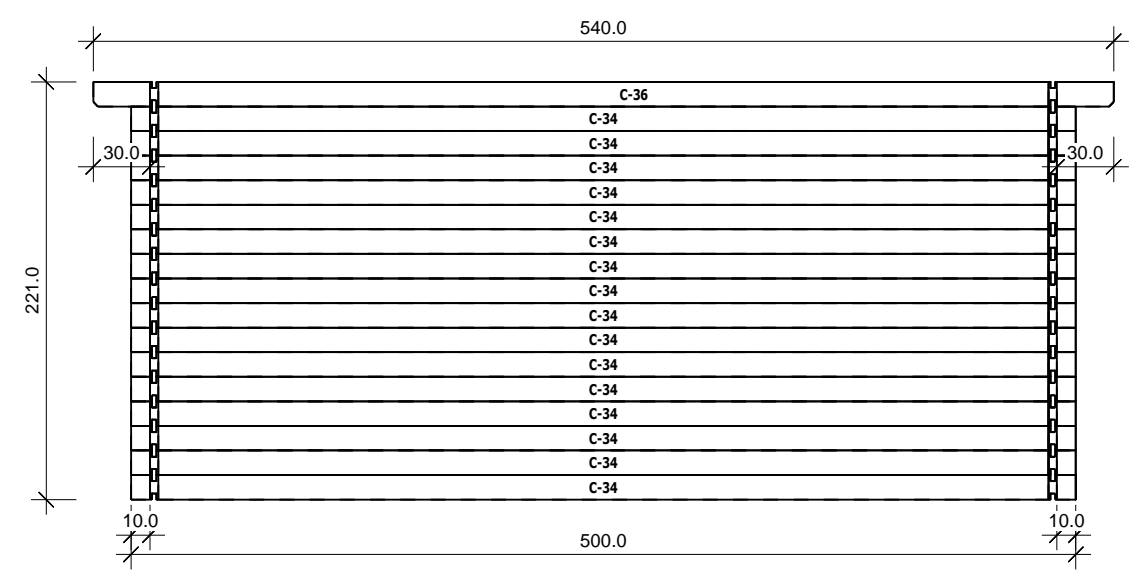
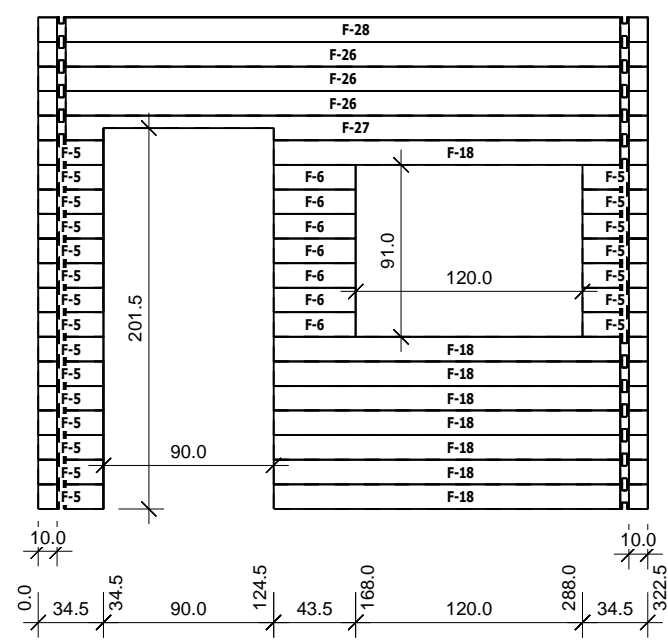

Nr	H	L	Psc
C 34	13.0	500.0	16
C 36	13.0	540.0	1

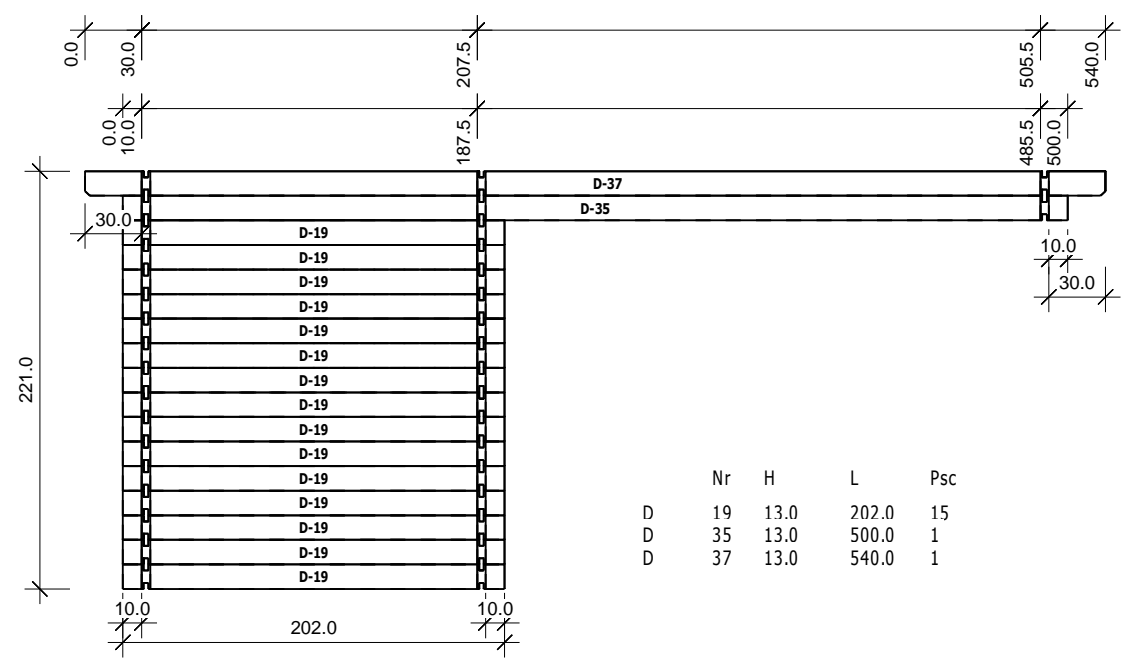

Nr	H	L	Psc
D 19	13.0	202.0	15
D 35	13.0	500.0	1
D 37	13.0	540.0	1

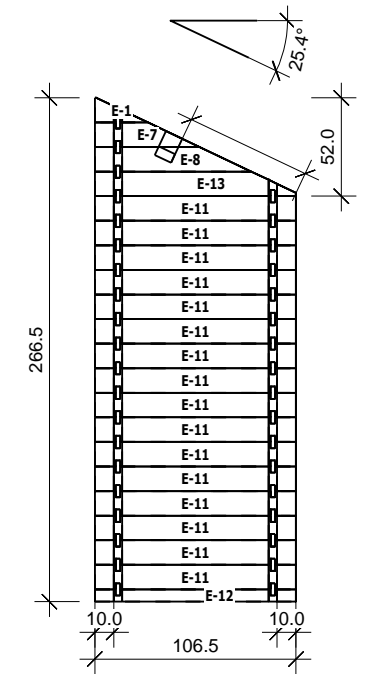

Nr	H	L	Psc
E 1	13.0	28.2	1
E 7	13.0	55.5	1
E 8	13.0	82.8	1
E 11	13.0	106.5	16
E 12	6.5	106.5	1