



Bemerkung: die Ansicht von Turen, Fenster und anderen Teilen kann abweichen von diesem Bild



Grundrahmenplan

3,0

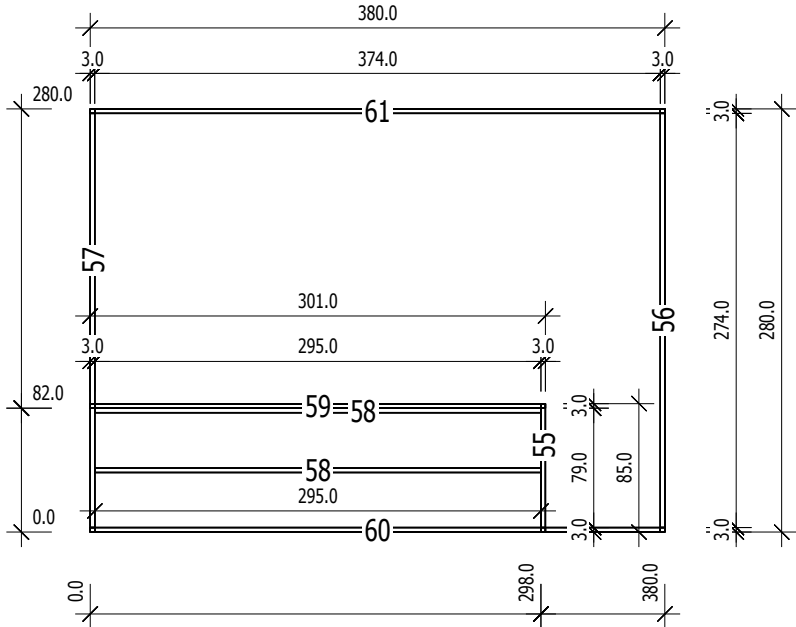

Nr.	B	H	L	Psc
	[cm]	[cm]	[cm]	
55	3,0	6,0	85,0	1
56	3,0	6,0	280,0	1
57	3,0	6,0	280,0	1
58	3,0	6,0	295,0	2
59	3,0	6,0	301,0	1
60	3,0	6,0	380,0	1
61	3,0	6,0	380,0	1

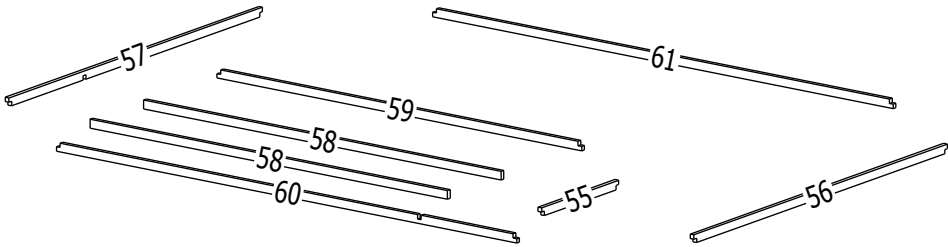

A

Ansicht von Aussen

M 1:40

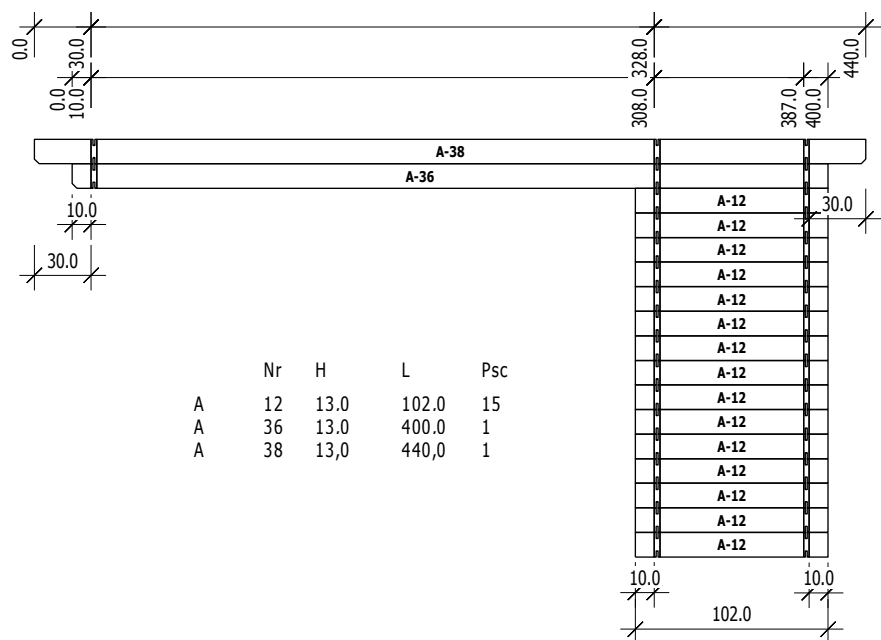

B

Ansicht von Aussen

M 1:40

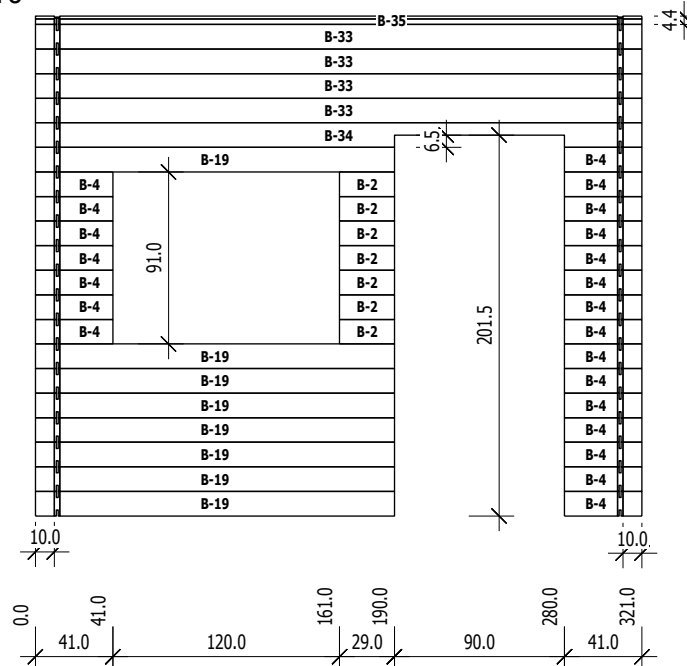

C

View from inside

M 1:40

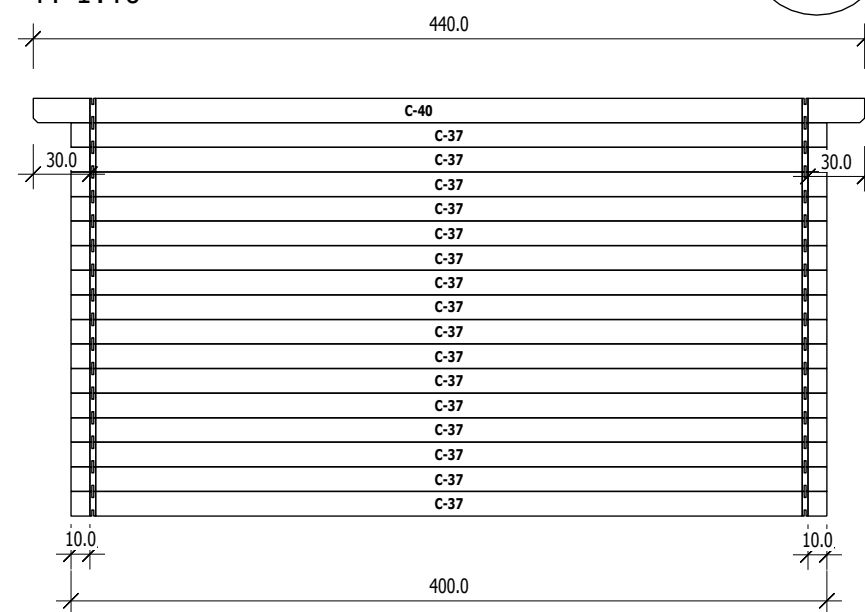

3,0

D

Ansicht von Aussen

M 1:40

Gegnes 6,5x17,5

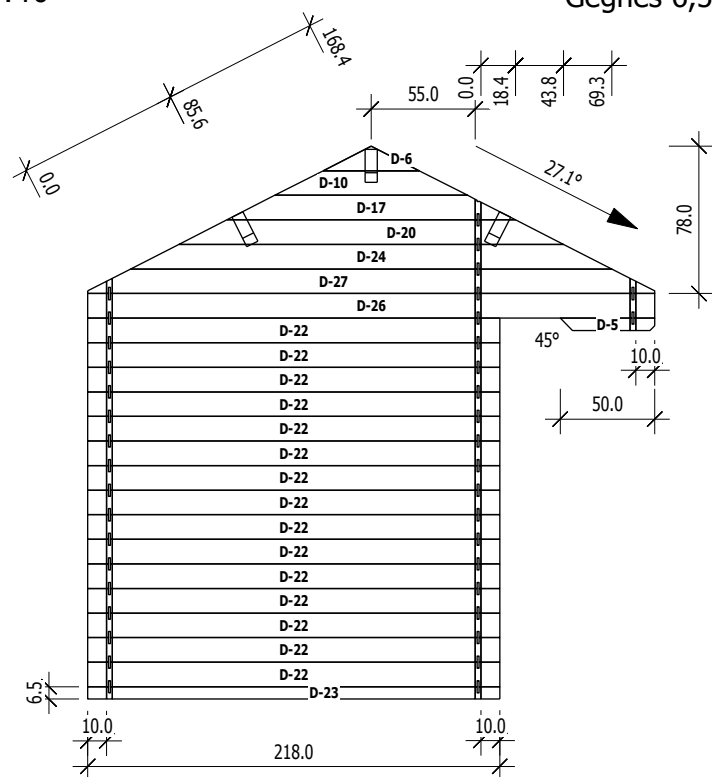

E

Ansicht von Aussen

M 1:40

Gegnes 6,5x17,5

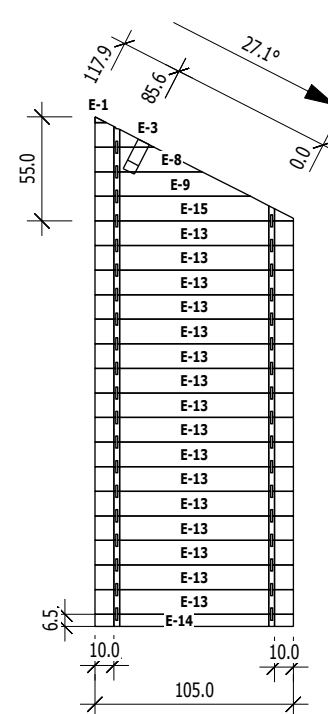

Zr. Brzn. B- 35

F

View from inside

M 1:40

Gegnes 6,5x17,5

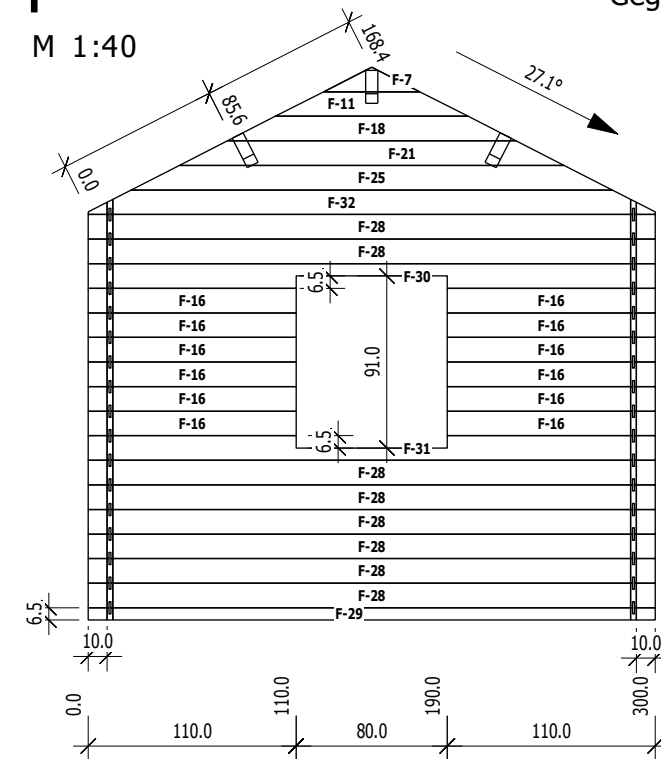

Nr	H	L	Psc
D 5	6.5	50.0	1
D 6	13.0	50.9	1
D 10	13.0	101.8	1
D 17	13.0	152.7	1
D 20	13.0	203.6	1
D 22	13.0	218.0	15
D 23	6.5	218.0	1
D 24	13.0	254.5	1
D 26	13.0	300.0	1
D 27	13.0	300.0	1

Nr	H	L	Psc
E 1	3.0	5.9	1
E 3	13.0	31.4	1
E 8	13.0	56.8	1
E 9	13.0	82.3	1
E 13	13.0	105.0	16
E 14	6.5	105.0	1
E 15	13.0	105.0	1

Nr	H	L	Psc
F 7	13.0	50.9	1
F 11	13.0	101.8	1
F 16	13.0	110.0	12
F 18	13.0	152.7	1
F 21	13.0	203.6	1
F 25	13.0	254.5	1
F 28	13.0	300.0	8
F 29	6.5	300.0	1
F 30	13.0	300.0	1
F 31	13.0	300.0	1
F 32	13.0	300.0	1