

Bemerkung: die Ansicht von Turen, Fenster und anderen Teilen kann abweichen von diesem Bild

Grundriss

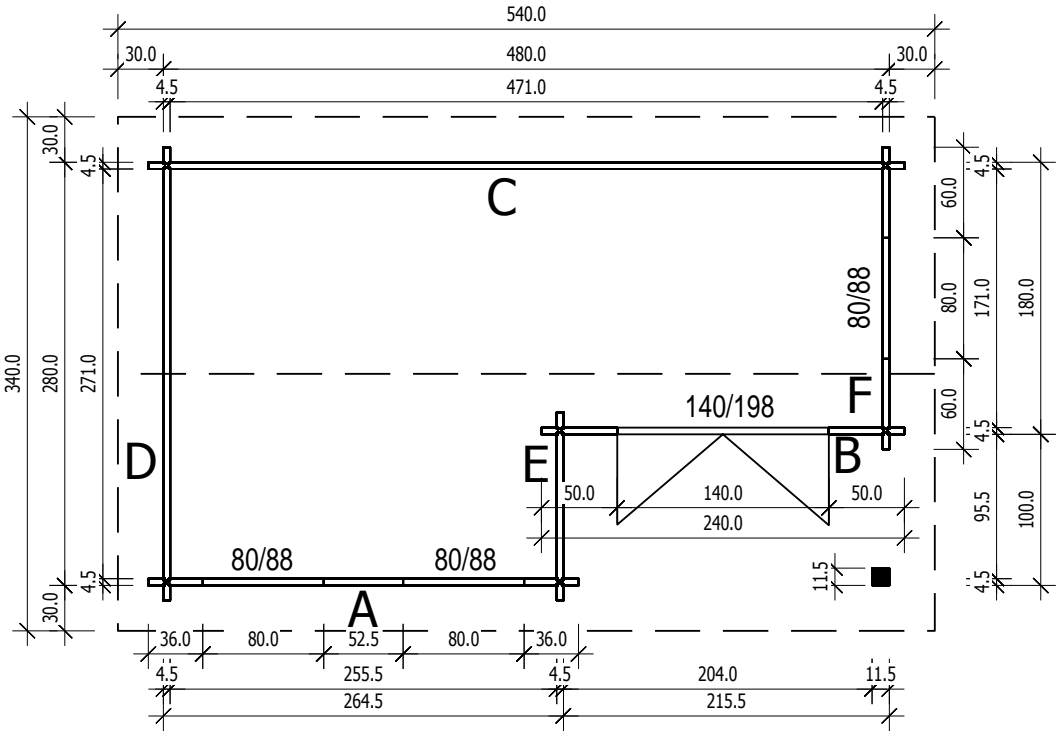

4,5

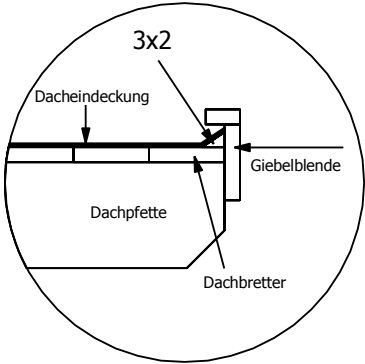

Schnitt

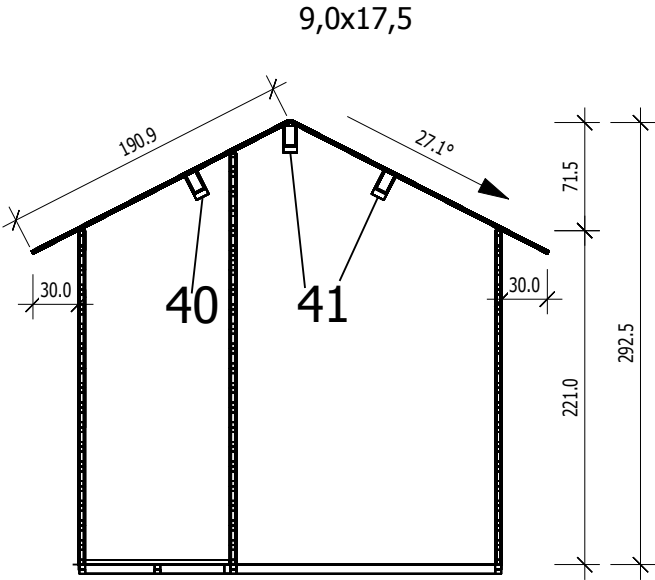

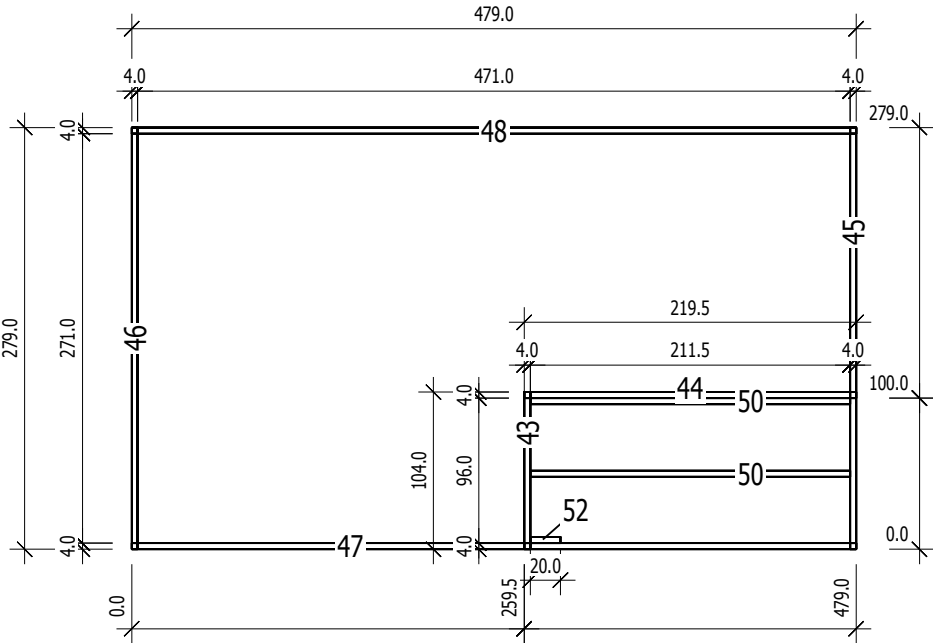

Grundrahmenplan

Nr.	B	H	L	Psc
	[cm]	[cm]	[cm]	
=====				
43	4,0	6,0	104,0	1
44	4,0	6,0	219,5	1
45	4,0	6,0	279,0	1
46	4,0	6,0	279,0	1
47	4,0	6,0	479,0	1
48	4,0	6,0	479,0	1
50	4,0	6,0	211,5	2
52	4,0	6,0	20,0	1

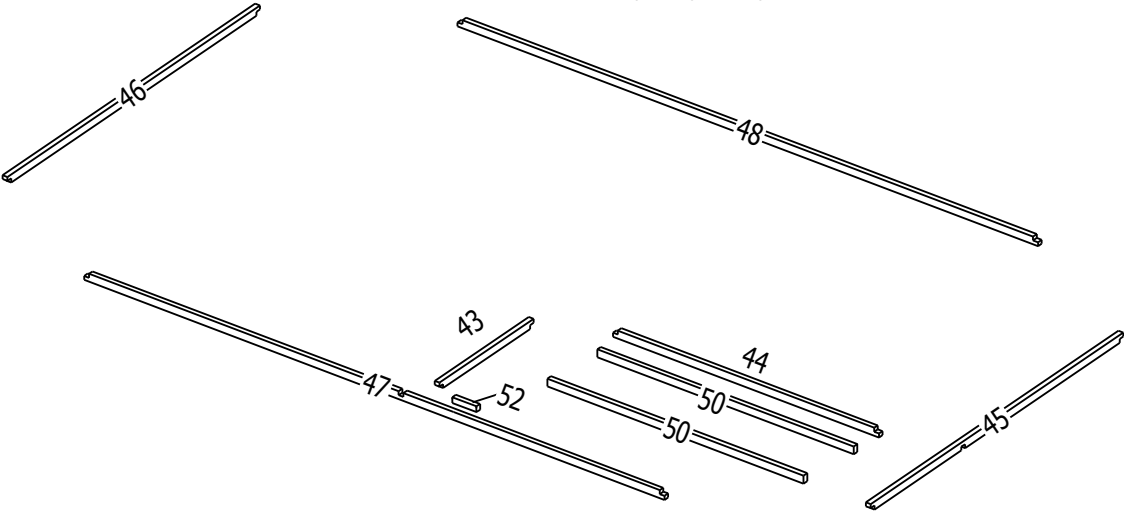

A
Ansicht von Aussen
M 1:40

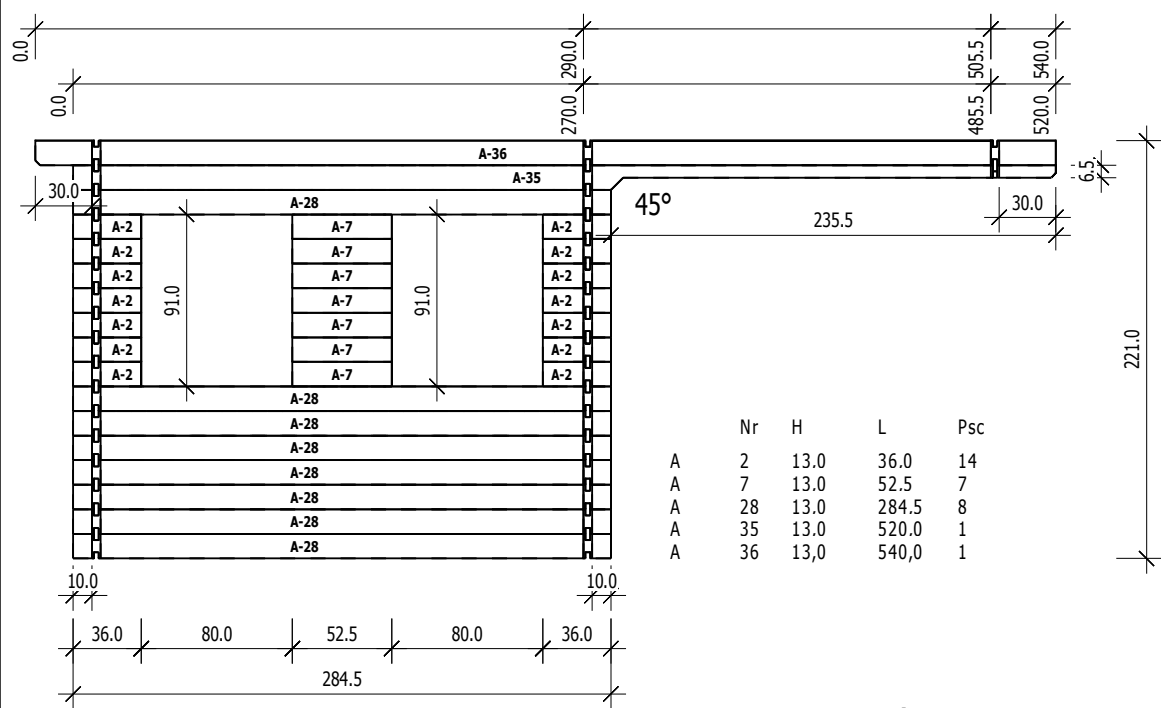

	Nr	H	L	Psc
A	2	13.0	36.0	14
A	7	13.0	52.5	7
A	28	13.0	284.5	8
A	35	13.0	520.0	1
A	36	13,0	540,0	1

C
Ansicht von Innen
M 1:40

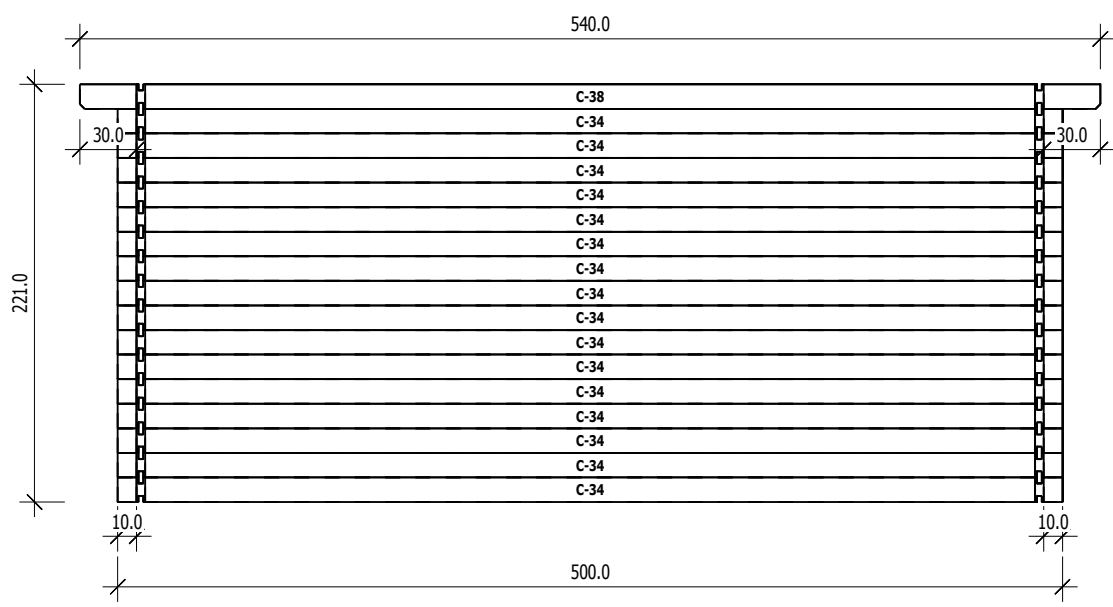

	Nr	H	L	Psc
C	34	13.0	500.0	16
C	38	13,0	540,0	1

B
Ansicht von Aussen
M 1:40

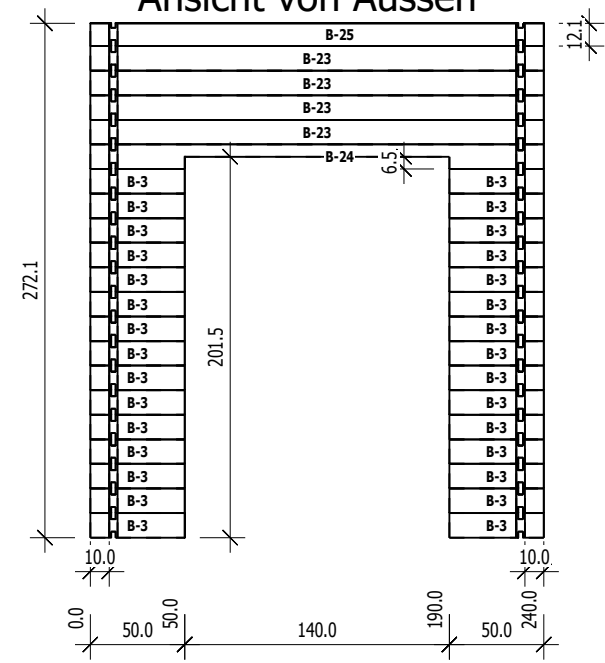

	Nr	H	L	Psc
B	3	13.0	50.0	30
B	23	13.0	240.0	4
B	24	13.0	240.0	1
B	25	12,1	240,0	1

D
Ansicht von Aussen
M 1:40

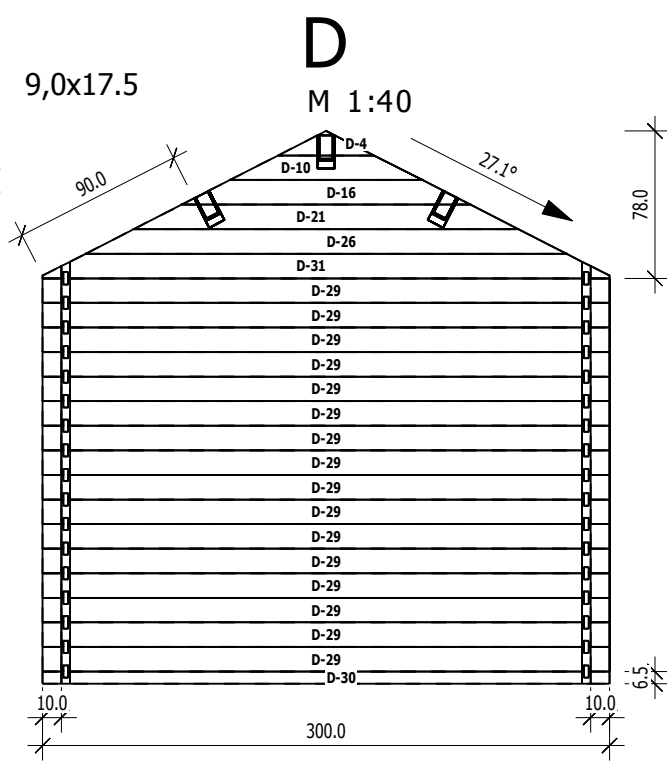

	Nr	H	L	Psc
D	4	13.0	50.9	1
D	10	13.0	101.8	1
D	16	13.0	152.7	1
D	21	13.0	203.6	1
D	26	13.0	254.5	1
D	29	13.0	300.0	16
D	30	6.5	300.0	1
D	31	13,0	300,0	1

E
Ansicht von Innen
M 1:40

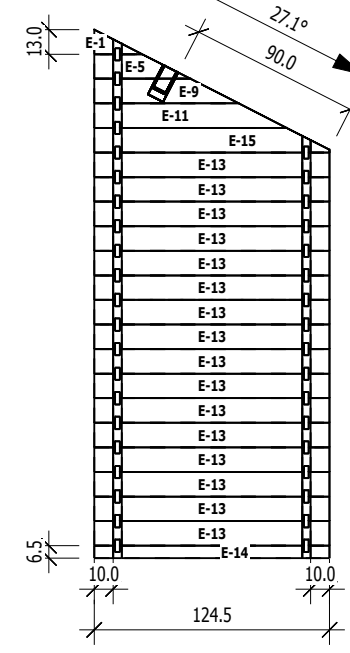

	Nr	H	L	Psc
E	1	13.0	25.4	1
E	5	13.0	50.9	1
E	9	13.0	76.3	1
E	11	13.0	101.8	1
E	13	13.0	124.5	16
E	14	6.5	124.5	1
E	15	13,0	124,5	1

F
Ansicht von Innen
M 1:40

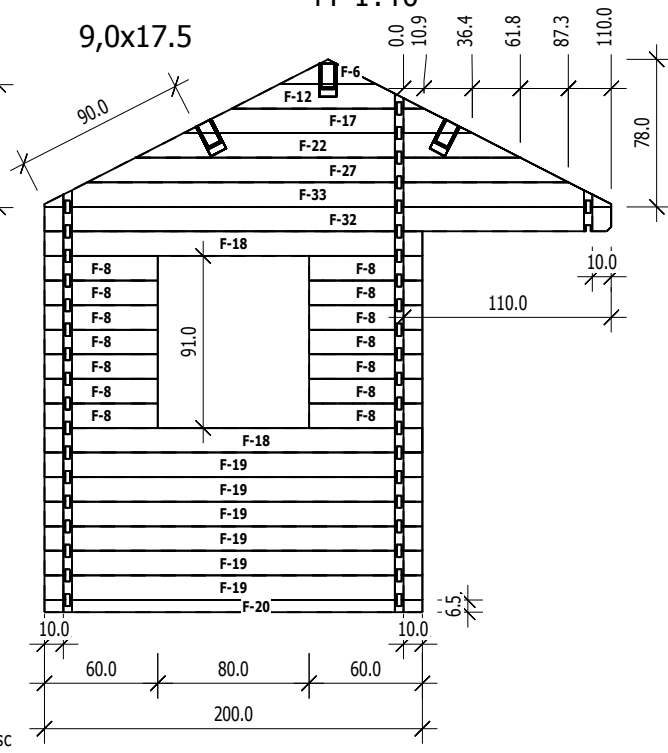

	Nr	H	L	Psc
F	6	13.0	50.9	1
F	8	13.0	60.0	14
F	12	13.0	101.8	1
F	17	13.0	152.7	1
F	18	13.0	200.0	2
F	19	13.0	200.0	6
F	20	6.5	200.0	1
F	22	13.0	203.6	1
F	27	13.0	254.5	1
F	32	13.0	300.0	1
F	33	13,0	300,0	1