



Bemerkung: die Ansicht von Turen, Fenster und anderen Teilen kann abweichen von diesem Bild



4,5

# Grundrahmenplan

Nr.	B [cm]	H [cm]	L [cm]	Psc
55	4.0	6.0	20.0	1
56	4.0	6.0	104.0	1
57	4.0	6.0	211.0	2
58	4.0	6.0	219.0	1
59	4.0	6.0	379.0	1
60	4.0	6.0	379.0	1
61	4.0	6.0	575.0	1
62	4.0	6.0	575.0	1

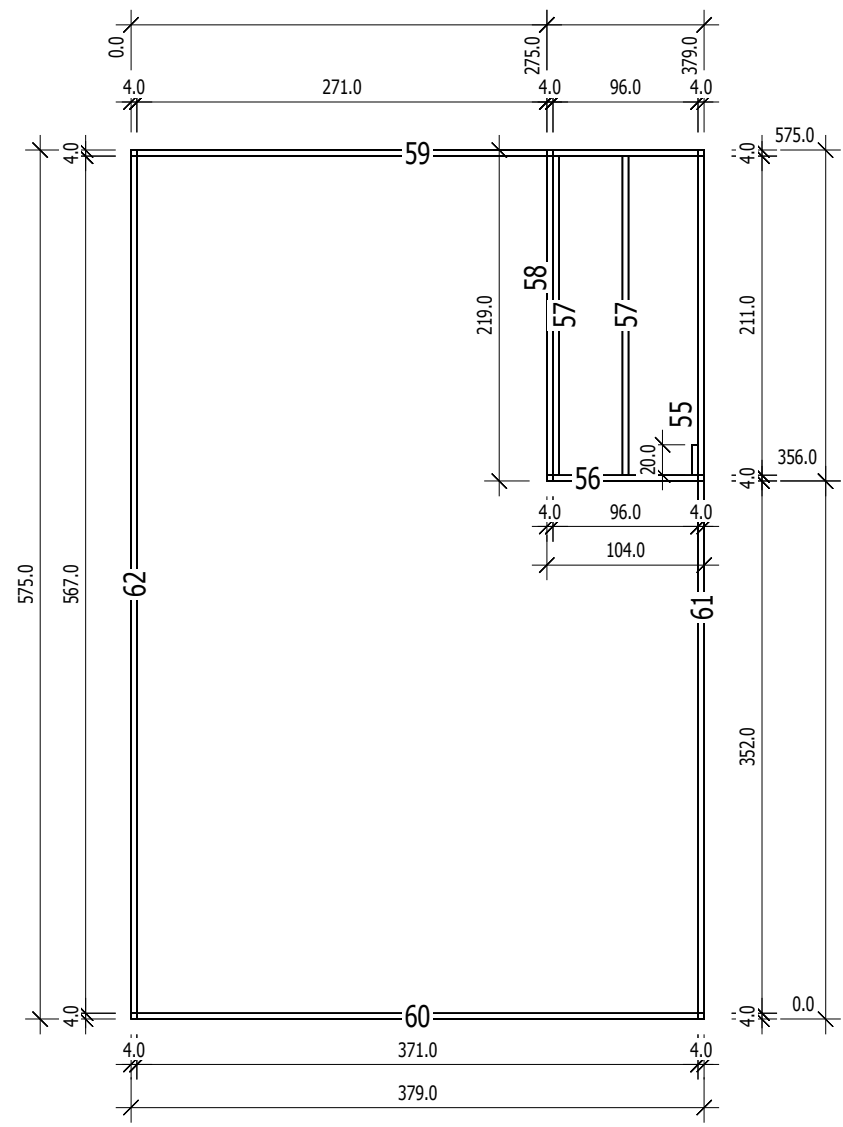
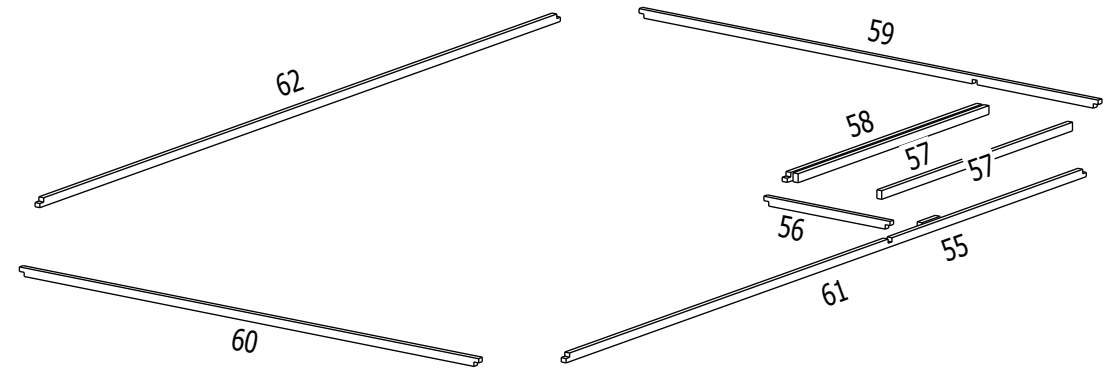

**A**  
M 1:40

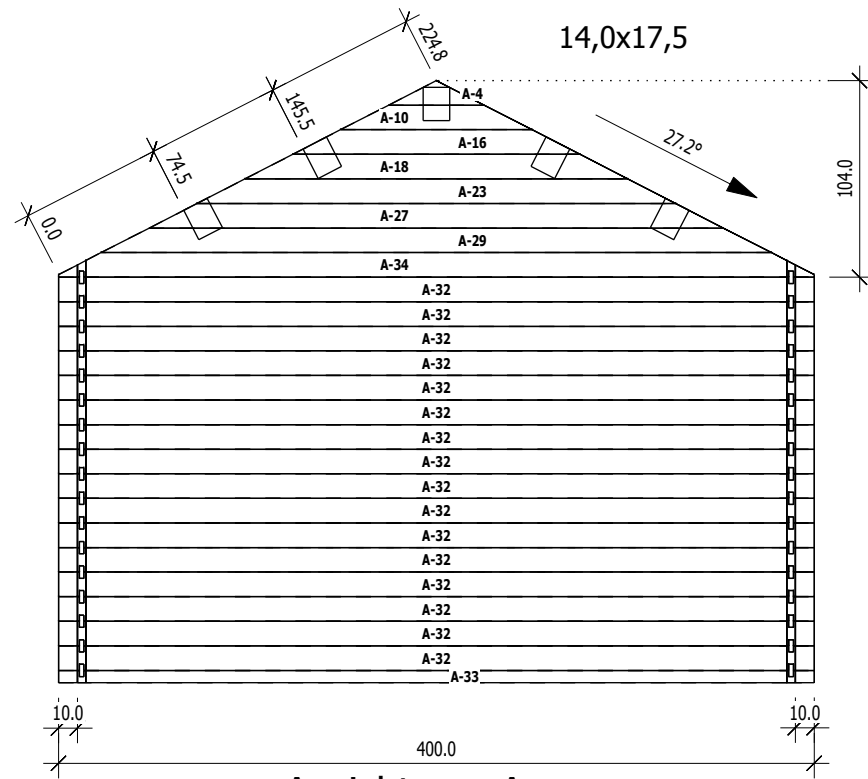

Nr	H	L	Psc
A 4	13.0	50.7	1
A 10	13.0	101.3	1
A 16	13.0	152.0	1
A 18	13.0	202.7	1
A 23	13.0	253.3	1
A 27	13.0	304.0	1
A 29	13.0	354.7	1
A 32	13.0	400.0	16
A 33	6.5	400.0	1
A 34	13.0	400.0	1

Ansicht von Aussen

**C**  
M 1:40

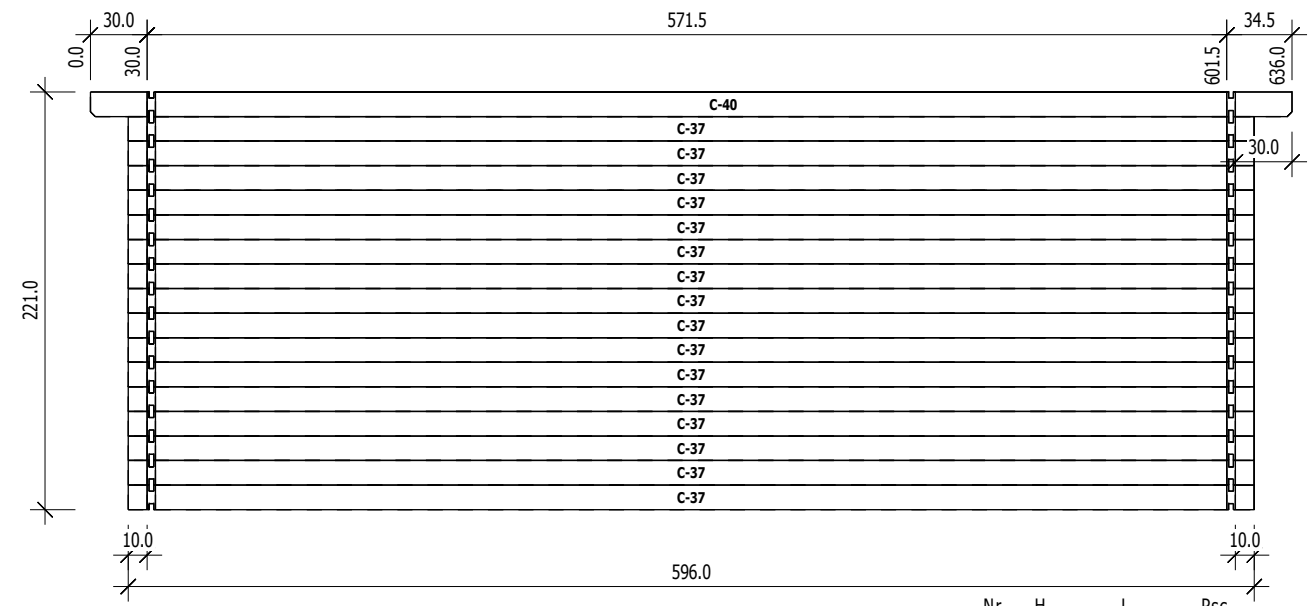

Nr	H	L	Psc
C 37	13.0	596.0	16
C 40	13.0	636.0	1

Ansicht von Aussen

**B**  
M 1:40

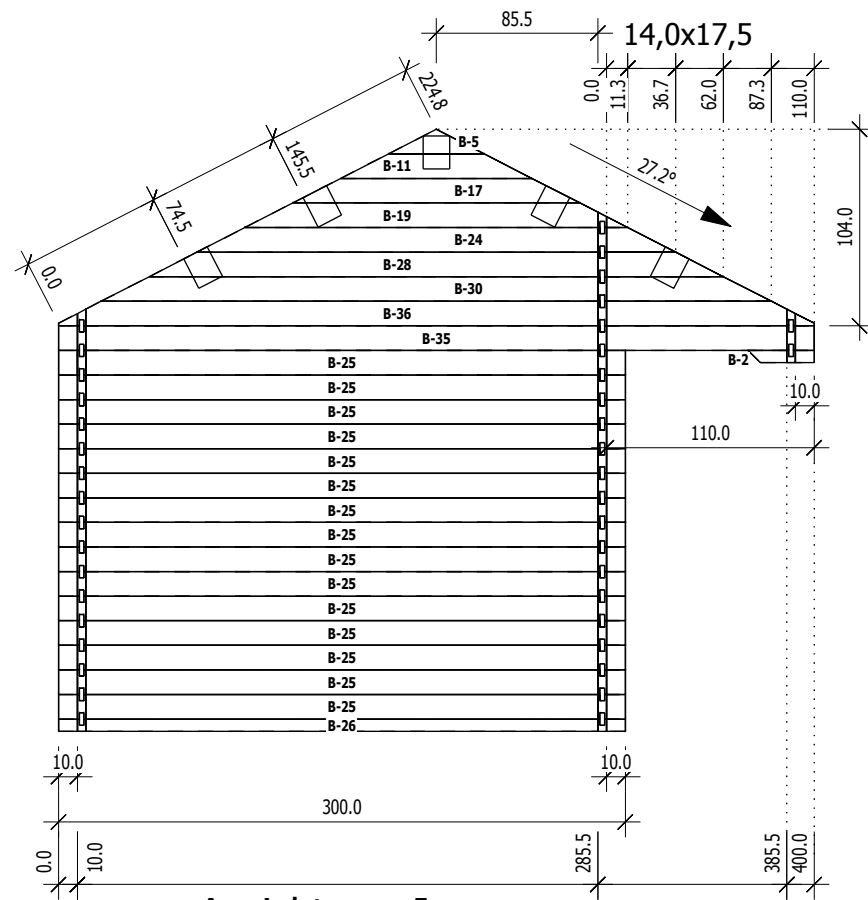

Nr	H	L	Psc
B 2	6.5	35.0	1
B 5	13.0	50.7	1
B 11	13.0	101.3	1
B 17	13.0	152.0	1
B 19	13.0	202.7	1
B 24	13.0	253.3	1
B 25	13.0	300.0	15
B 26	6.5	300.0	1
B 28	13.0	304.0	1
B 30	13.0	354.7	1
B 35	13.0	400.0	1
B 36	13.0	400.0	1

Ansicht von Innen

**D**  
M 1:40

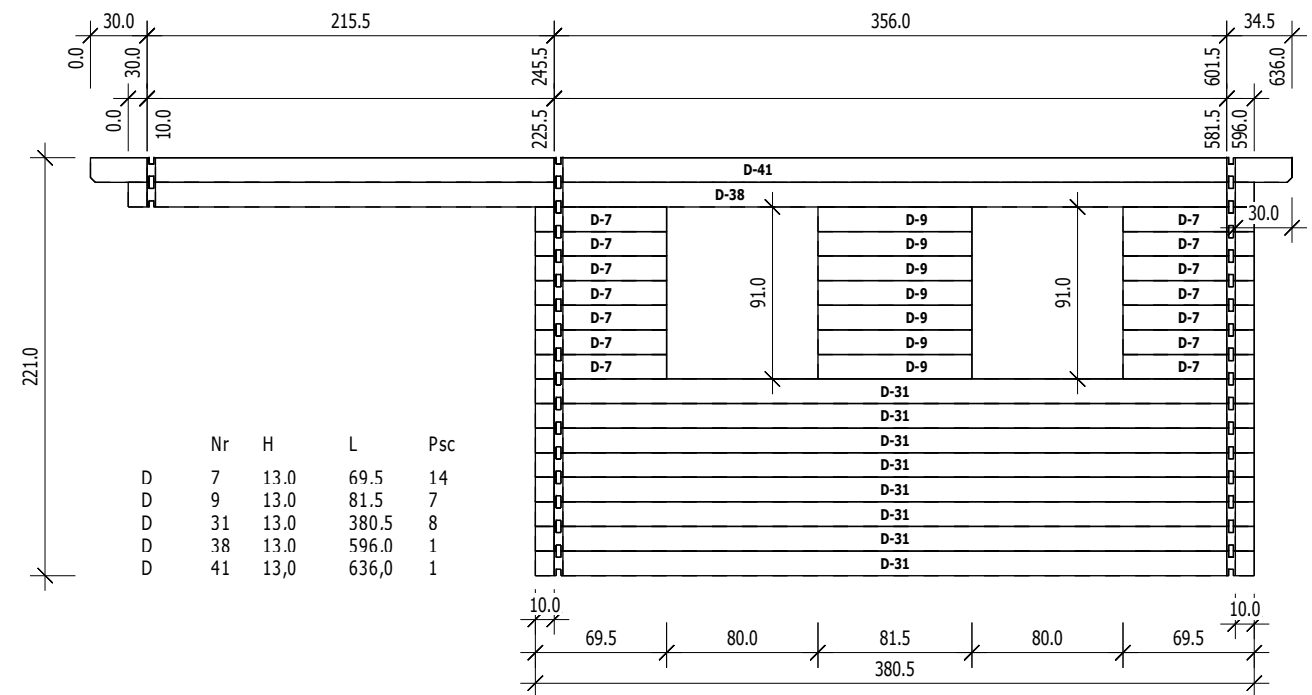

Nr	H	L	Psc
D 7	13.0	69.5	14
D 9	13.0	81.5	7
D 31	13.0	380.5	8
D 38	13.0	596.0	1
D 41	13.0	636.0	1

Ansicht von Innen

**E**  
M 1:40

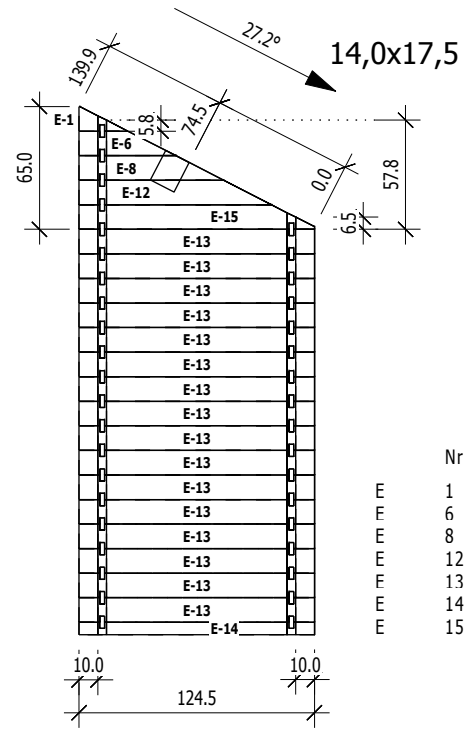

	Nr	H	L	Psc
E	1	13.0	25.8	1
E	6	13.0	51.2	1
E	8	13.0	76.5	1
E	12	13.0	101.8	1
E	13	13.0	124.5	16
E	14	6.5	124.5	1
E	15	13.0	124.5	1

Ansicht von Innen

**F**  
M 1:40

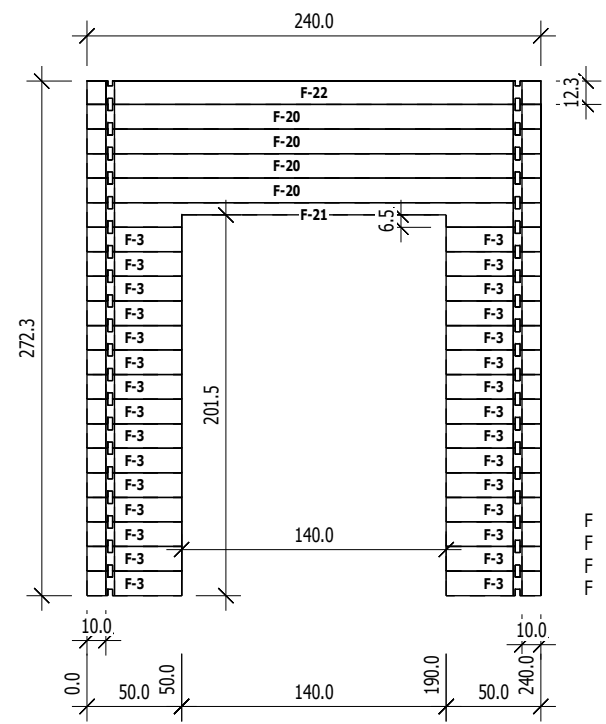

	Nr	H	L	Psc
F	3	13.0	50.0	30
F	20	13.0	240.0	4
F	21	13.0	240.0	1
F	22	12.3	240.0	1

Ansicht von Innen