

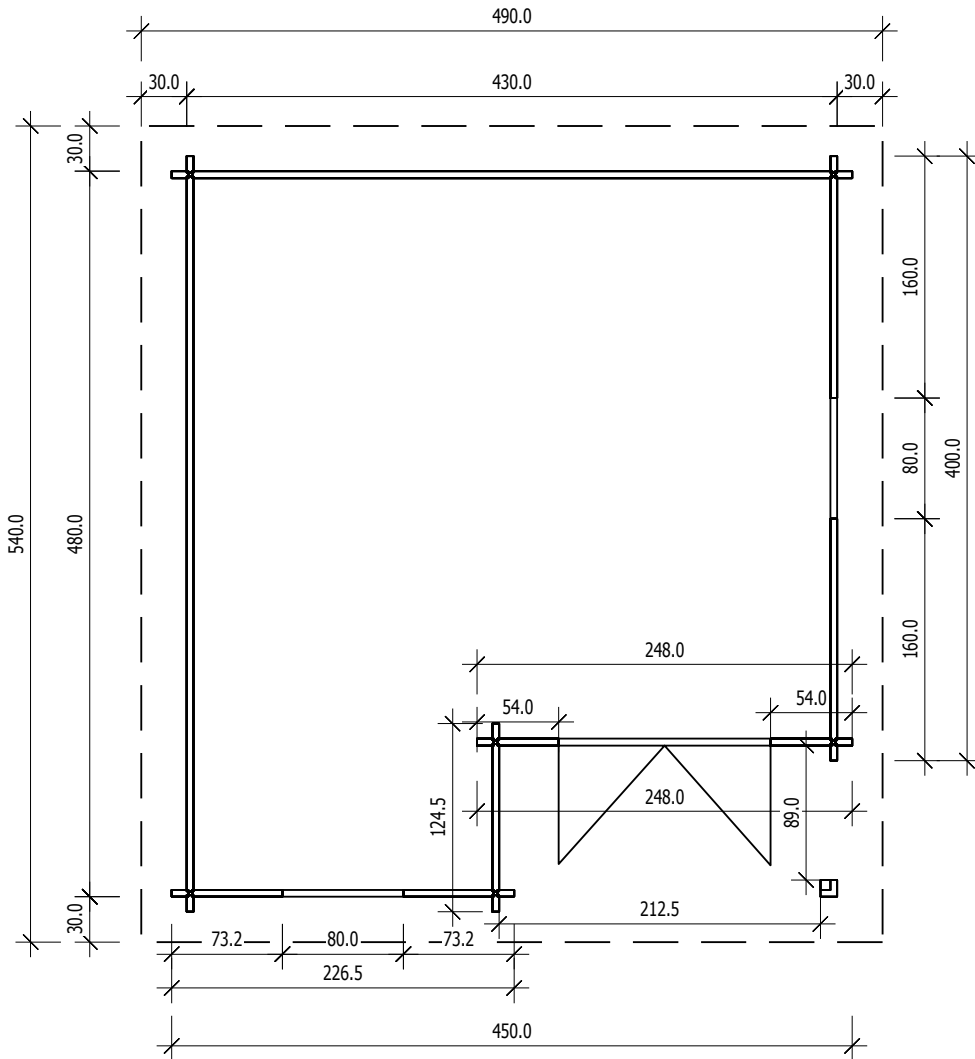

Bemerkung: die Ansicht von Turen, Fenster und anderen Teilen kann abweichen von diesem Bild



Grundriss



4,5

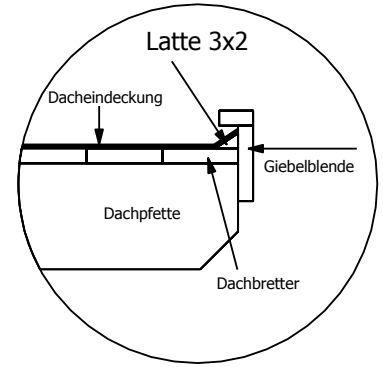

Schnitt

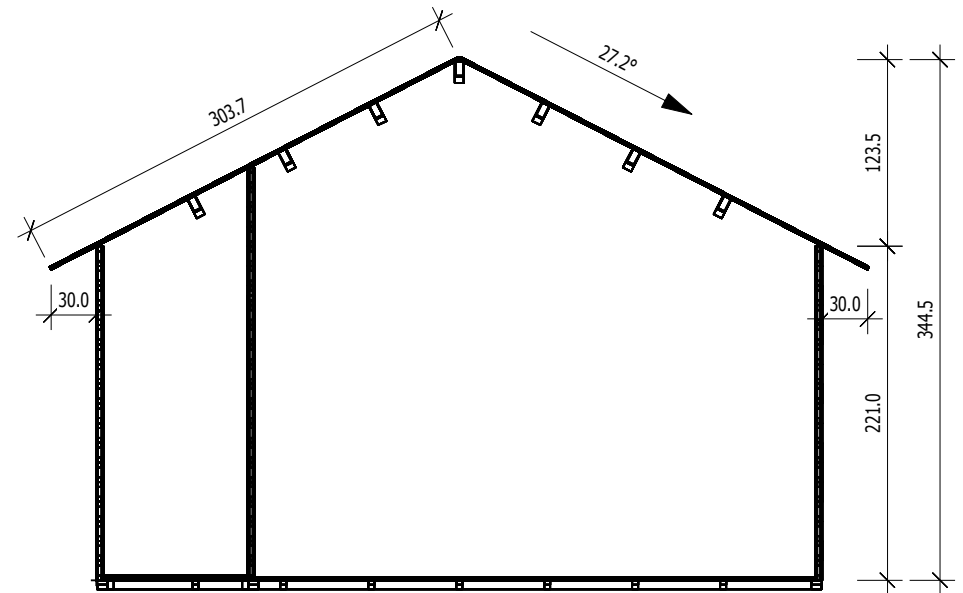

4,5

F
M1:40

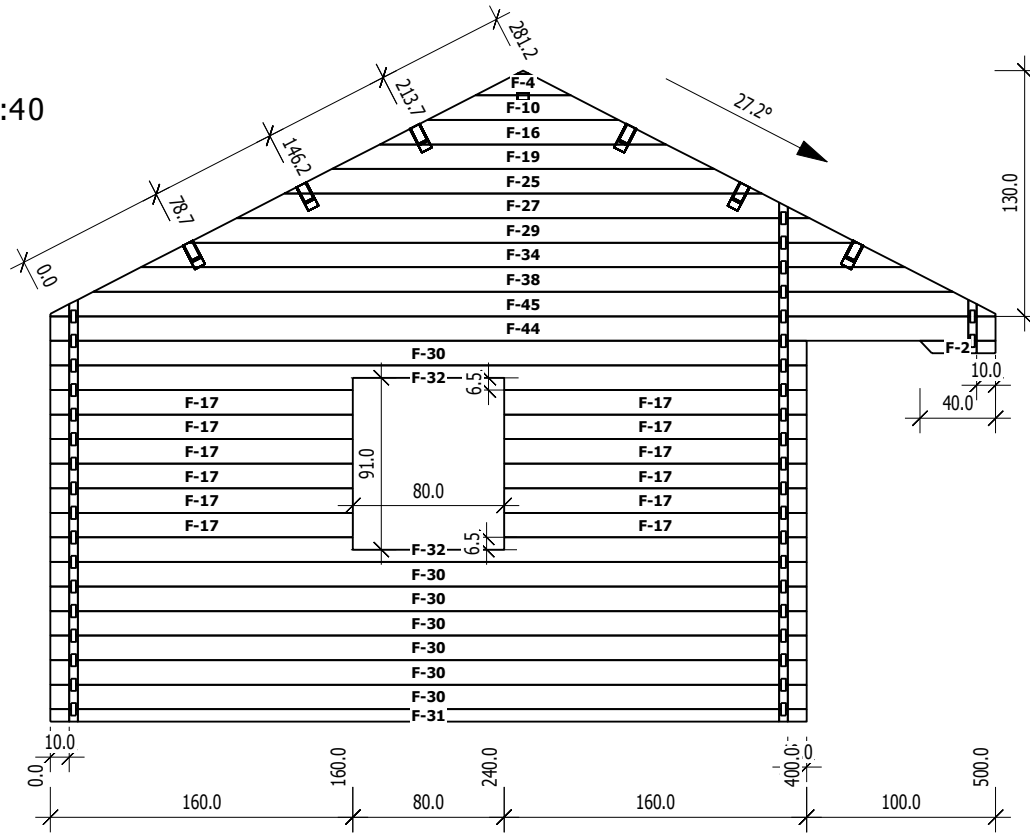

Nr	H	L	Psc
F 2	6.5	40.0	1
F 4	13.0	50.5	1
F 10	13.0	101.1	1
F 16	13.0	151.6	1
F 17	13.0	160.0	12
F 19	13.0	202.1	1
F 25	13.0	252.6	1
F 27	13.0	303.2	1
F 29	13.0	353.7	1
F 30	13.0	400.0	7
F 31	6.5	400.0	1
F 32	13.0	400.0	2
F 34	13.0	404.2	1
F 38	13.0	454.7	1
F 44	13.0	500.0	1
F 45	13.0	500.0	1

E
M1:40

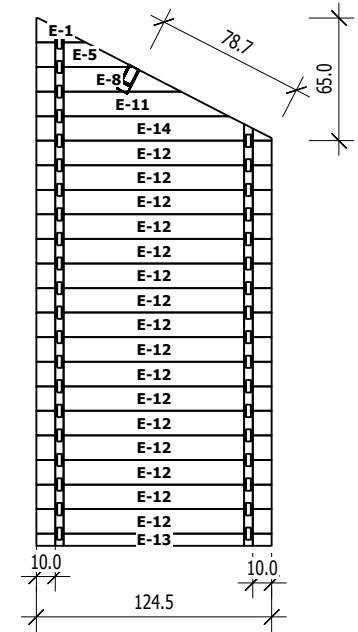

Nr	H	L	Psc
E 1	13.0	26.1	1
E 5	13.0	51.3	1
E 8	13.0	76.6	1
E 11	13.0	101.9	1
E 12	13.0	124.5	16
E 13	6.5	124.5	1
E 14	13.0	124.5	1

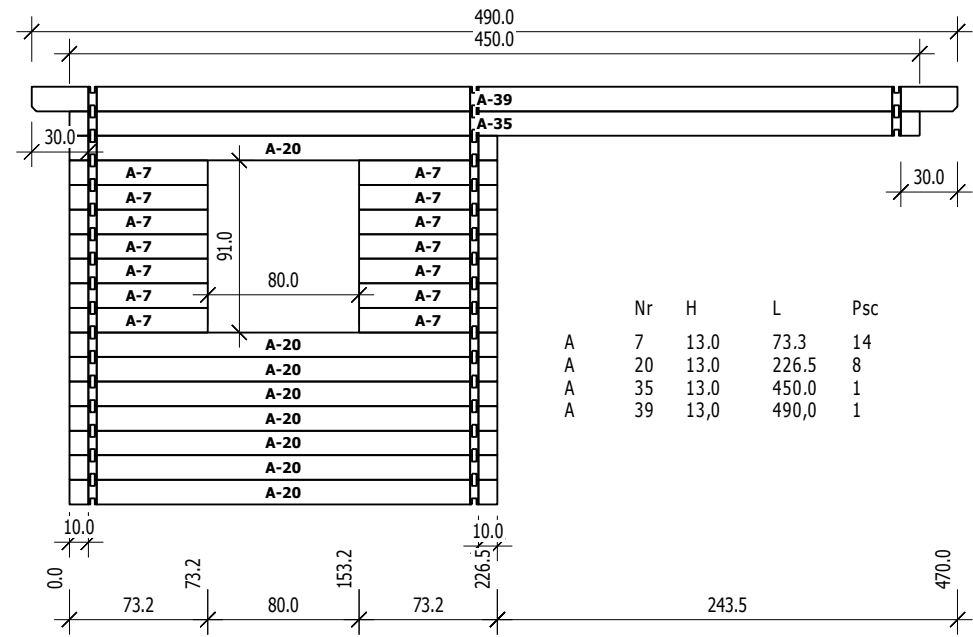

	Nr	H	L	Psc
A	7	13.0	73.3	14
A	20	13.0	226.5	8
A	35	13.0	450.0	1
A	39	13.0	490.0	1

	Nr	H	L	Psc
B	6	13.0	54.0	28
B	21	13.0	248.0	1
B	22	13.0	248.0	5
B	23	13.0	248.0	1

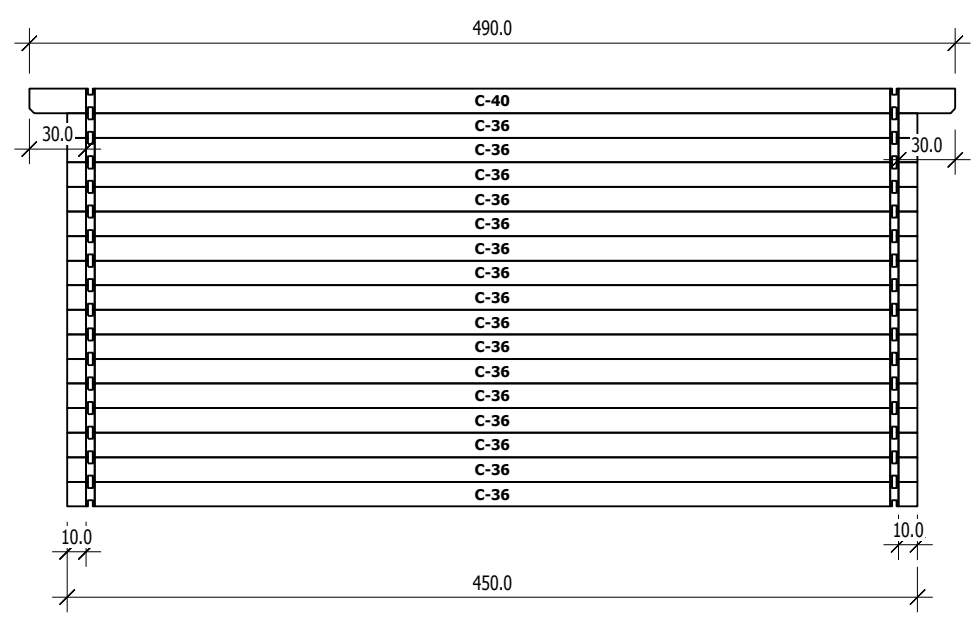
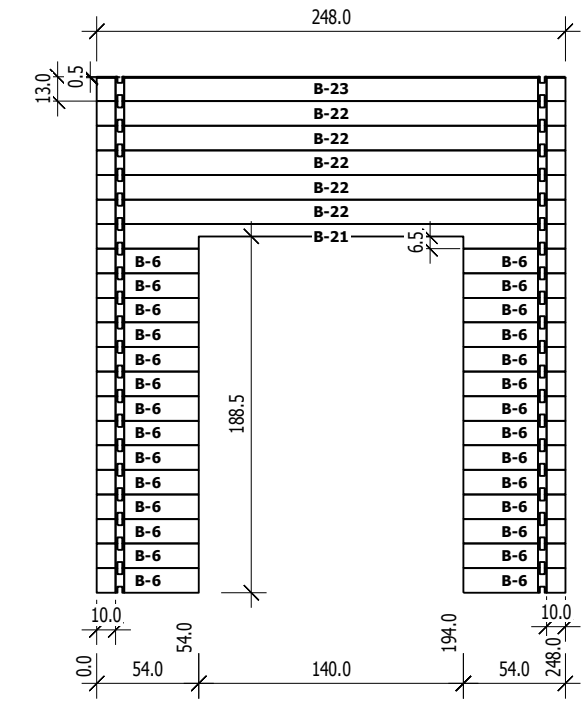

	Nr	H	L	Psc
C	36	13.0	450.0	16
C	40	13.0	490.0	1

	Nr	H	L	Psc
D	3	13.0	50.5	1
D	9	13.0	101.1	1
D	15	13.0	151.6	1
D	18	13.0	202.1	1
D	24	13.0	252.6	1
D	26	13.0	303.2	1
D	28	13.0	353.7	1
D	33	13.0	404.2	1
D	37	13.0	454.7	1
D	41	13.0	500.0	16
D	42	6.5	500.0	1
D	43	13.0	500.0	1

