

Bemerkung: die Ansicht von Turen, Fenster und anderen Teilen kann abweichen von diesem Bild

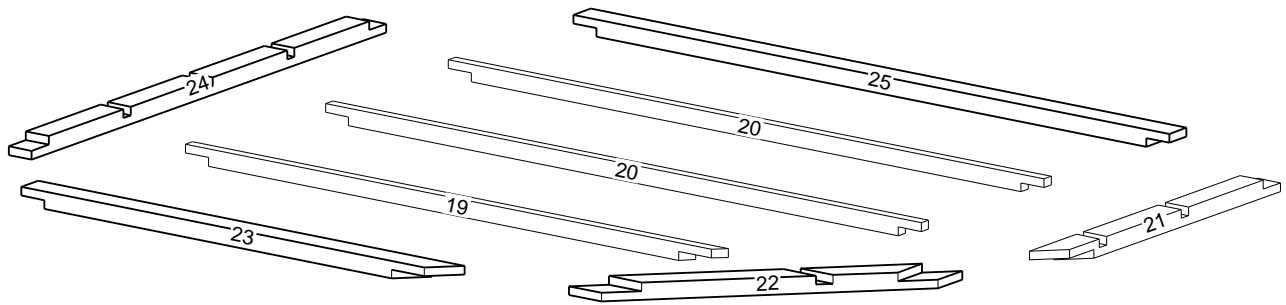

# Grundrahmenplan



Nr.	B	H	L	Psc
[cm]	[cm]	[cm]	[cm]	
19	4,0	6,0	221,2	1
20	4,0	6,0	246,0	2
21	9,5	6,0	126,0	1
22	9,5	6,0	131,5	1
23	9,5	6,0	176,0	1
24	9,5	6,0	196,0	1
25	9,5	6,0	246,0	1

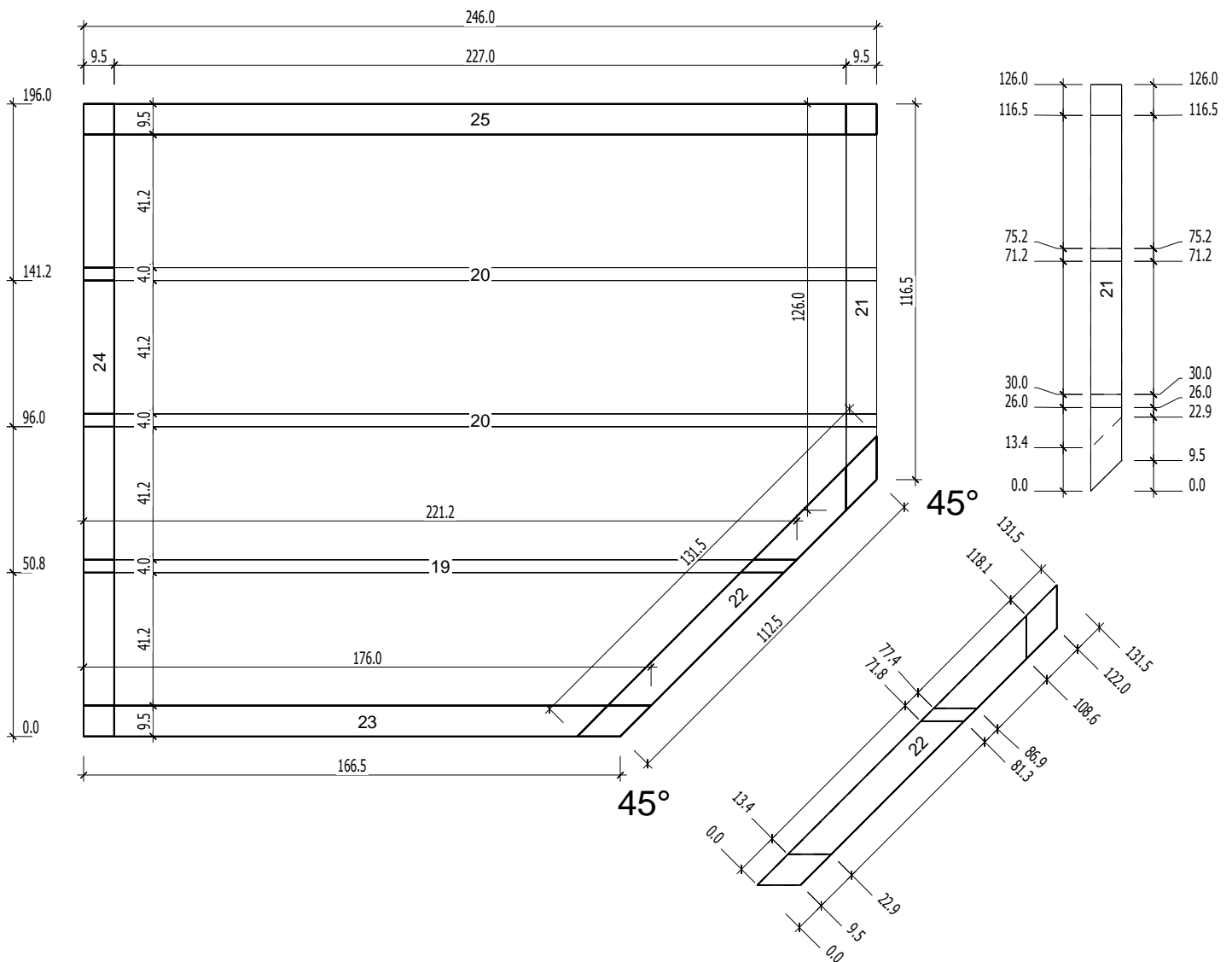

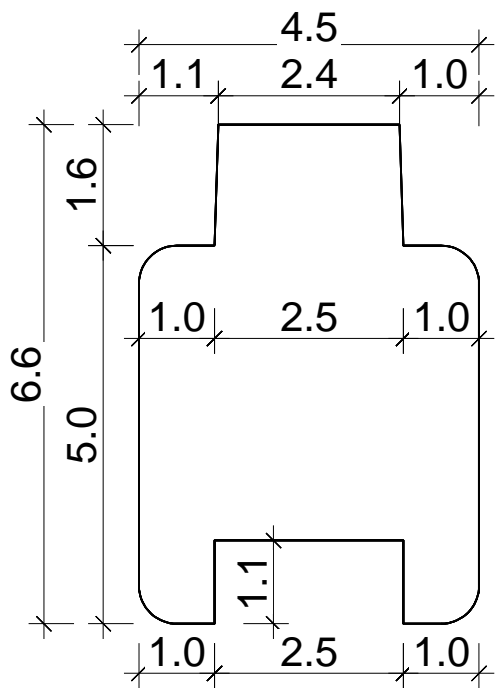

## Unterrahm

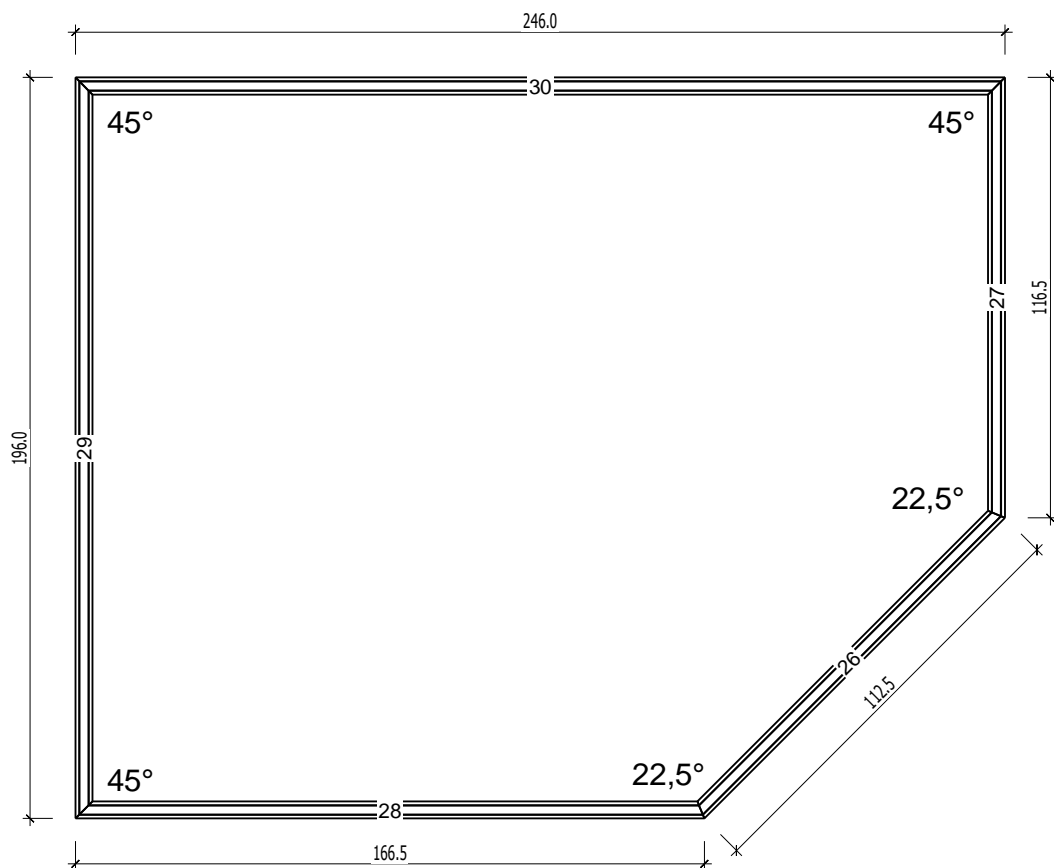

# Dachelemente

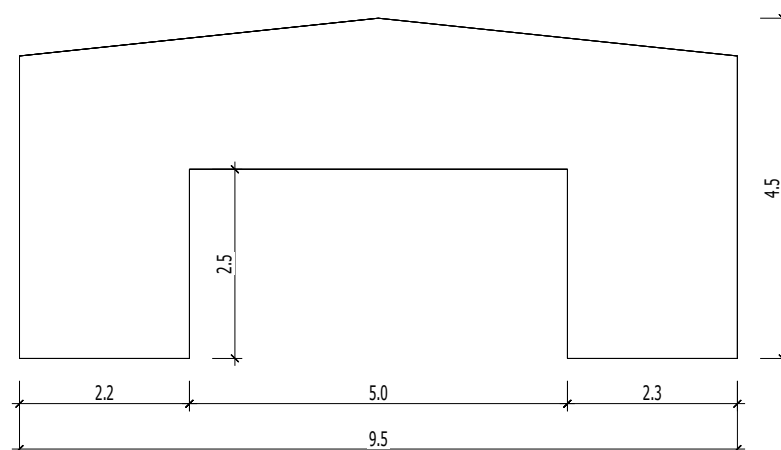
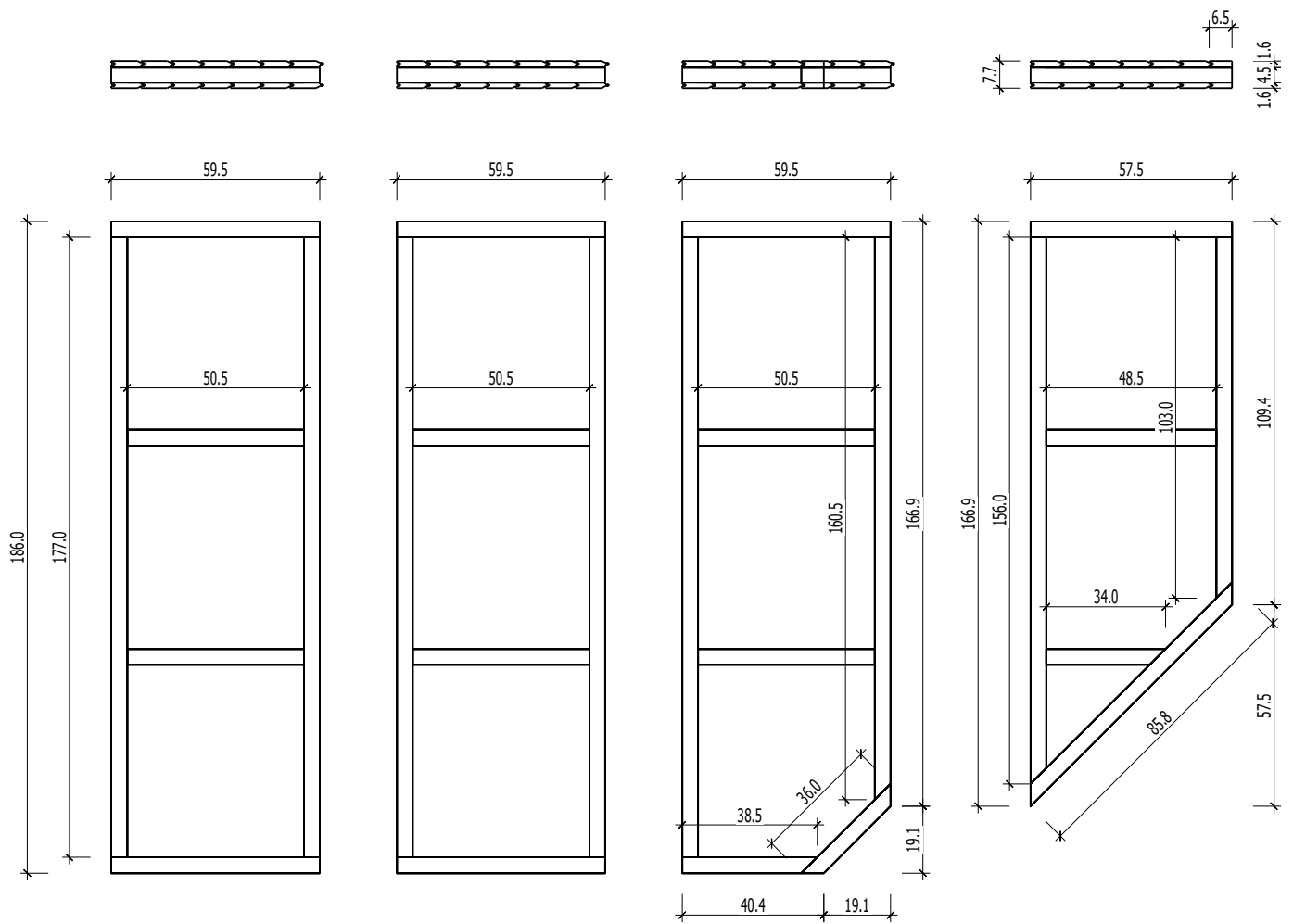

# Dachleisten

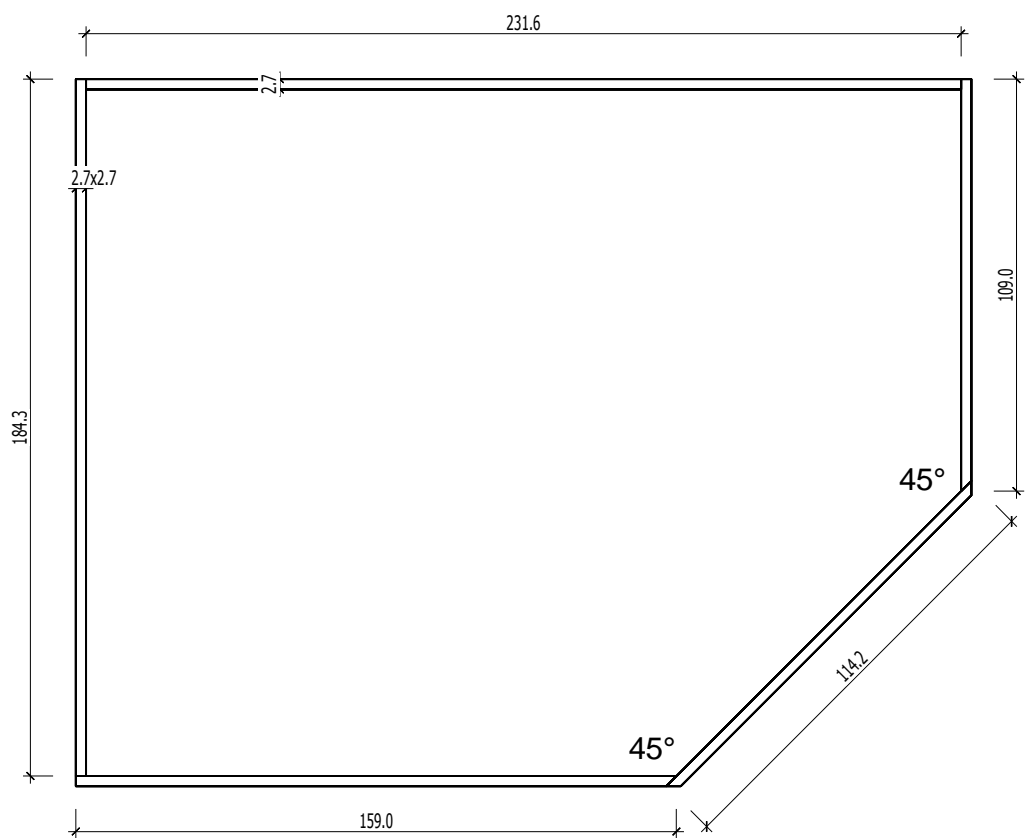

# Liegeauflageleistan

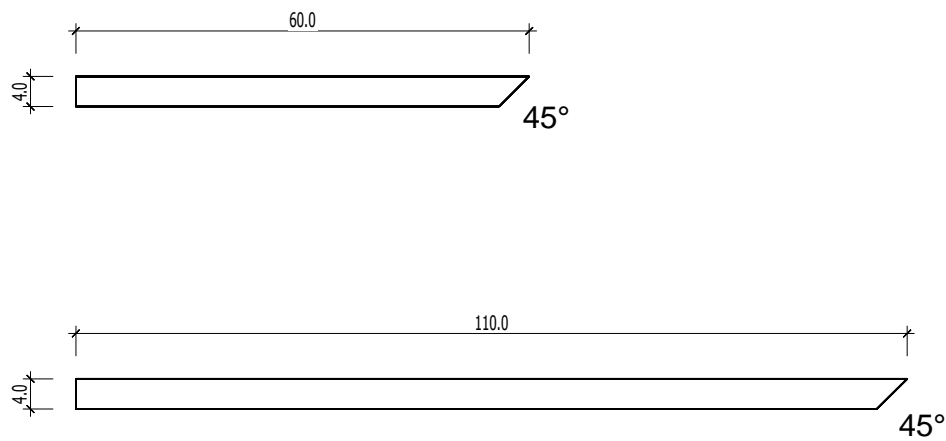



# Windbord

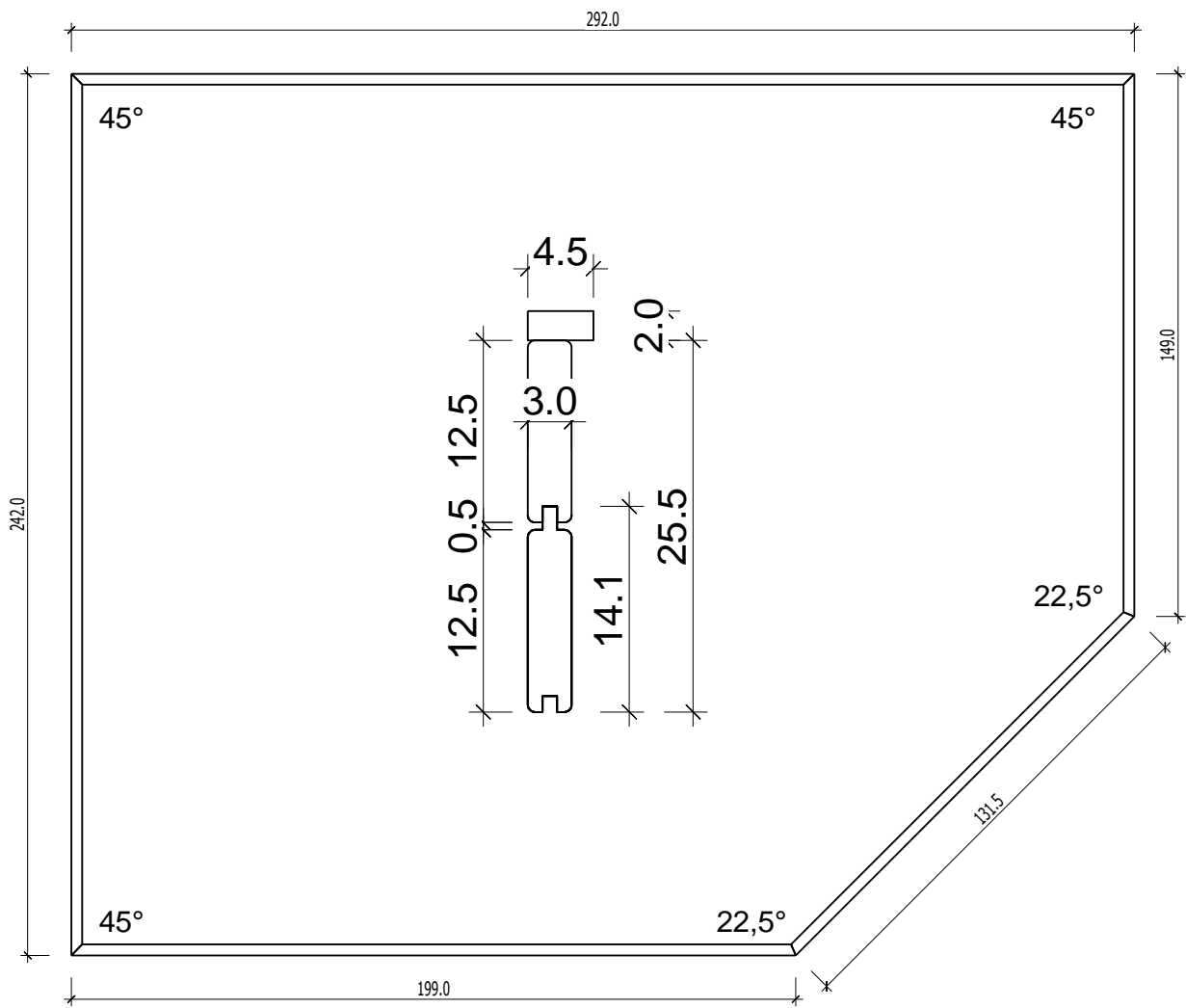
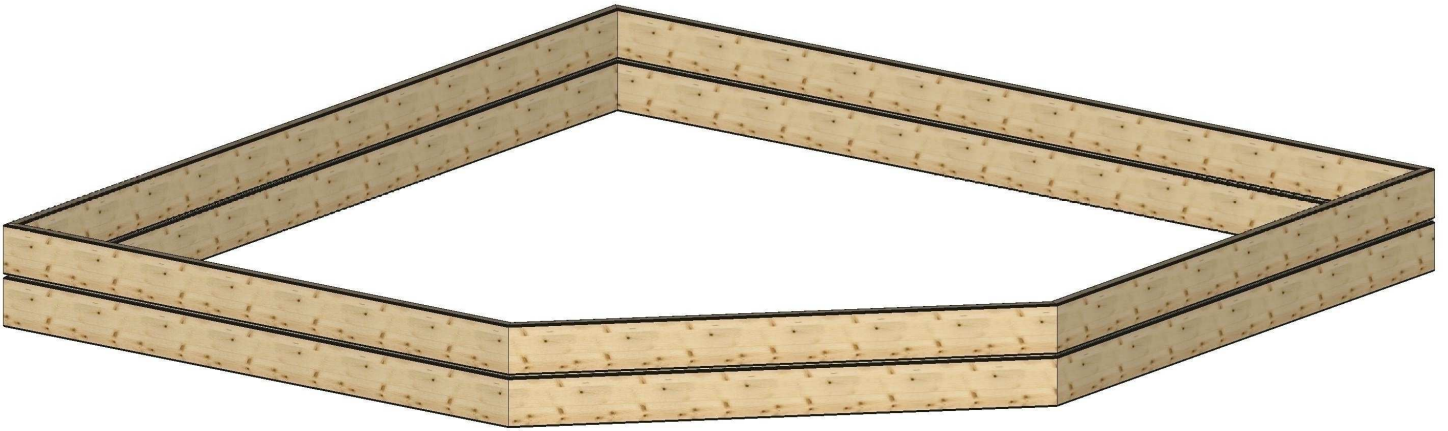

# Dachrahmen

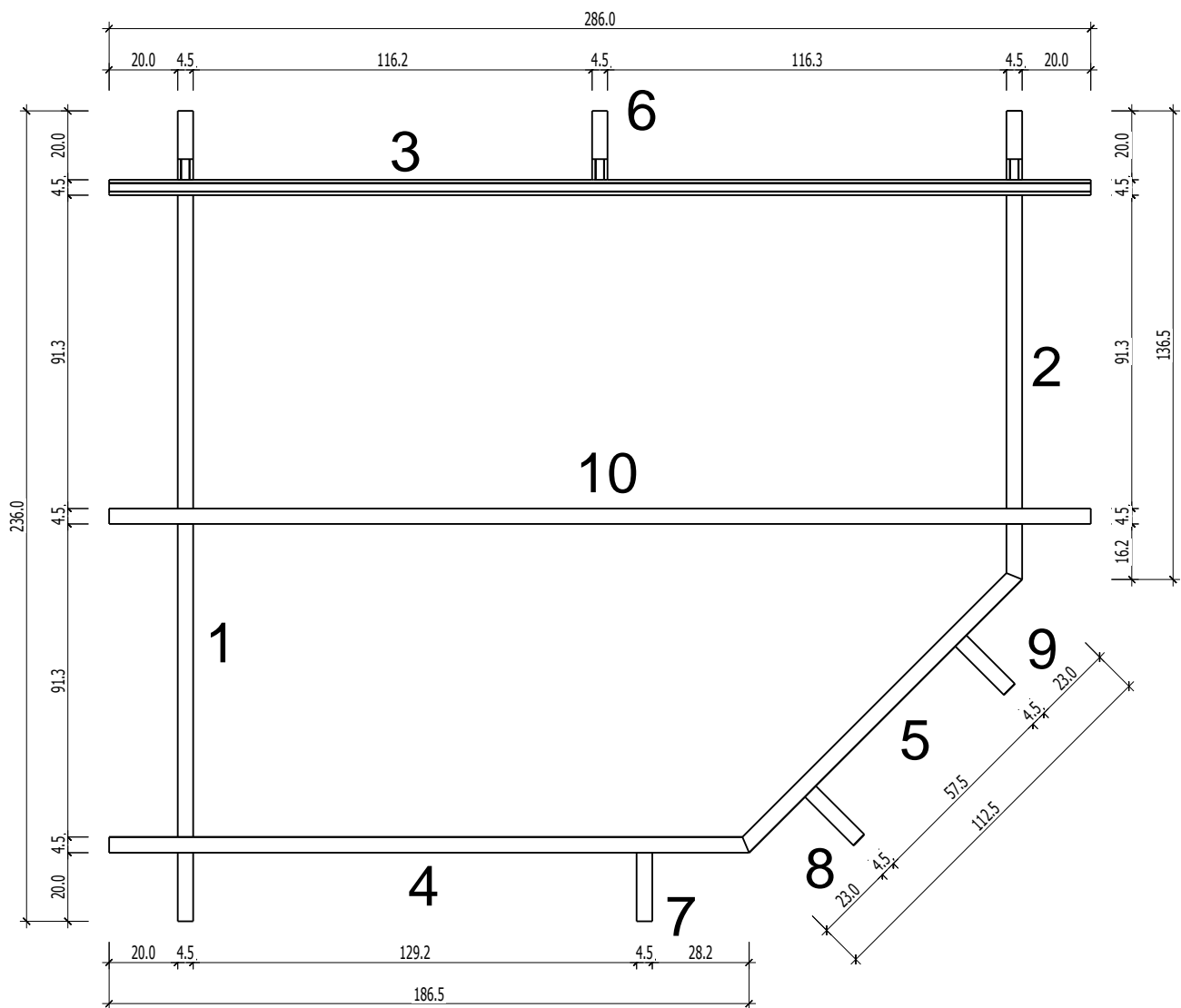
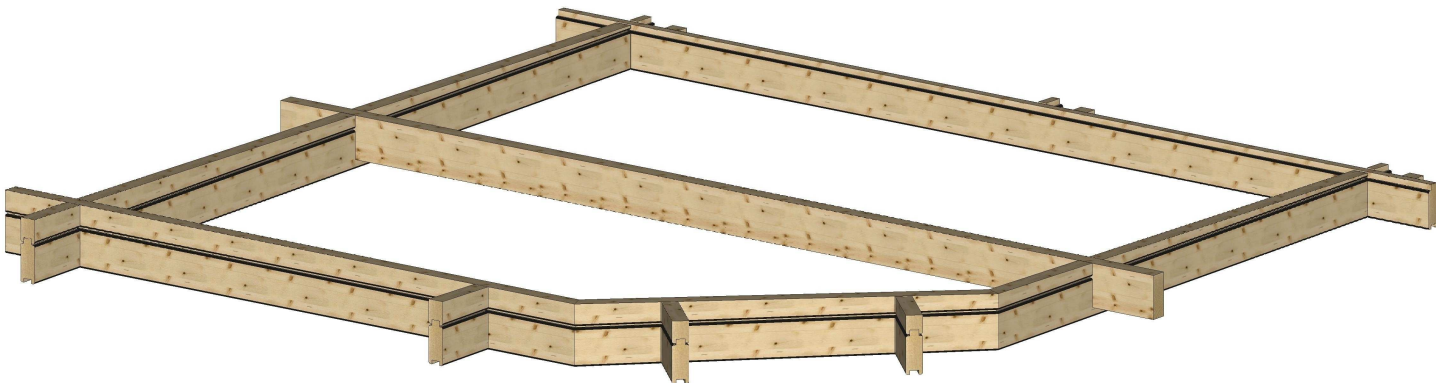



# Dachbretter

Nr.	B	H	L	Psc
	[cm]	[cm]	[cm]	
84	9,0	2,0	139,7	1
85	9,0	2,0	148,7	1
86	9,0	2,0	157,7	1
87	9,0	2,0	166,7	1
88	9,0	2,0	175,7	1
89	9,0	2,0	184,7	1
90	9,0	2,0	193,7	1
91	9,0	2,0	202,7	1
92	9,0	2,0	211,7	1
93	9,0	2,0	220,7	1
94	9,0	2,0	222,0	1
95	9,0	2,0	222,0	21
96	4,5	12,1	20,0	6
97	4,5	12,1	20,0	2
98	4,5	12,1	112,5	2
99	4,5	12,1	136,5	2
100	4,5	12,1	186,5	2
101	4,5	12,1	236,0	2
102	4,5	12,1	286,0	1

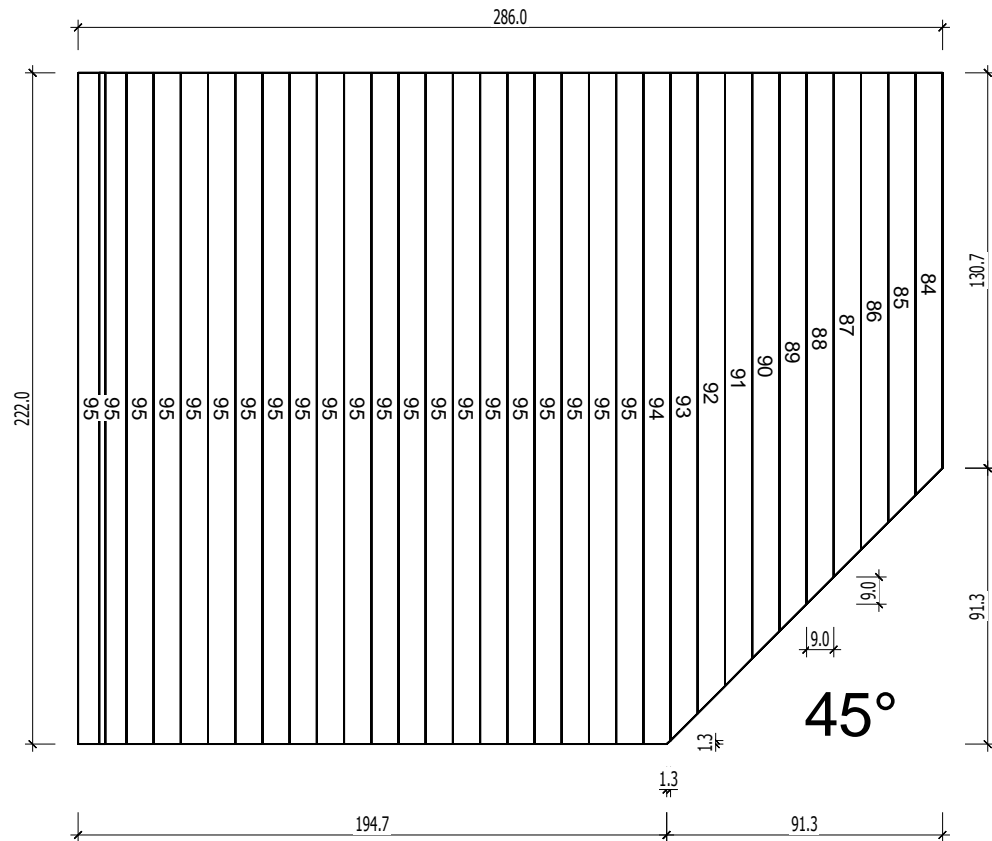

# Hobeldielen

Nr.	B	H	L	Psc
	[cm]	[cm]	[cm]	
9	9,0	3,0	118,6	1
10	9,0	3,0	127,6	1
11	9,0	3,0	136,6	1
12	9,0	3,0	145,6	1
13	9,0	3,0	154,6	1
14	9,0	3,0	163,6	1
15	9,0	3,0	172,6	1
16	9,0	3,0	181,6	1
17	9,0	3,0	186,5	1
18	9,0	3,0	186,5	18

