

Bemerkung: die Ansicht von Türen, Fenster und anderen Teilen kann abweichen von diesem Bild

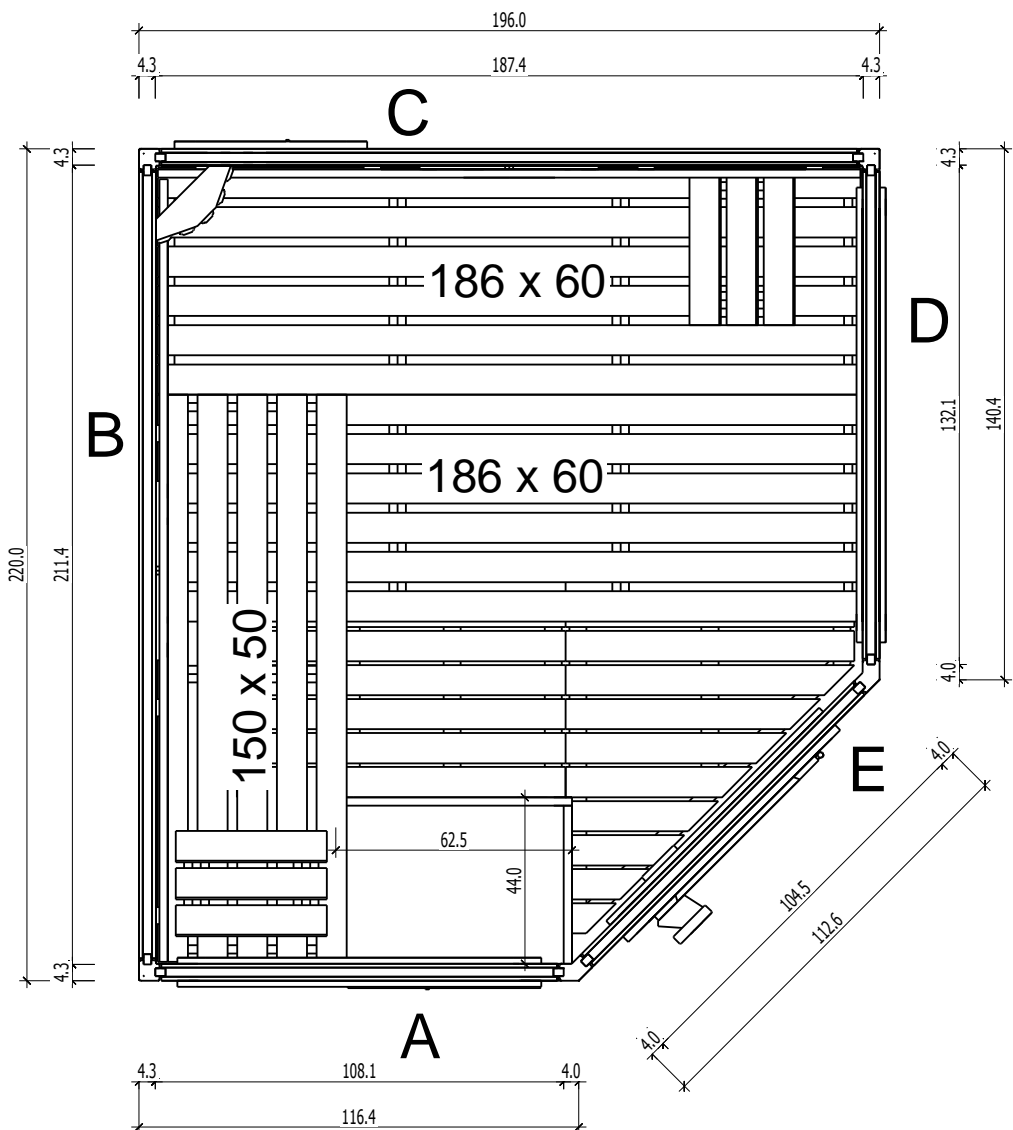

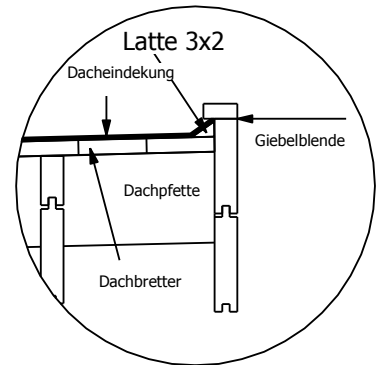
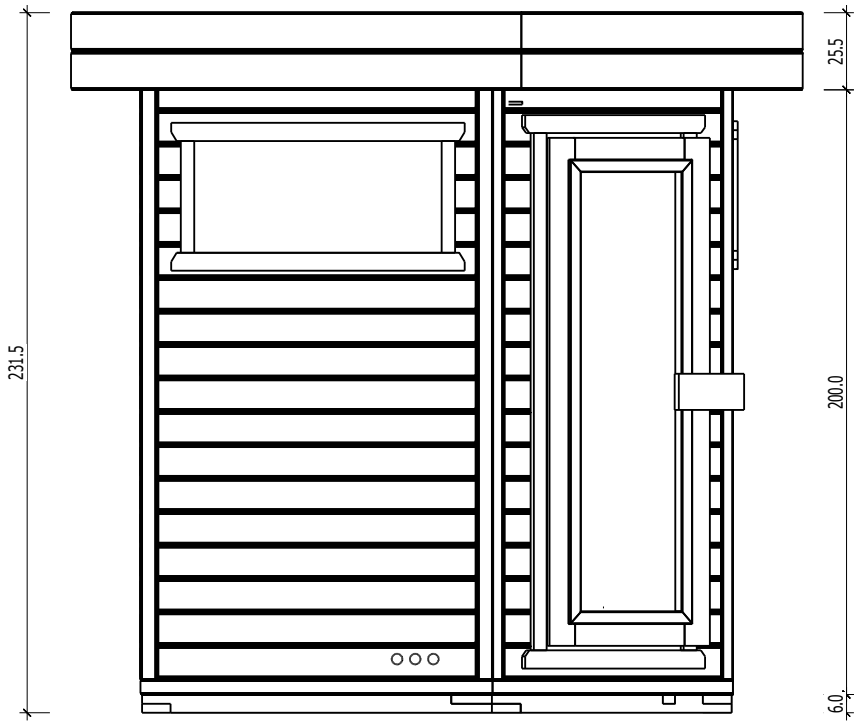
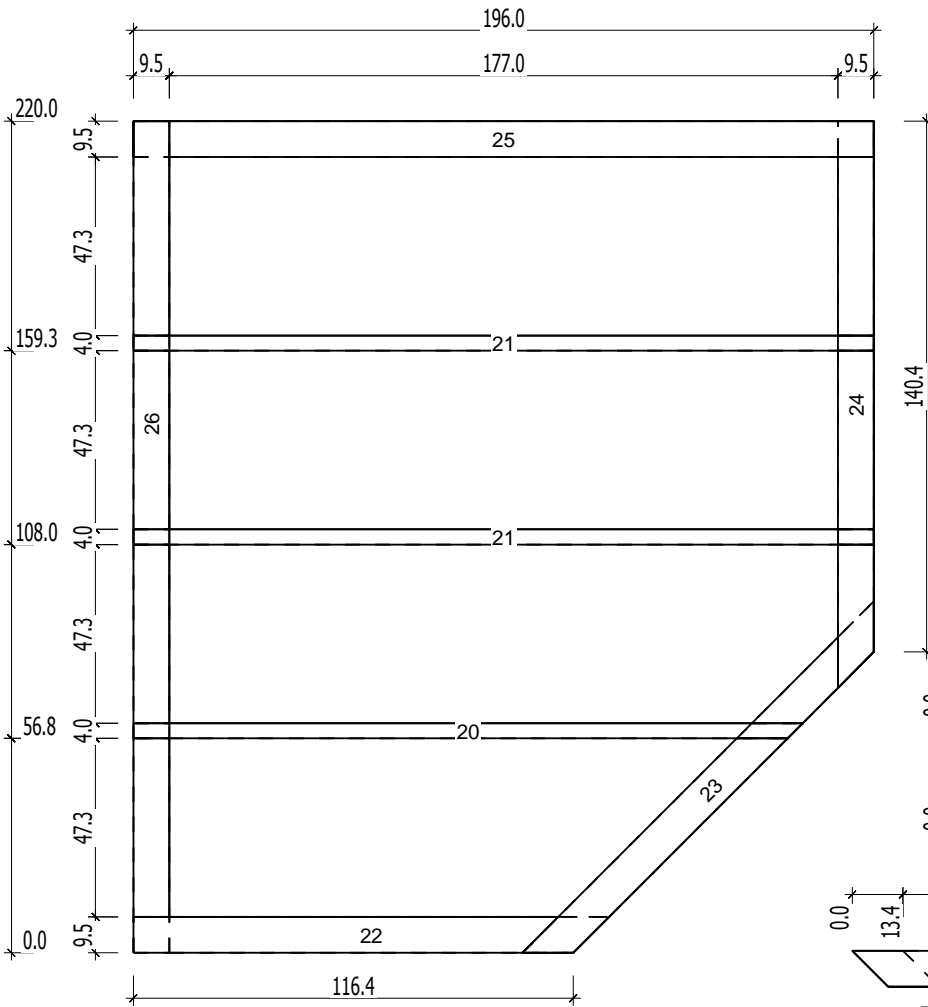
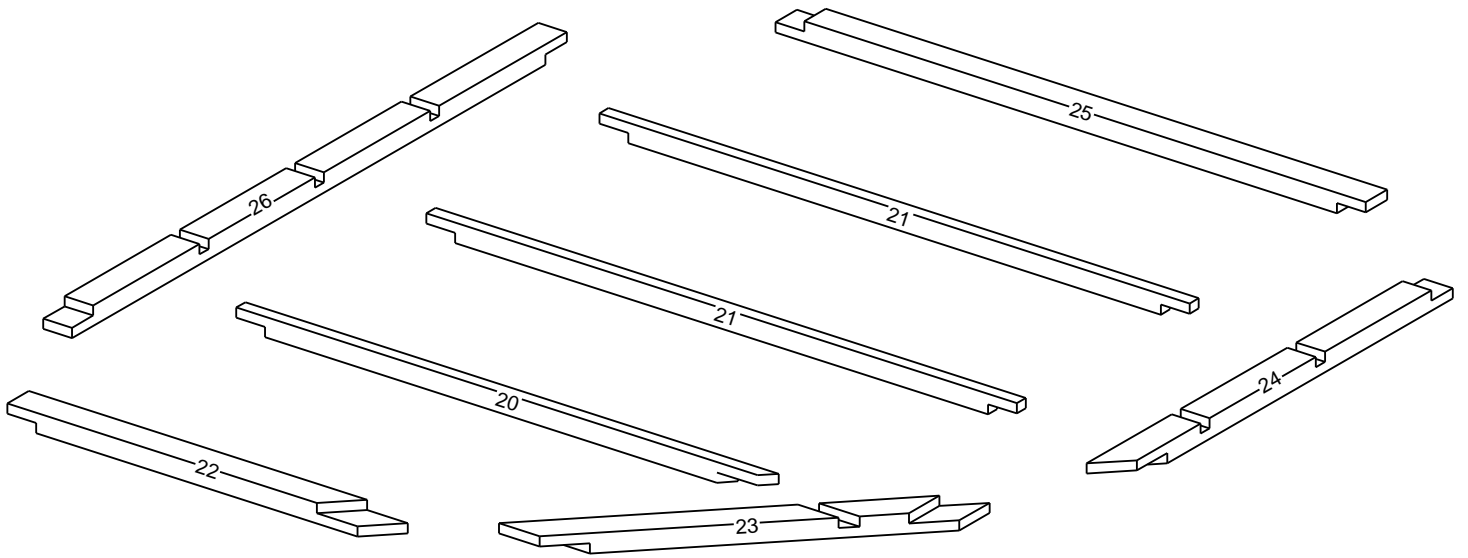

Nr. B H L Psc
[cm] [cm] [cm]

Nr.	B [cm]	H [cm]	L [cm]	Psc
20	4,0	6,0	177,2	1
21	4,0	6,0	196,0	2
22	9,5	6,0	125,9	1
23	9,5	6,0	131,6	1
24	9,5	6,0	149,9	1
25	9,5	6,0	196,0	1
26	9,5	6,0	220,0	1

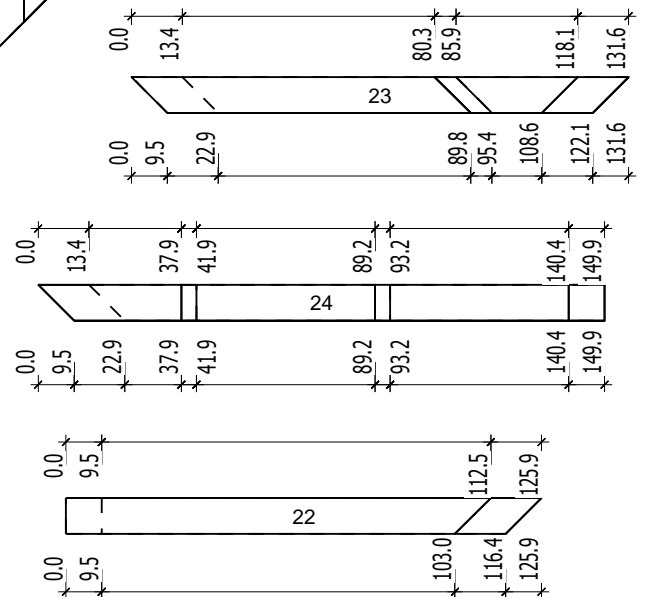

Unterrahm/ Lower ring

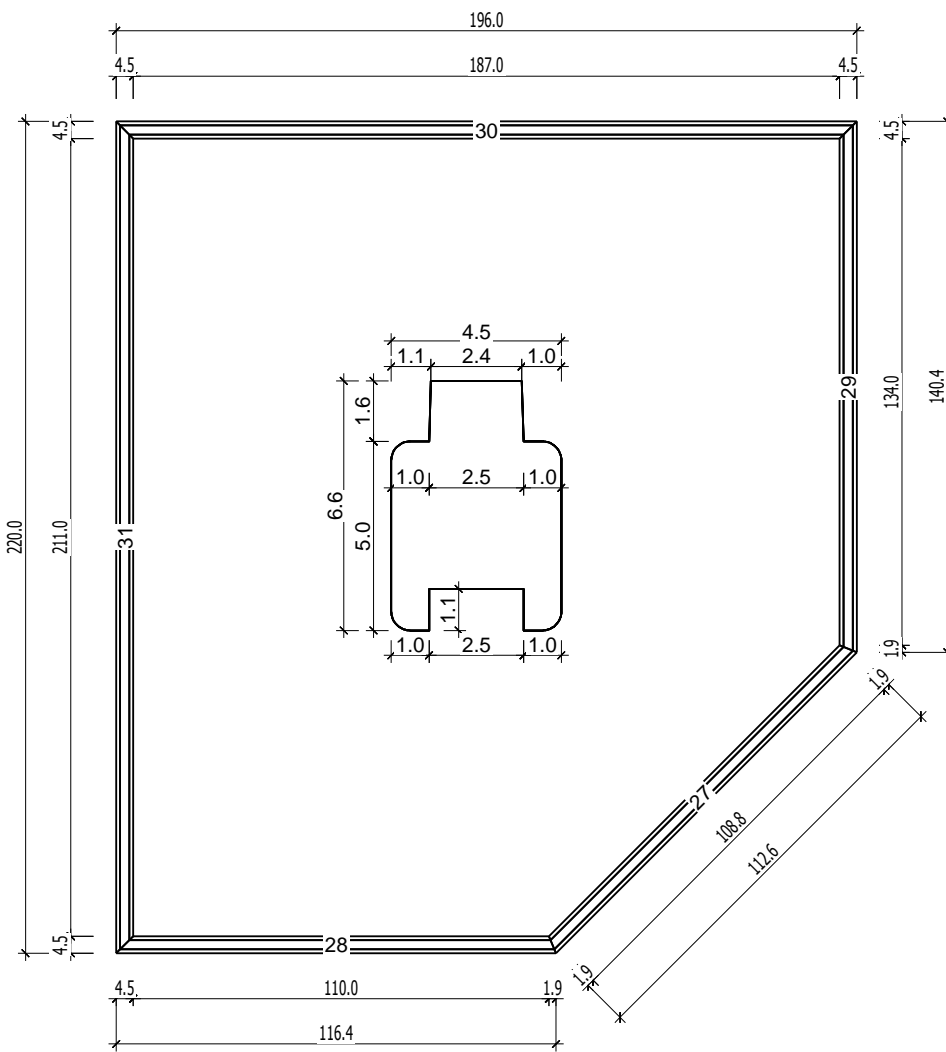
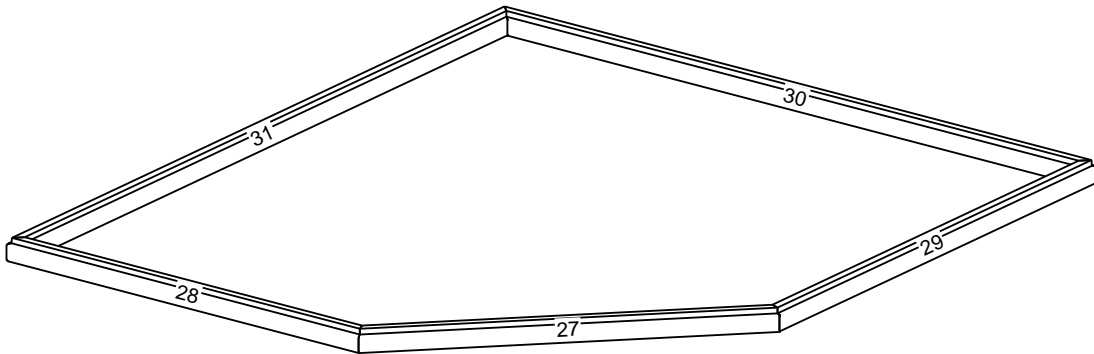

Nr.	B [cm]	H [cm]	L [cm]	Psc
27	4,5	6,6	112,6	1
28	4,5	6,6	116,4	1
29	4,5	6,6	140,4	1
30	4,5	6,6	196,0	1
31	4,5	6,6	220,0	1

Dach elemente/ Roof panel

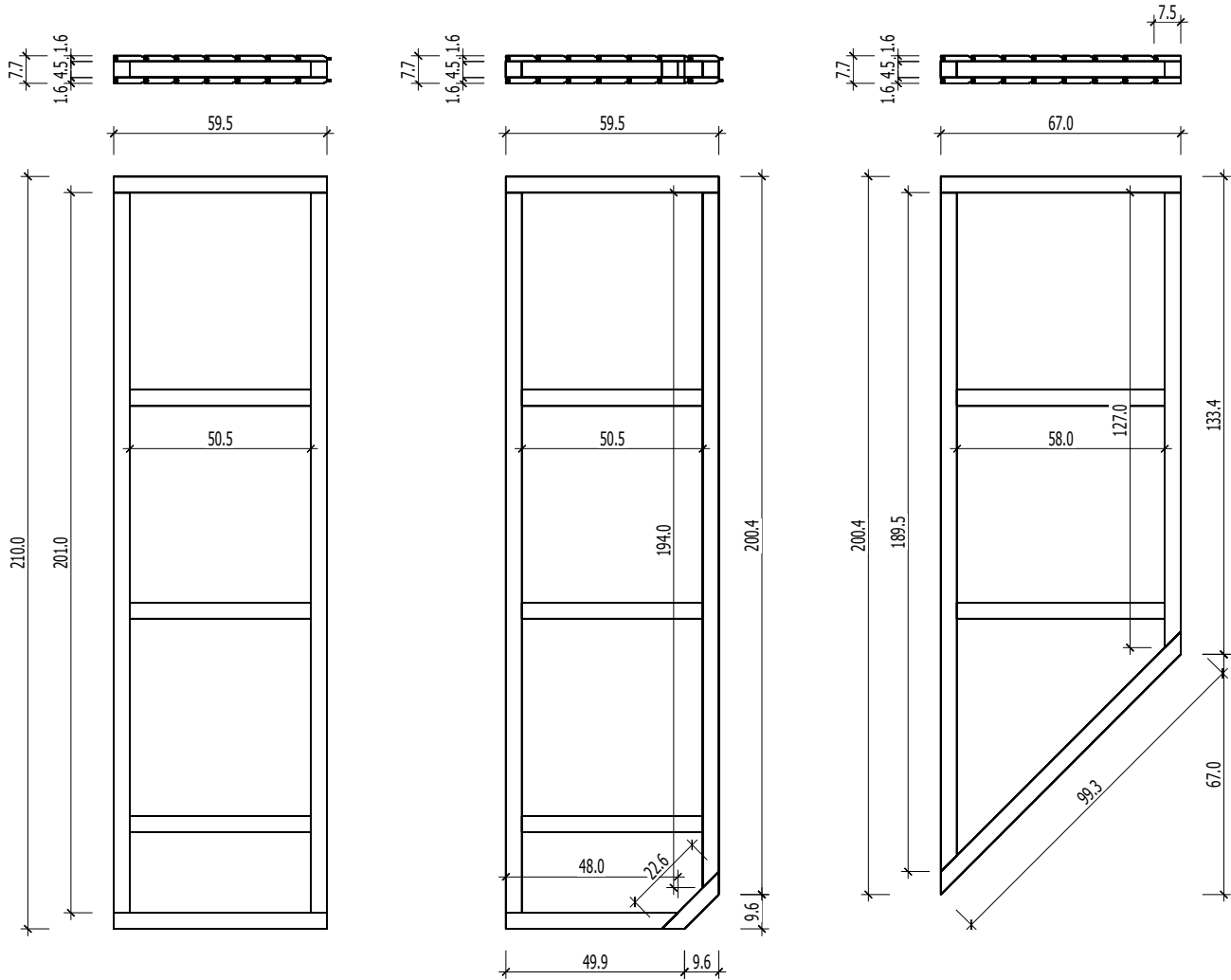

Kabelabdeckkleiste

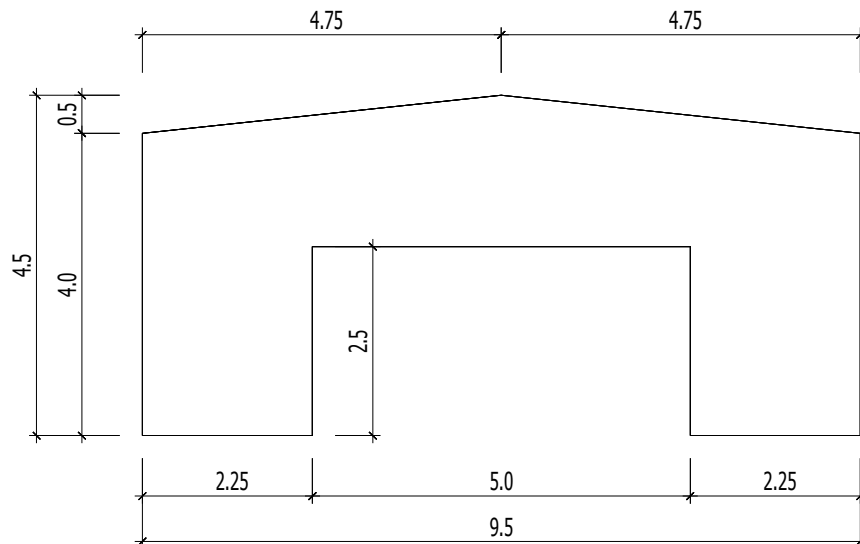

Dachleisten/ Battens for panels fixing

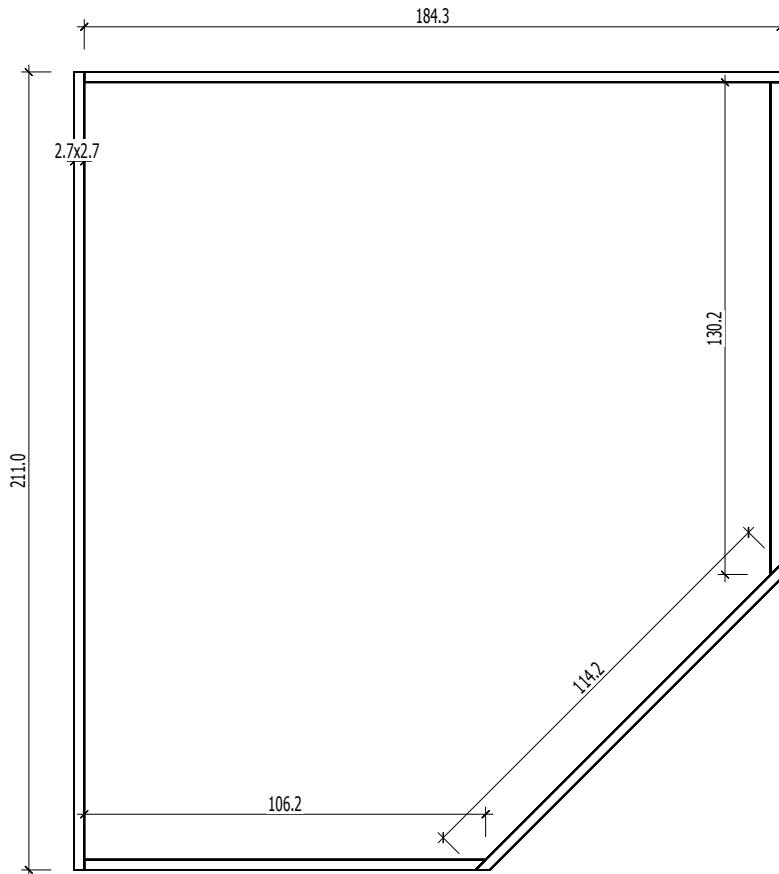

Liegeauflegeleisten

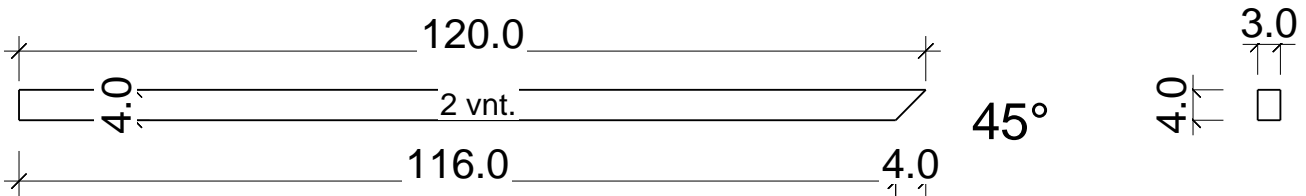
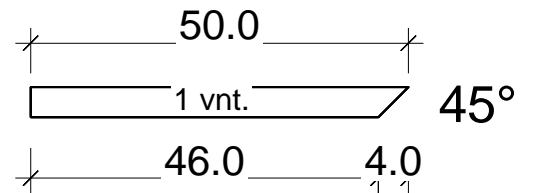
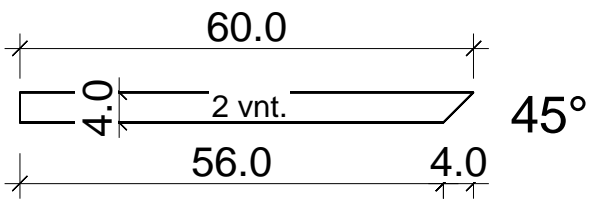

Dachrahmen

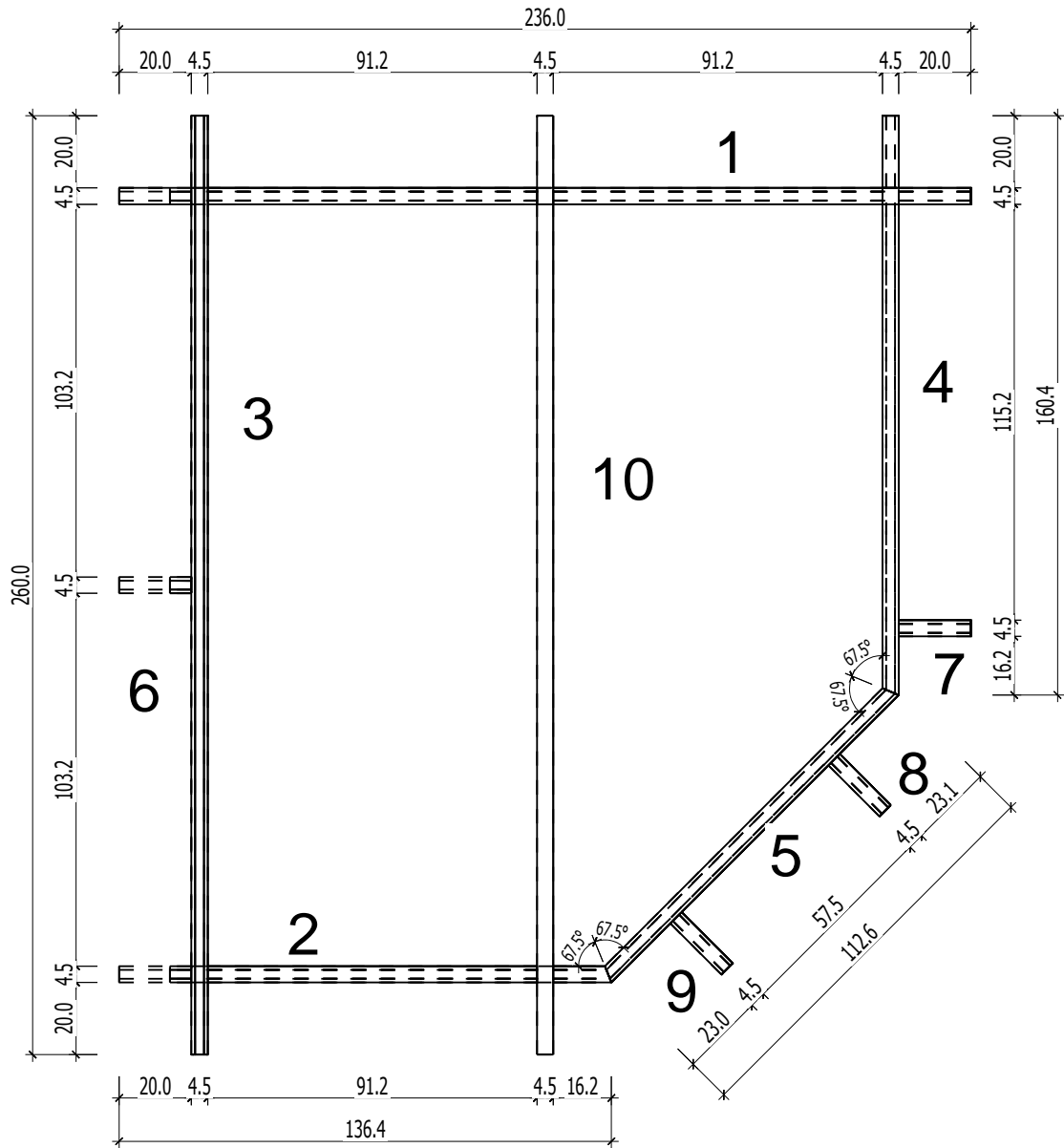
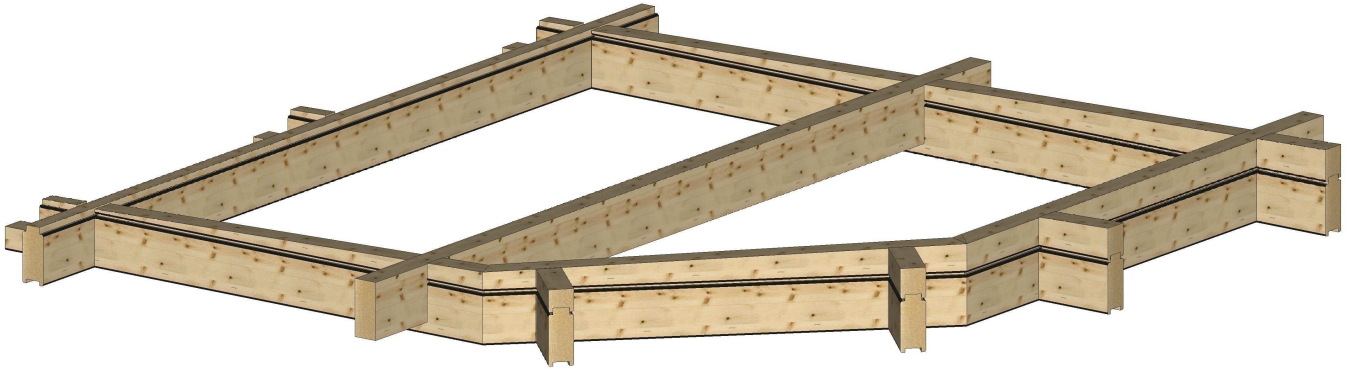

Dachbretter/ Roof boards

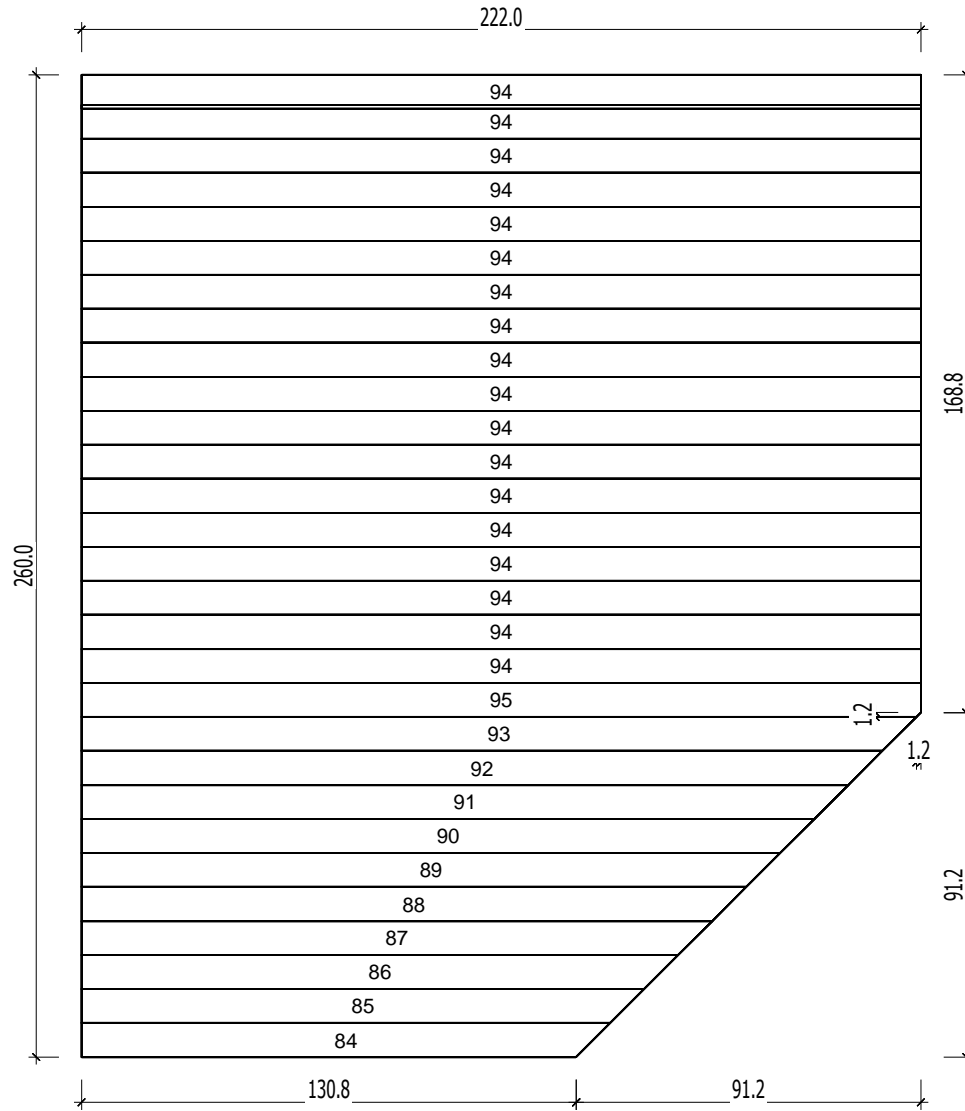

Hobeldielen/ Flooring

