

Bemerkung: die Ansicht von Turen, Fenster und anderen Teilen kann abweichen von diesem Bild

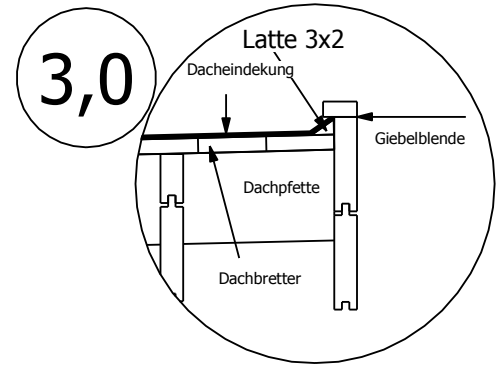

# Grundriss

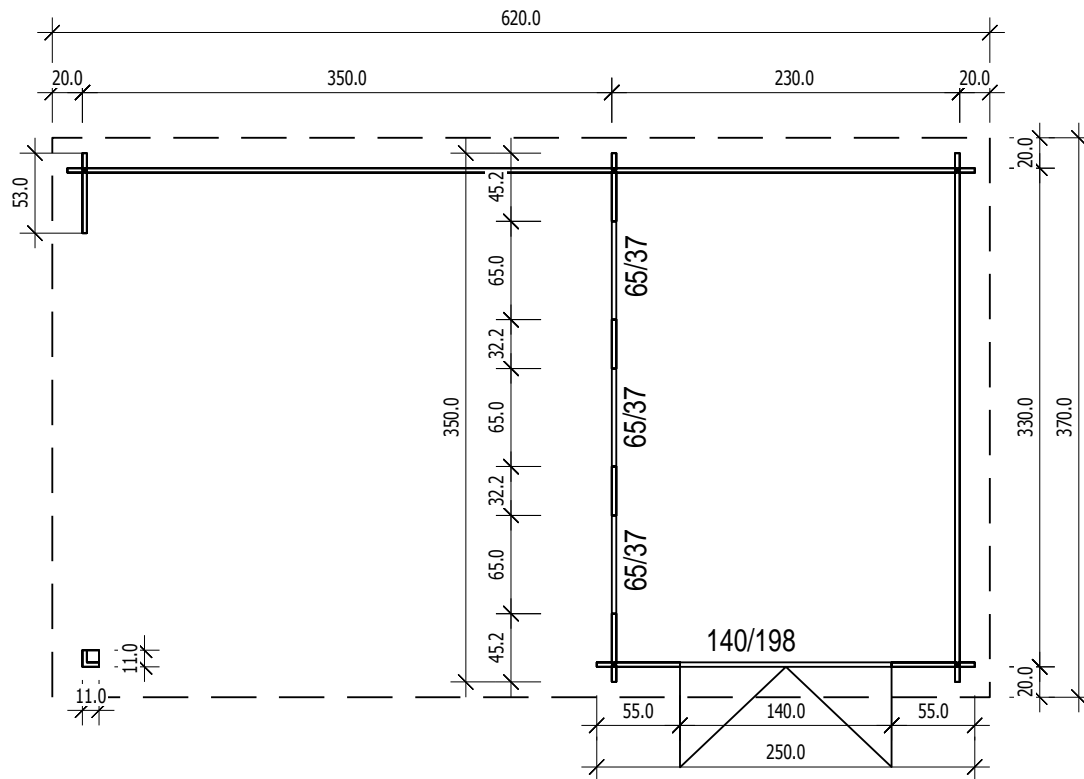

# Schnitt

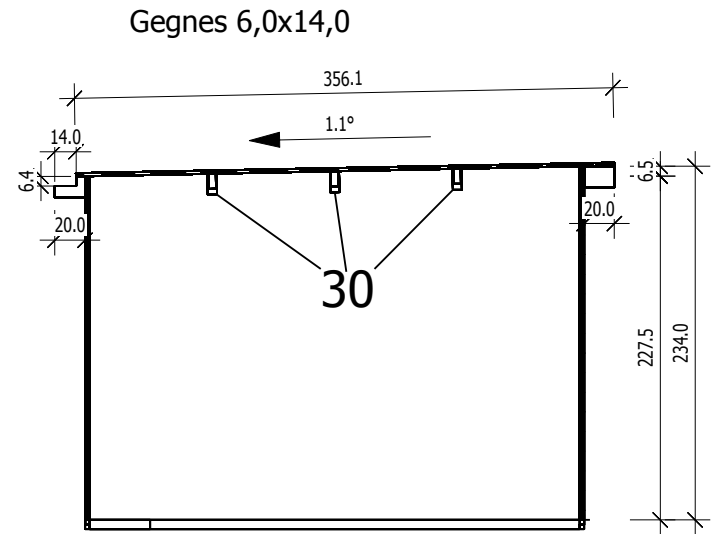

3,0

# Grundrahmenplan

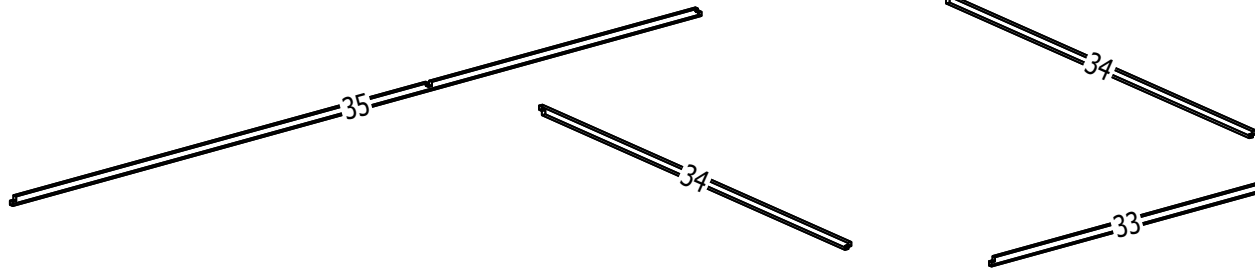
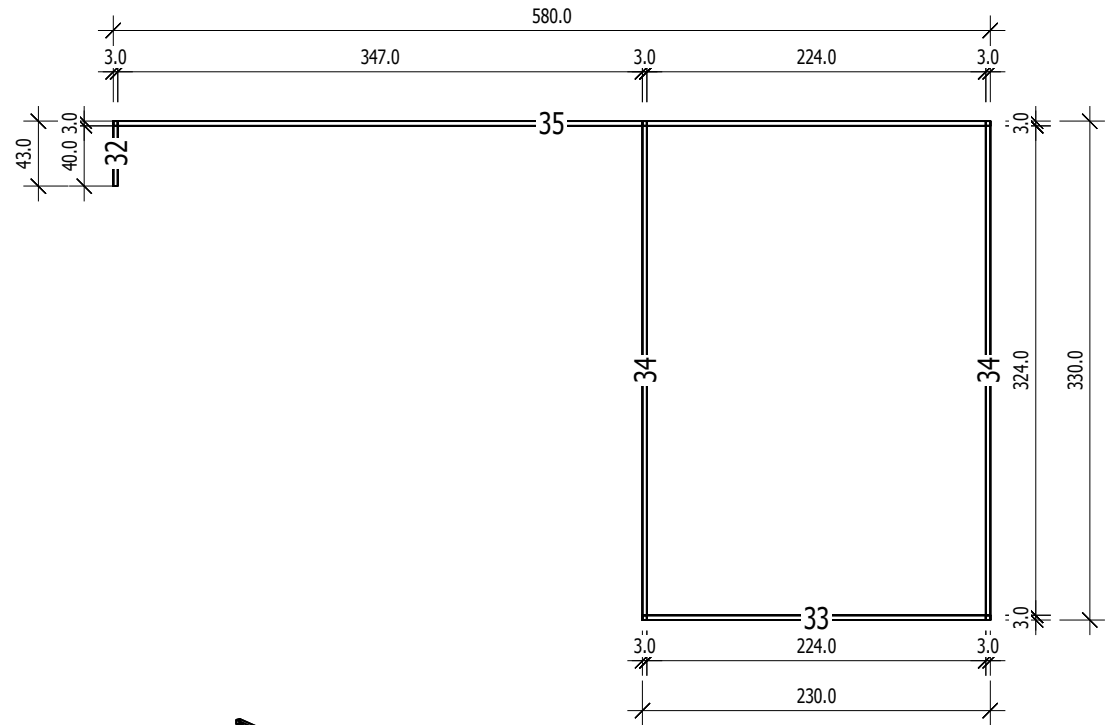

32

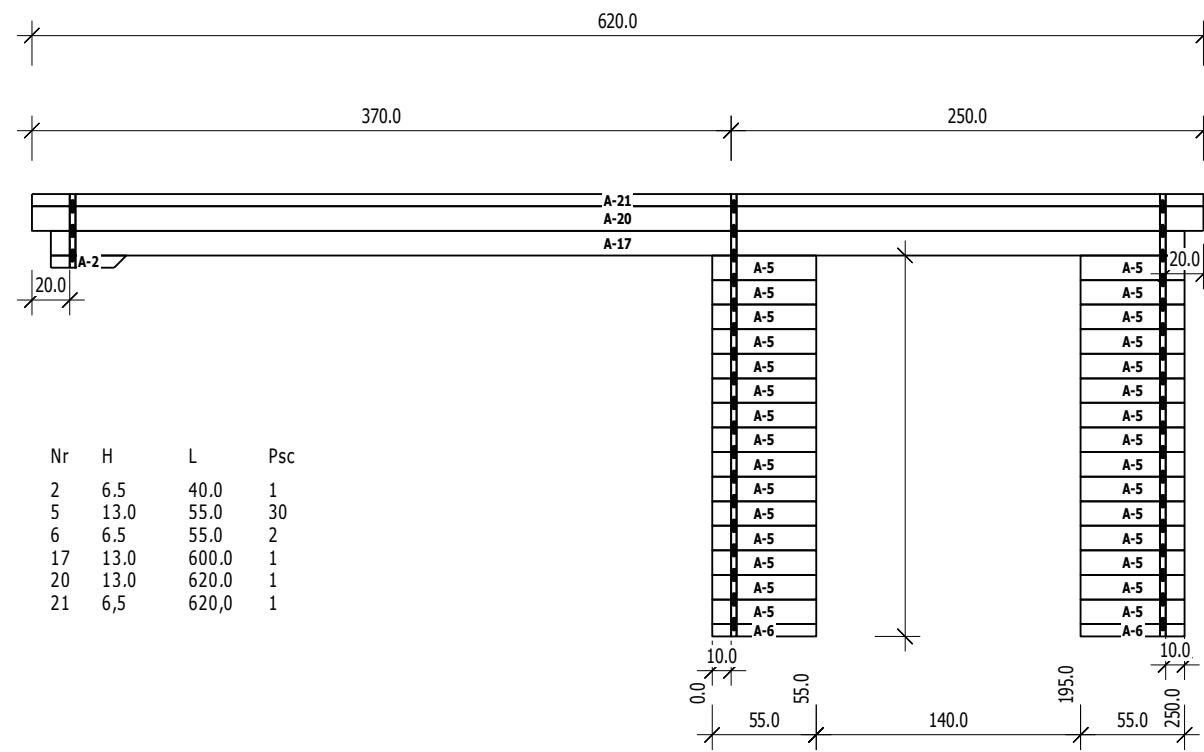

	Nr	H	L	Psc
A	2	6,5	40,0	1
A	5	13,0	55,0	30
A	6	6,5	55,0	2
A	17	13,0	600,0	1
A	20	13,0	620,0	1
A	21	6,5	620,0	1

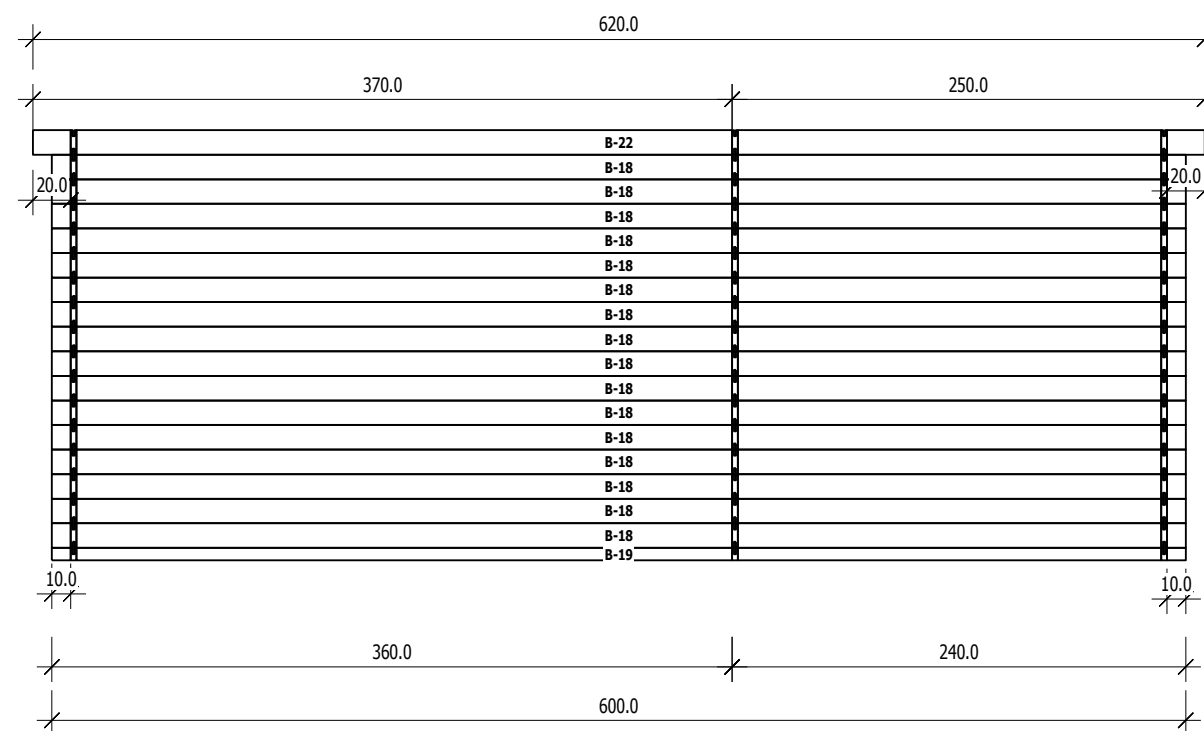

	Nr	H	L	Psc
B	18	13,0	600,0	16
B	19	6,5	600,0	1
B	22	13,0	620,0	1

