

	Nr	H	L	Psc
A	1	0.0	1.0	1
A	9	13.0	53.0	15
A	12	13.0	300.0	1
A	16	13.0	306.0	1
A	19	13.0	320.0	1

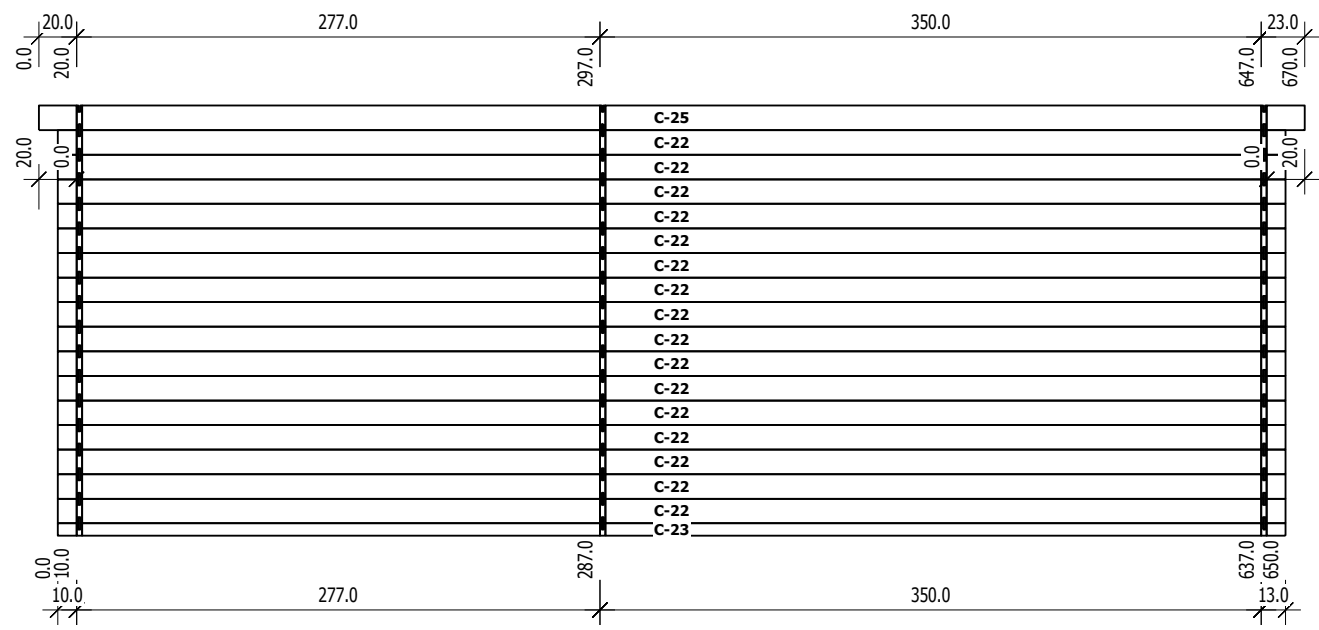

	Nr	H	L	Psc
C	22	13.0	650.0	16
C	23	6.5	650.0	1
C	25	13.0	670.0	1

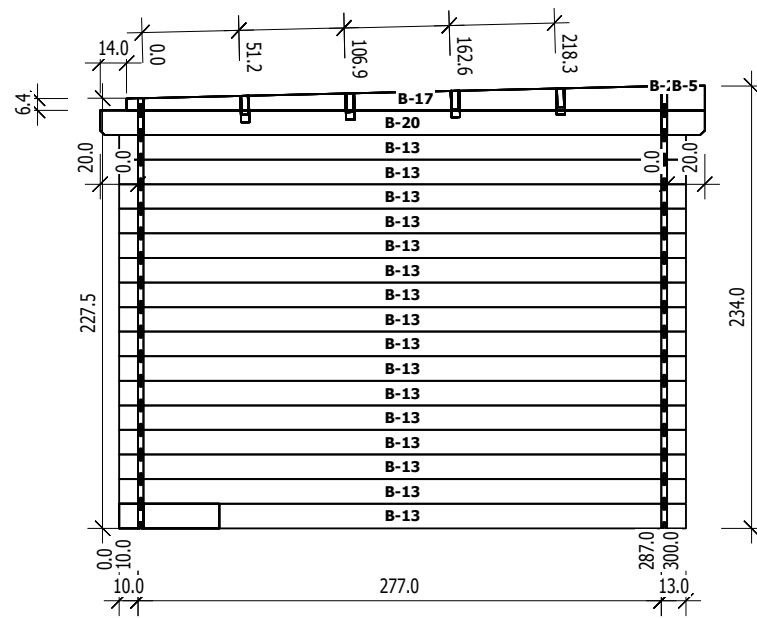

	Nr	H	L	Psc
B	2	0.0	1.0	1
B	5	0.5	21.0	1
B	13	13.0	300.0	16
B	17	13.0	306.0	1
B	20	13.0	320.0	1

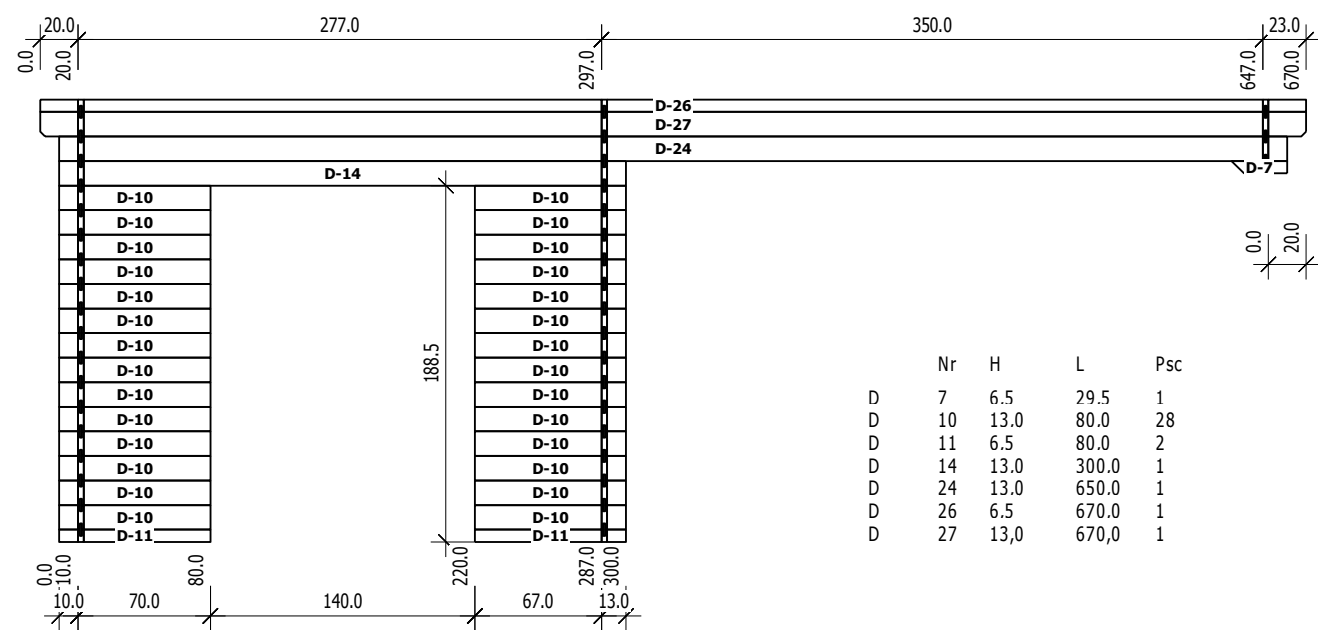

	Nr	H	L	Psc
D	7	6.5	29.5	1
D	10	13.0	80.0	28
D	11	6.5	80.0	2
D	14	13.0	300.0	1
D	24	13.0	650.0	1
D	26	6.5	670.0	1
D	27	13.0	670.0	1

E

M 1:40

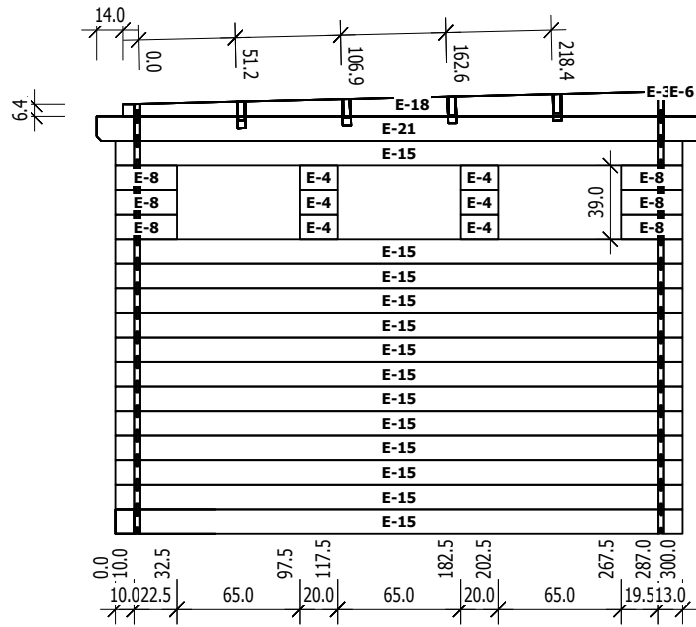

	Nr	H	L	Psc
E	3	0.0	1.0	1
E	4	13.0	20.0	6
E	6	0.5	21.0	1
E	8	13.0	32.5	6
E	15	13.0	300.0	13
E	18	13.0	306.0	1
E	21	13.0	320.0	1