

Bemerkung: die Ansicht von Turen, Fenster und anderen Teilen kann abweichen von diesem Bild

# Grundriss

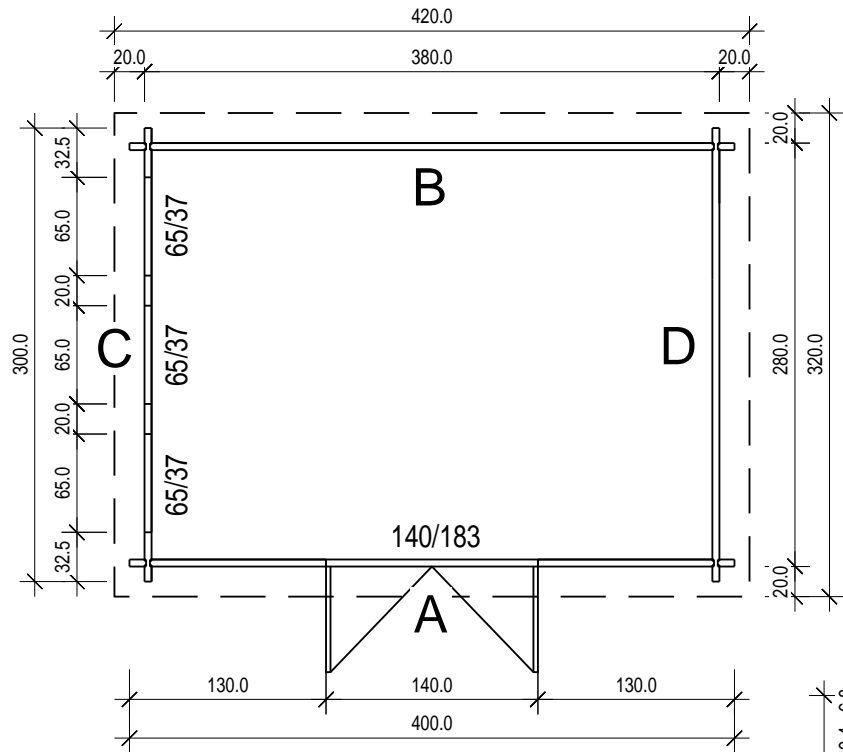

# Schnitt

4,5x14,0

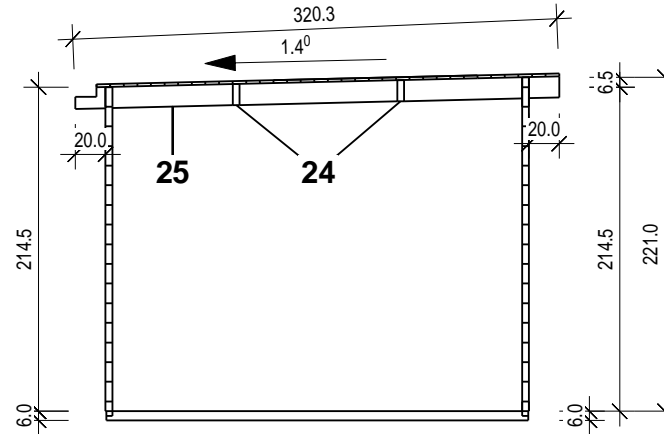

4,5

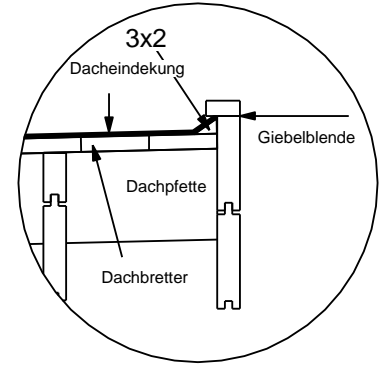

# Grundrahmenplan

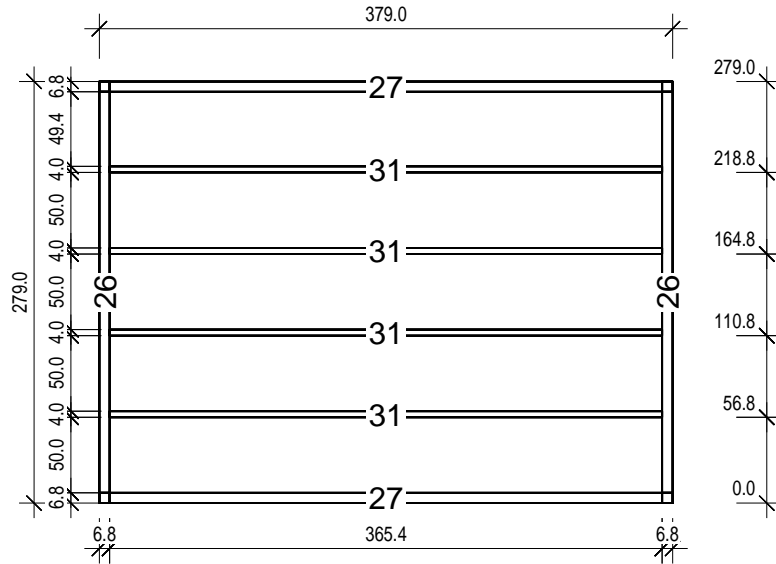
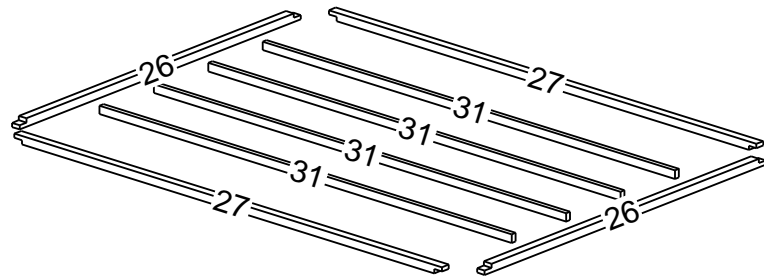

Nr.	B [cm]	H [cm]	L [cm]	Psc
26	6,0	6,8	279,0	2
27	6,0	6,8	379,0	2
31	4,0	6,0	365,4	4

# A

M 1:40

4,5x14,0

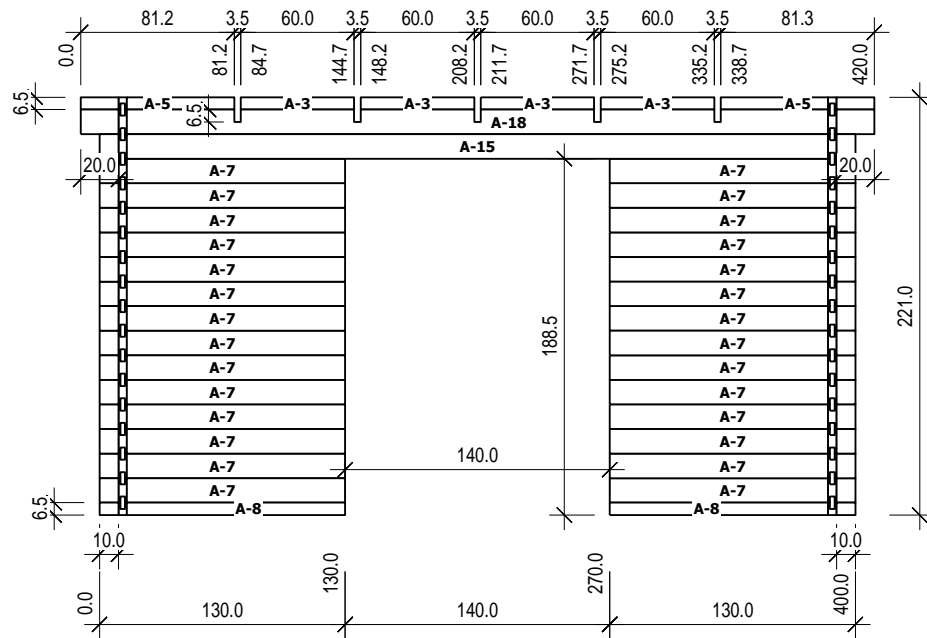

Nr	H	L	Psc
A 3	6,5	60,0	4
A 5	6,5	81,3	2
A 7	13,0	130,0	28
A 8	6,5	130,0	2
A 15	13,0	400,0	1
A 18	13,0	420,0	1

# B

M 1:40

4,5x14,0

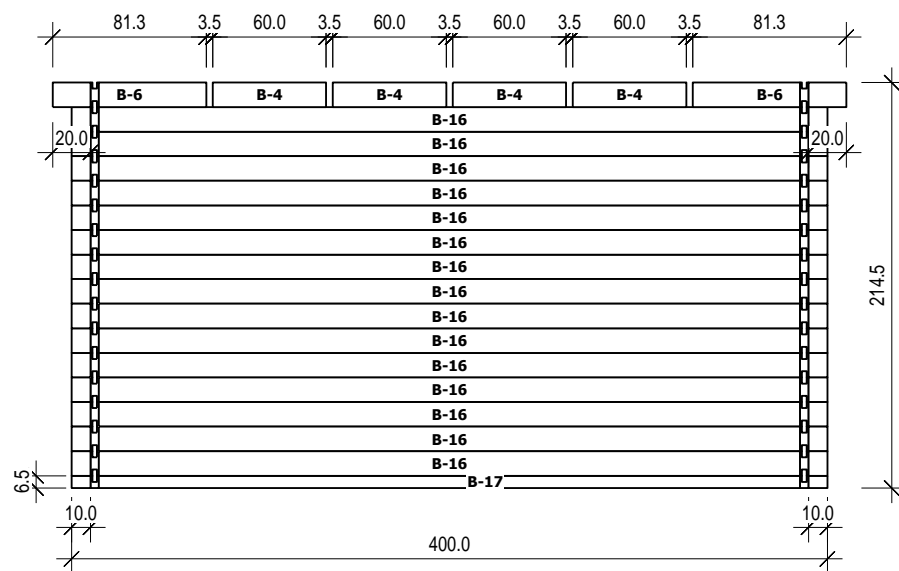

Nr	H	L	Psc
B 4	13,0	60,0	4
B 6	13,0	81,3	2
B 16	13,0	400,0	15
B 17	6,5	400,0	1

# C

M 1:40

4,5

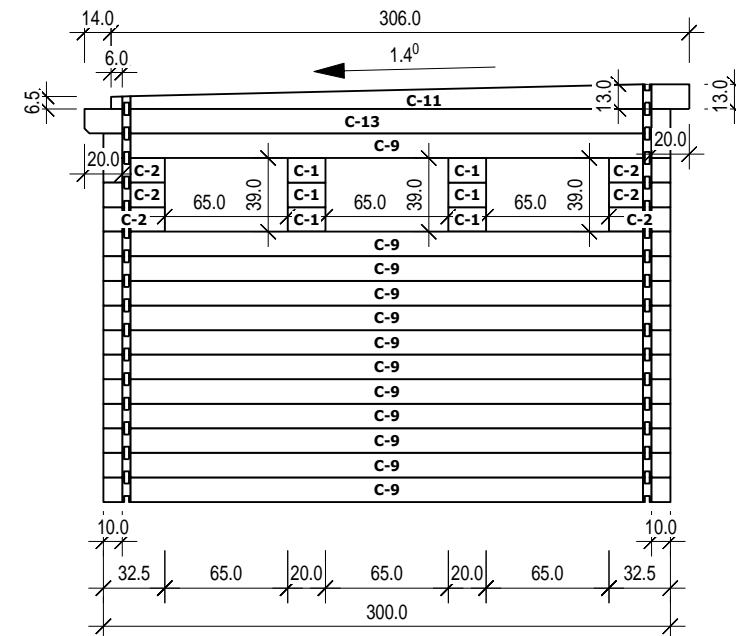

Nr	H	L	Psc
C 1	13,0	20,0	6
C 2	13,0	32,5	6
C 9	13,0	300,0	12
C 11	13,0	306,0	1
C 13	13,0	310,0	1

# D

M 1:40

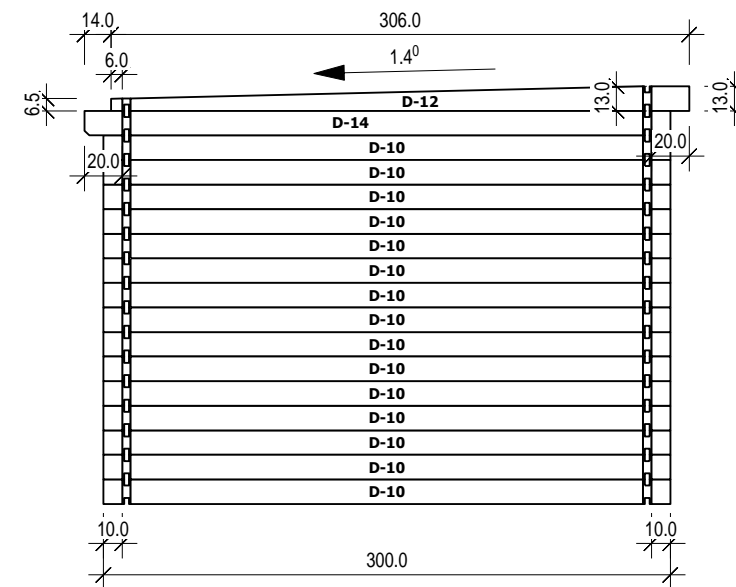

Nr	H	L	Psc
D 10	13,0	300,0	15
D 12	13,0	306,0	1
D 14	13,0	310,0	1