

Bemerkung: die Ansicht von Turen, Fenster und anderen Teilen kann abweichen von diesem Bild

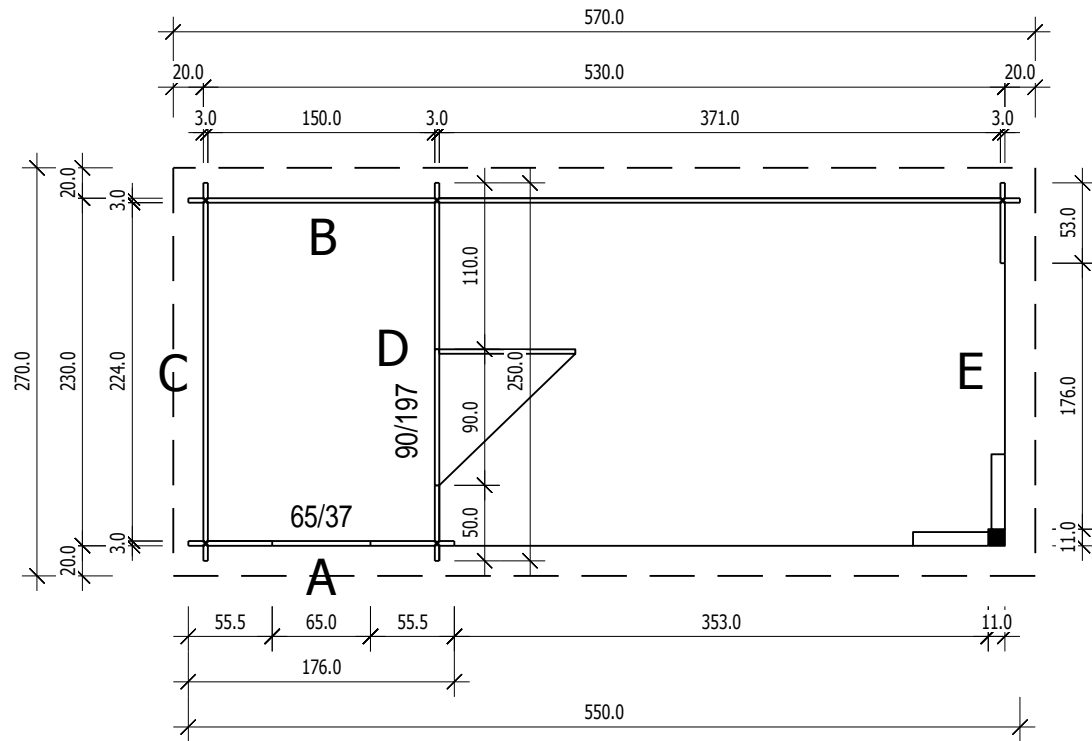

Grundriss



Schnitt

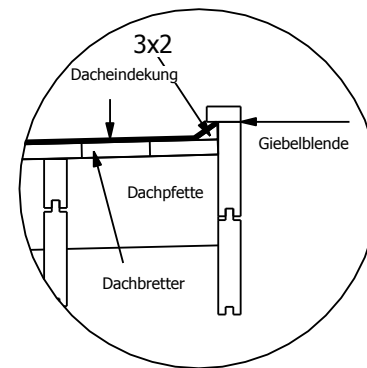
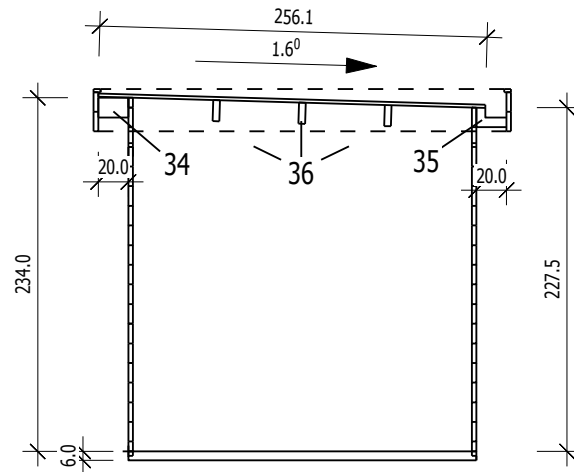

Grundrahmenplan

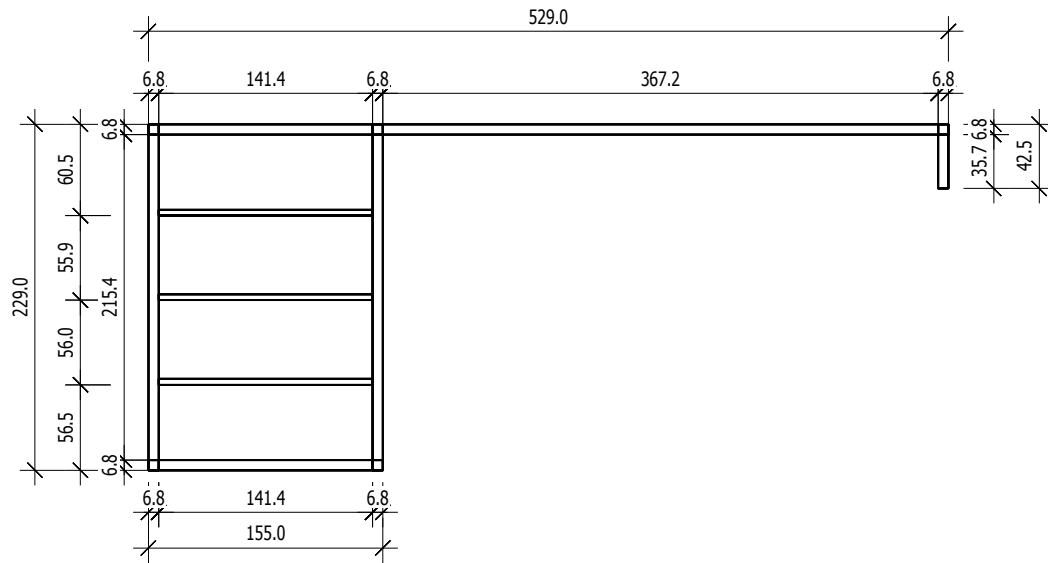

Nr.	B [cm]	H [cm]	L [cm]	Psc
26	6,8	6,0	42,5	1
27	4,0	6,0	141,4	3
28	6,8	6,0	155,0	1
30	6,8	6,0	229,0	2
31	6,8	6,0	529,0	1

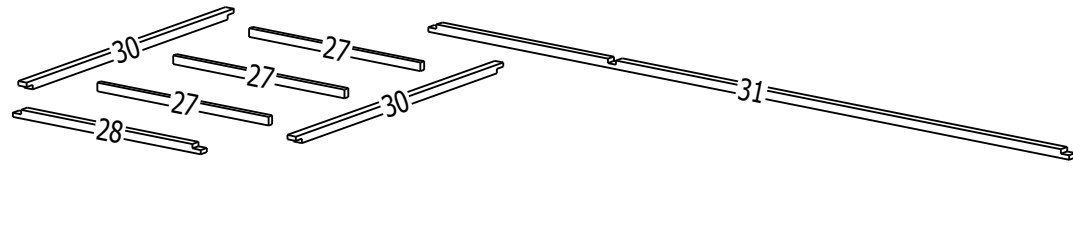

A
M 1:40

Ansicht von Aussen

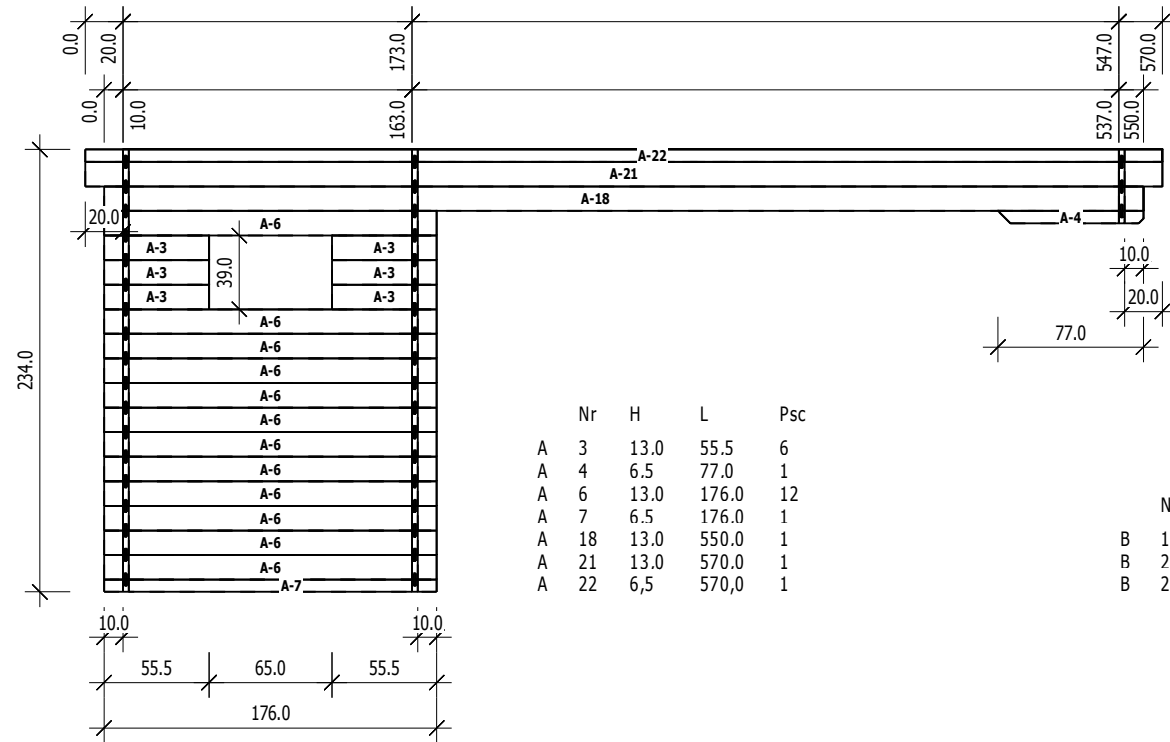

B
M 1:40

Ansicht von Innen

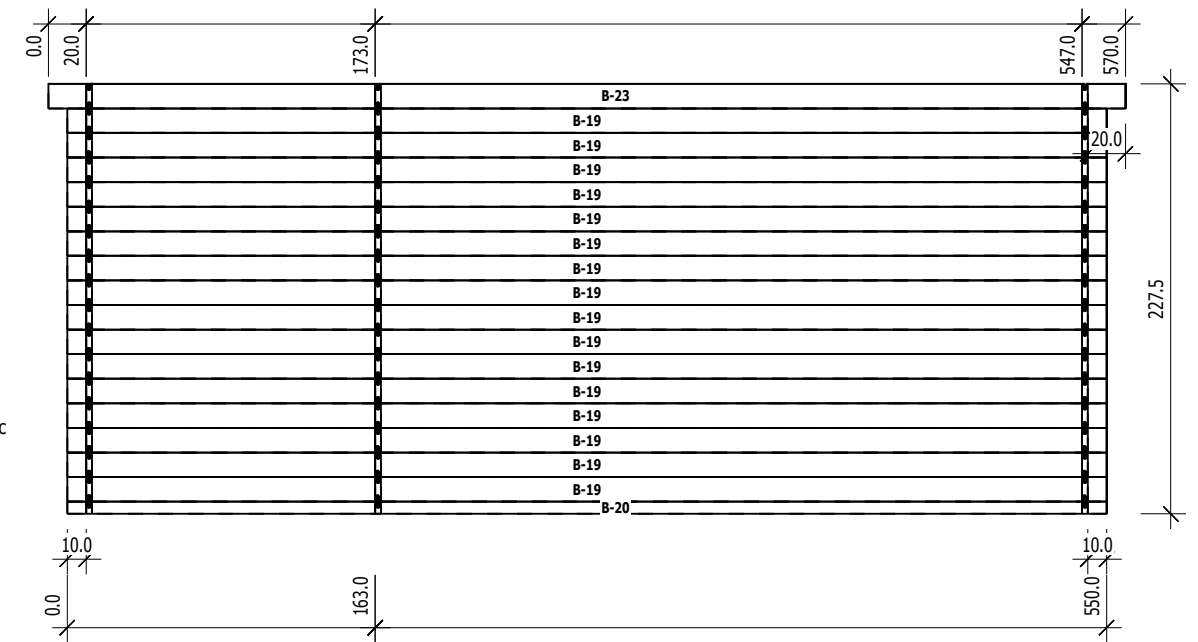

C
M 1:40

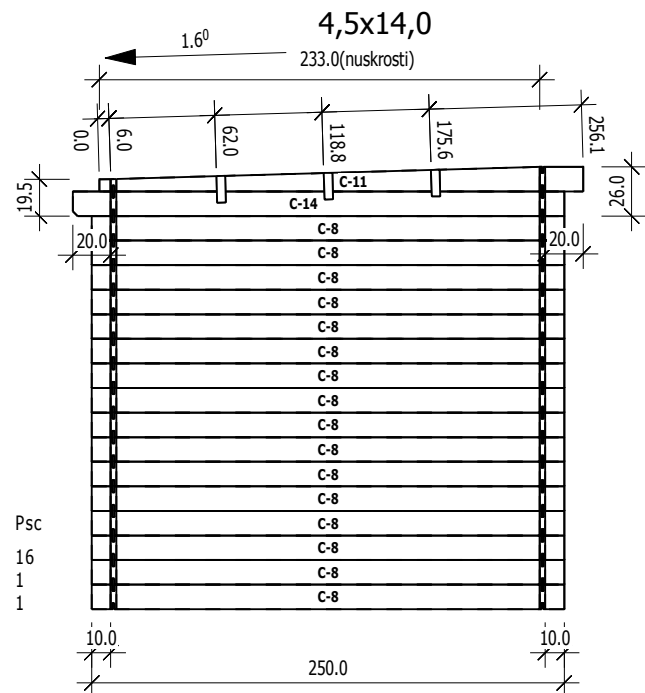

D
M 1:40

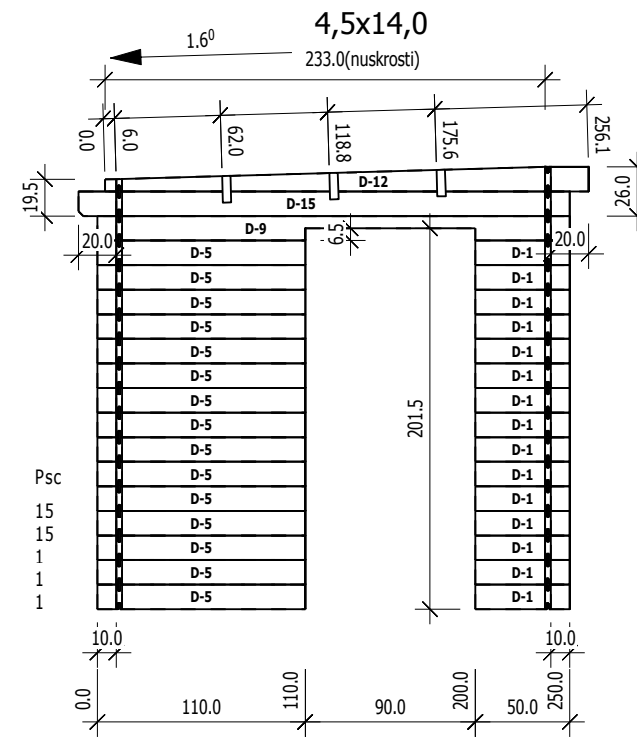

E
M 1:40

