

Edith-5035

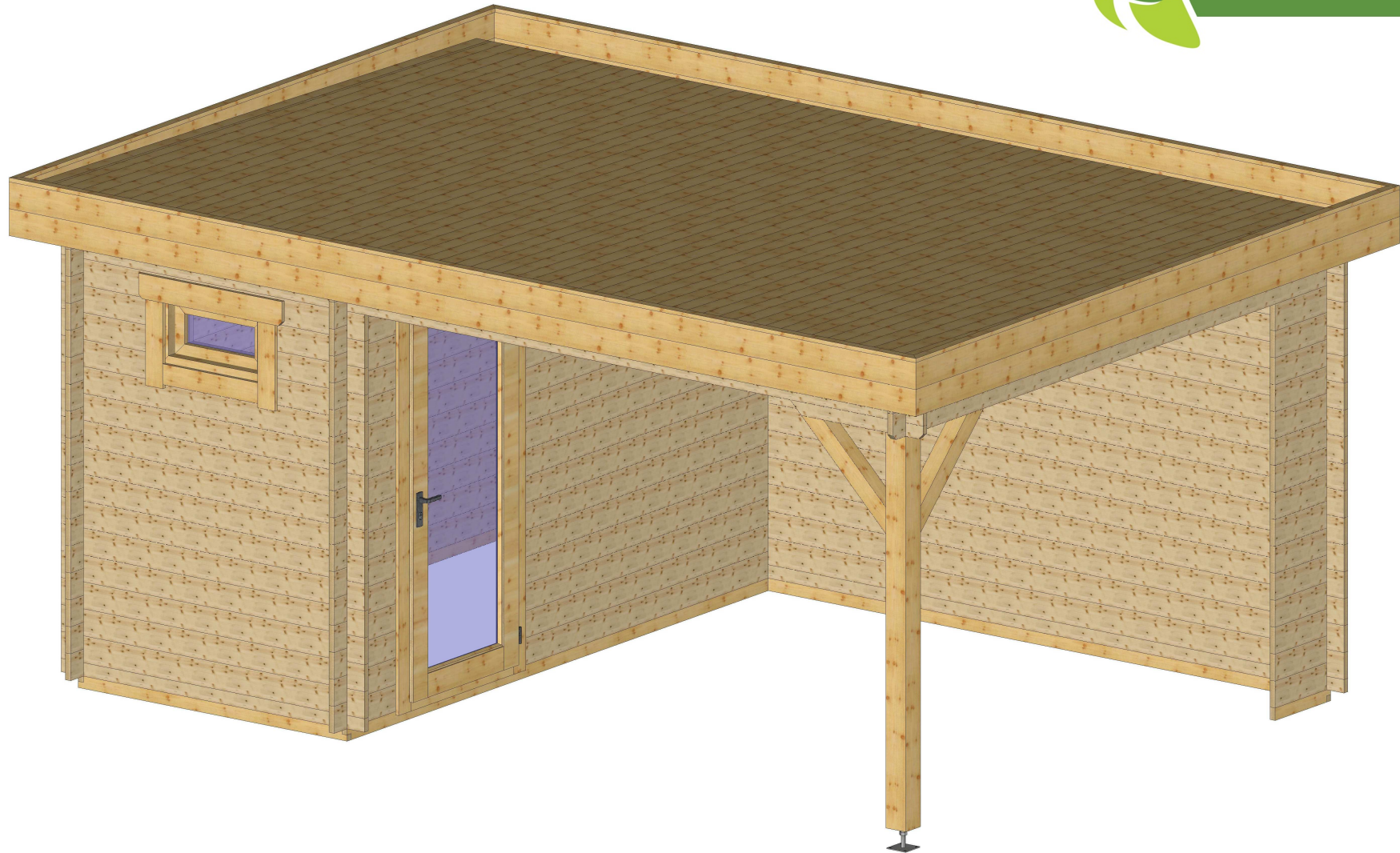

Bemerkung: die Ansicht von Turen, Fenster und anderen Teilen kann abweichen von diesem Bild

Grundriss

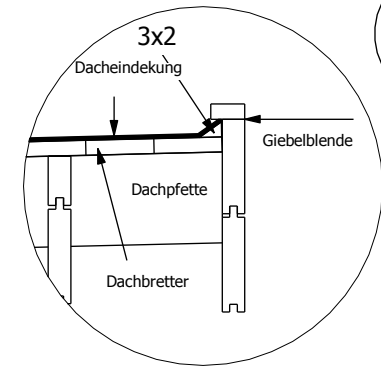
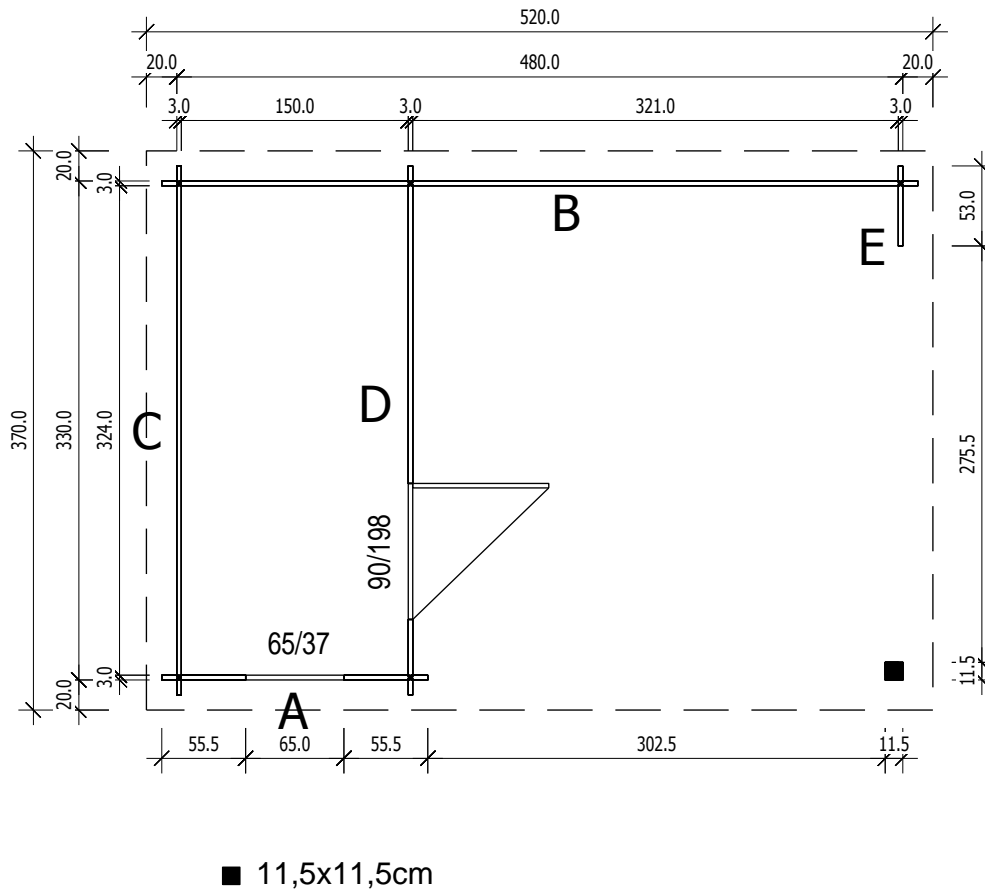

3,0)

Schnitt

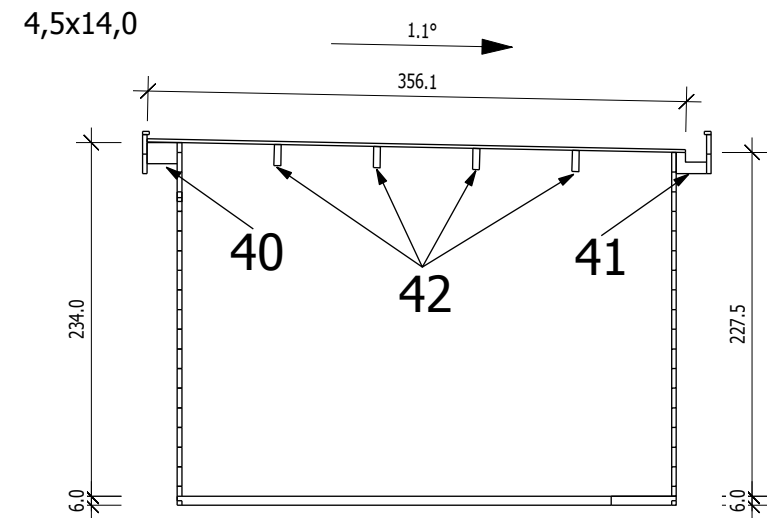

3,0

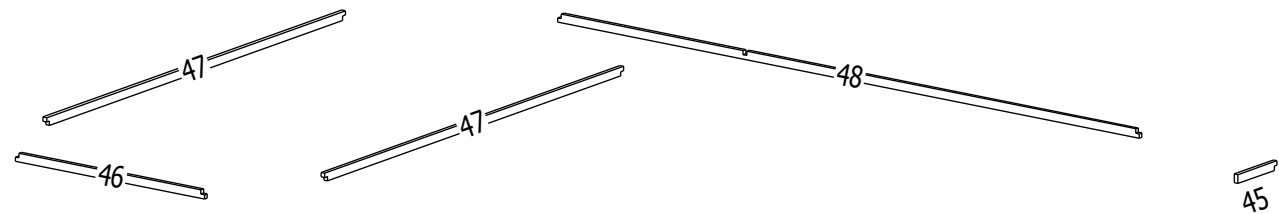
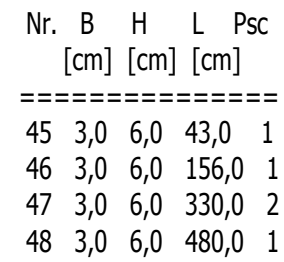

A

M 1:40

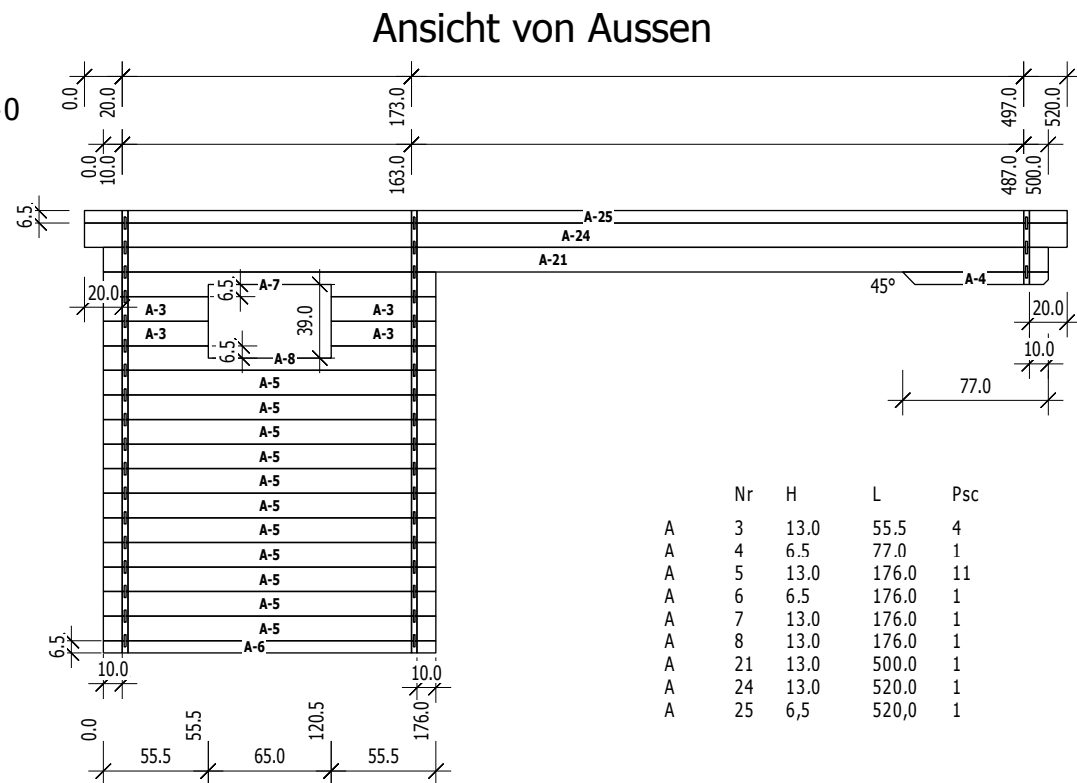

	Nr	H	L	Psc
A	3	13.0	55.5	4
A	4	6.5	77.0	1
A	5	13.0	176.0	11
A	6	6.5	176.0	1
A	7	13.0	176.0	1
A	8	13.0	176.0	1
A	21	13.0	500.0	1
A	24	13.0	520.0	1
A	25	6.5	520.0	1

B

M 1:40

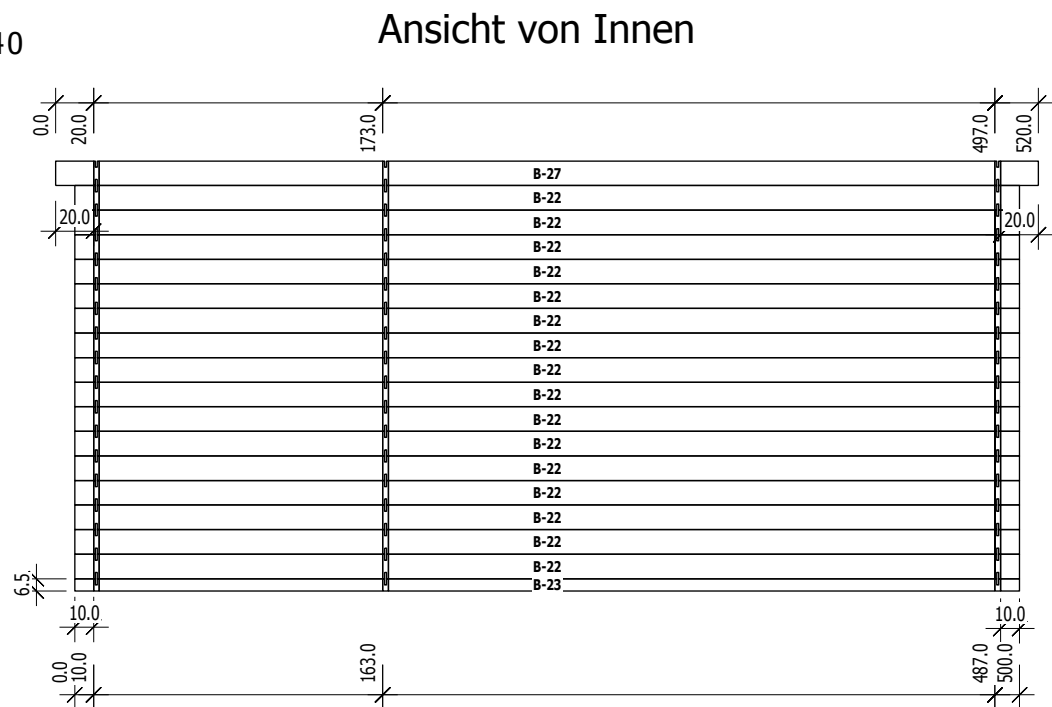

	Nr	H	L	Psc
B	22	13.0	500.0	16
B	23	6.5	500.0	1
B	27	13.0	520.0	1

C

M 1:40

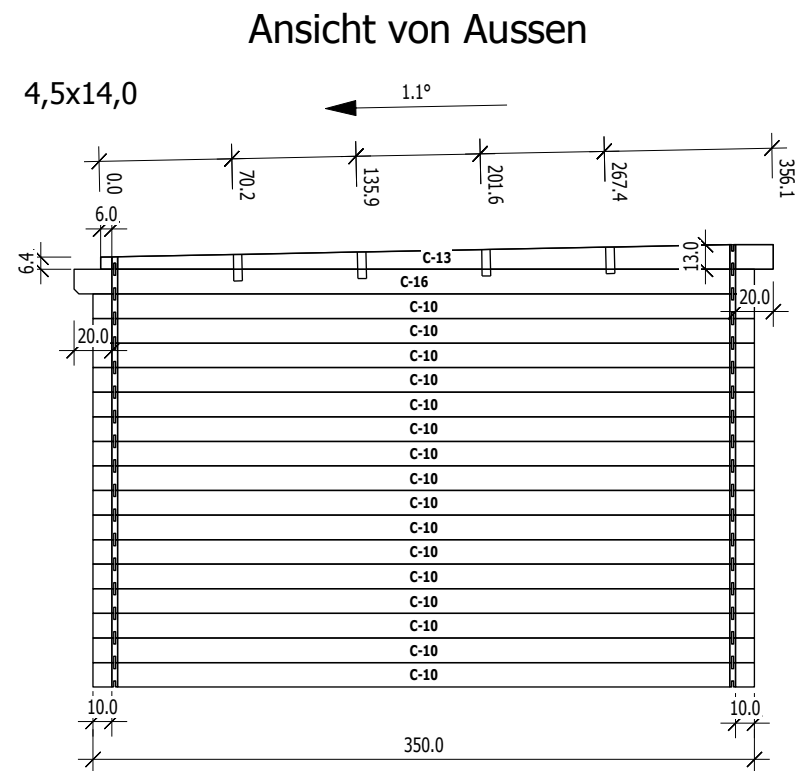

	Nr	H	L	Psc
C	10	13.0	350.0	16
C	13	13.0	356.0	1
C	16	13.0	360.0	1

D

M 1:40

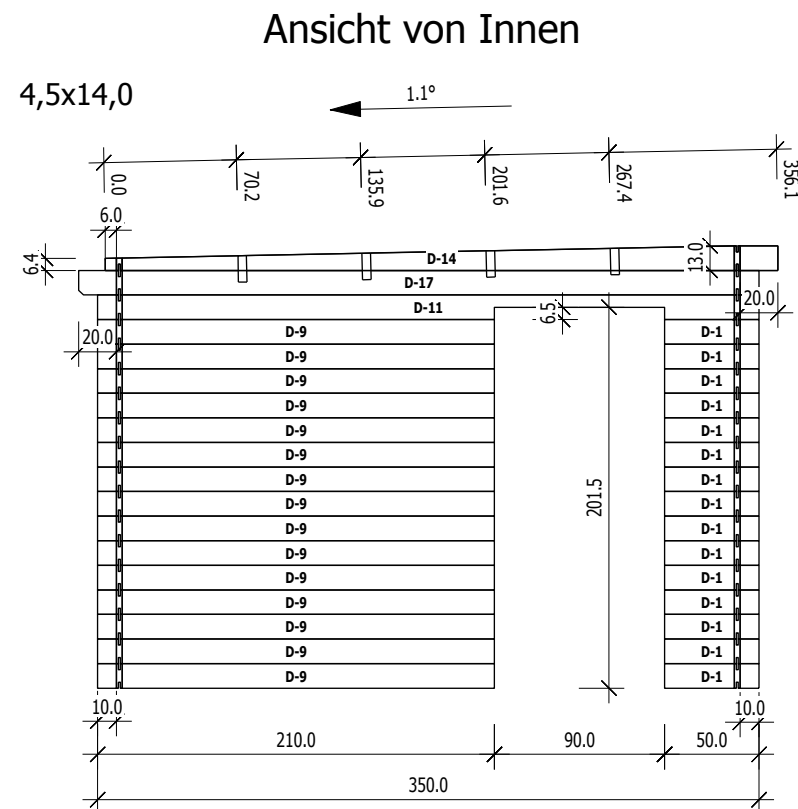

	Nr	H	L	Psc
D	1	13.0	50.0	15
D	9	13.0	210.0	15
D	11	13.0	350.0	1
D	14	13.0	356.0	1
D	17	13.0	360.0	1

3,0

E

M 1:40 4,5x14,0

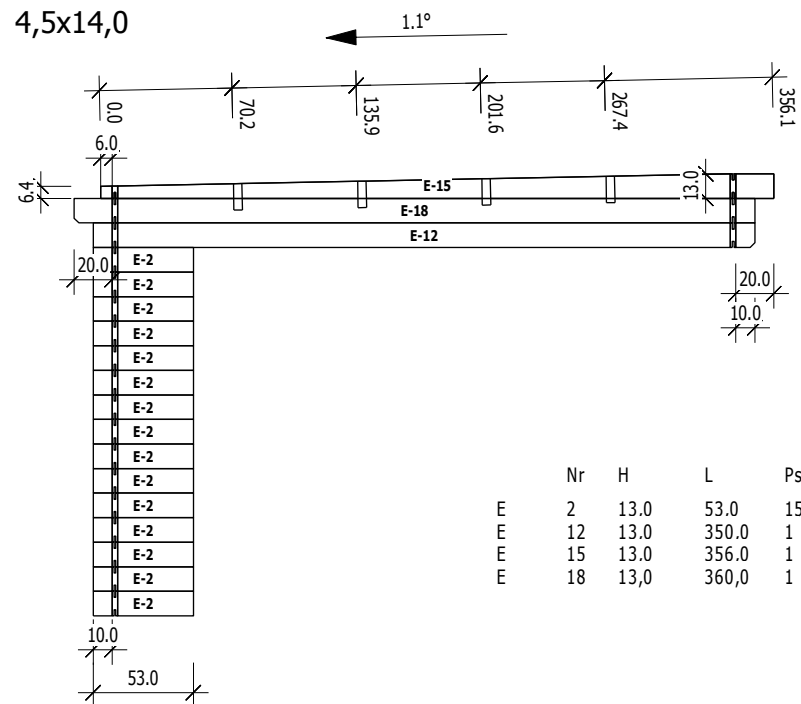

	Nr	H	L	Psc
E	2	13.0	53.0	15
E	12	13.0	350.0	1
E	15	13.0	356.0	1
E	18	13.0	360.0	1