

# "Classic Daisy-Typ" 228 x 186 E h-205



Bemerkung: die Ansicht von Türen, Fenster und andere Teile kann abweichen von diesem Bild

## A 3D perspective rendering of the interior of a wooden sauna. The walls are clad in vertical wooden planks. Three tiers of wooden benches are built against the back wall. A small, square wooden heater is mounted on the upper left wall. The floor is made of wooden planks, and a small wooden door is visible on the right side.

Bemerkung: die Ansicht von Türen, Fenster und andere Teile kann abweichen von diesem Bild



# “Classic Daisy-Typ” 228 x 186 E h-205

## Schnitt

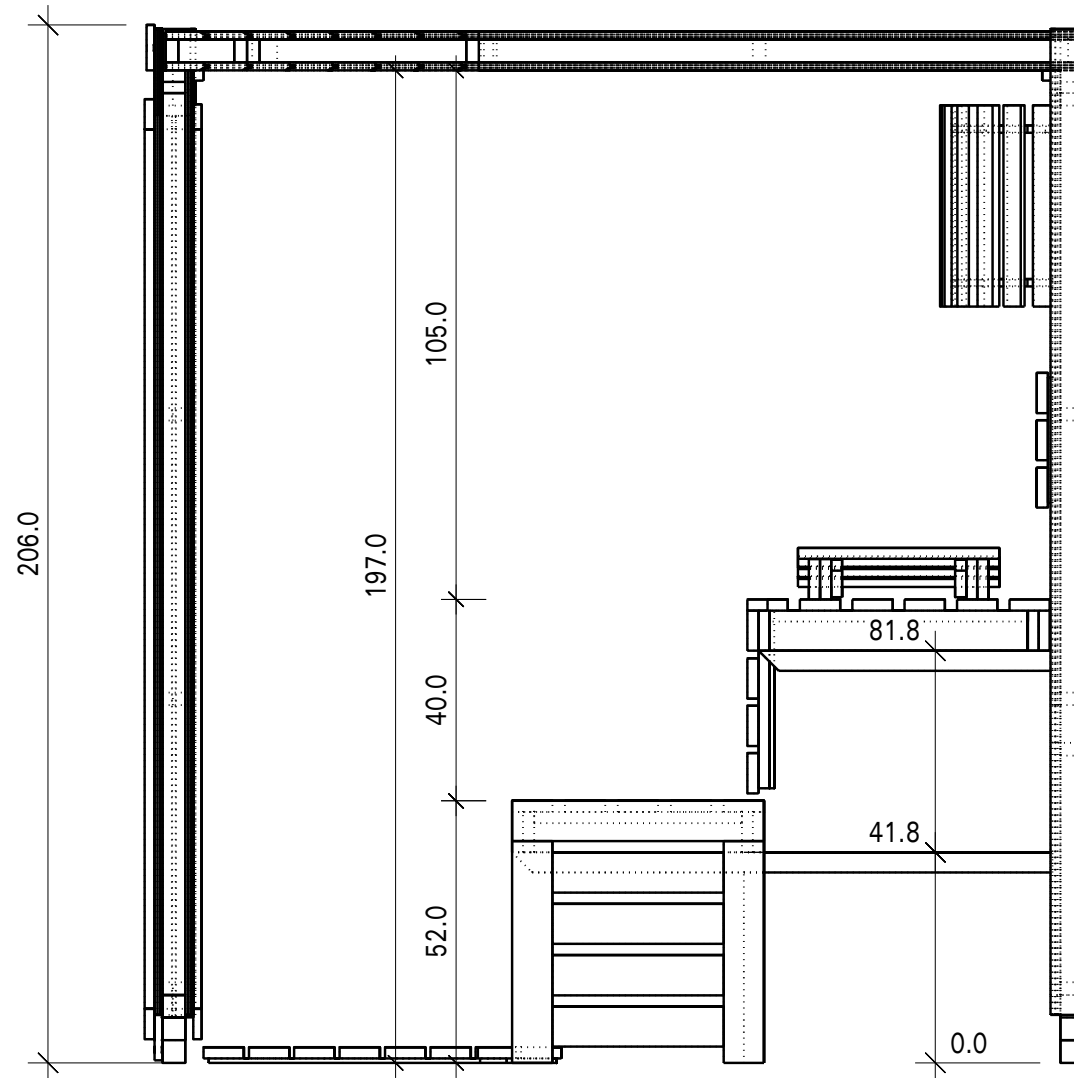

Grundriss

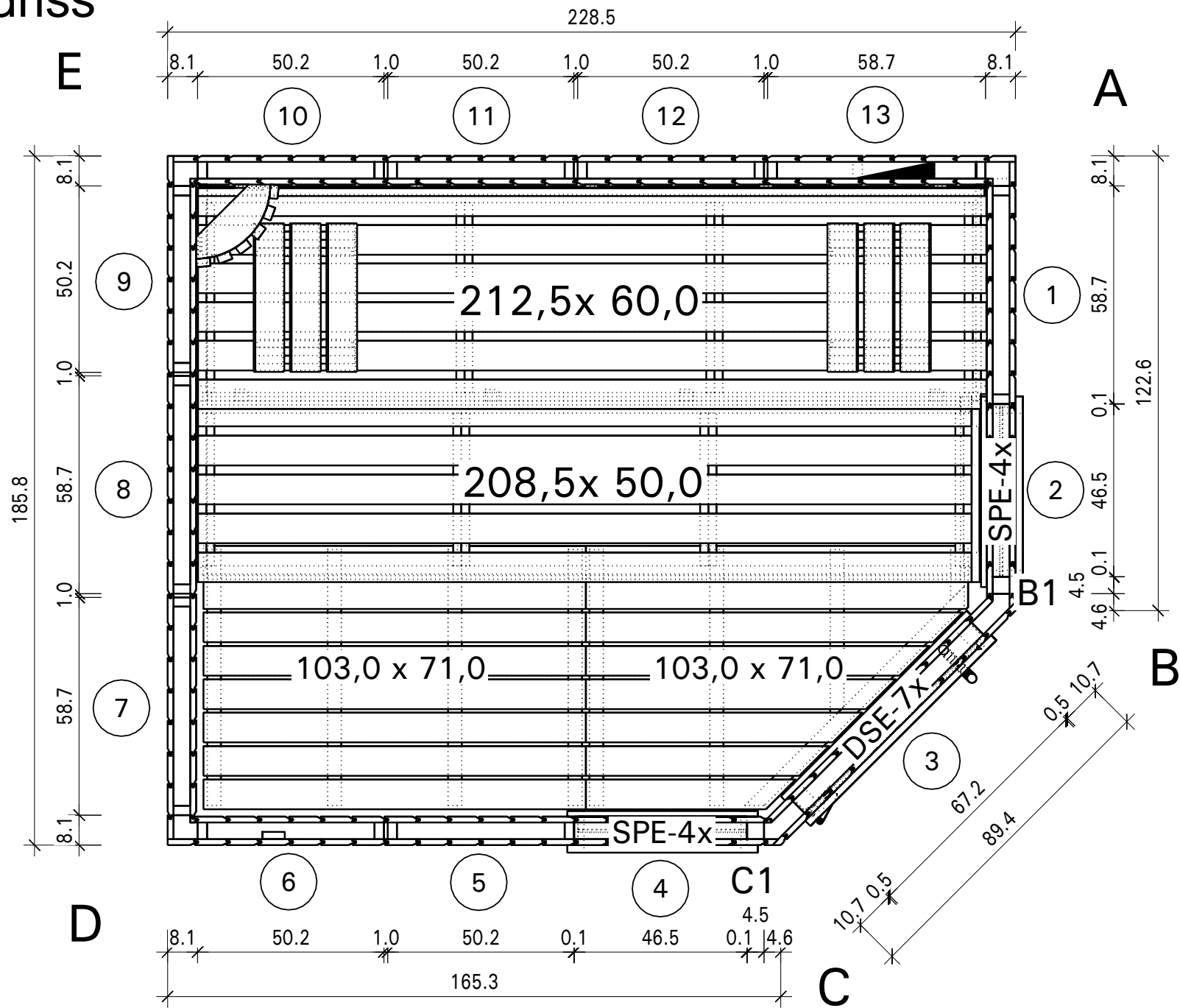

"Classic Daisy-Typ" 228 x 186 E h-205

# Grundrahmen

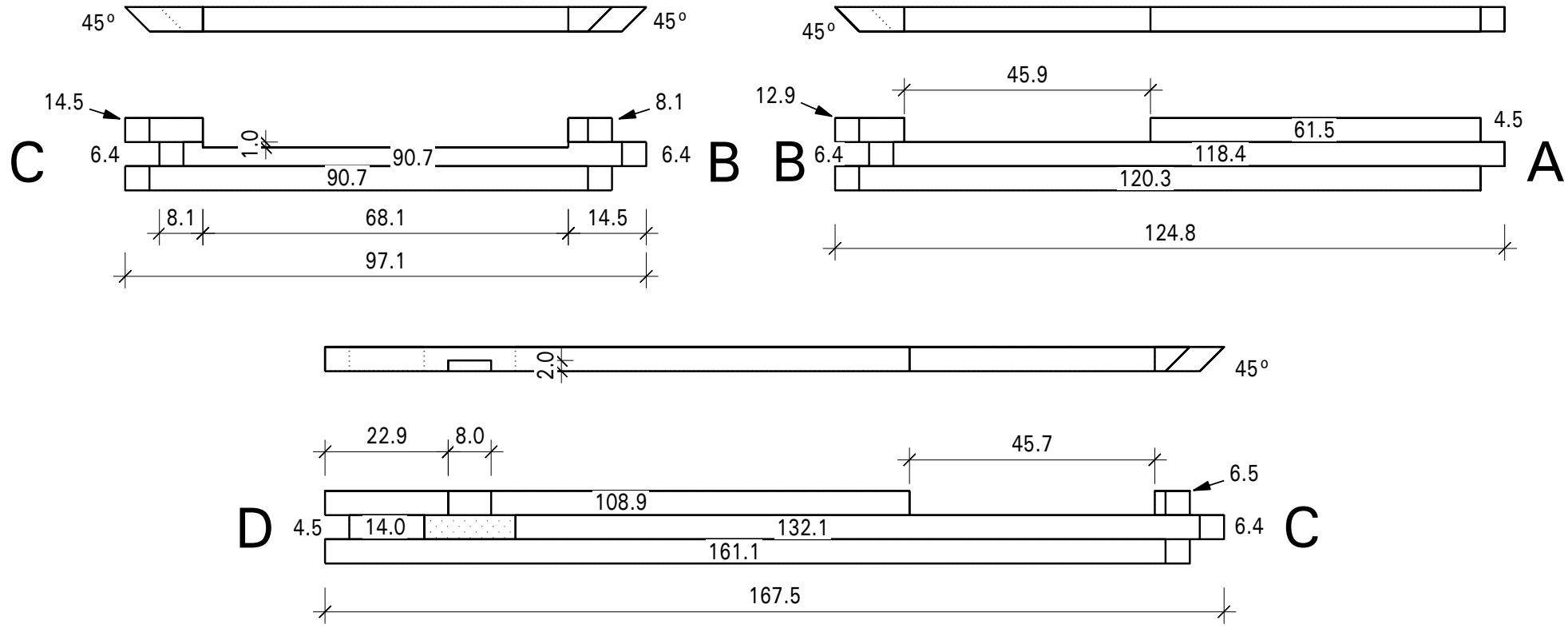
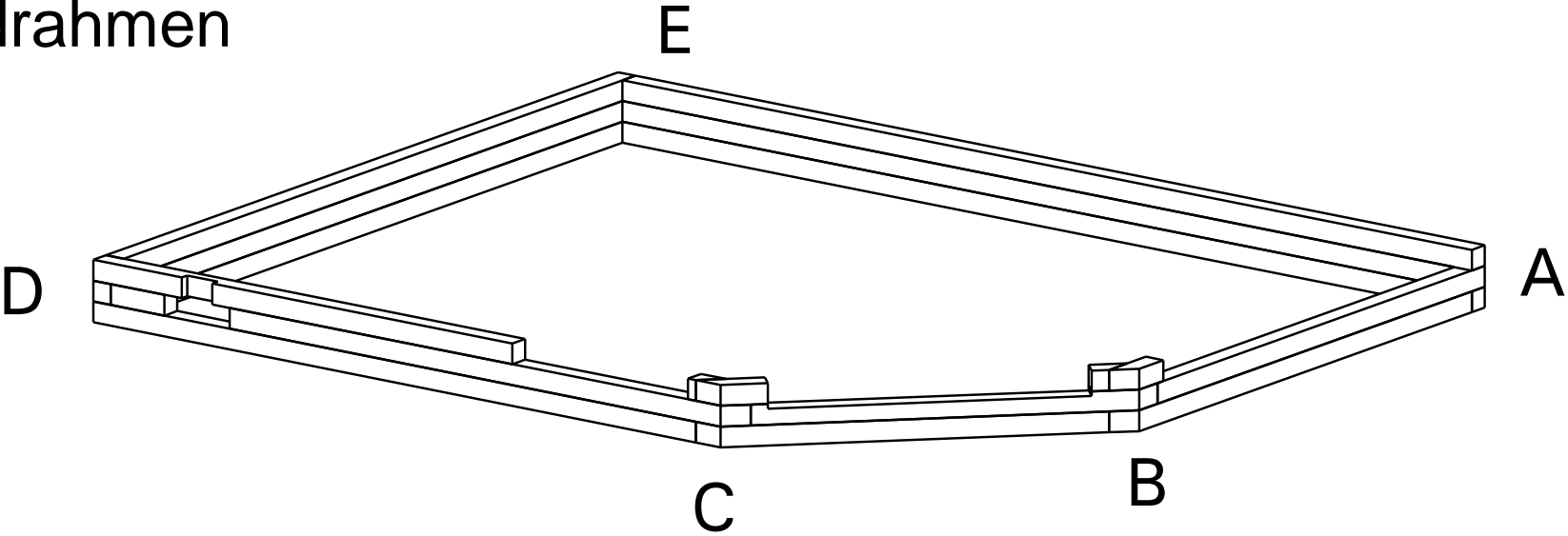

# Grundrahmen

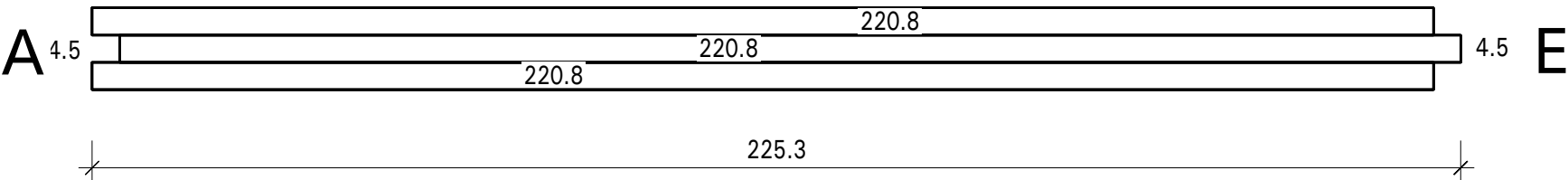
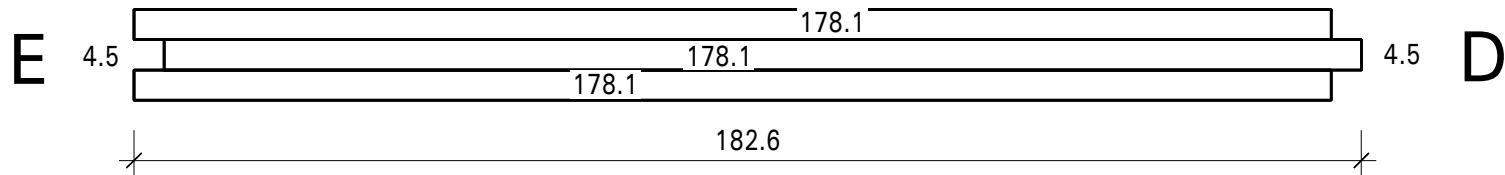

# Dachrahmen

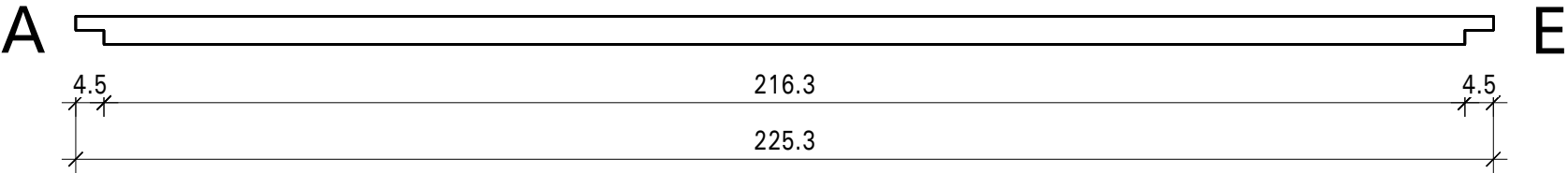
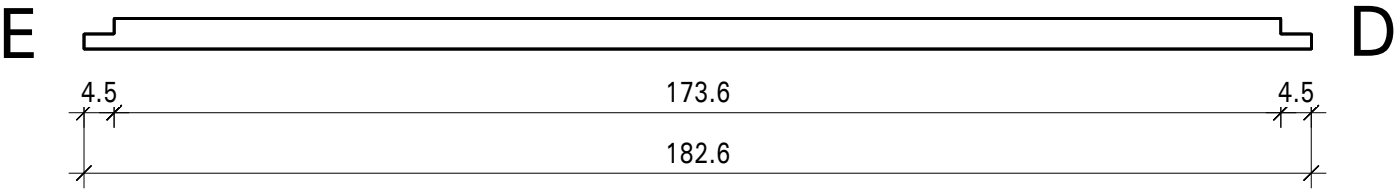
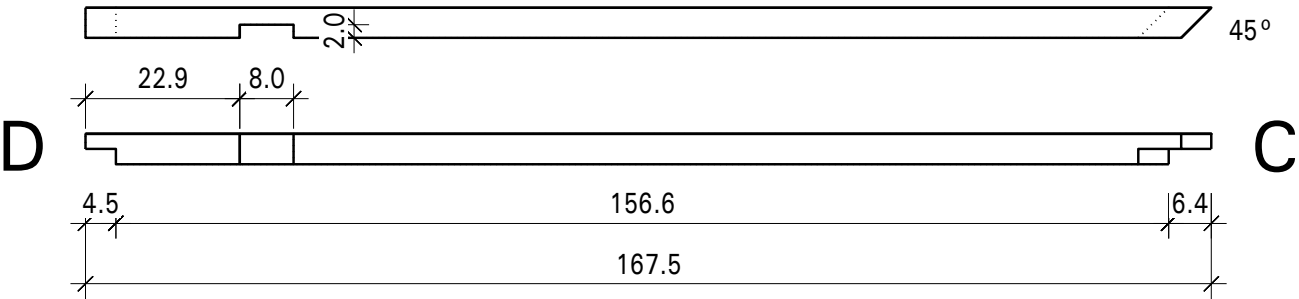
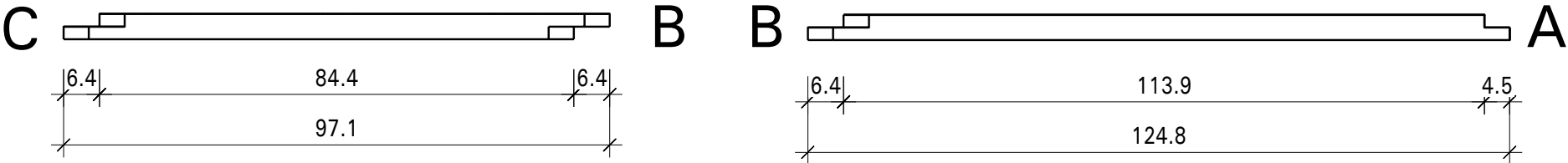
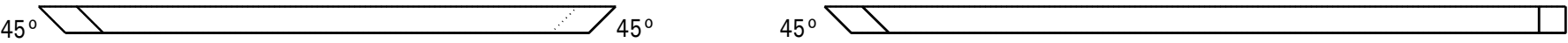
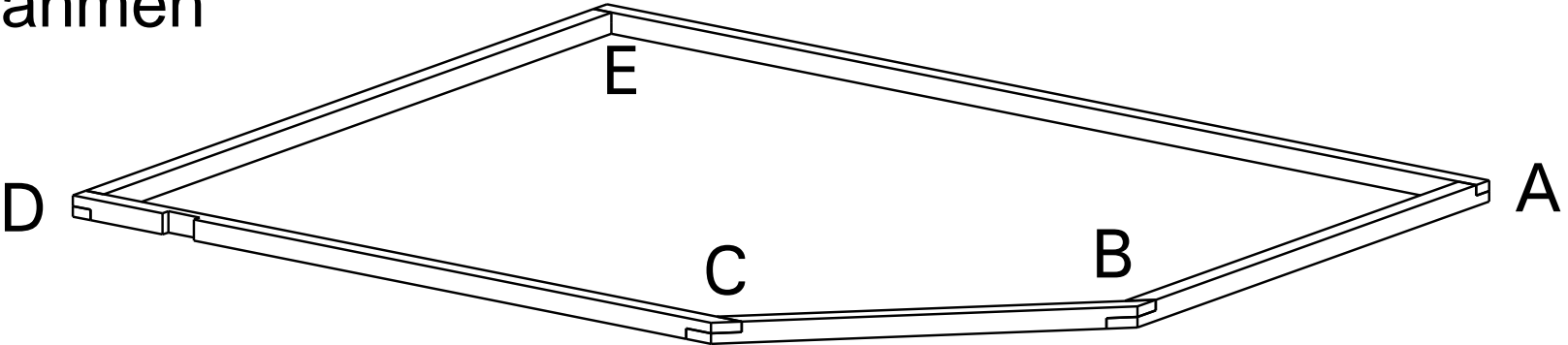

# Dachelemente

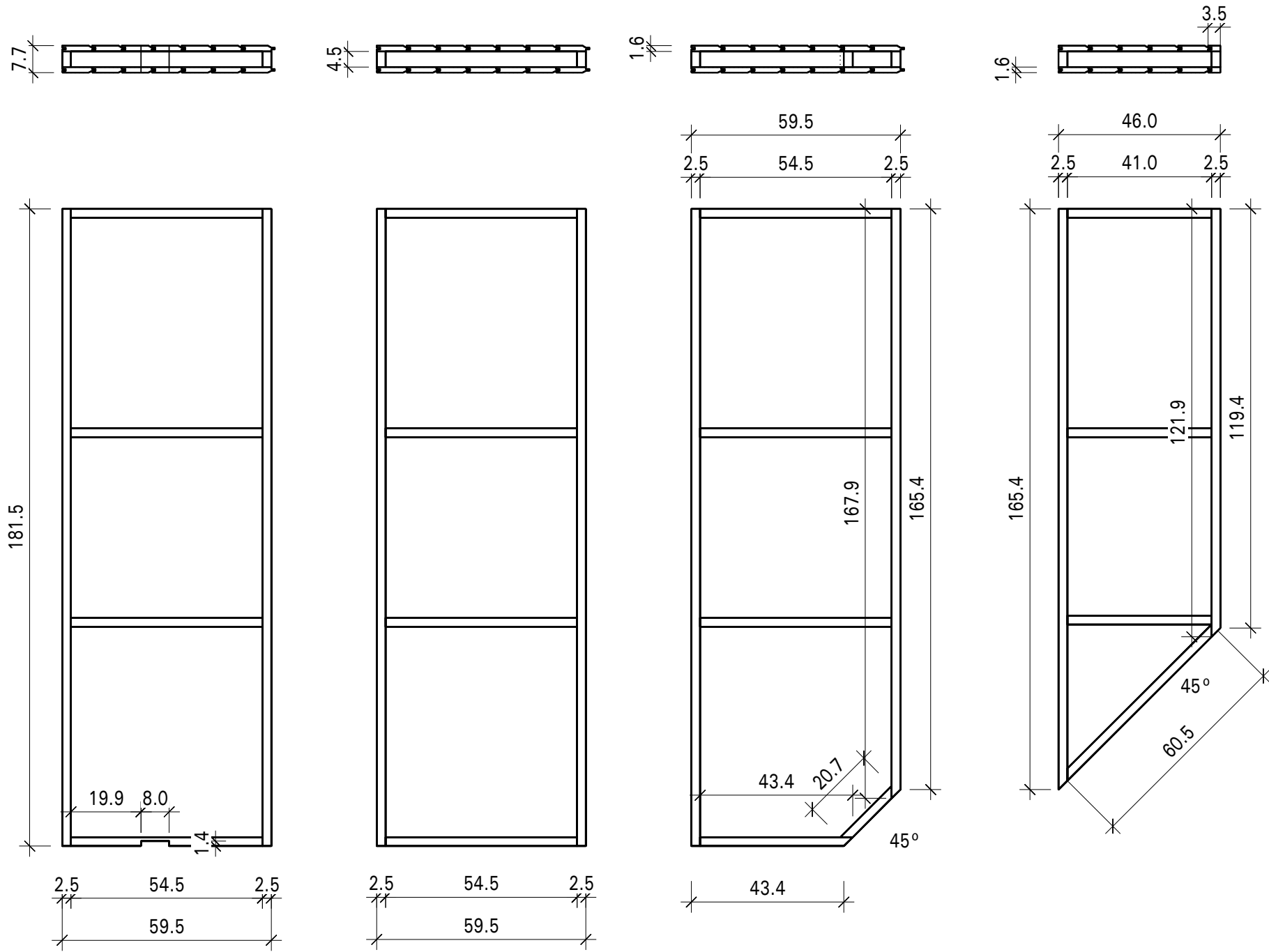



# Glaseinbau

