

Bemerkung: die Ansicht von Turen, Fenster und anderen Teilen kann abweichen von diesem Bild

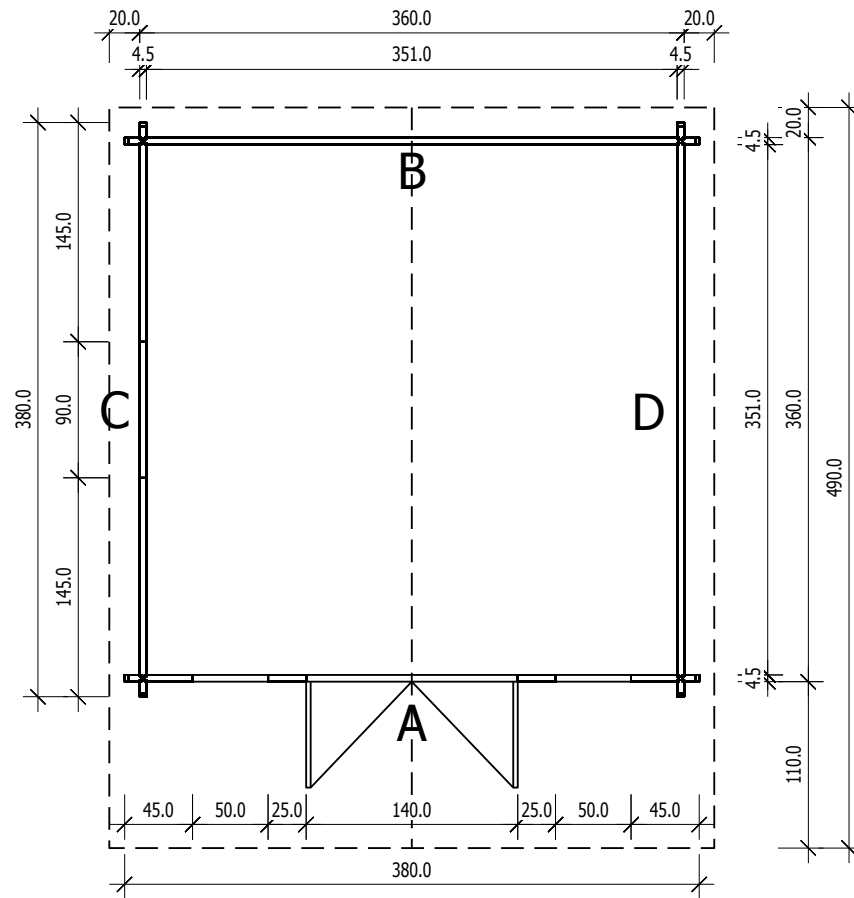

4,5



Grundriss

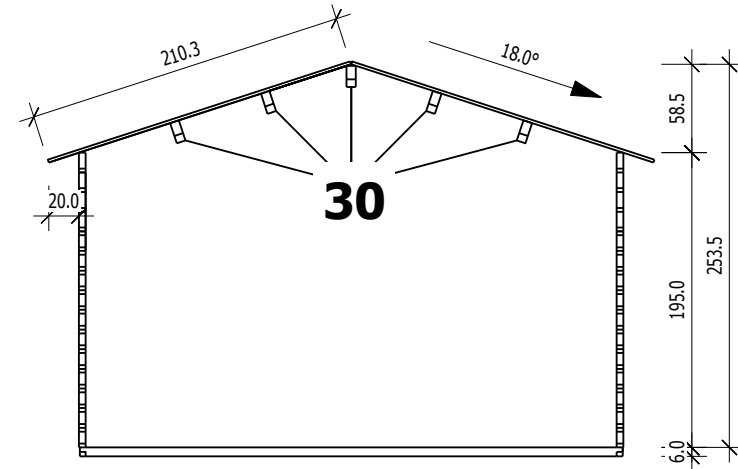
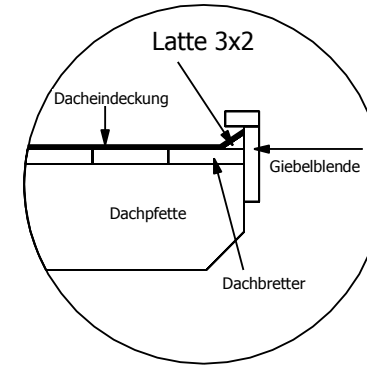

Schnitt

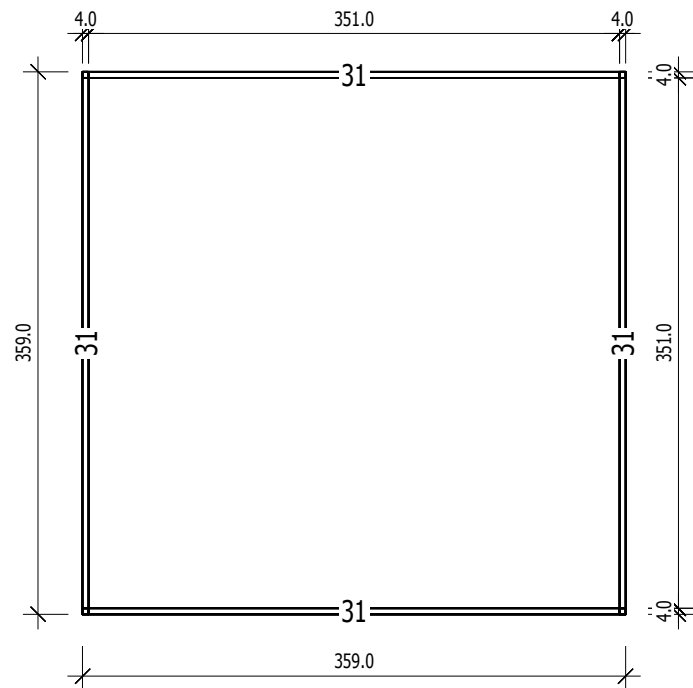

Nr	H	L	W	Psc
	[cm]	[cm]	[cm]	
31	6,0	359,0	4,0	4

Grundrahmenplan

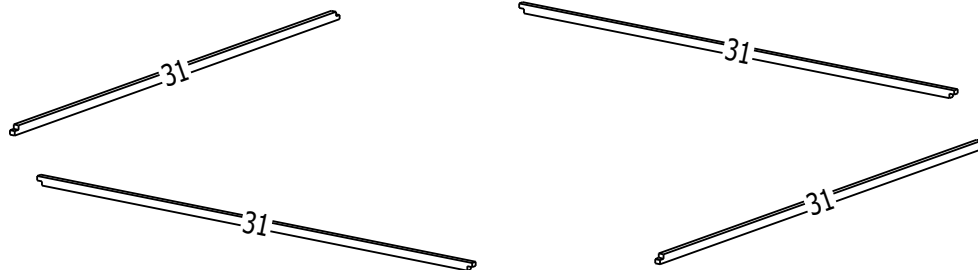

	Nr	H	L	Psc
A	1	6,5	25,0	2
A	2	13,0	25,0	28
A	3	13,0	45,0	28
A	4	6,5	45,0	2
A	5	13,0	80,0	1
A	8	13,0	160,0	1
A	13	13,0	240,0	1
A	15	13,0	320,0	1
A	17	13,0	380,0	1

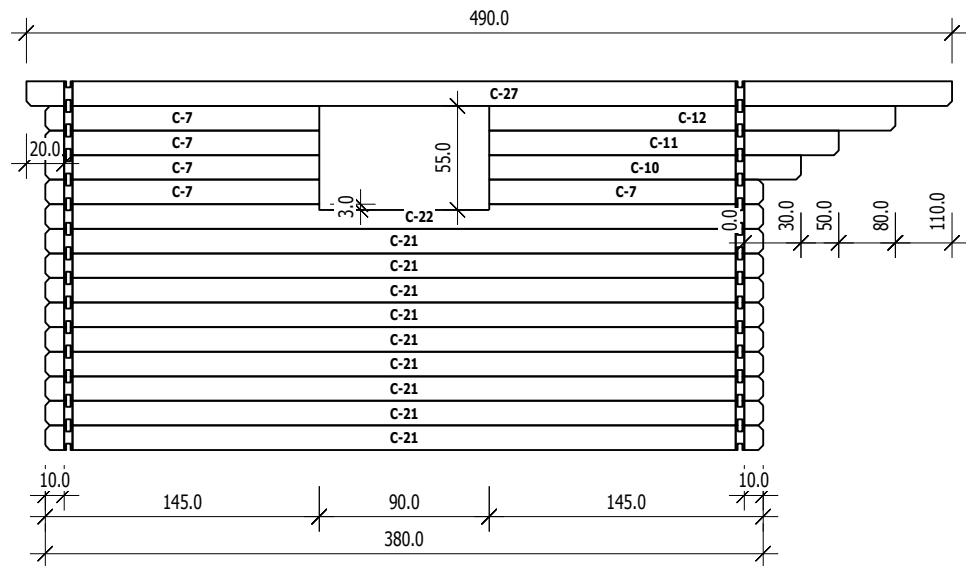
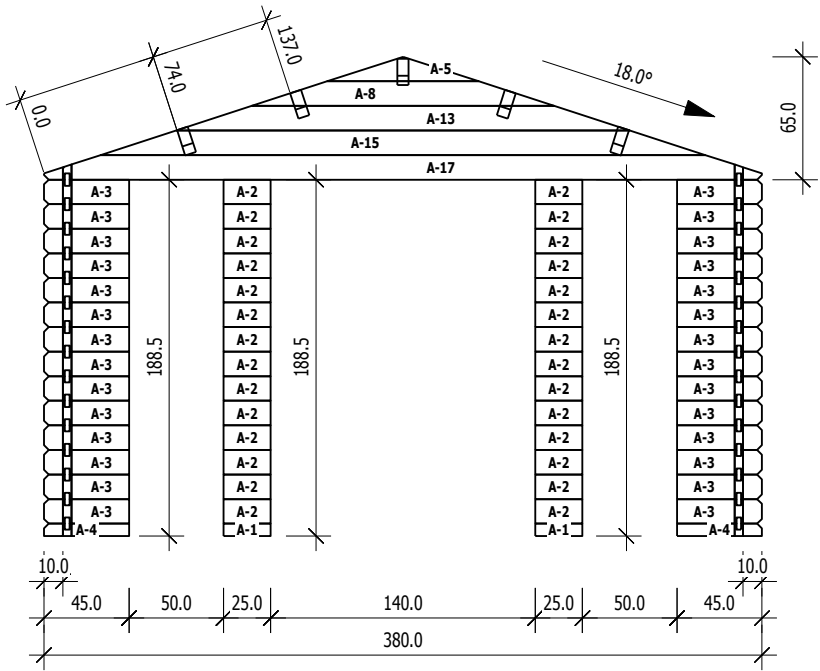

	Nr	H	L	Psc
C	7	13,0	145,0	5
C	10	13,0	165,0	1
C	11	13,0	185,0	1
C	12	13,0	215,0	1
C	21	13,0	380,0	9
C	22	13,0	380,0	1
C	27	13,0	490,0	1

	Nr	H	L	Psc
B	6	13,0	80,0	1
B	9	13,0	160,0	1
B	14	13,0	240,0	1
B	16	13,0	320,0	1
B	18	13,0	380,0	14
B	19	6,5	380,0	1
B	20	13,0	380,0	1

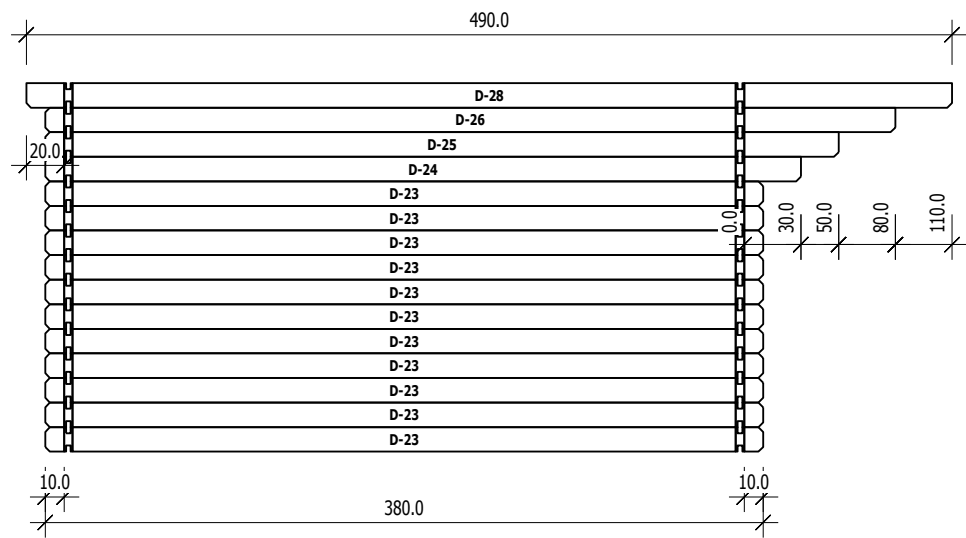
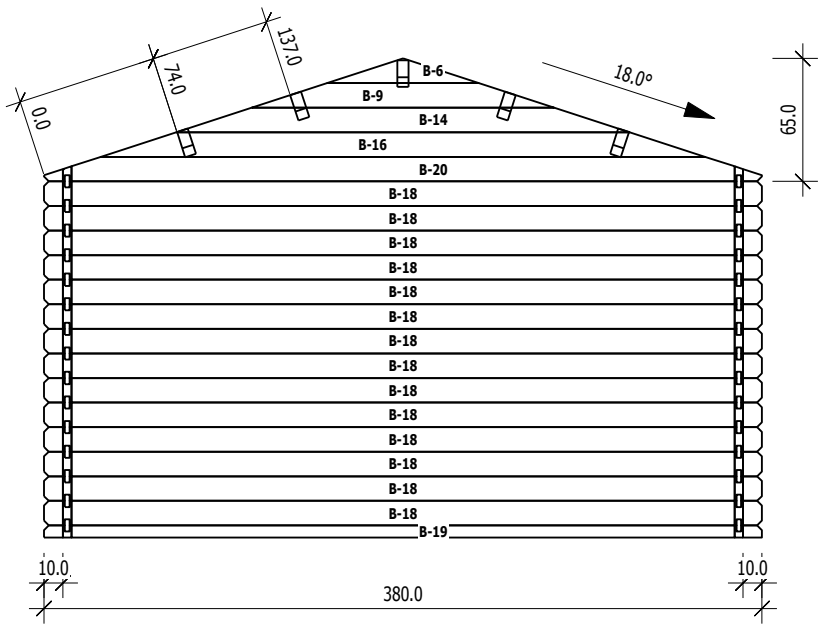

	Nr	H	L	Psc
D	23	13,0	380,0	11
D	24	13,0	400,0	1
D	25	13,0	420,0	1
D	26	13,0	450,0	1
D	28	13,0	490,0	1