

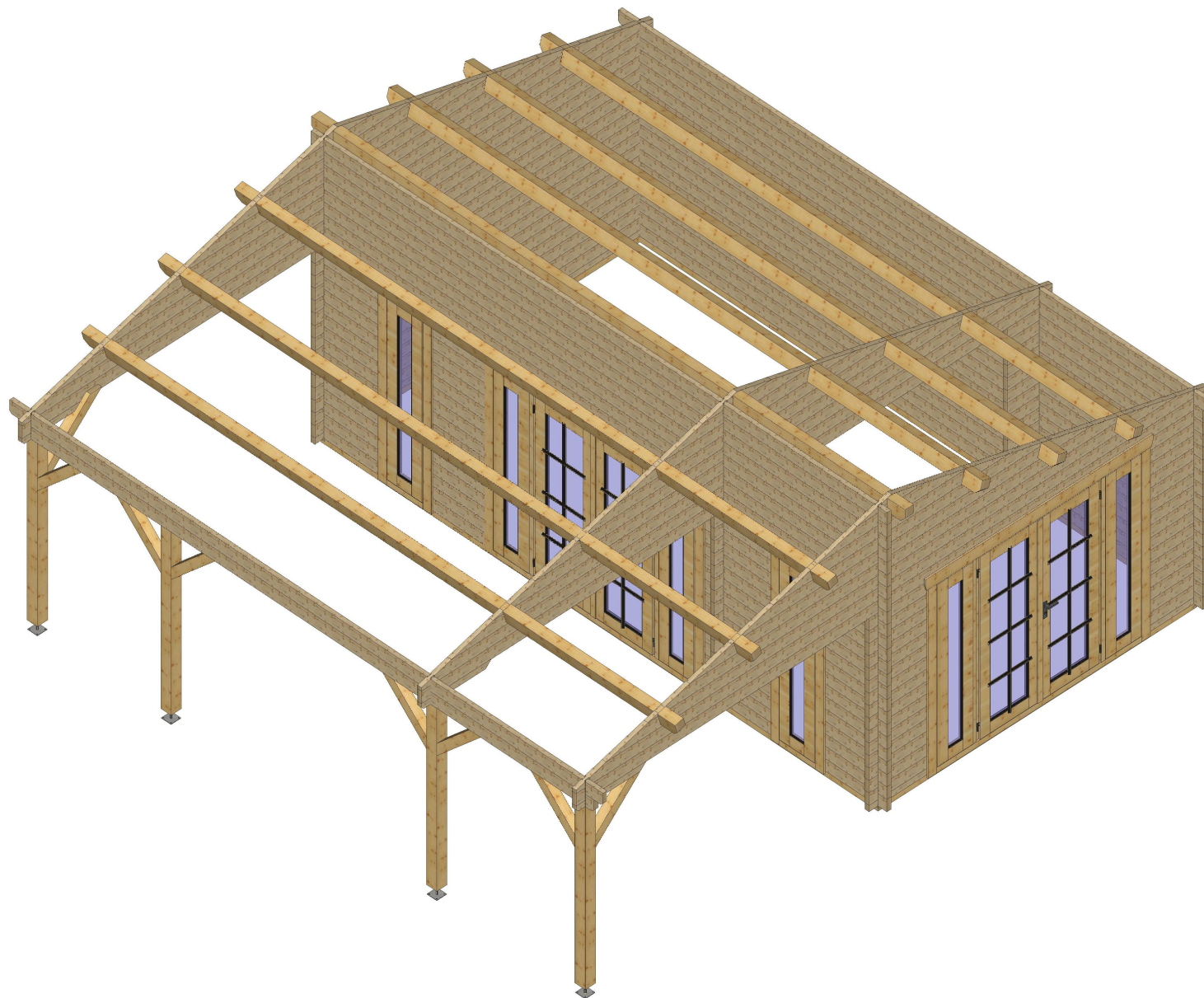

Bemerkung: die Ansicht von Turen, Fenster und anderen Teilen kann abweichen von diesem Bild



Bemerkung: die Ansicht von Turen, Fenster und anderen Teilen kann abweichen von diesem Bild

# Grundriss

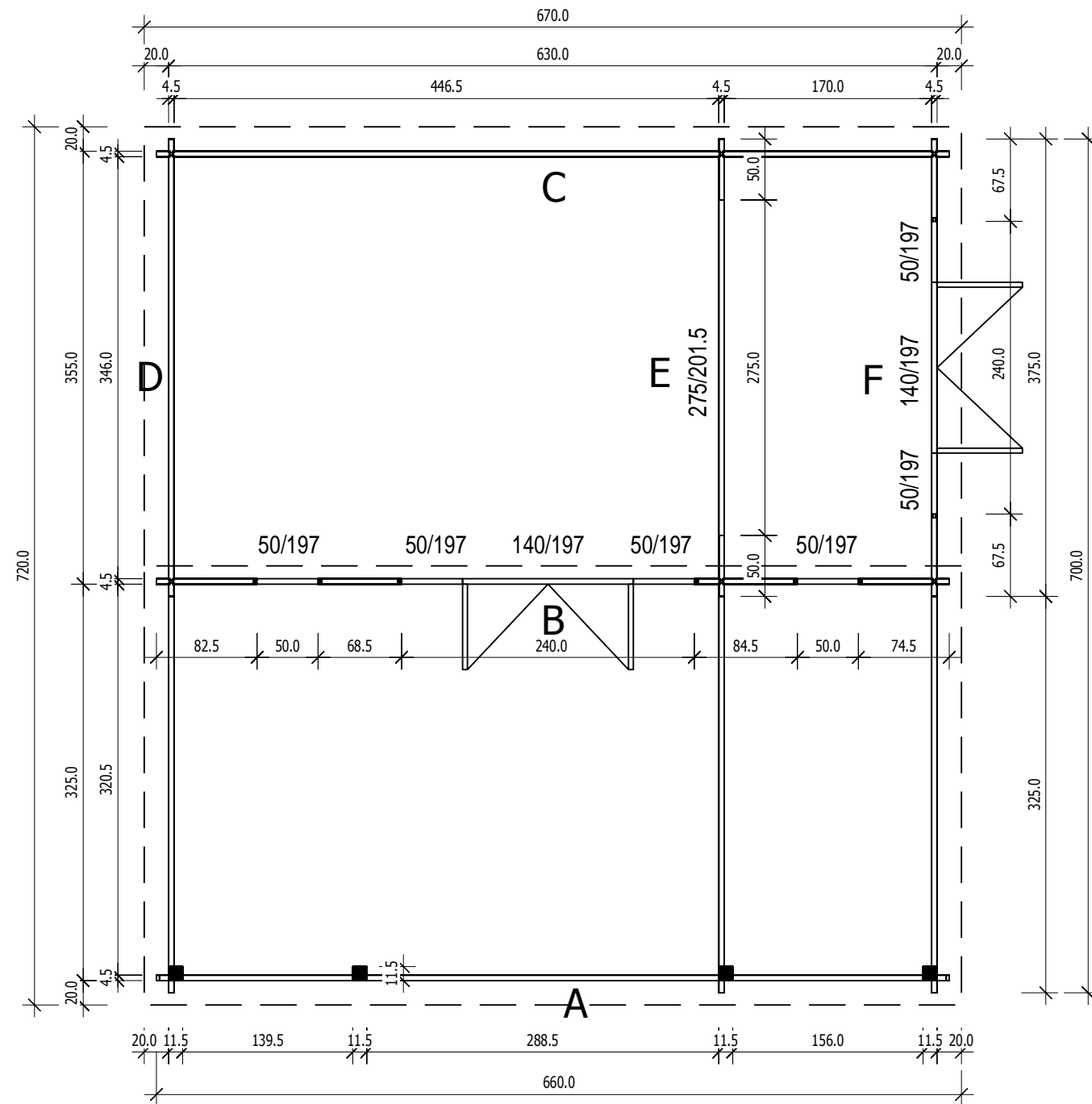

## Schnitt

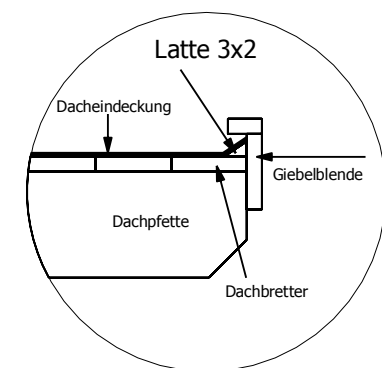
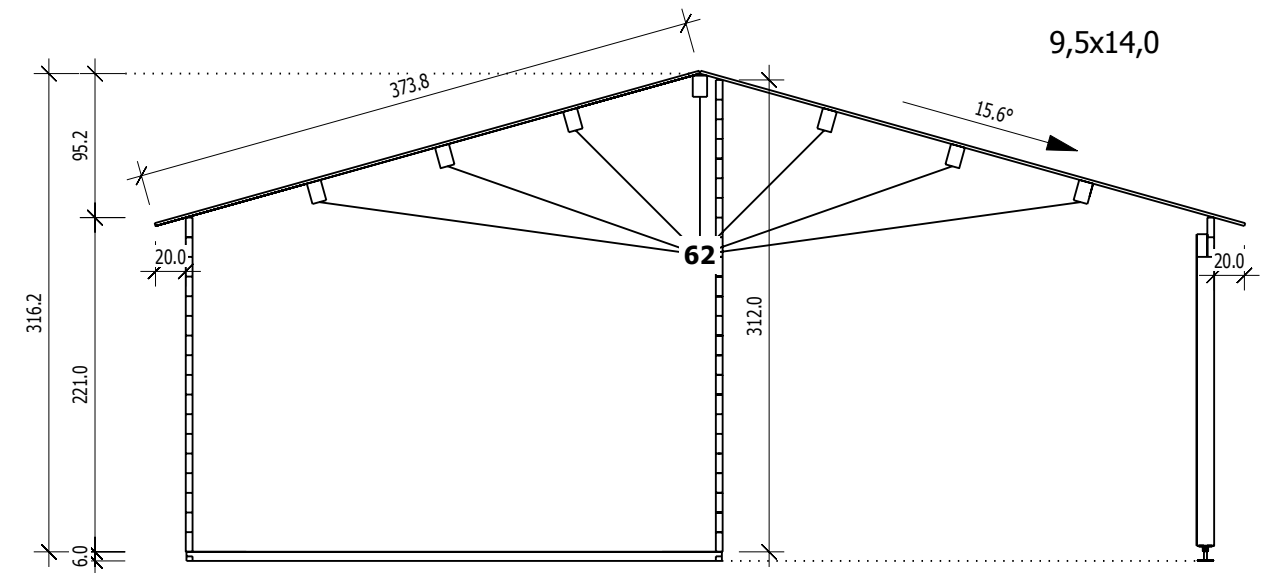

4,5

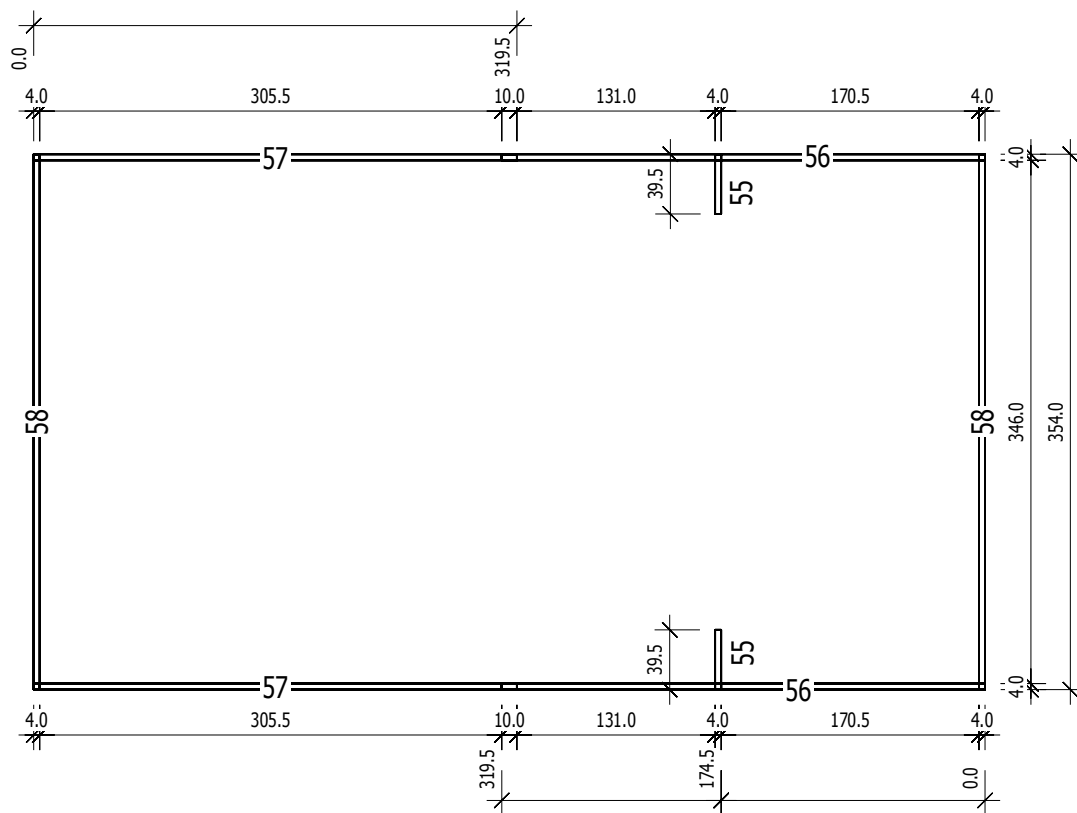

## Grundrahmenplan

Nr.	B	H	L	Psc
	[cm]	[cm]	[cm]	
55	4,0	6,0	39,5	2
56	4,0	6,0	319,5	2
57	4,0	6,0	319,5	2
58	4,0	6,0	354,0	2

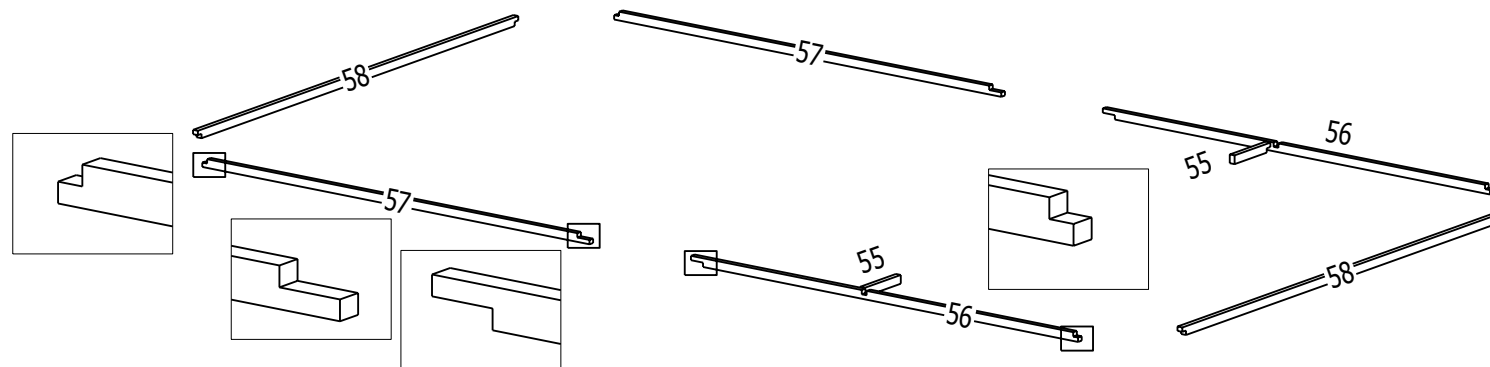

A  
M 1:40

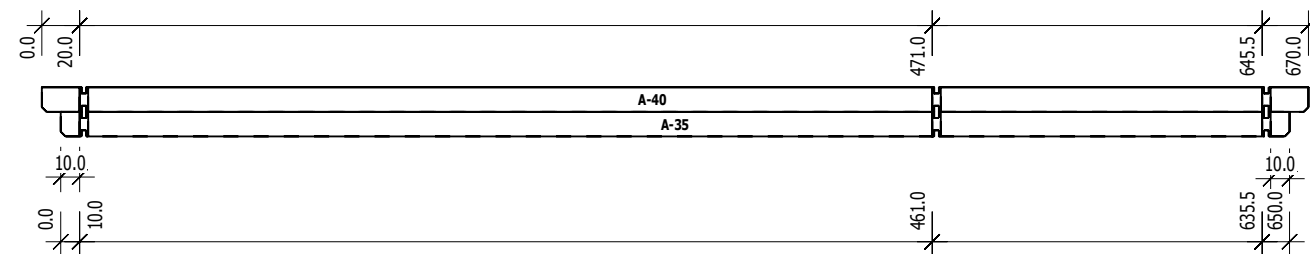

B  
M 1:40

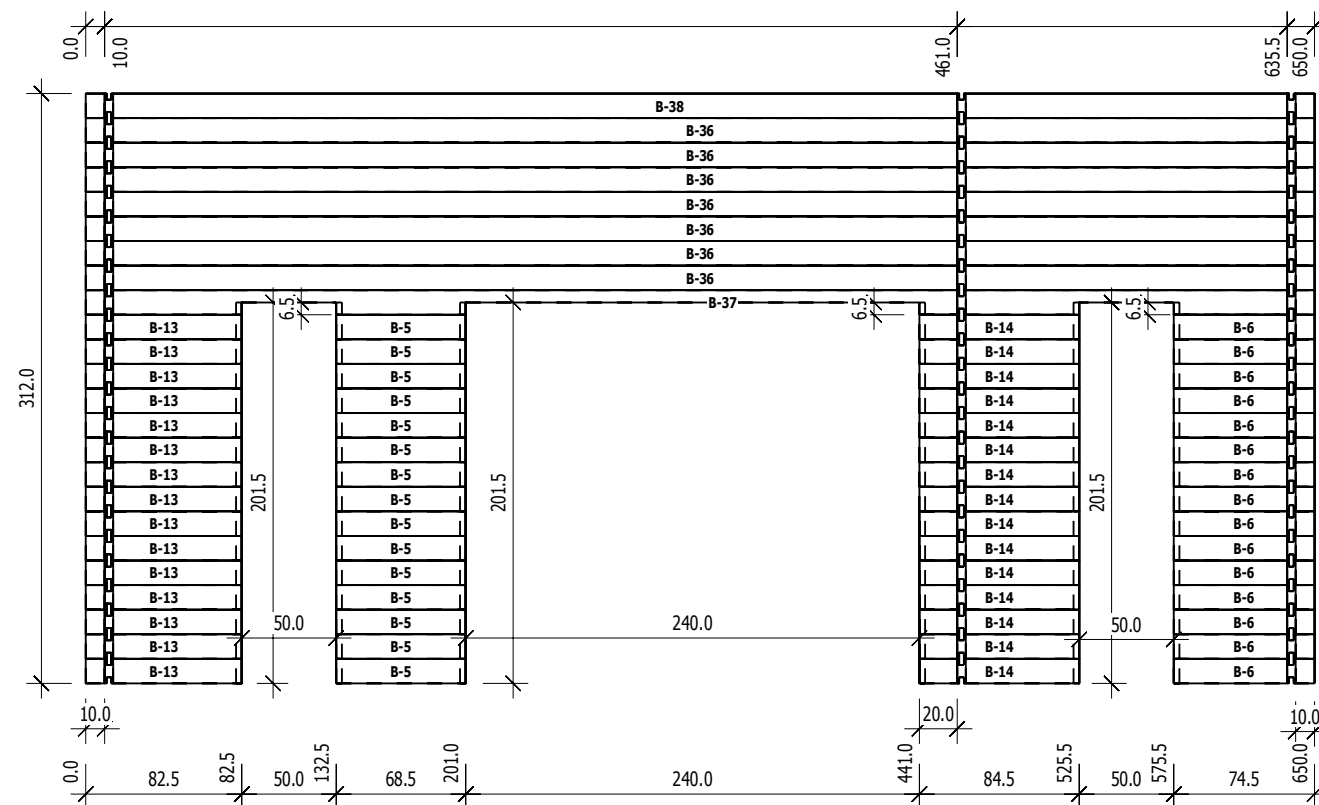

C  
M 1:40

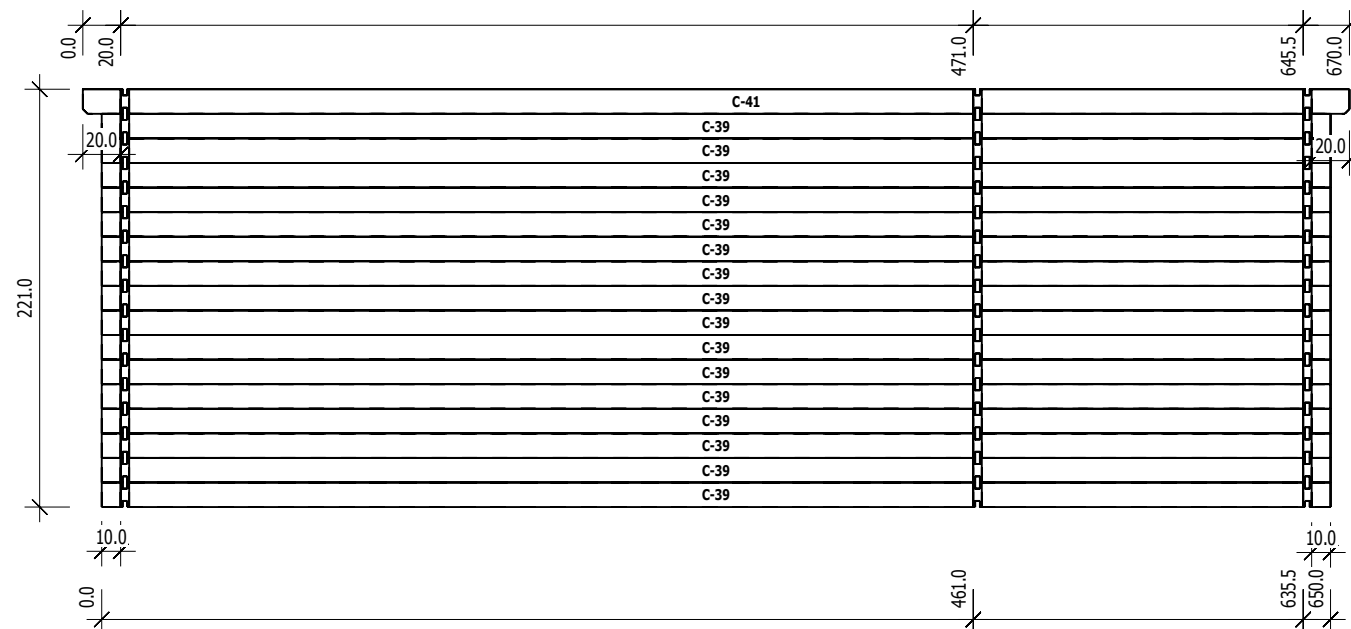

	Nr	H	L	Psc
A	35	13.0	650.0	1
A	40	13,0	670,0	1

4,5

	Nr	H	L	Psc
B	5	13.0	68.5	15
B	6	13.0	74.5	15
B	13	13.0	82.5	15
B	14	13.0	84.5	15
B	36	13.0	650.0	7
B	37	13.0	650.0	1
B	38	13,0	650,0	1

	Nr	H	L	Psc
C	39	13.0	650.0	16
C	41	13,0	670,0	1

D

M 1:40

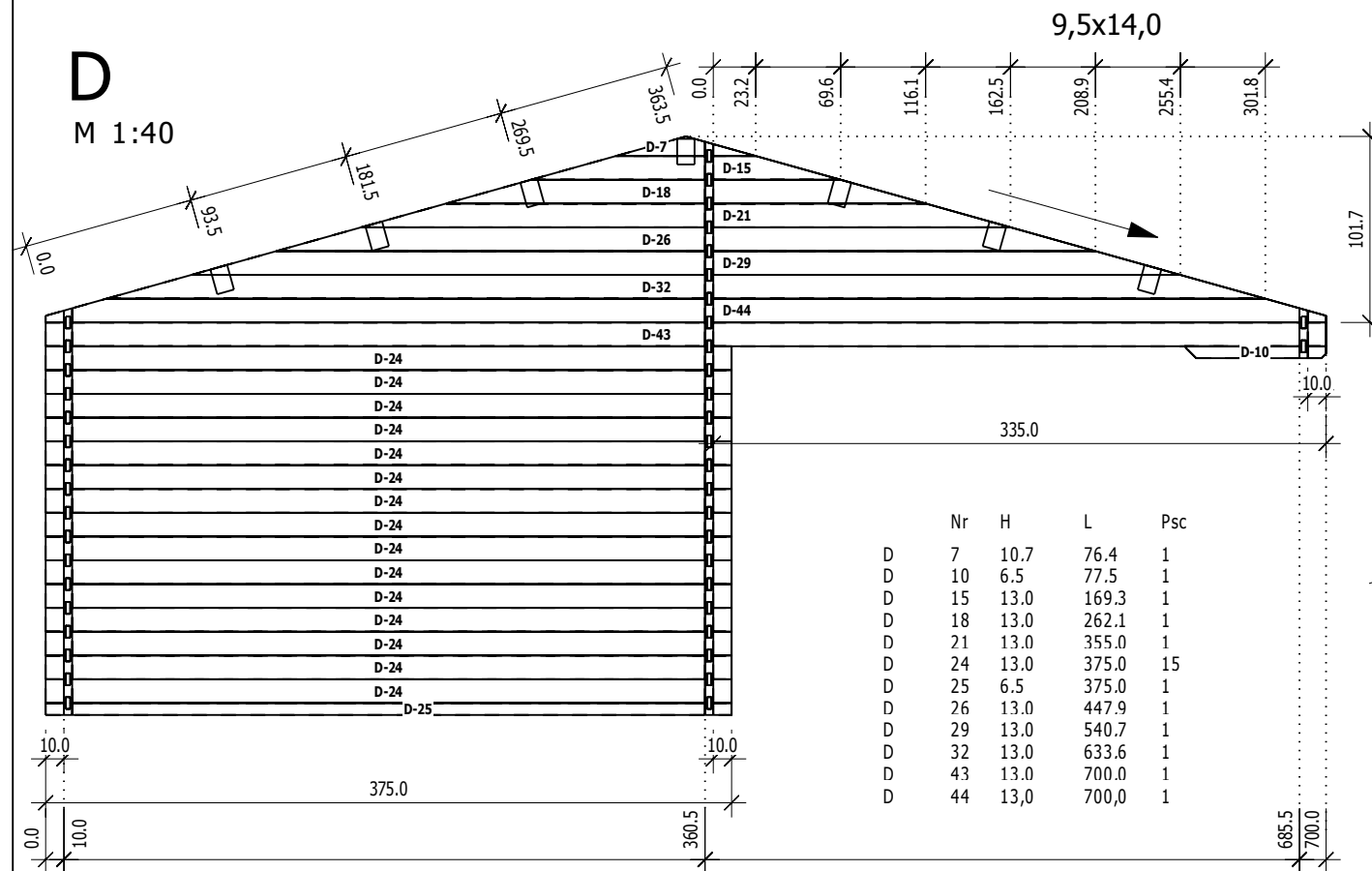

F

M 1:40

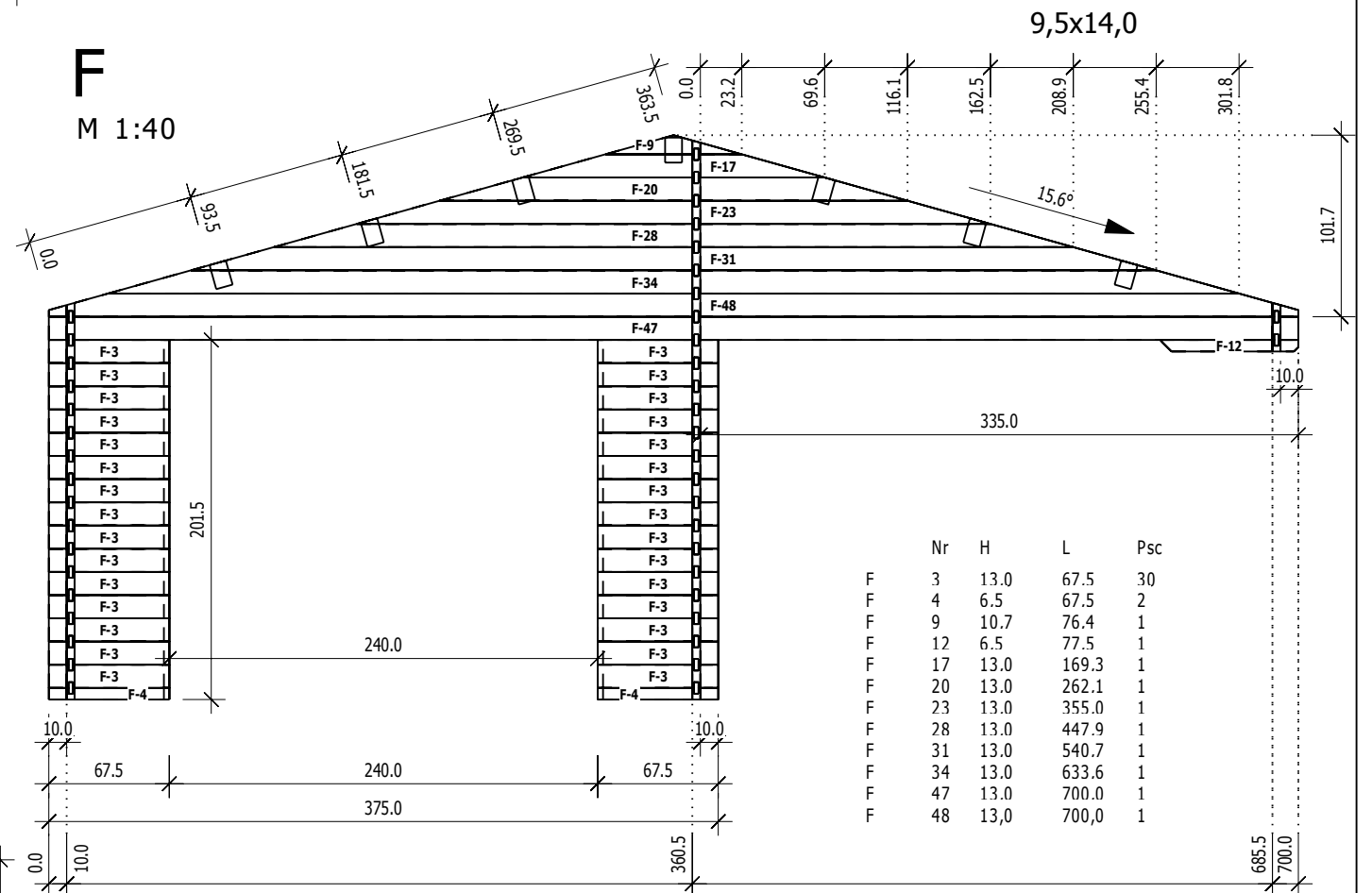

E

M 1:40

