

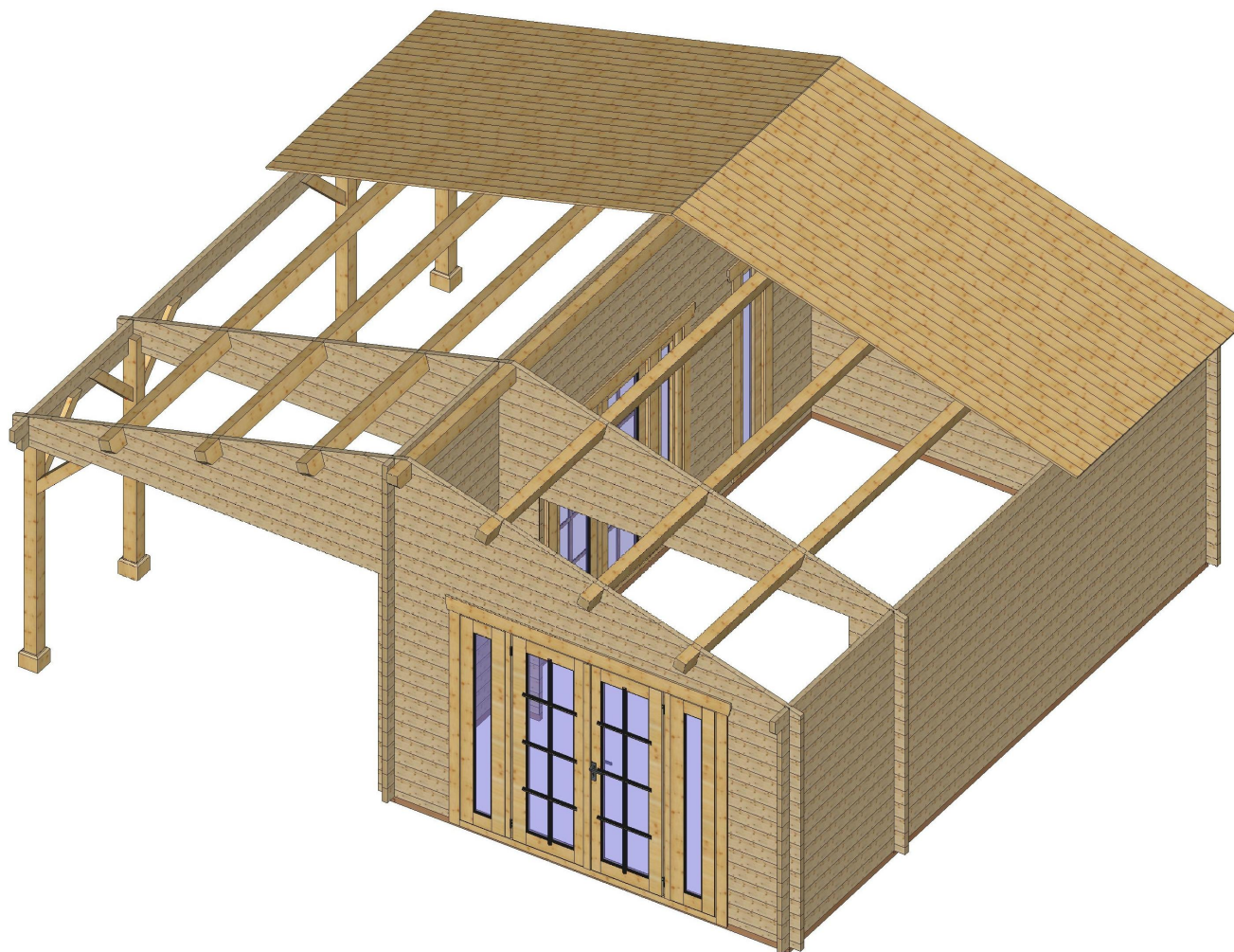

Bemerkung: die Ansicht von Turen, Fenster und anderen Teilen kann abweichen von diesem Bild





Bemerkung: die Ansicht von Türen, Fenster und anderen Teilen kann abweichen von diesem Bild

Grundriss

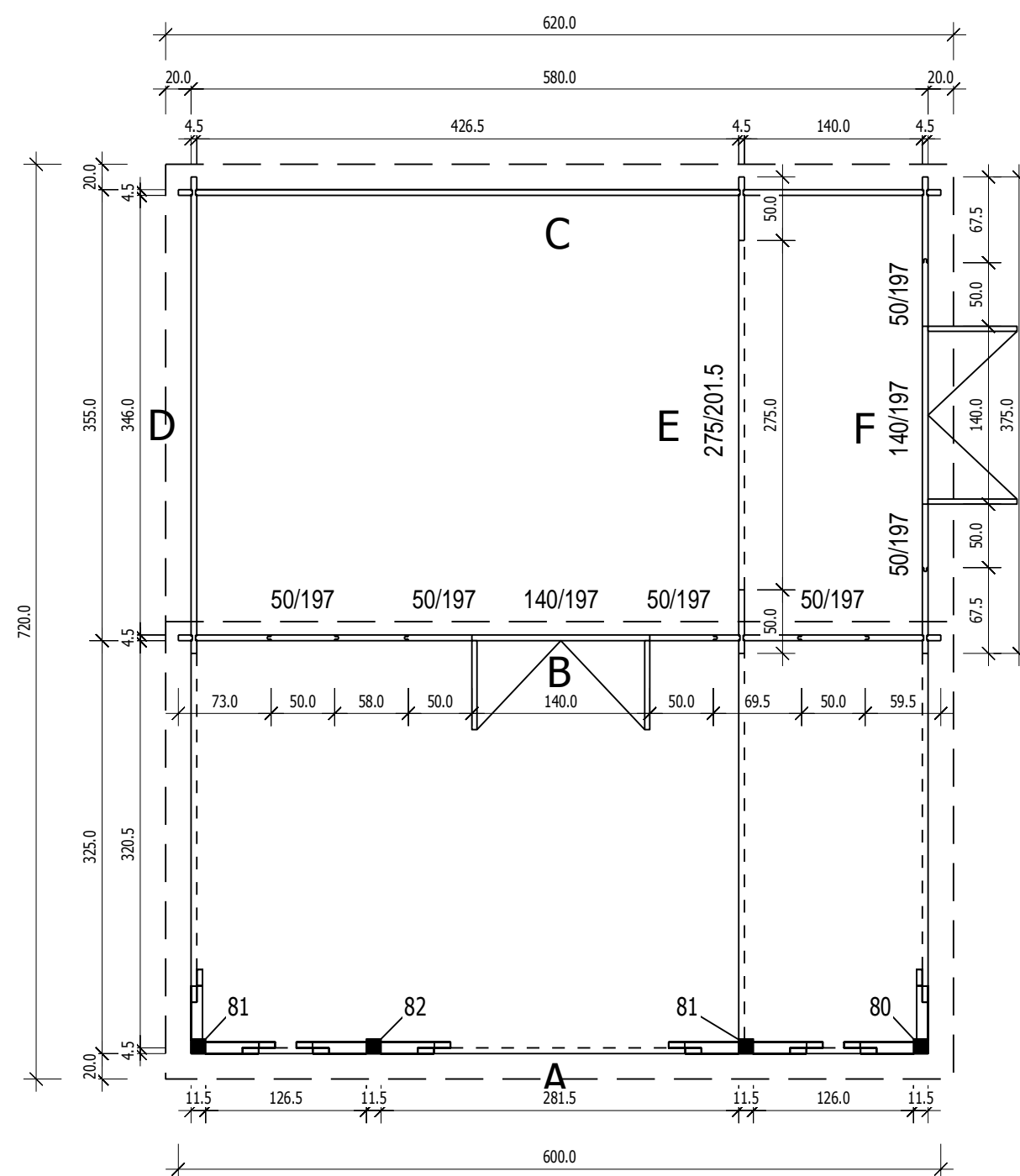

■ 11,5x11,5cm

Schnitt

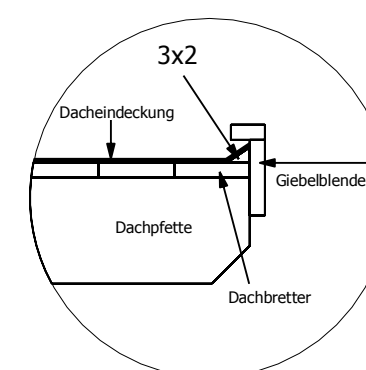
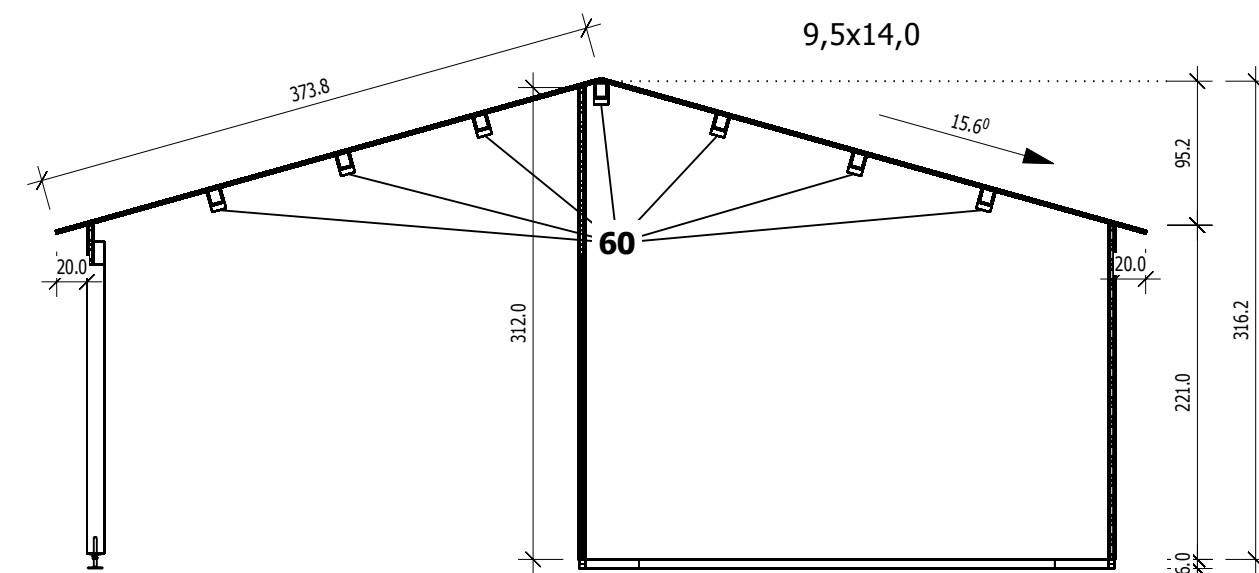

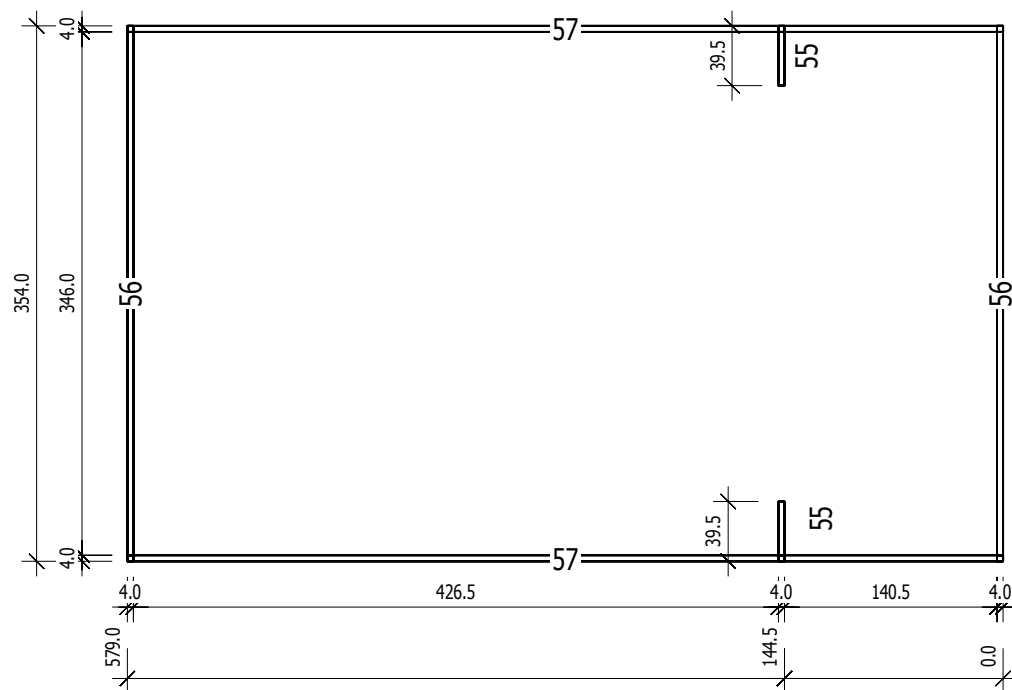

Grundrahmenplan

Nr.	B	H	L	Psc
	[cm]	[cm]	[cm]	
55	4.0	6.0	39.5	2
56	4.0	6.0	354.0	2
57	4.0	6.0	579.0	2

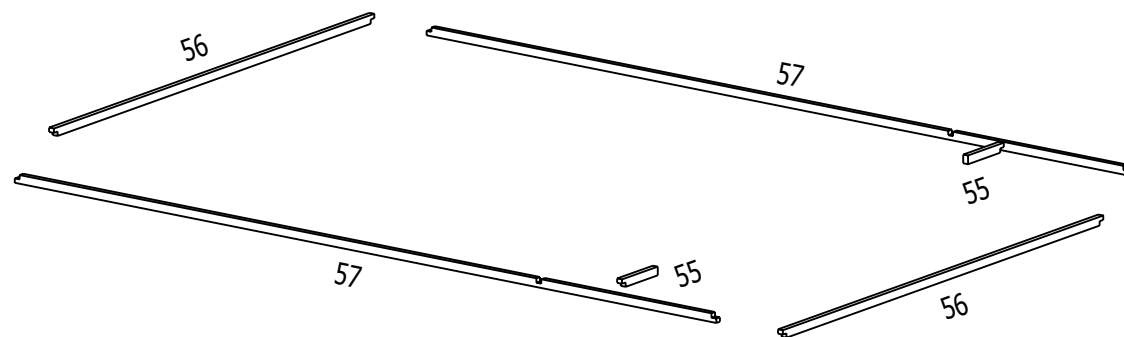

A
M 1:40

4,5

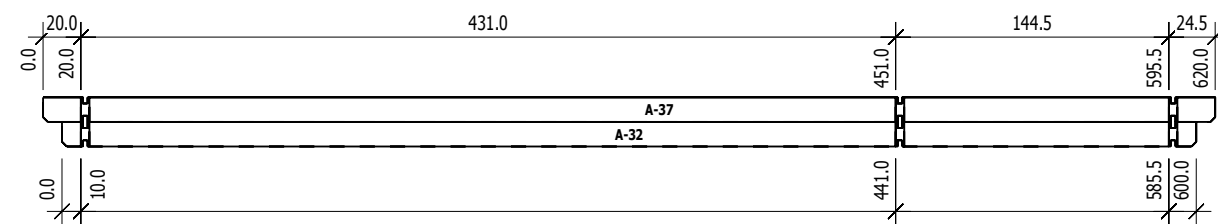

	Nr	H	L	Psc
A	32	13.0	600.0	1
A	37	13.0	620.0	1

B
M 1:40

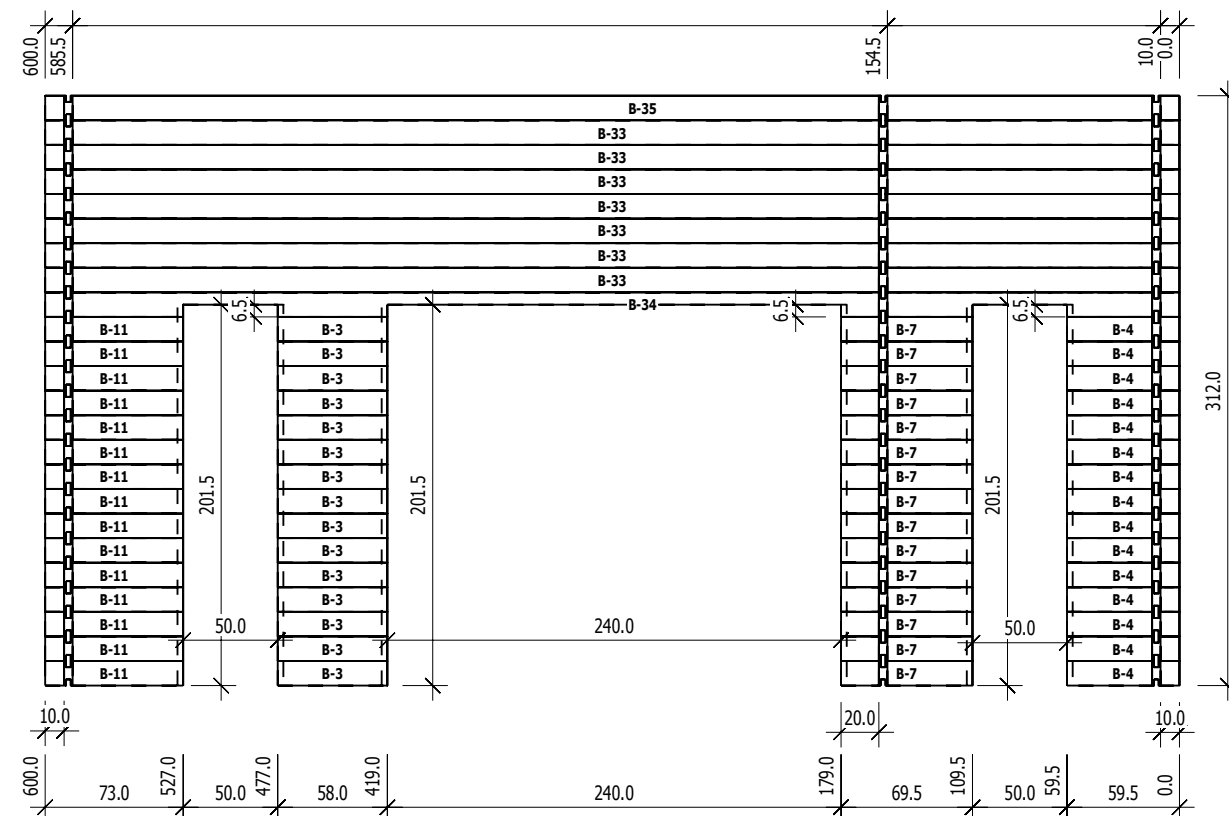

	Nr	H	L	Psc
B	3	13.0	58.0	15
B	4	13.0	59.5	15
B	7	13.0	69.5	15
B	11	13.0	73.0	15
B	33	13.0	600.0	7
B	34	13.0	600.0	1
B	35	13.0	600.0	1

C
M 1:40

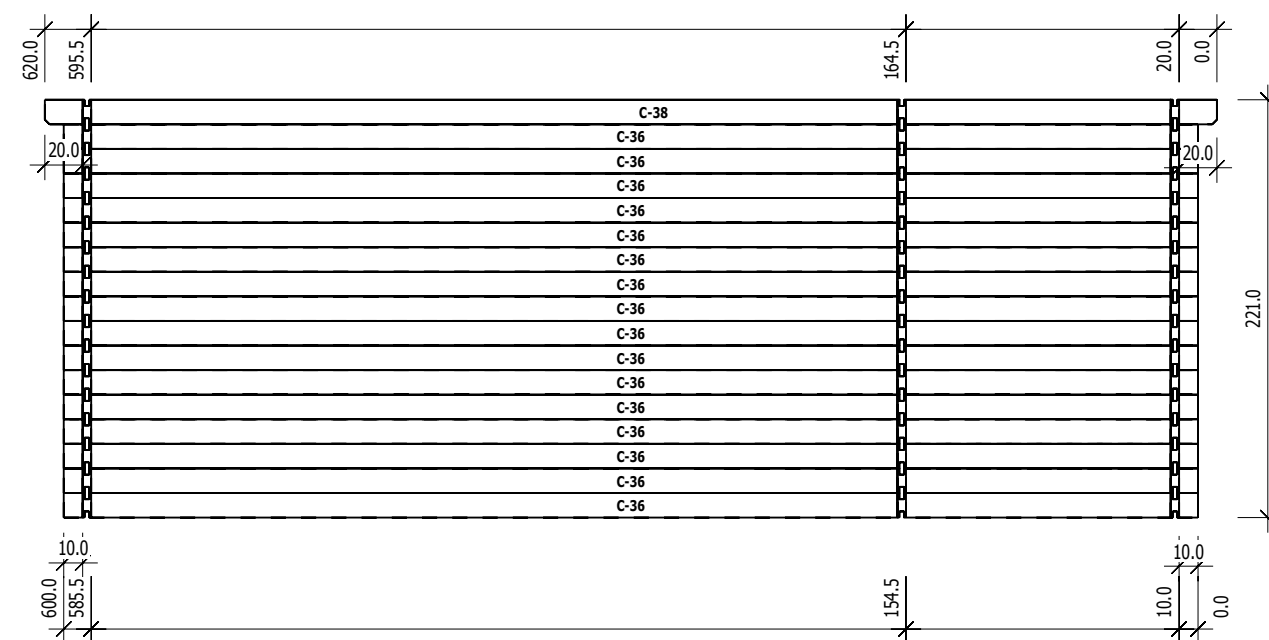

	Nr	H	L	Psc
C	36	13.0	600.0	16
C	38	13.0	620.0	1

