



Bemerkung: die Ansicht von Turen, Fenster und anderen Teilen kann abweichen von diesem Bild



A
M 1:40

Ansicht von Aussen

4,5

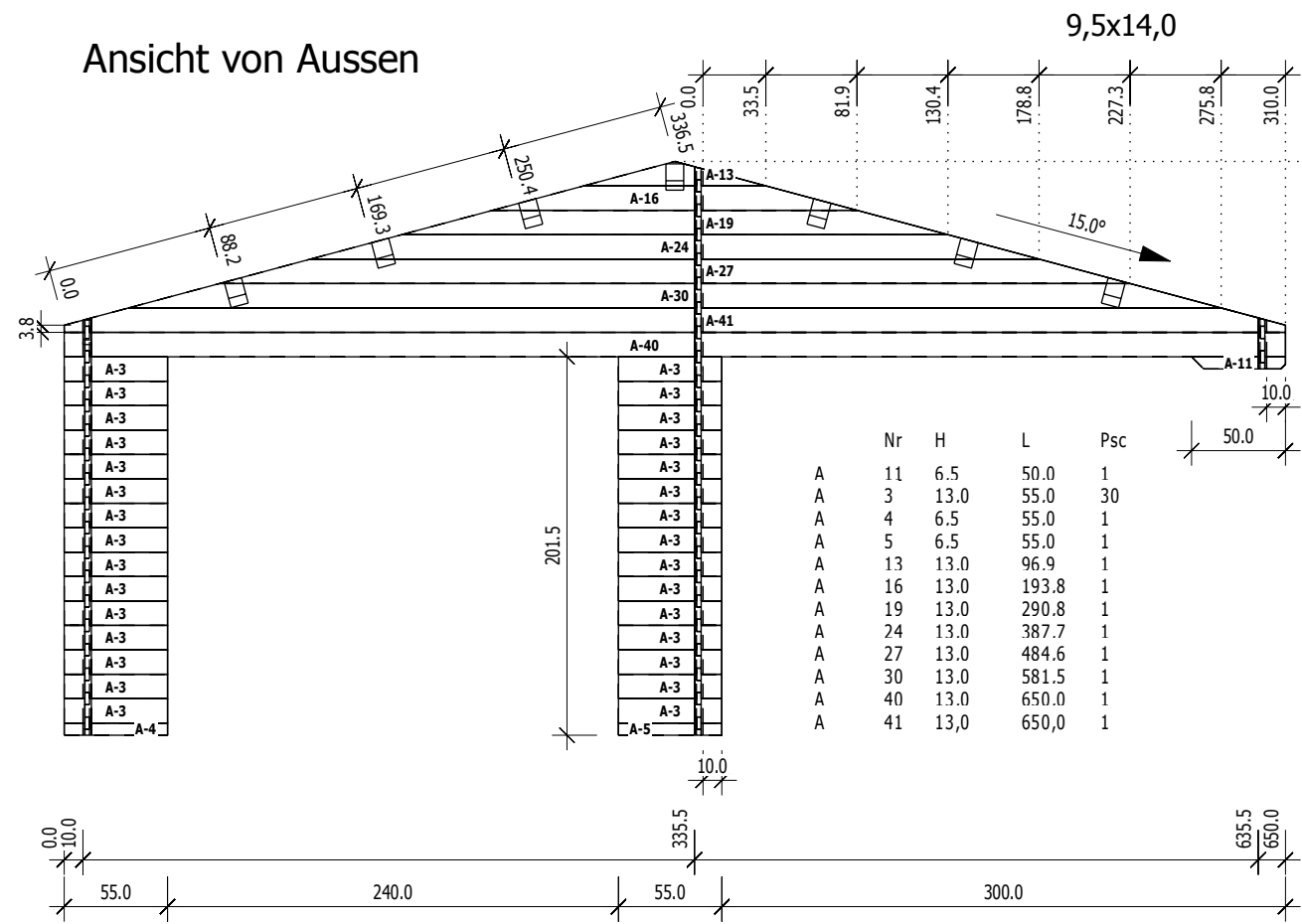

B
M 1:40

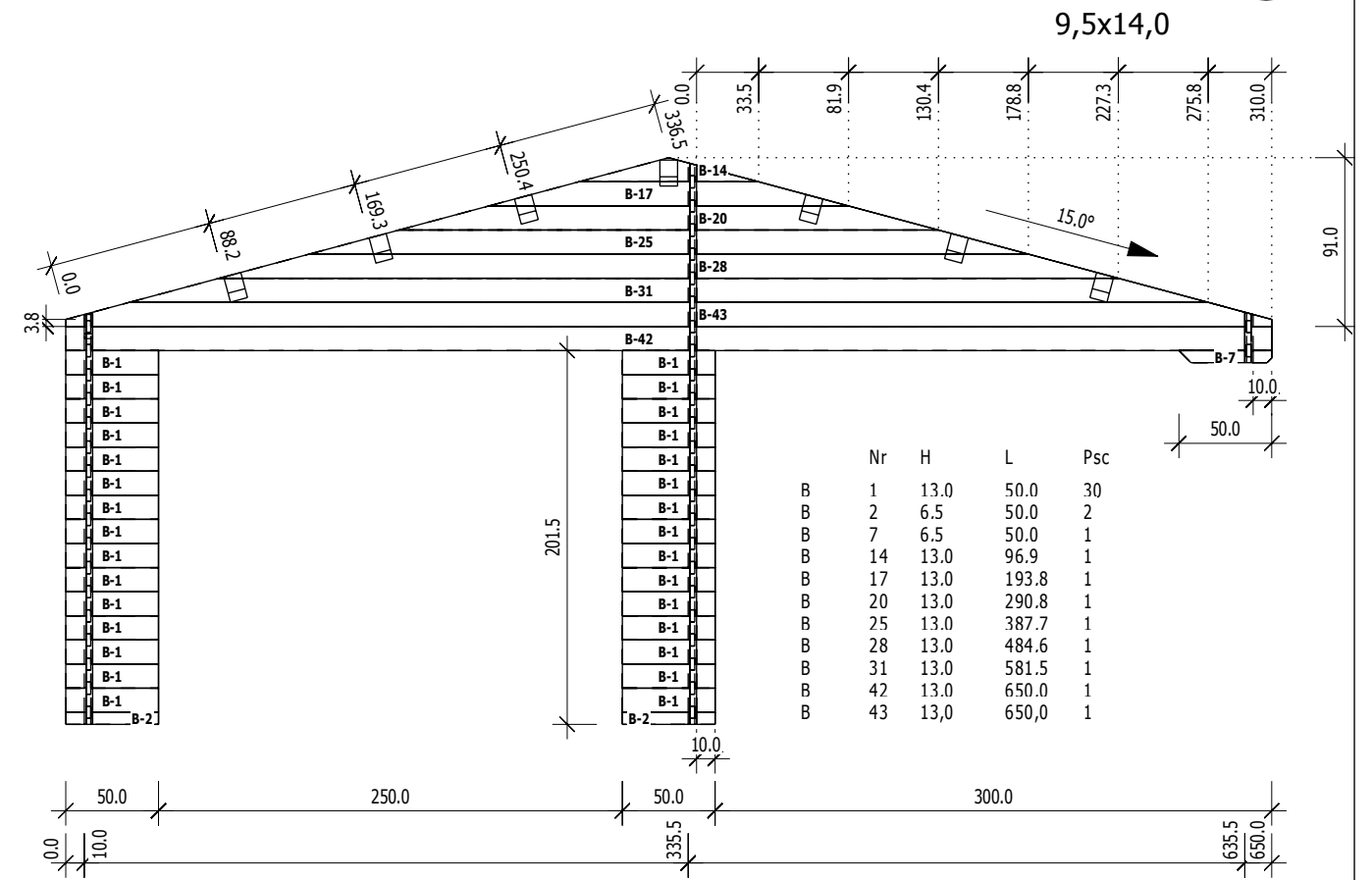

C
M 1:40

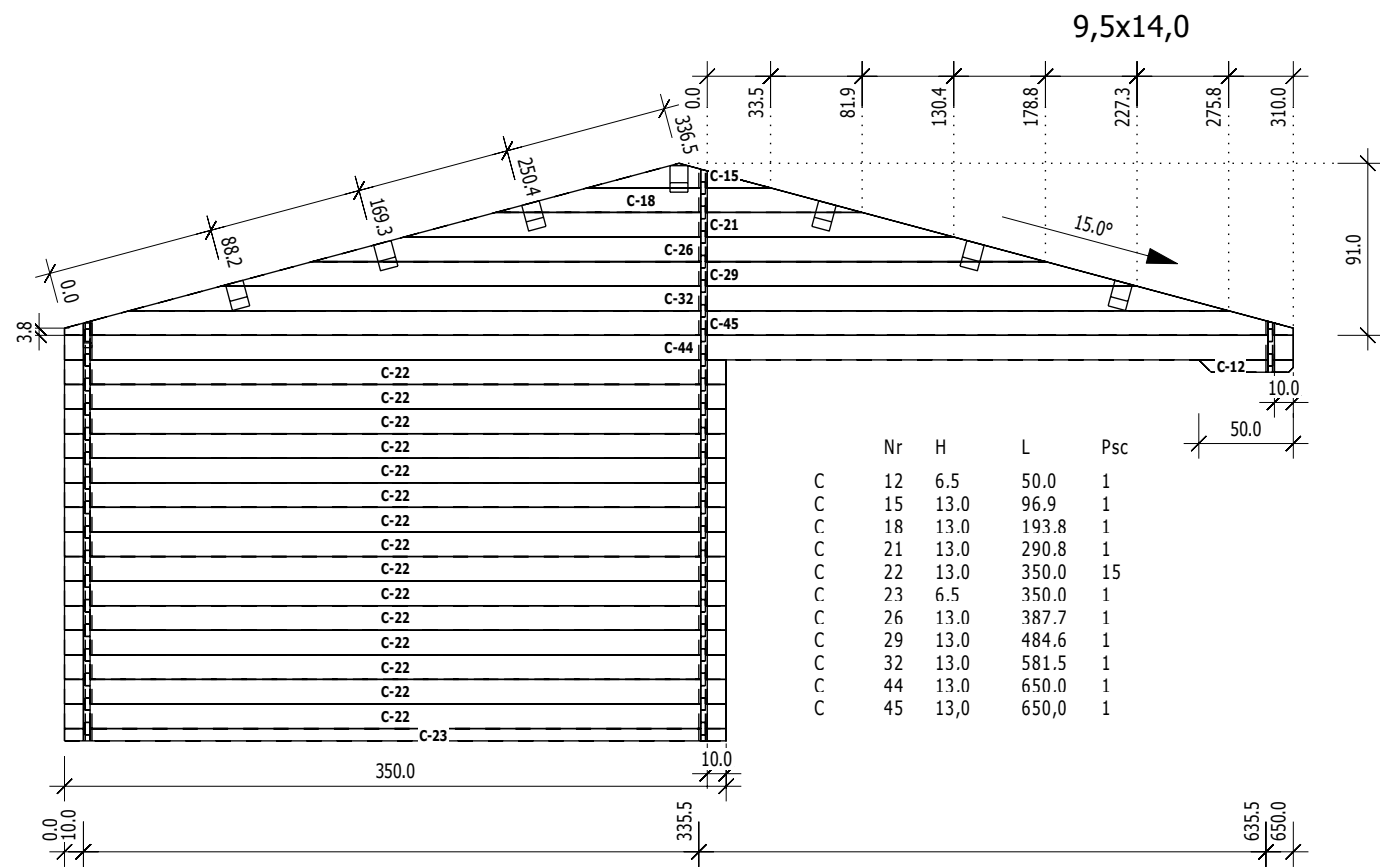

F
M 1:40

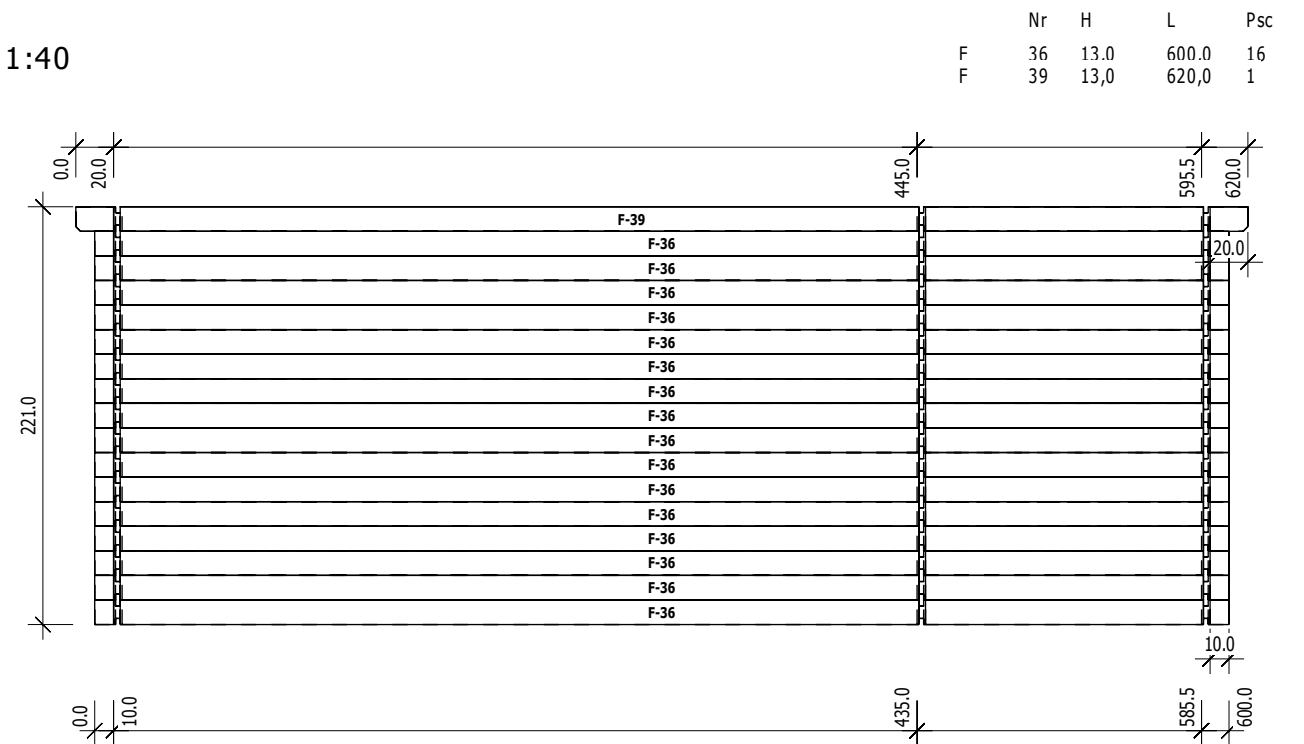

Grundriss

4,5

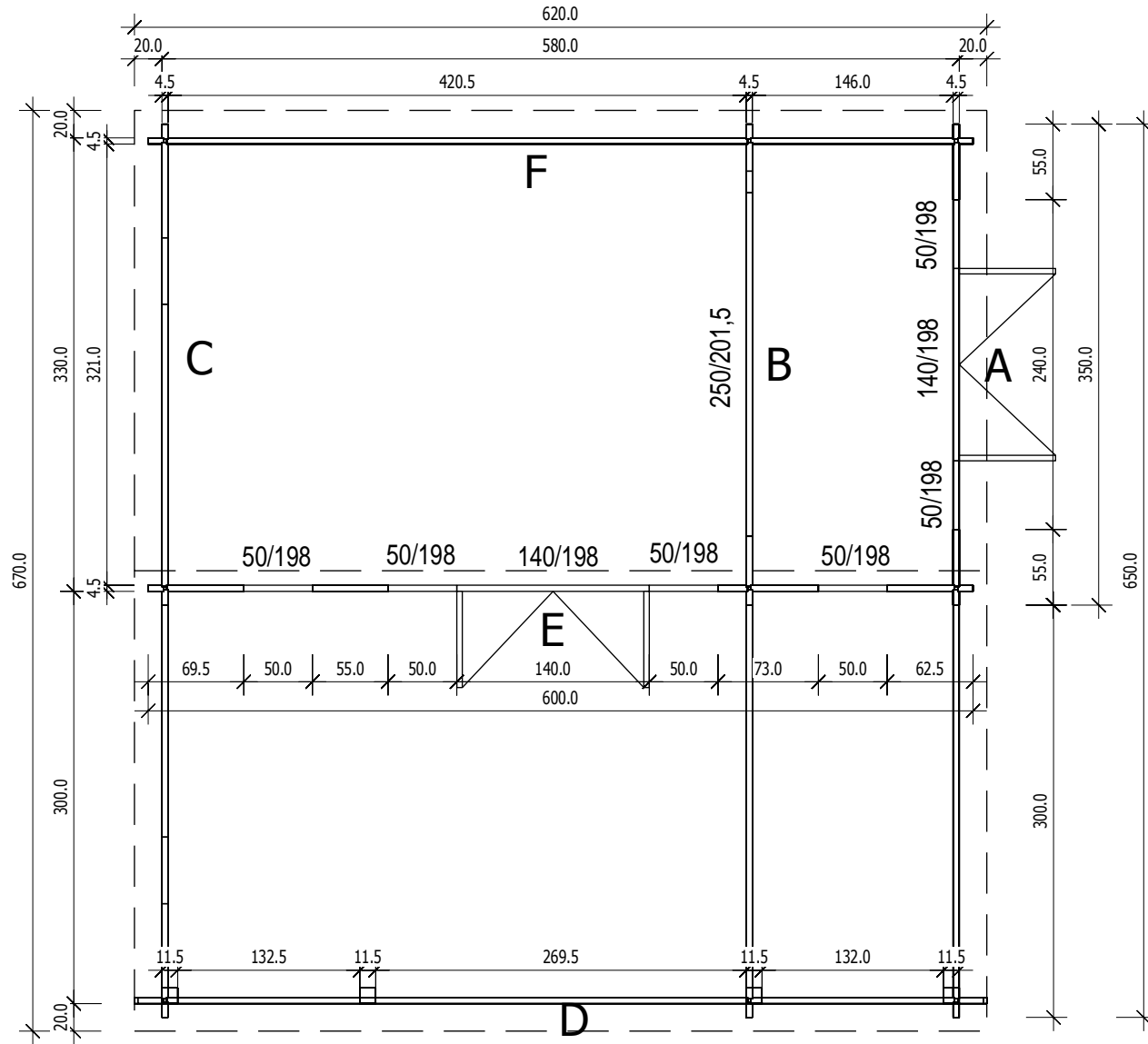

Grundrahmenplan

4,5

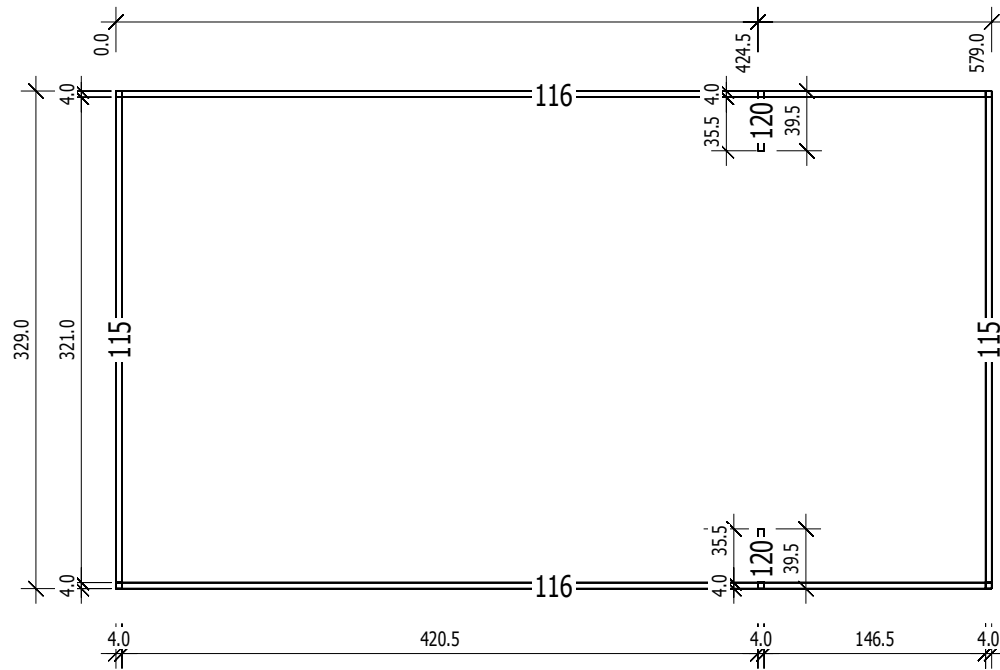

Nr.	B	H	L	Psc
	[cm]	[cm]	[cm]	

115	4,0	6,0	329,0	2
116	4,0	6,0	579,0	2
120	4,0	6,0	39,5	2

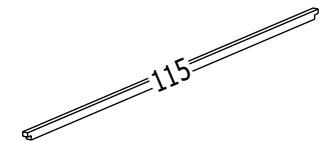
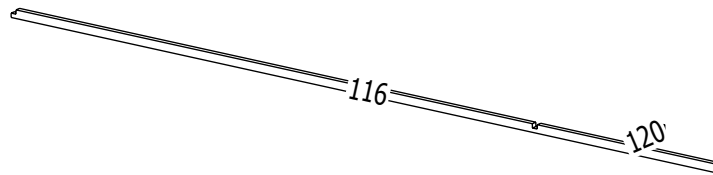
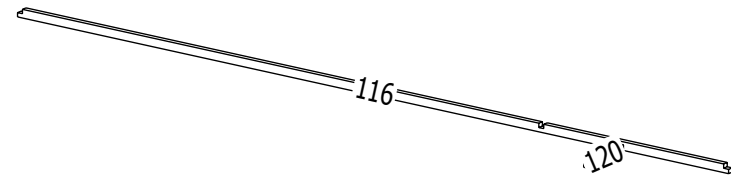
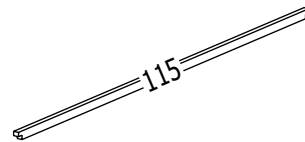

E
M 1:40

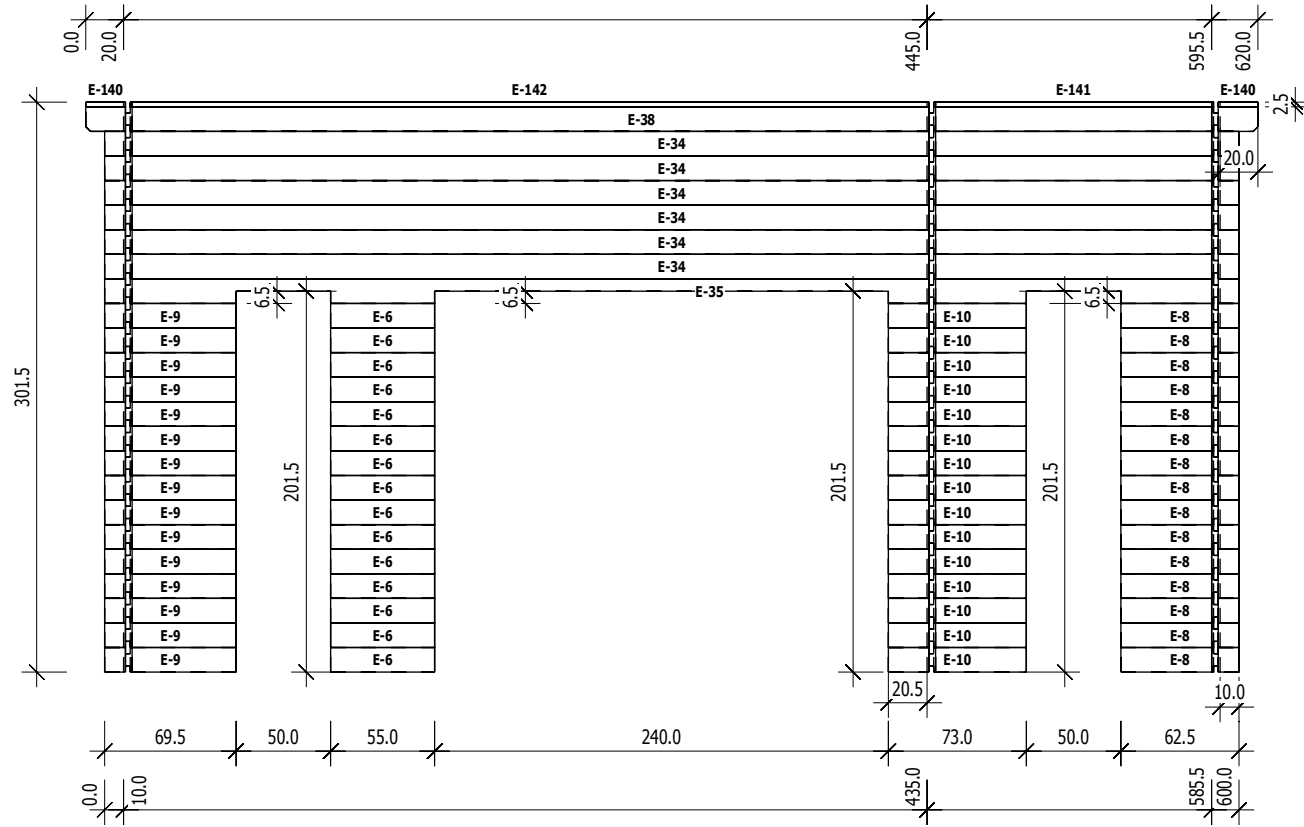

	Nr	H	L	Psc
E	140	2.5	21.0	2
E	6	13.0	55.0	15
E	8	13.0	62.5	15
E	9	13.0	69.5	15
E	10	13.0	73.0	15
E	141	2.5	148.0	1
E	142	2.5	422.5	1
E	34	13.0	600.0	6
E	35	13.0	600.0	1
E	38	13.0	620.0	1

D
M 1:40

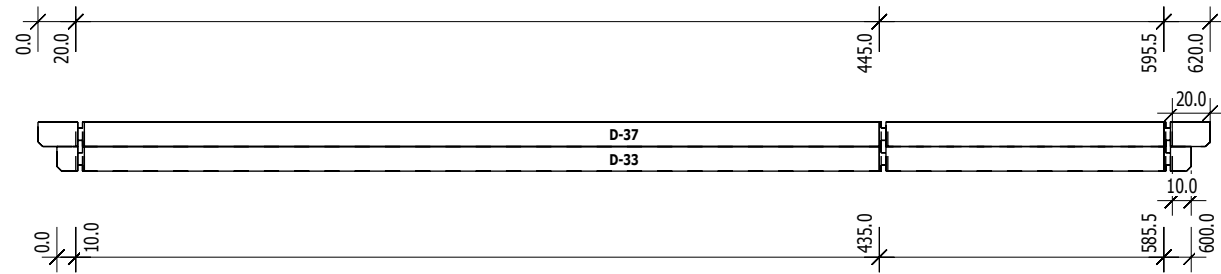

	Nr	H	L	Psc
D	33	13.0	600.0	1
D	37	13.0	620.0	1